

KENT WEST

CORPORATE PARK

FOR LEASE
47,821 SF

AVAILABLE NOW
LANDLORD MAY CONSIDER
SHORTER TERM LEASE



SITE PLAN

AVAILABLE:

47,821 SF - SUITE 21901

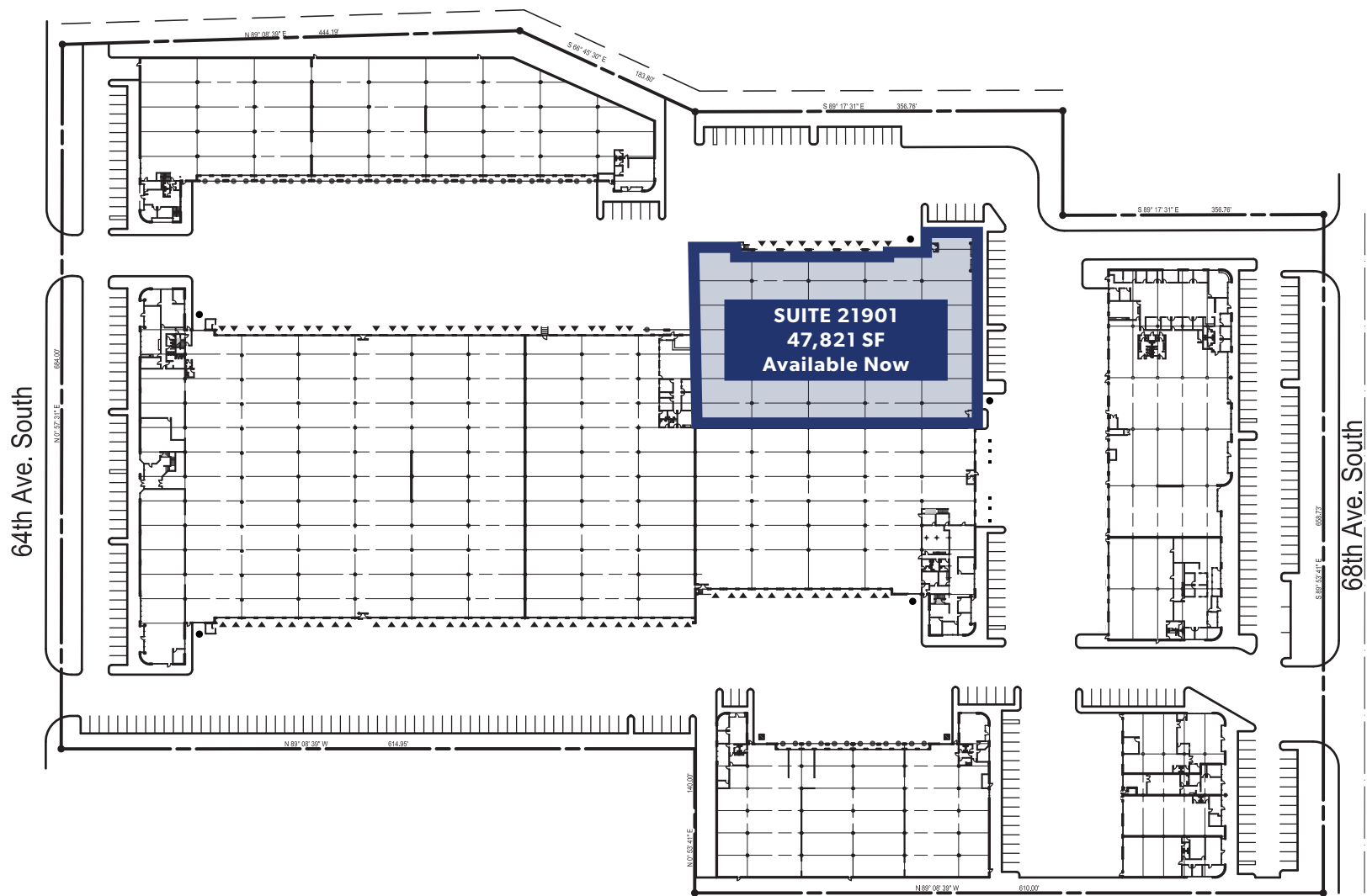

The information contained herein has been obtained from reliable sources, but is not guaranteed. A prospective buyer/tenant should verify each item relating to this property and all information contained herein.



47,821 SF TOTAL

Size: **47,821 SF TOTAL**

Office Space: **76 SF (RESTROOMS)**

Clear Height: **24'**

Docks: **10 (5 Pit Levelers, 1 Edge of Dock Levelers)**

Grade Level: **2 (1 oversized 12' x 14')**

Available: **Now**

Notes: **Landlord may consider shorter term leases. End cap space with unopposed truck court. Please call Brian and Shane for rates, operating expenses and to arrange a site visit.**

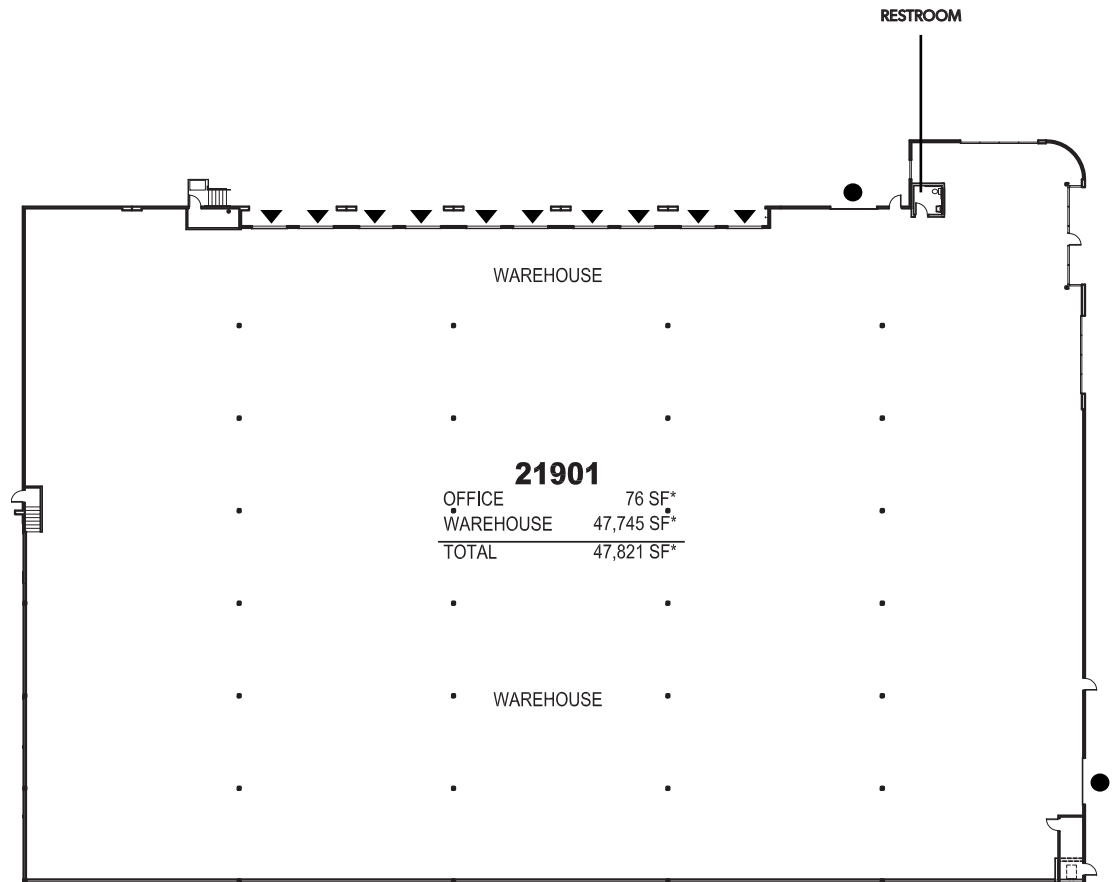
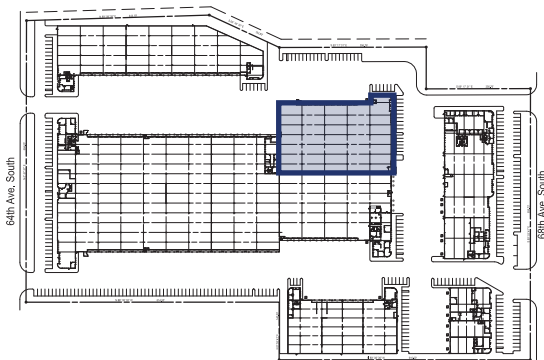

- ▲ Dock high door
- Drive-in door

**21901 67TH AVE S
KENT, WA**

BRIAN BRUININKS, CCIM
(206) 336-5324
bbruininks@andoverco.com

SHANE MAHVI, SIOR
(206) 336-5338
smahvi@andoverco.com

 **THE ANDOVER
COMPANY, INC.**
CORFAC INTERNATIONAL

CONVENIENT COMMUTE



CURRENT ESTIMATED DRIVING TRAVEL TIMES

PORT OF SEATTLE	15 MILES	23 MIN.
SEATTLE CBD	17 MILES	23 MIN.
PORT OF TACOMA	19 MILES	28 MIN.
TACOMA CBD	20 MILES	29 MIN.
SEATAC INT. AIRPORT	5.7 MILES	15 MIN.
BELLEVUE	17.7 MILES	28 MIN.

KENT WEST

CORPORATE PARK



THE ANDOVER
COMPANY, INC.

CORFAC INTERNATIONAL

BRIAN BRUININKS, CCIM
(206) 336-5324
bbruininks@andoverco.com

SHANE MAHVI, SIOR
(206) 336-5338
smahvi@andoverco.com