

FOR LEASE BUILT-OUT CAFE SPACE

422 Yale Ave N, Seattle, WA 98109

AVAILABLE
NOW



For more information please contact:

LAURA MILLER

laura@gibraltarusa.com

206.351.3573



GIBRALTAR
INVESTMENT PROPERTY SOLUTIONS

422 YALE AVE N, SEATTLE, WA 98109

BUILT-OUT CAFE SPACE

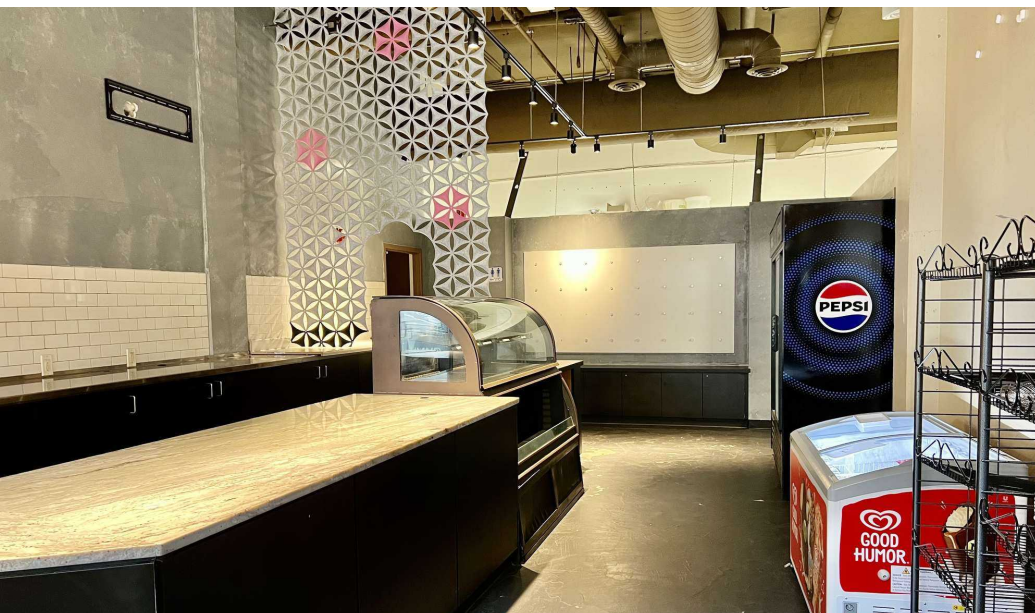

PROPERTY HIGHLIGHTS

- Rare opportunity to lease a built-out cafe space located at the base of The Cairns Apartments, a mixed-use building in a community focused neighborhood in South Lake Union
- Modern industrial space features, large storefront windows, concrete floors, outdoor seating, restroom, storage unit
- Ideal for day-time coffee shop or cafe
- Building co-tenant is The Noodle Bar. Surrounding businesses include Amazon, NBBJ Architects, Cyclebar, Drift Yoga, PlayDate Seattle, and REI
- 1,566 Sq Ft
- Equipment list available upon request
- HVAC
- Rental Rate \$28.00/SF/YR plus 2025 NNN (\$12.00/SF) = \$5,220.00
- Long term lease available



67

TRANSIT SCORE



94

WALK SCORE



82

BIKE SCORE



34,351

TOTAL POPULATION



19,897

TOTAL HOUSEHOLDS



\$124,408

MEDIAN INCOME

* Estimated 2024 Demographics based on a 2 mile radius

422 YALE AVE N, SEATTLE, WA 98109

BUILT-OUT CAFE SPACE



This information has been obtained from sources believed reliable. No guarantee, warranty or representation, express or implied, is made as to the accuracy of the information contained herein, and same is submitted subject to errors, omissions, change of price, rental or other conditions withdrawal without notice, and to any special listing conditions, imposed by our principals. Any projections, opinions, assumptions or estimates used are for example only and do not represent the current or future performance of the property.

422 YALE AVE N, SEATTLE, WA 98109

BUILT-OUT CAFE SPACE

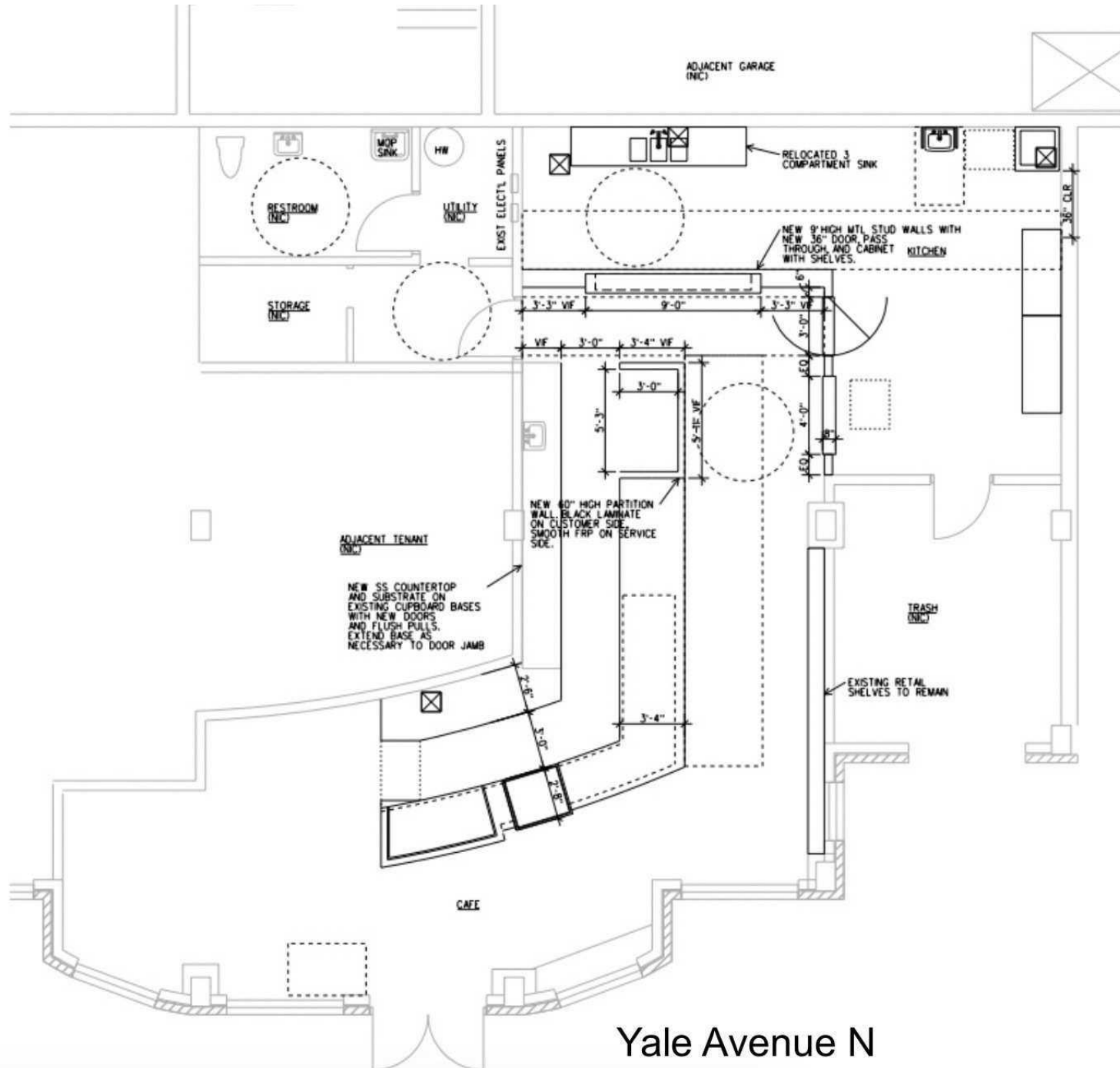

422 YALE AVE N, SEATTLE, WA 98109

BUILT-OUT CAFE SPACE

