

FOR LEASE

4550 3rd Ave SE
Lacey, WA 98503



4550 3RD AVE SE

Amanda Blackwood | Sean Brennecke



First Western Properties—Tacoma Inc. | 253.472.0404
6402 Tacoma Mall Blvd, Tacoma, WA 98409 | fwp-inc.com

Cresa | 503.351.7788
1355 NW Everett Street, Suite #100 | Portland, OR 97209

AVAILABLE SUITES

Zoning – WD (Woodland District)
Lacey WD Zoning Land Use ([Click Here](#))

SUITE 100: 5,525 RSF CALL BROKERS FOR DETAILS

SUITE 103: 2,206 RSF CALL BROKERS FOR DETAILS

*SUITES 100 & 103 CAN BE COMBINED: 7,731 CONTIGUOUS SF

- Limited office space available
- Monument signage available
- Abundant parking with direct access into suite(s) - 4.14 : 1,000
- Sprinkler System
- High Traffic counts at 29,589 per day on College St SE
- Great visibility from 3rd Ave SE & College St SE
- Easy access to College St SE and I-5
- **Neighboring Tenants Include:** Providence Regional Cancer System, SeaMar, Target, Kohls, PetSmart, Fred Meyer and Many More!
- **Intended uses include but are not limited to:** Government, Industrial/ Retail, Medical/Dental, Executive Suite, Data Center/Call Center, Research & Development



Population



Average HH Income



Daytime Population

Regis - 2024

Regis - 2024	Population	Average HH Income	Daytime Population
Mile 1	8,040	\$88,164	12,597
Mile 3	68,126	\$108,325	45,911
Mile 5	160,358	\$117,752	113,035

NEARBY TENANTS



FLOOR PLAN

Interstate 5
Neighboring Business

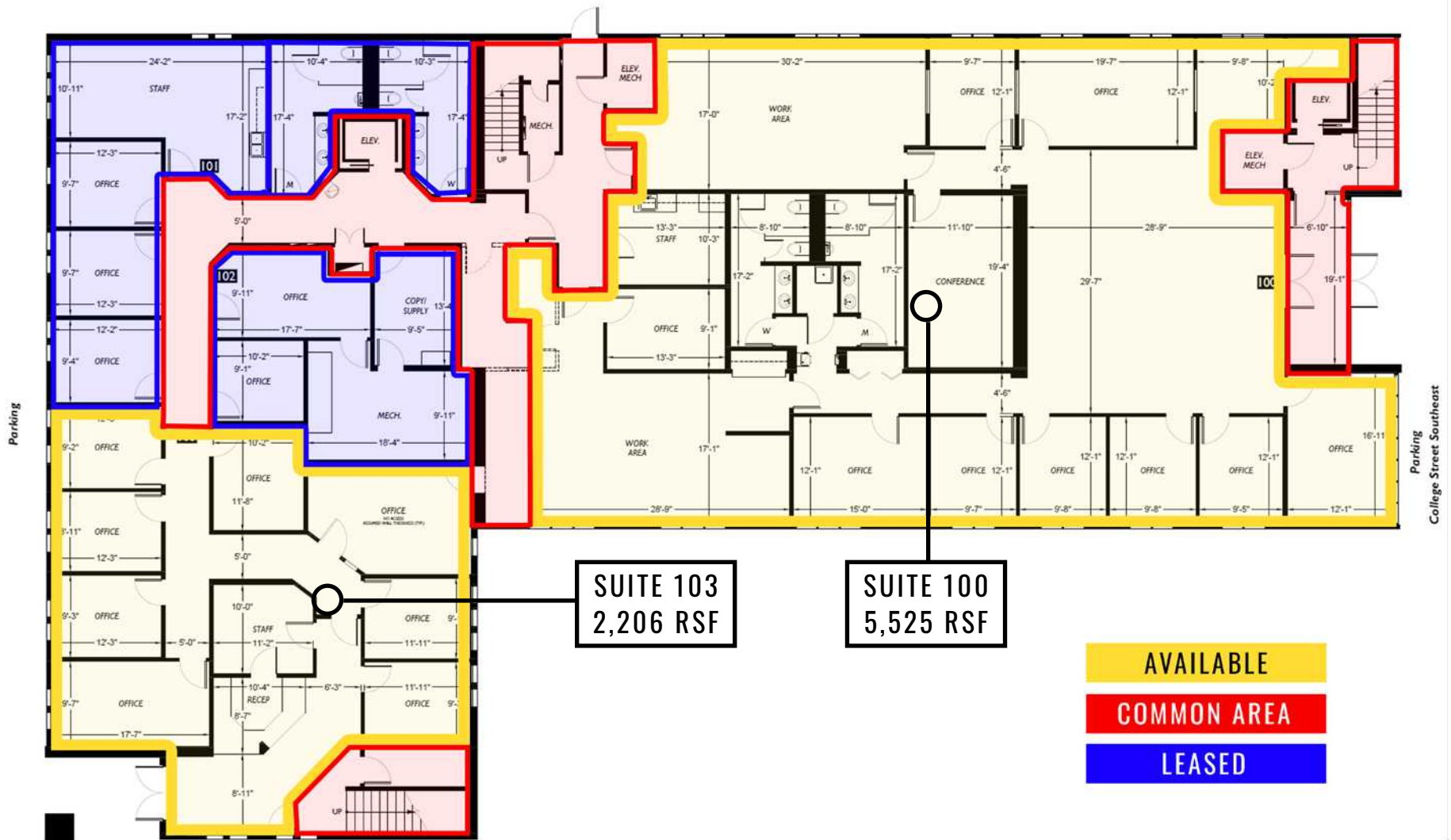

SUITE 103
2,206 RSF

SUITE 100
5,525 RSF

AVAILABLE
COMMON AREA
LEASED

*SUITES 100 & 103 CAN BE COMBINED: 7,731 CONTIGUOUS SF



INTERIOR PHOTOS



LOCATION DETAILS

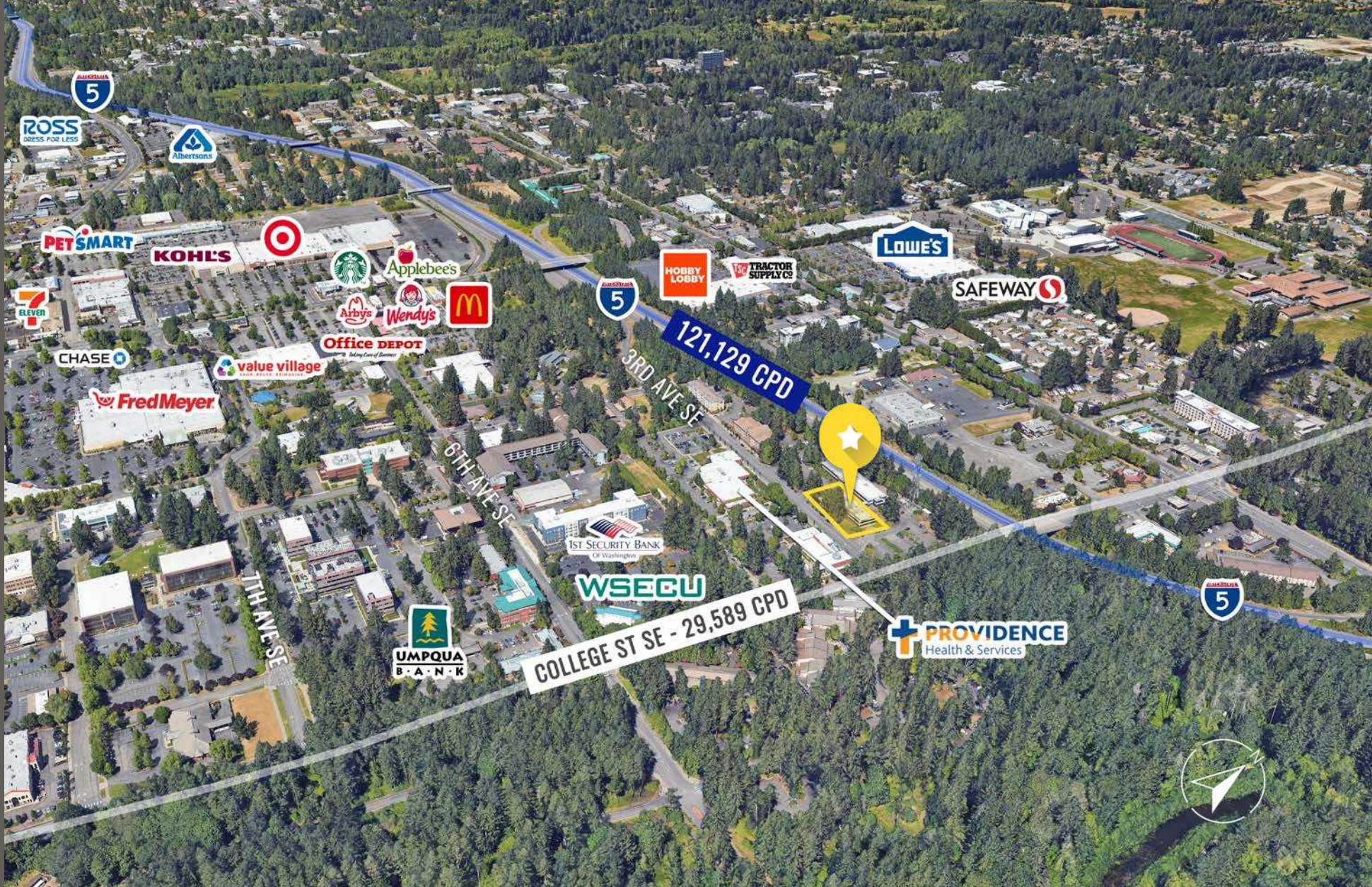

Moments away
from I-5



Located near
major tenants



29,589 CPD
College St SE



121,129 CPD
Interstate 5

LOCATION AERIAL



TRACTOR SUPPLY CO

HOBBY LOBBY

Burlington

REGAL

Coastal FARM & RANCH

LOWE'S

SAFeway

Mor

DISCOUNT TIRE

TACO BELL

Albertsons

CAR-TOYS

ROSS DRESS FOR LESS

DQ

SITE

Saint Martin's UNIVERSITY
1,800 STUDENTS

Fred Meyer

planet fitness

SOUTH SOUND CENTER

TARGET

KOHL'S expect great things

Applebee's

PET SMART

Marshalls

STARBUCKS



TACOMA | KIRKLAND | PORTLAND | SEATTLE

RELATIONSHIP FOCUSED. RESULTS DRIVEN.



FIRST
WESTERN
PROPERTIES

AMANDA BLACKWOOD

Vice President | Broker



425.531.3345



ablackwood@firstwesternproperties.com



cresa

SEAN BRENNECKE

Vice President | Licensed in OR & WA



503.351.778



sbrennecke@cresa.com

First Western Properties—Tacoma Inc. | 253.472.0404
6402 Tacoma Mall Blvd, Tacoma, WA 98409 | fwp-inc.com

Cresa | 503.351.7788
1355 NW Everett Street, Suite #100 | Portland, OR 97209



© First Western Properties, Inc. DISCLAIMER: The above information has been secured from sources believed to be reliable, however, no representations are made to its accuracy. Prospective tenants or buyers should consult their professional advisors and conduct their own independent investigation. Properties are subject to change in price and/or availability without notice.