

THE FOUNDRY



12700 NE 124TH ST, KIRKLAND, WA

12,768 SF (DIVISIBLE) RETAIL SPACE FOR LEASE

OPENING Q3 2027

CBRE

FLOOR PLAN

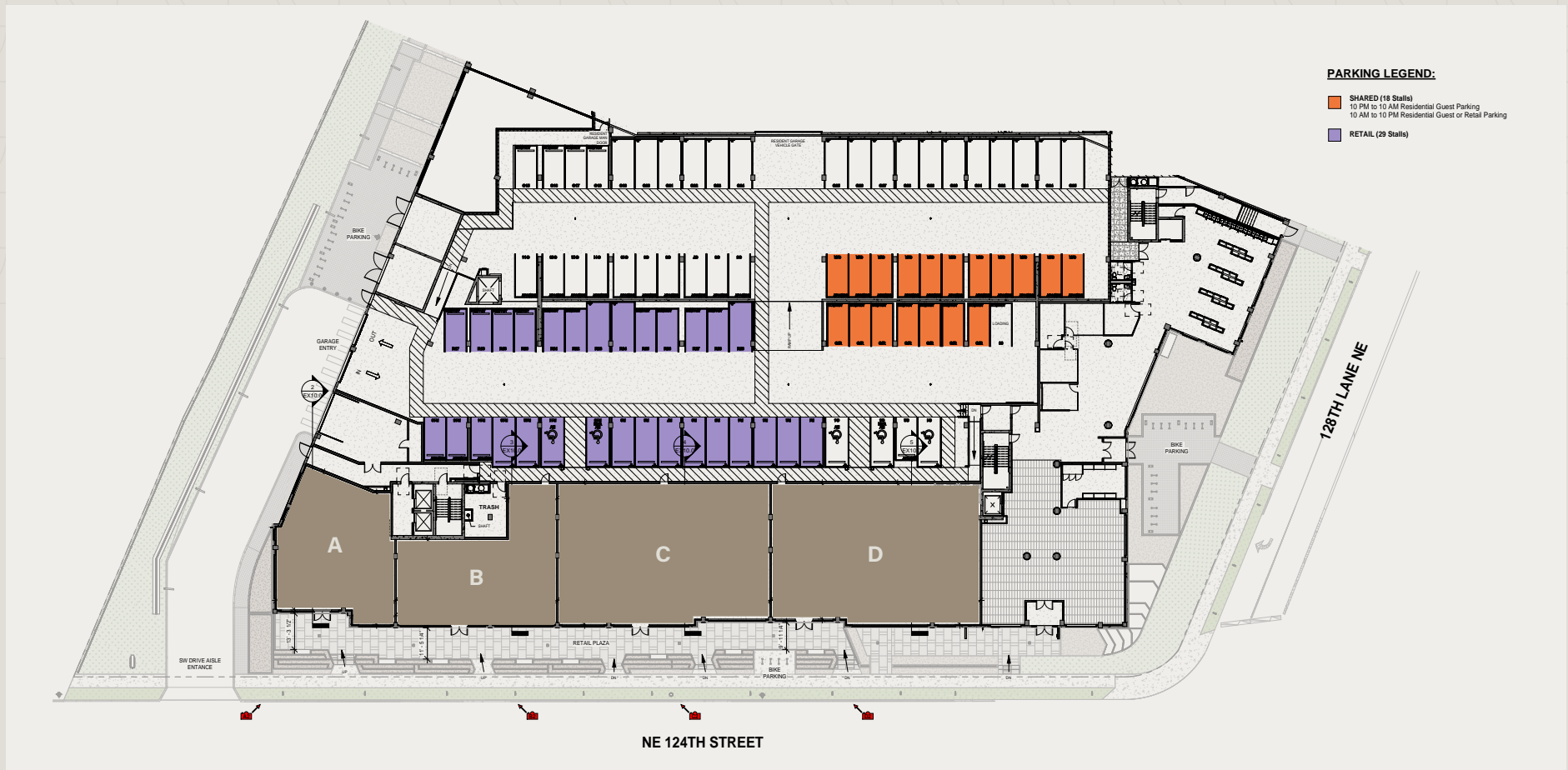

SUITE	RSF	USF
A	2,192 SF	2,001 SF
B	2,330 SF	2,187 SF
C	4,152 SF	3,936 SF
D	4,094 SF	3,838 SF

SPACE HIGHLIGHTS

- + Ground floor retail below 453 residential apartment units
- + 13'6" to 14'4" interior ceiling height
- + Type 1 Hood Shafts available for suites A & B
- + Level floor throughout, allowing for alternate demising scenarios

MAP



2024 DEMOGRAPHICS

1 MILE 3 MILE 5 MILE

Number of Businesses	1,039	4,177	9,087
Population	16,256	121,565	252,238
Daytime Population	30,780	129,577	273,946
Average Household Income	\$176,553	\$215,935	\$218,553

PROJECT HIGHLIGHTS

- + Highly sought after retail space in busy Totem Lake corridor
- + Excellent visibility to high traffic NE 124th Street (over 35,000 cars per day)
- + Extremely strong income demographics at over \$200,000K on average
- + Strong retail coTenancy being less than 1/4 mile from Totem Lake Village

THE FOUNDRY

UMAMI RAMEN

12700 NE 124TH ST, KIRKLAND, WA

12,768 SF (DIVISIBLE) FOR LEASE

JENNIFER SEVERSEN
Vice President

C +1 206-390-1498
jennifer.seversen@cbre.com

CBRE

© 2025 CBRE, Inc. All rights reserved. This information has been obtained from sources believed reliable but has not been verified for accuracy or completeness. CBRE, Inc. makes no guarantee, representation or warranty and accepts no responsibility or liability as to the accuracy, completeness, or reliability of the information contained herein. You should conduct a careful, independent investigation of the property and verify all information. Any reliance on this information is solely at your own risk. CBRE and the CBRE logo are service marks of CBRE, Inc. All other marks displayed on this document are the property of their respective owners, and the use of such marks does not imply any affiliation with or endorsement of CBRE. Photos herein are the property of their respective owners. Use of these images without the express written consent of the owner is prohibited. BCS0019463 7.16.25 BSO