

FOR SUBLEASE

10700 NORTHUP WAY | BELLEVUE, WA 98004

10700 BUILDING



SPACE

HIGHLIGHTS

- + Master Lease Expires July 31, 2028
- + Shorter term subleases considered.
- + Plug and Play ready with furniture available
- + Parking ratio: 4.58 / 1,000 RSF (surface and covered available)
- + Centrally located between Downtown Kirkland and Downtown Bellevue
- + Easy access to SR-520 & I-405

1ST FLOOR SPACE AVAILABLE

100 + 110 + 120 3,485 - 30,355
SUITES RSF



ADDITIONAL FEATURES



Fitness center + showers



Adjacent to the Cross
Kirkland Corridor trail



520 Bike Trail



Located next to South Kirkland Park
and Ride



Close proximity to Kirkland amenities
such as Carillon Point and the Lake
Washington waterfront



AS-BUILT FLOOR PLAN

AVAILABLE WITH
+/- 90 DAYS NOTICE
**SUITE
100**
18,709 SF

AVAILABLE NOW
**SUITE
110**
3,485 SF

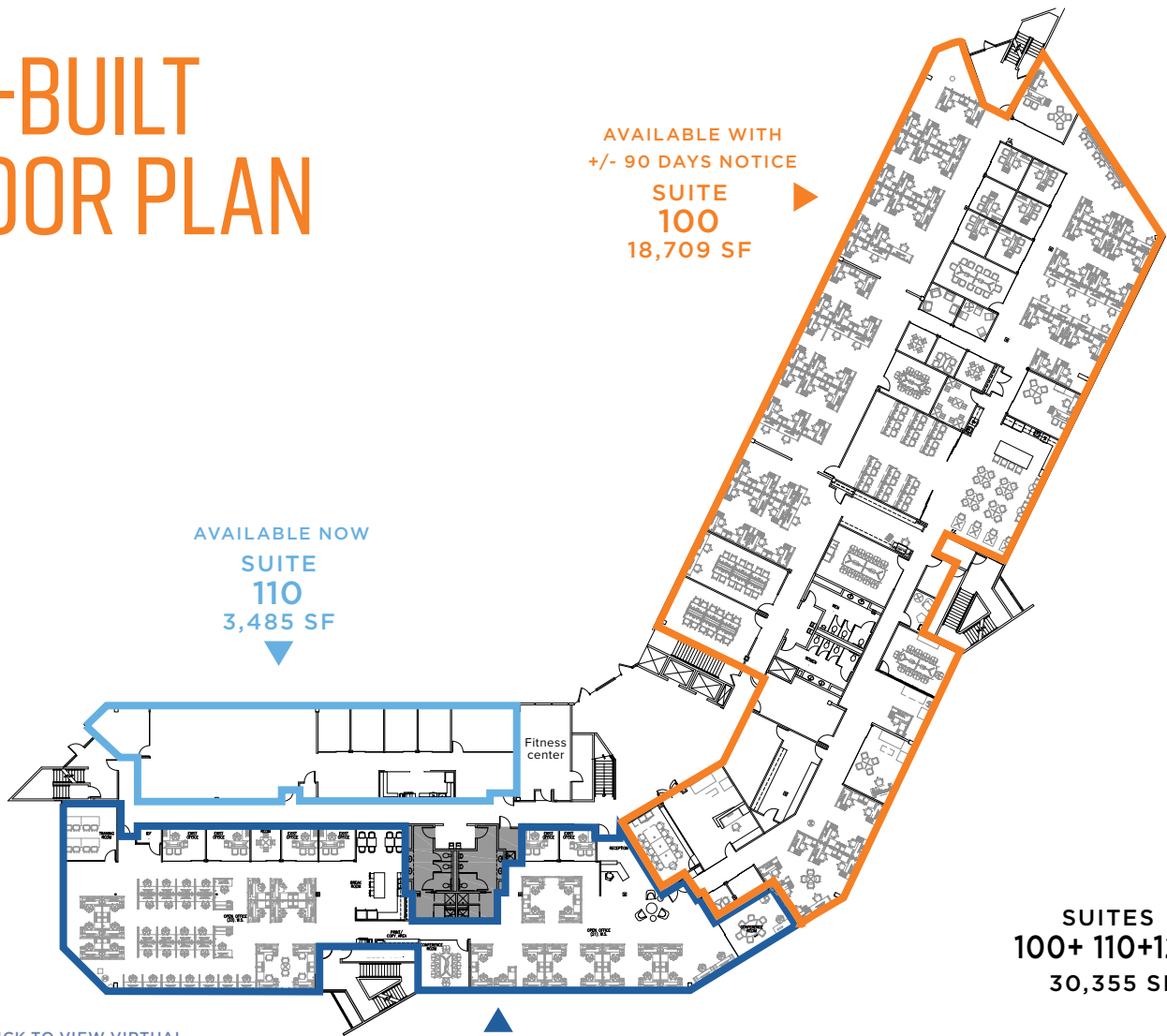

**SUITES
100+ 110+120**
30,355 SF



CLICK TO VIEW VIRTUAL
TOUR OF SUITE 120
*NEW RECEPTION AND KITCHEN
AREA NOT SHOWN ON VIRTUAL
TOUR

**SUITE
120**
8,161 SF

AVAILABLE 8/1/2025



Sam Ziemba
+1 425 974 4005
sam.ziemba@jll.com

Jake Bos
+1 425 974 4086
jake.bos@jll.com

Bailey Hallis
+1 425 974 4009
bailey.hallis@jll.com



DISCLAIMER © 2021 Jones Lang LaSalle IP, Inc.
All rights reserved. All information contained herein is from sources deemed reliable; however, no representation or warranty is made to the accuracy thereof. Jones Lang LaSalle Brokerage, Inc.