



DEMOGRAPHICS

	1 MILE	3 MILES	5 MILES
Total Households	5,230	39,863	97,410
Total Population	12,038	96,545	251,309
Average HH Income	\$67,349	\$66,889	\$74,684

AVAILABLE SPACES

SPACE	LEASE RATE	SIZE (SF)
Suite 250	\$15.00 SF/yr	4,989 SF

PROPERTY FEATURES

- Retail/Office Space for Lease
- Electric/Gas Separately Metered
- 1.5 Miles from Downtown Renton
- Tenants include, Circle Food's, Pizza Time, First Impressions Dental Care, Spoon-feed Training, and State Farm Insurance
- 15,500 VPD
- Professionally Managed

Goodale & Barbieri Company
818 West Riverside #300
Spokane, WA 99201
www.g-b.com

Clayton McFarland | Commercial & Leasing Manager
509.344.4929 // cmcfarland@g-b.com

Cory Barbieri | Vice President
509.344.4901 // cbarbieri@g-b.com



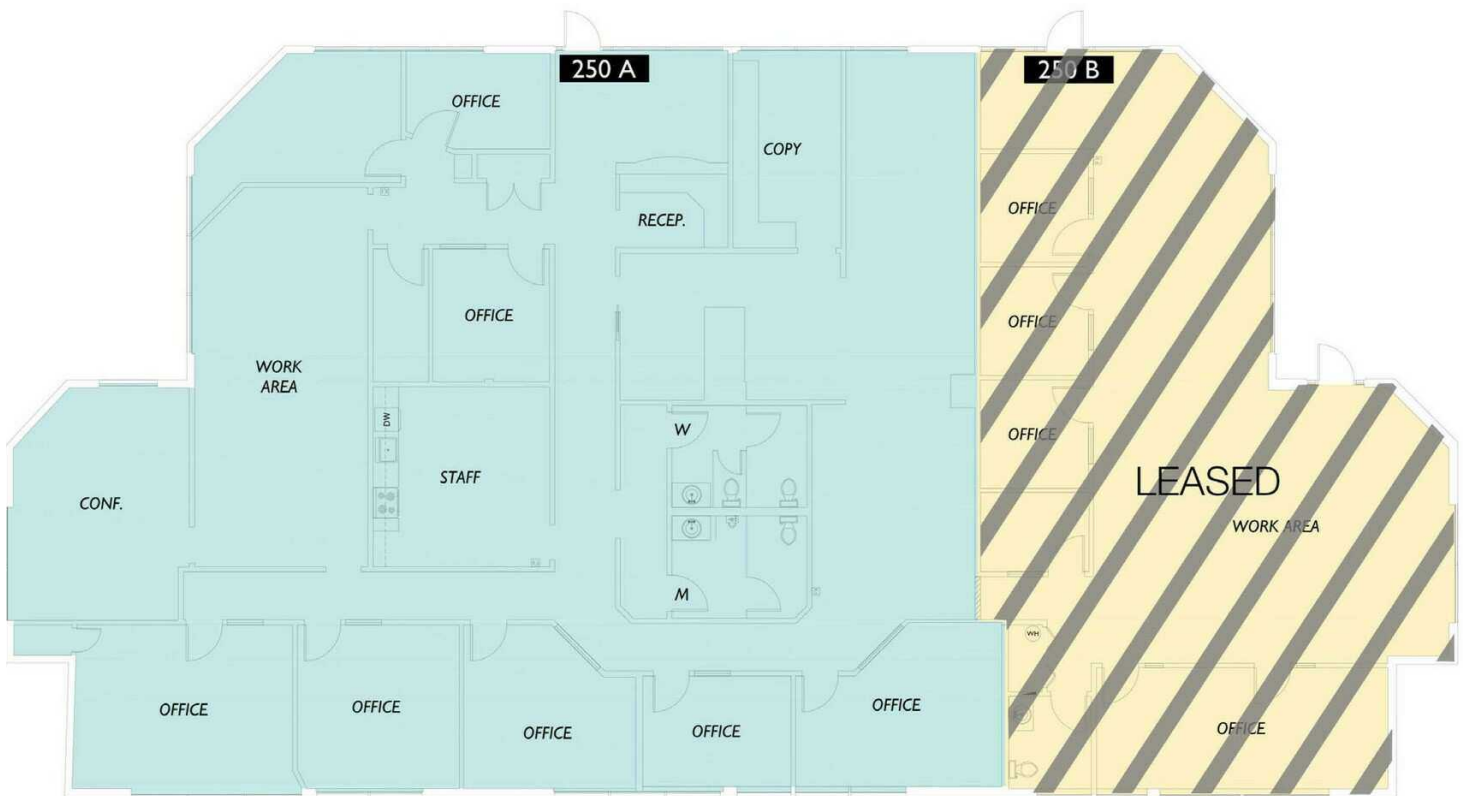

General Warranty Disclaimer: G&B makes no warranties, representations, or guarantees as to Seller/Owner's supplied information or the Property itself. G&B disclaims all warranties (express and implied) as to the Property and Seller/Owner's statements/information about the Property. Buyer/Lessee shall not rely on Property information supplied by Seller/Owner or G&B. Buyer/Lessee shall conduct its own due diligence to verify any information and the Property's suitability for specific intended purposes. Copyright information: G&B represents the intellectual Property of G&B and its Digital Millennium Copyright Act.

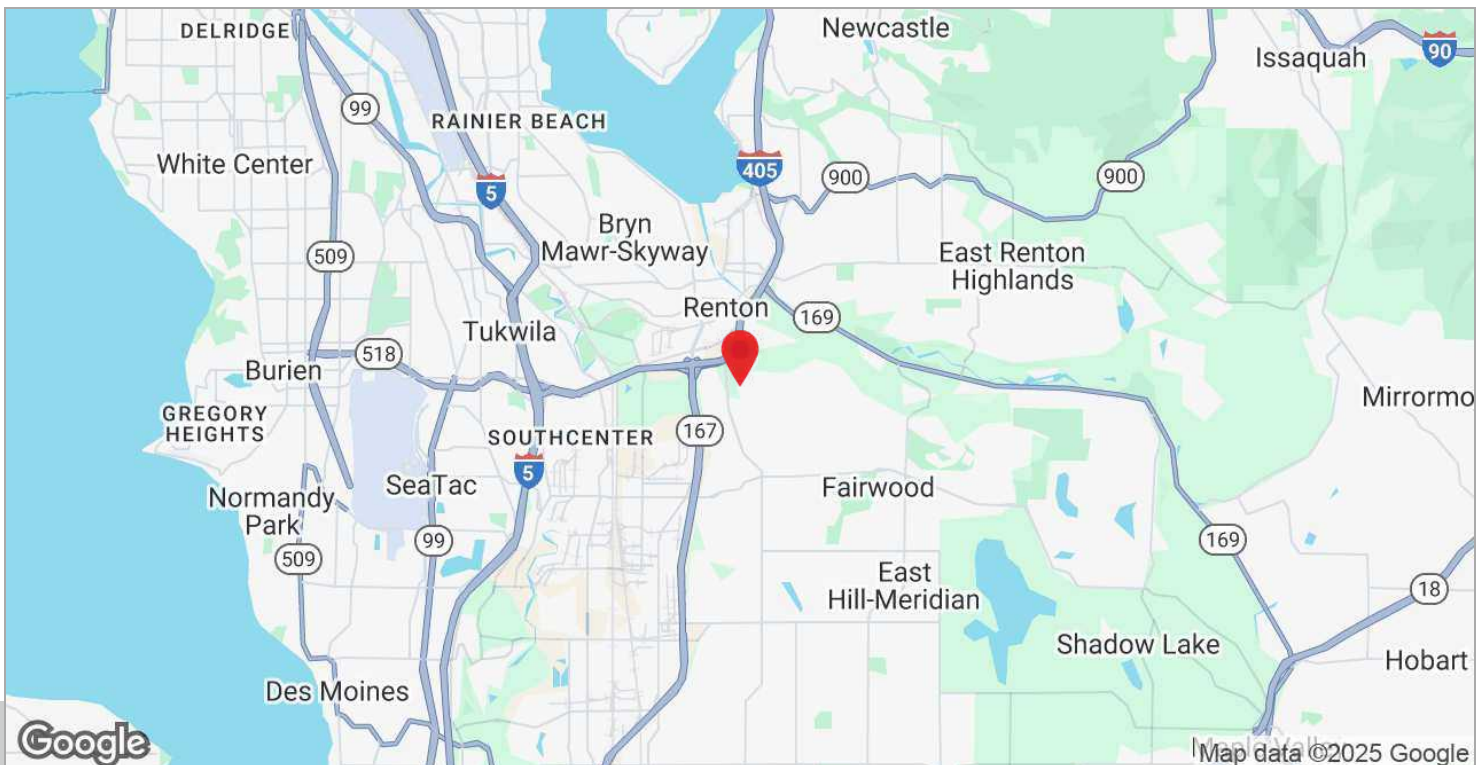
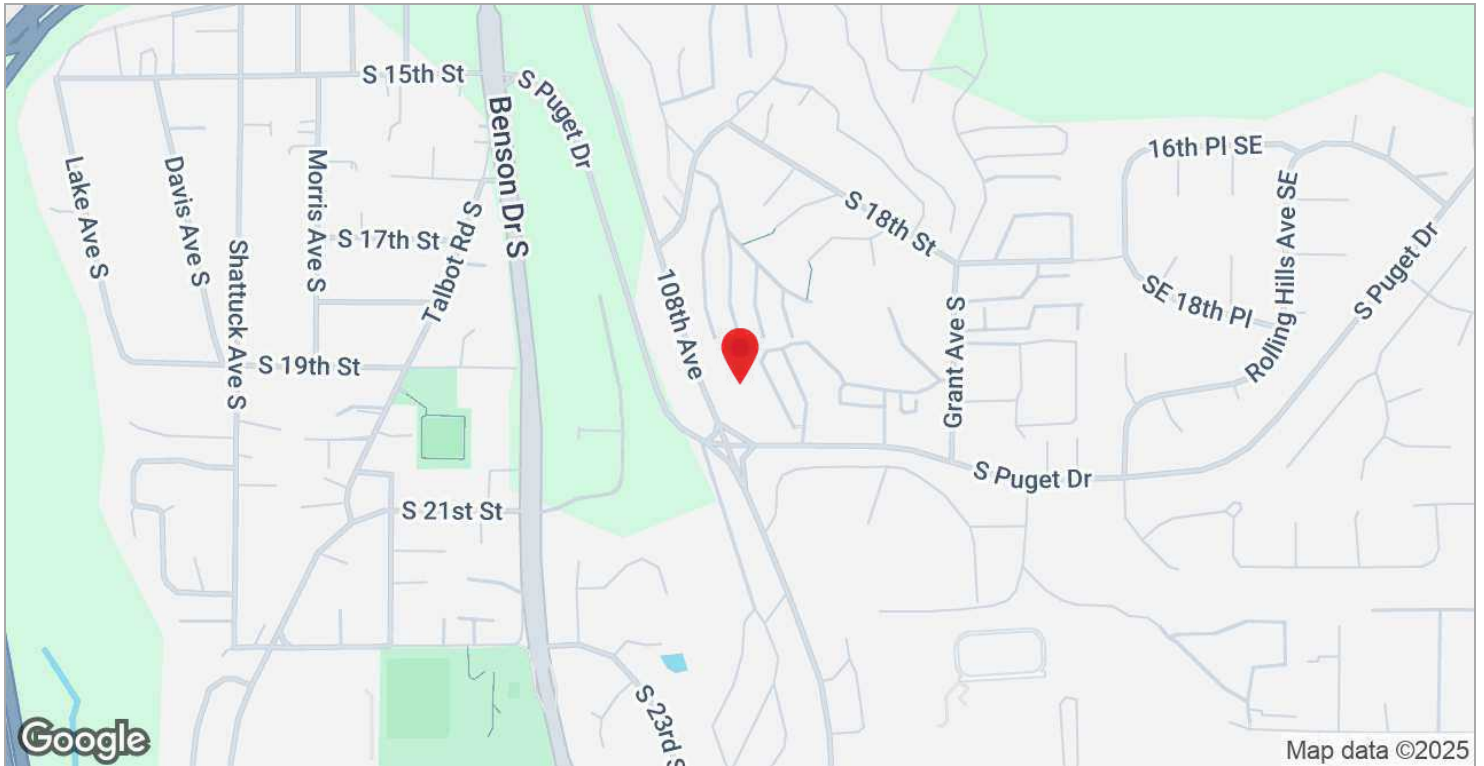

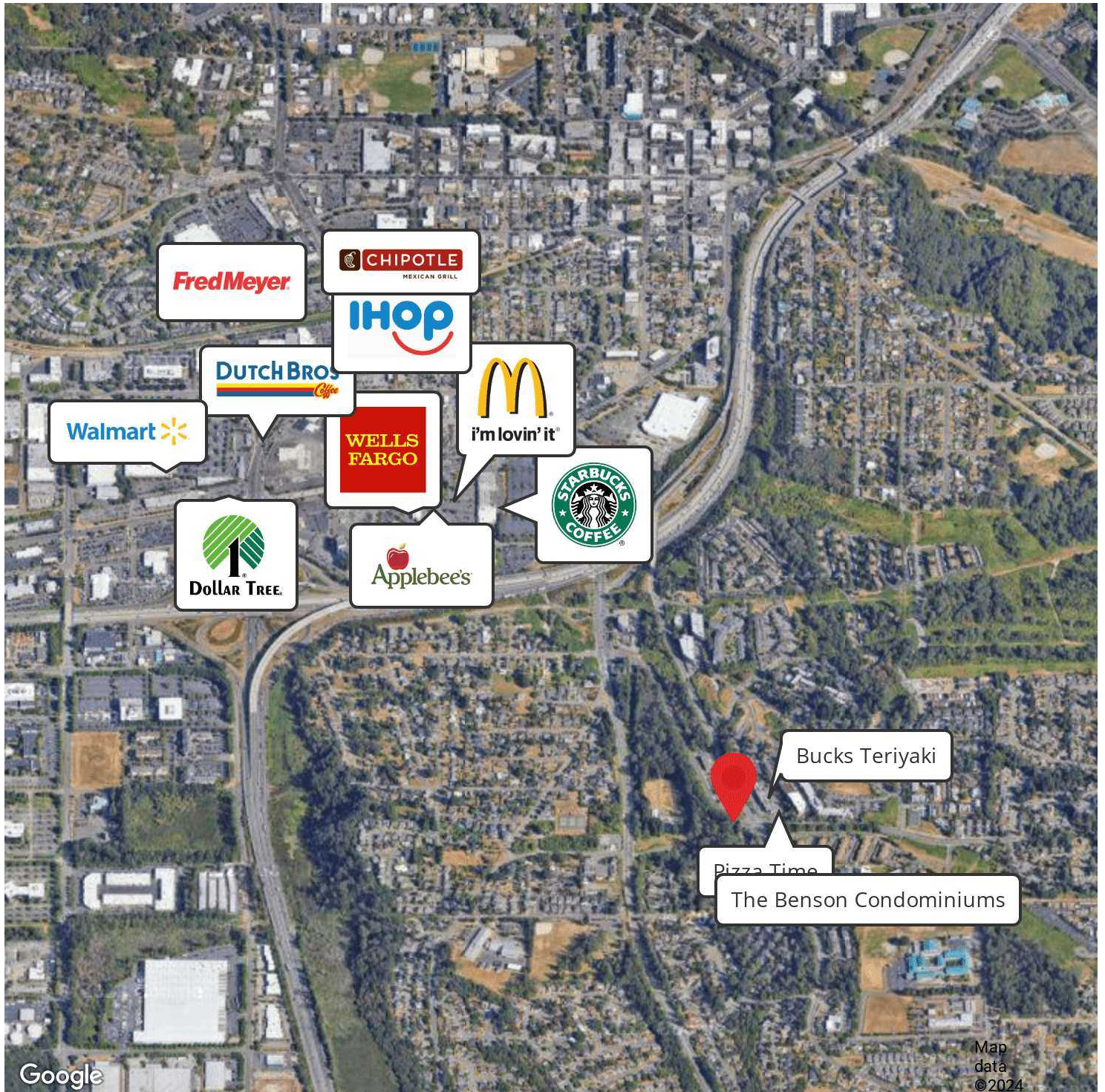

Google

Map
data
©2024

General Warranty Disclaimer: G&B makes no warranties, representations, or guarantees as to Seller/Owner's supplied information or the Property itself. G&B disclaims all warranties (express and implied) as to the Property and Seller/Owner's statements/information about the Property. Buyer/Lessee shall not rely on Property information supplied by Seller/Owner or G&B. Buyer/Lessee shall conduct its own due diligence to verify any information and the Property's suitability for specific intended purposes. Copyright information: G&B represents the intellectual property of G&B and its Digital Millennium Copyright Act.

Goodale & Barbieri Company
818 West Riverside #300
Spokane, WA 99201
www.g-b.com

Clayton McFarland | Commercial & Leasing Manager
509.344.4929 // cmcfarland@g-b.com

Cory Barbieri | Vice President
509.344.4901 // cbarbieri@g-b.com