

FOR LEASE

\$16.50 SF/YR
NNN \$3.85 PSF



MK BUSINESS PARK

2225 N Molter Rd

Liberty Lake, WA 99019

Exclusively listed by:

Bob Spooner
Senior Commercial and Leasing Manager
509.344.4903 | bob.spooner@g-b.com



Available Spaces – 2225 N Molter Rd

SPACE	RATE	SIZE	AVAILABLE
UNIT 100	\$16.50 SF/YR NNN	2,700 SF	DECEMBER 2025 (estimated)
UNIT 101-103	\$16.50 SF/YR NNN <i>Divisible to 1,800 SF and 3,600 SF</i>	5,400 SF	DECEMBER 2025 (estimated)
UNIT 107	\$16.50 SF/YR NNN	4,800 SF	LEASED

Available suites can be combined for total of 8,100 SQ FT

Bonus Loft Space at No Additional Cost

SPACE	RATE
UNIT 101	282 SF
UNIT 103	444 SF
UNIT 107	334 SF



Bob Spooner
Senior Commercial and Leasing Manager
509.344.4903 | bob.spooner@g-b.com



MK Business Park

AVAILABLE UNITS CAN BE COMBINED FOR TOTAL OF 8,100 SF

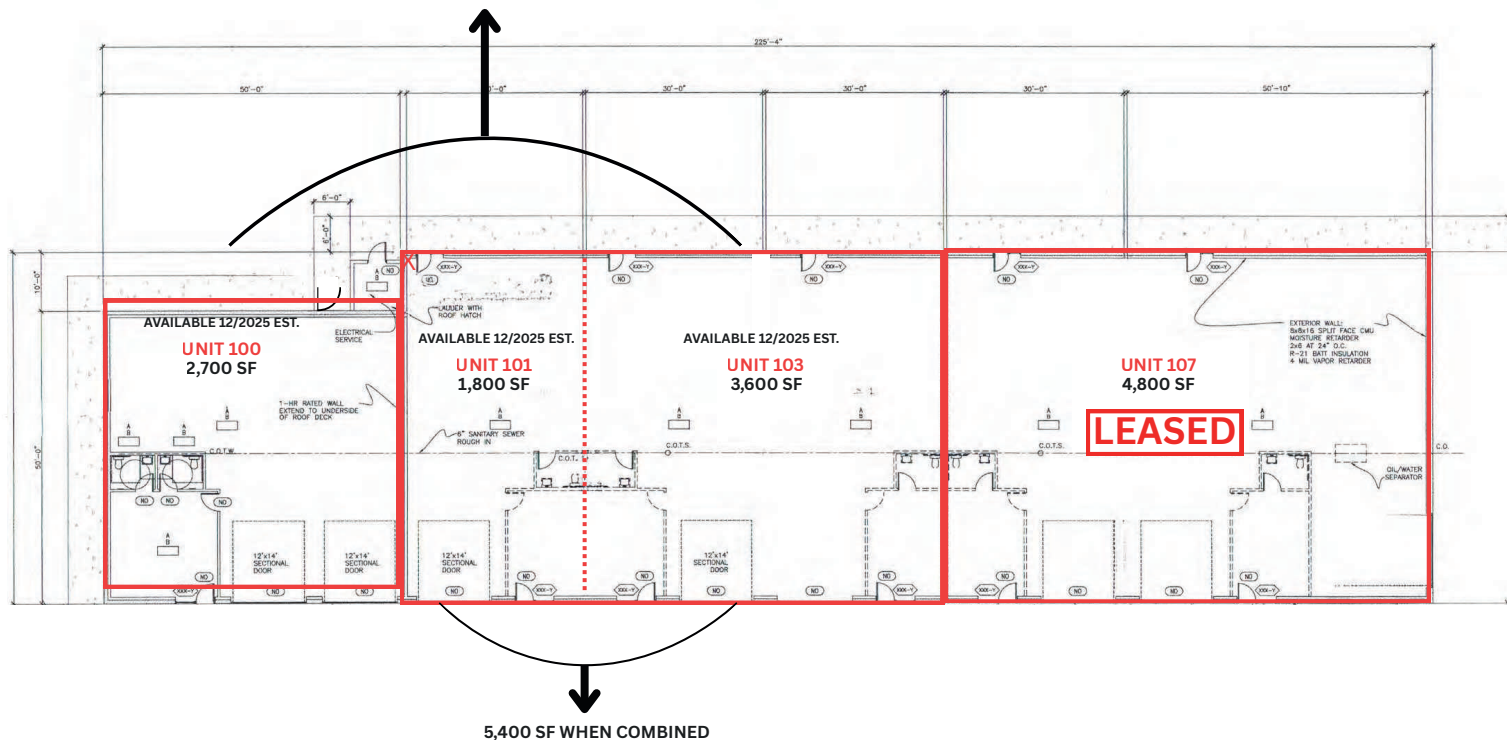

Overhead door dimensions: 13' wide x 14' tall

Ceiling height to trusses: 23' front sloping to 20' rear

Highlights



Zoned Light Industrial allowing for a wide variety of uses. <https://shorturl.at/b2OGp>



All units include built out restrooms with showers, office, lofts, and warehouse space

Bob Spooner
Senior Commercial and Leasing Manager
509.344.4903 | bob.spooner@g-b.com



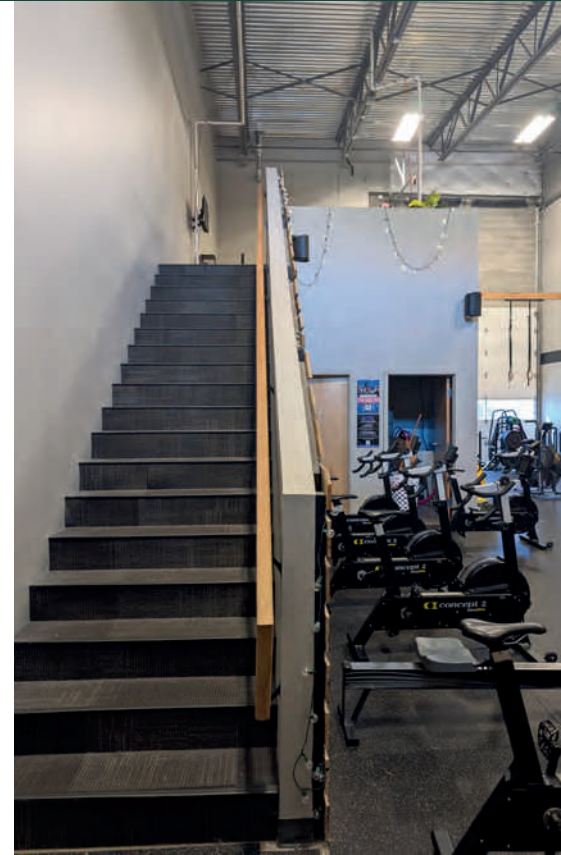

Bob Spooner
Senior Commercial and Leasing Manager
509.344.4903 | bob.spooner@g-b.com





AERIAL MAP

General Warranty Disclaimer: G&B makes no warranties, representations, or guarantees as to Seller/Owner's supplied information or the Property itself. G&B disclaims all warranties (express and implied) as to the Property and Seller/Owner's statements/information about the Property. Buyer/Lessee shall not rely on Property information supplied by Seller/Owner or G&B. Buyer/Lessee shall conduct its own due diligence to verify any information and the Property's suitability for specific or general purposes. Copyright information G&B respects the intellectual property of others and its Digital Millennium Copyright Act.

Bob Spooner
Senior Commercial and Leasing Manager
509.344.4903 | bob.spooner@g-b.com

