

FORMER RITE AID

8500 35th AVE NE
SEATTLE, WA 98115

PACIFIC ASSET ADVISORS, INC.

LISTING DETAILS

RENTABLE SF
26,853 SF

**CALL
FOR
RATE**

ADDRESS: 8500 35th Ave NE
Seattle, WA 98115

SQUARE FOOTAGE: 26,853 SF

PARKING: 53 Spaces Available (4 Handicap)

DEMOGRAPHICS:

	1 MILE	3 MILES	5 MILES
POPULATION	23,131	198,210	490,161
HOUSEHOLDS	9,458	85,485	223,377
AVERAGE HH INCOME	\$239,973	\$183,882	\$204,430
MEDIAN HH INCOME	\$183,508	\$135,145	\$146,831
DAYTIME POPULATION	10,139	109,303	301,654
MEDIAN AGE	39.8	34.5	36.6
BUSINESSES	959	9,422	28,522
EMPLOYEES	4,476	54,395	178,135

425.990.6200 | PAADVISORS.COM

SPACE PLAN

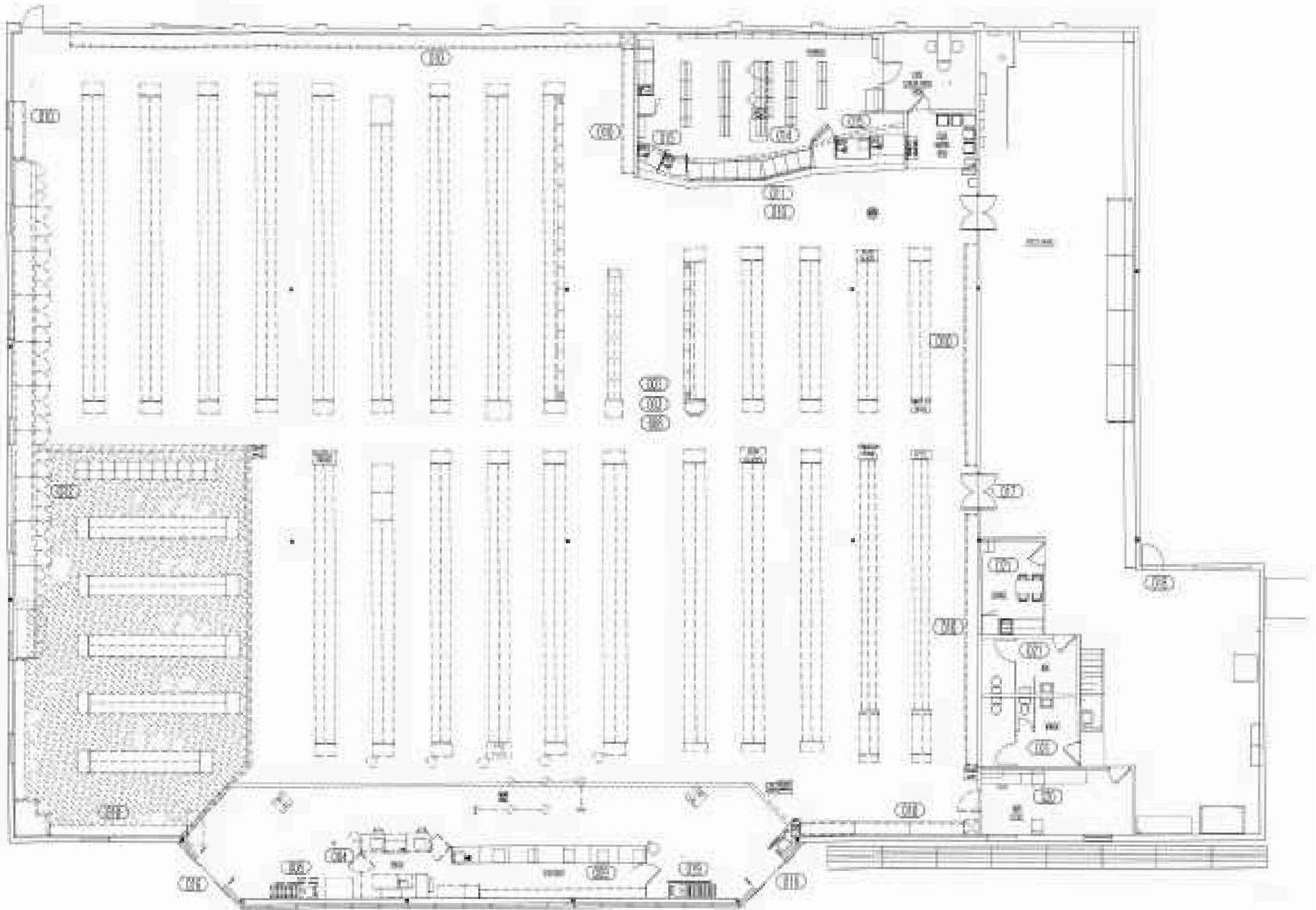

AERIAL

MAPLE LEAF
RESERVOIR PARK

WEDGWOOD
ELEMENTARY SCHOOL

WELLS
FARGO



BANK OF AMERICA

522

THORNTON CREEK
ELEMENTARY SCHOOL



ECKSTEIN
MIDDLE SCHOOL



TOPPOT
DONUTS

INTERSTATE
5



ROOSEVELT
HIGH SCHOOL

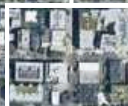

425.990.6200 | PAADVISORS.COM

CONTACT



ADAM GREENBERG
SENIOR VICE PRESIDENT
PARTNER
425.503.1339
ADAM@PAADVISORS.COM

PACIFIC ASSET ADVISORS, INC.
THE PREMIER CHOICE OF THE PACIFIC NORTHWEST

14205 SE 36TH ST, SUITE 215, BELLEVUE, WA 98006