

CEDAR BUSINESS PARK

*2,924 SF Warehouse Available for
Lease in Redmond's Sought-After
Industrial Submarket*

15319 NE 92ND ST, REDMOND, WA



KIDDER.COM

km Kidder
Mathews



Property Details

ADDRESS	15319-15339 NE 92nd St, Redmond
SUITE F	2,924 SF (dead warehouse)
LAND AREA	106,681 SF / 2.45 AC
YEAR BUILT	1980
PARKING	1.62 / 1,000 SF
ZONING	MP
CLEAR HEIGHT	18'
GL LOADING	Grade-level loading doors
POWER	3 phase, 1,000 amps, 120/208v

NOW
AVAILABLE

CALL
FOR LEASE RATES

FLOOR PLAN

CALL
FOR LEASE RATES

NOW
AVAILABLE

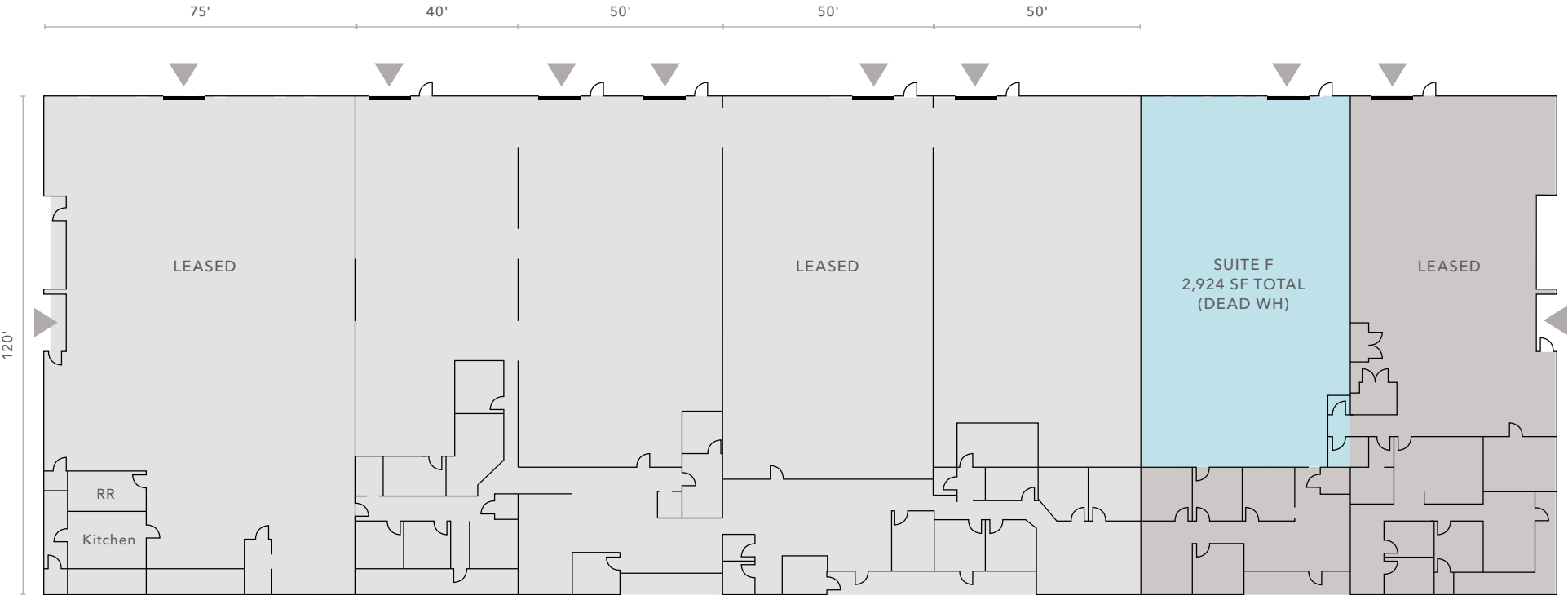

▲ Grade-level loading







CEDAR BUSINESS PARK

*For more information on
this property, please contact*

JASON BLOOM
425.450.1102
jason.bloom@kidder.com

TODD GAUTHIER
425.450.1118
todd.gauthier@kidder.com

KIDDER.COM

This information supplied herein is from sources we deem reliable. It is provided without any representation, warranty, or guarantee, expressed or implied as to its accuracy. Prospective Buyer or Tenant should conduct an independent investigation and verification of all matters deemed to be material, including, but not limited to, statements of income and expenses. Consult your attorney, accountant, or other professional advisor. All Kidder Mathews designs are the sole property of Kidder Mathews. Branded materials and layouts are not authorized for use by any other firm or person.

