

Ballard Place Condominiums

1545 NW 57th Street
Seattle, WA 98107



Corner Turn-Key Bar / Cafe
Available For Lease



Rare lease opportunity to save on upfront build out costs for your next cocktail/cafe/light food concept with this turn-key corner location!

Take advantage of existing infrastructure that includes bar seating, soaring 22'+ ceilings, remodeled kitchen prep area/fridge, great natural light, full HVAC, mezzanine for additional seating/storage and two shared restrooms at the base of Ballard Place, which is a 173 unit residential condominium building located within blocks of Market Street, Ballard Public Library, Ballard Commons Park.

The space measures a very manageable 2,154 SF with 1,534 SF on the ground floor plus 620 SF mezzanine.

Possible to add type 2 venting.

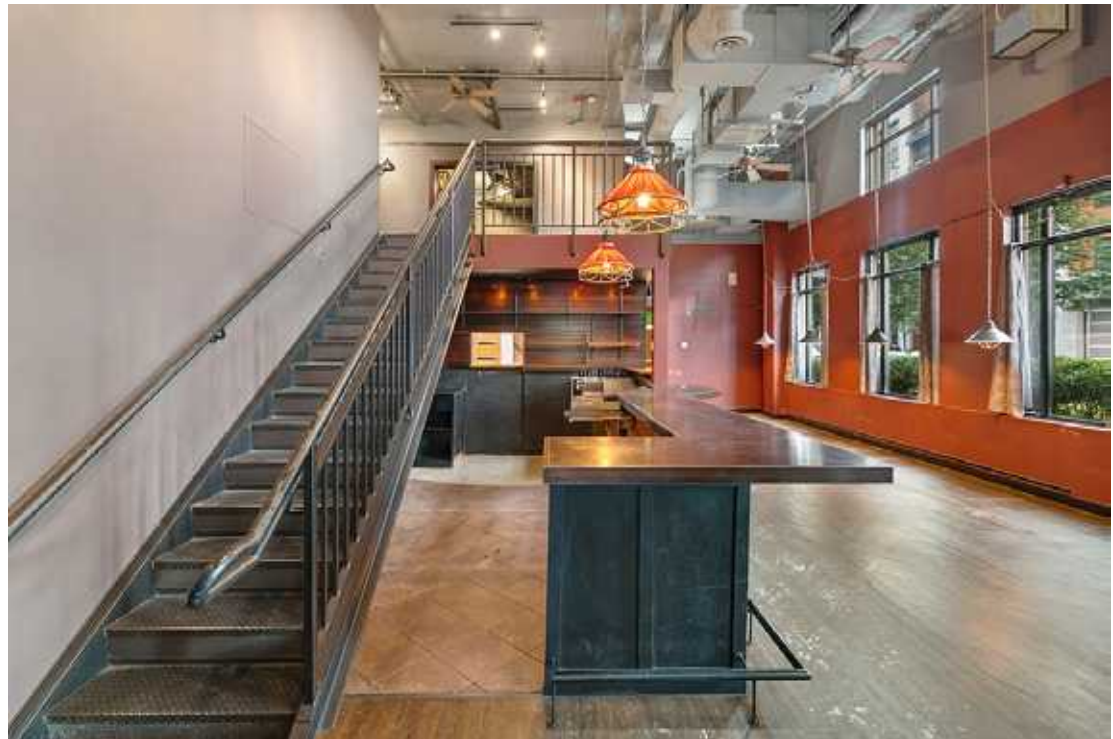

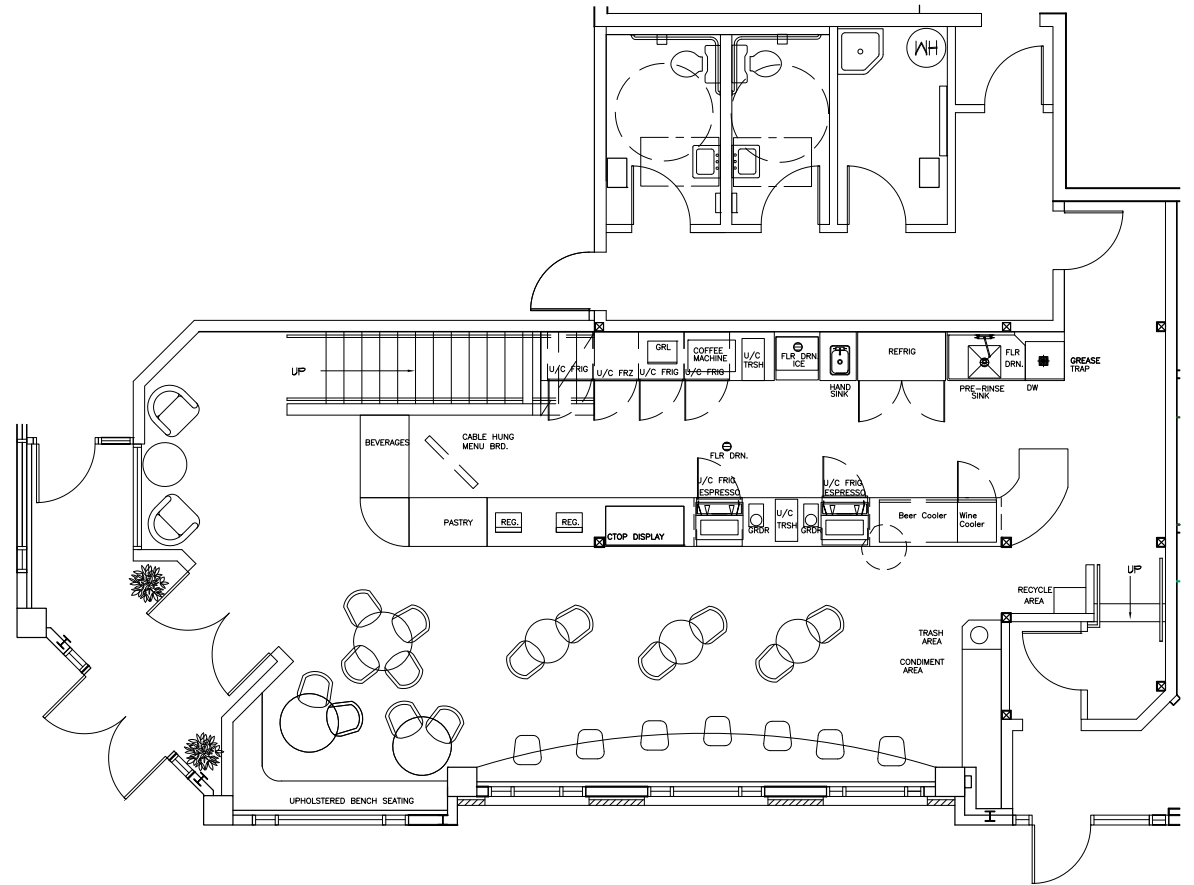



Ballard Place
Condominiums

usbank

TACO DEL MAR

MOD

TACO BELL

MAJESTIC BAY THEATRES

CHASE

SONIC BOOM
SEATTLE, WA

hot cakes
SOUTHERN CHOCOLATE PASTRY

Pep Boys

TOWN & COUNTRY
BALLARD MARKET

SAFEWAY

NW Market Street

Walgreens

KeyBank

SWEDISH

STONEBURNER

tractor

WHOLE PIES FAT SLICES
BALLARD PIZZA COMPANY

Hattie's Hat

STOUP
BREWING

URBAN FAMILY
BREWING CO.

Serious pie.

BEEREN'S BEERS
BEER UNBOUND

TRADER JOE'S

BevMo!

Fred Meyer

ROSS
DRESS FOR LESS

PCC
COMMUNITY MARKETS

LA FITNESS

Salmon Bay



Demographics

AVERAGE HOUSEHOLD INCOME

1-Mile: \$135,314

3-Mile: \$147,269

5-Mile: \$140,899

TOTAL POPULATION

1-Mile: 33,854

3-Mile: 206,068

5-Mile: 445,317



98
Walk Score
"Walker's Paradise"

TOTAL EMPLOYEES

1-Mile: 17,567

3-Mile: 81,635

5-Mile: 336,775



95
Bike Score
"Biker's Paradise"



Ballard Place Condominiums

1545 NW 57th Street
Seattle, WA 98107

Blake Taylor

blake@wccommercialrealty.com
206 931 0525

DISCLAIMER: The above information has been secured from sources believed to be reliable, however, no representations are made to its accuracy. Prospective tenants or buyers should consult their professional advisors and conduct their own independent investigation. Site plan and configuration are subject to change. Properties are subject to change in price and/or availability without notice. West Coast Commercial Realty, LLC



WCCR | West Coast
Commercial
Realty

206 283 5212
wccommercialrealty.com

