

Sand Point Village

5440 Sand Point Way NE,
Seattle, WA 98105

11,396 SF Anchor Space with demising options
Available For Lease

LEASED
BAKERY/CAFE
COMING SOON

Sand Point Way NE

This highly visible neighborhood retail center is located near Hawthorne Hills, Windermere, and Laurelhurst. This popular retail center has served local families for years, and will continue to do so! Join a strong lineup of established tenants, including Sand Point Grill, Windermere Real Estate, Uncle Lee's Chinese Restaurant, and Katterman's Sand Point Pharmacy. This is a fantastic opportunity to position your business in a well-loved community hub.

Highlights:

- Ample parking
- Anchor Space
- Excellent visibility on Sand Point Way with 15,191 average daily traffic counts
- Average household income within a 1 mile radius is \$203,005
- Total Population of 135,605 within a radius of 3 miles



FULL FLOOR PLAN

Available Space

11,396 SF

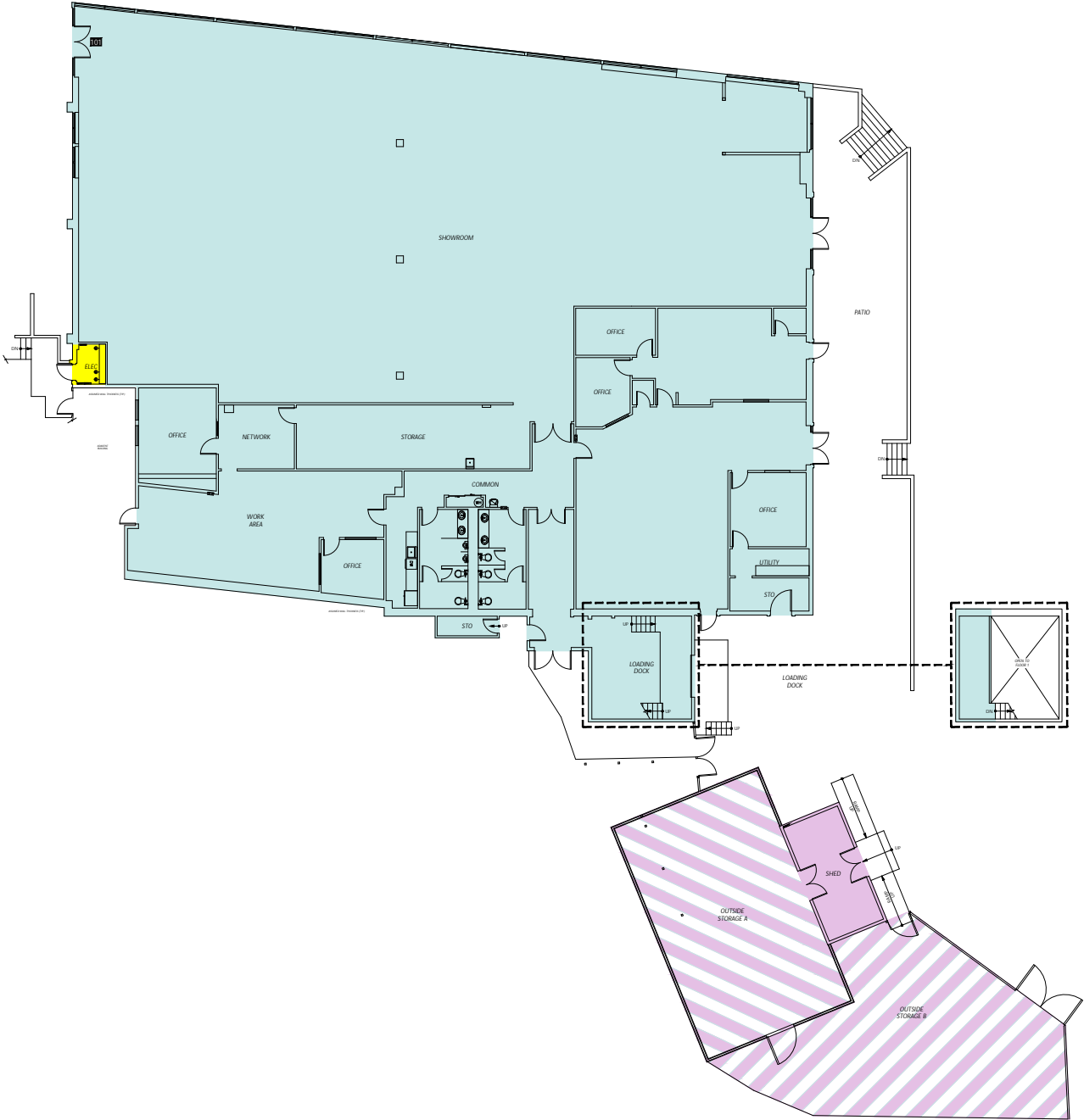

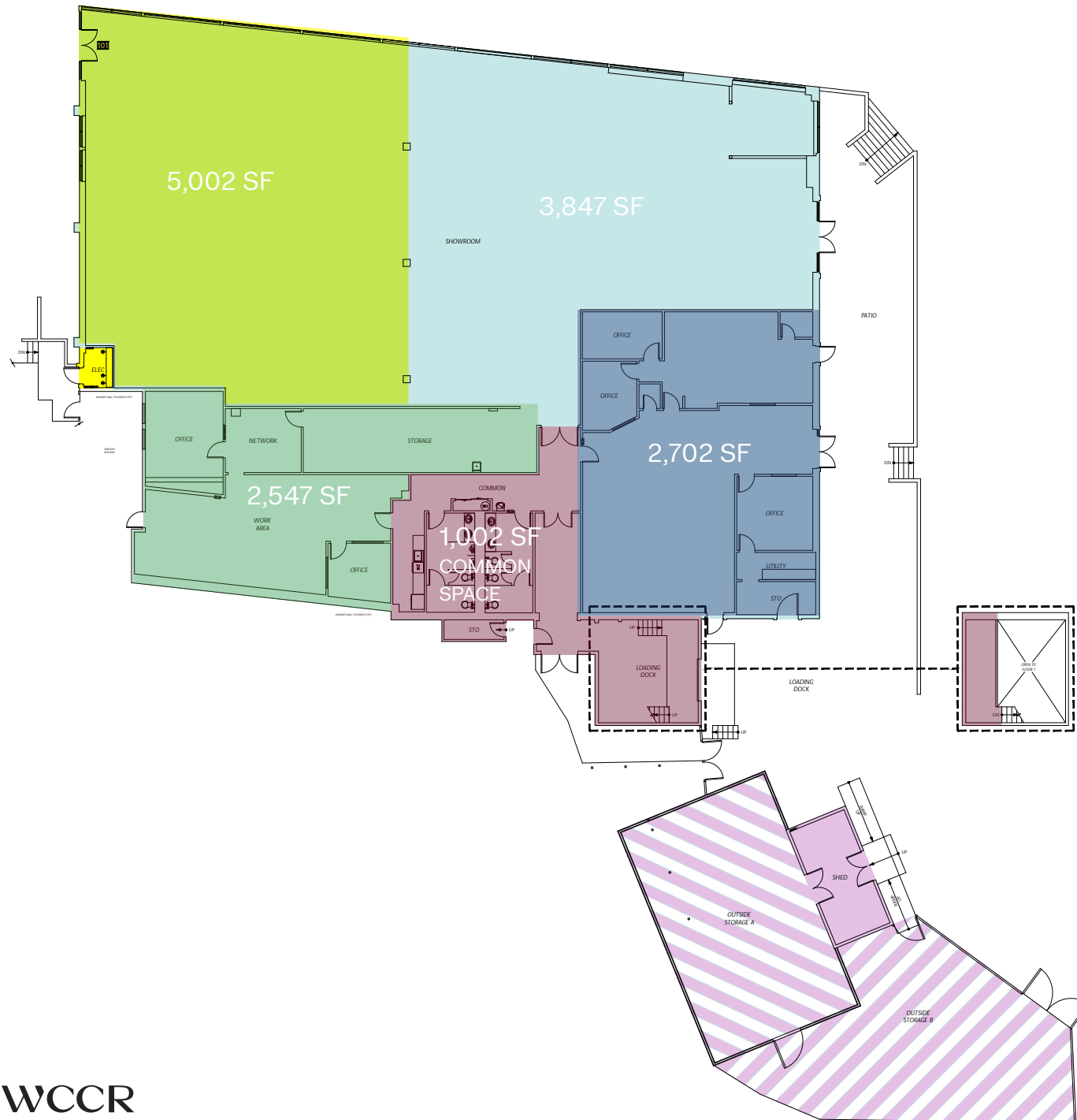

- 5,002 SF
- 3,847 SF
- 2,547 SF
- 2,702 SF

UNIVERSITY VILLAGE

Apple Crate&Barrel
 SEPHORA Marine Layer MUDBAY
 POTTERY BARN RIVIAN
 RH BARTELL DRUGS
 WILLIAMS-SONOMA
 Room&Board
 SHAKE SHACK CB2 THE NORTH FACE
 RACHEL'S GINGER BEER BA BAR STARBUCKS MR WEST

RETAIL FOR LEASE
 5440 Sand Point Way NE W Seattle, WA 98015

Warren G. Magnuson Park

PAGLIACCI PIZZA

Katterman's
 SAND POINT PHARMACY

metropolitanmarket. (m)

NATIONAL ARCHIVES

Sand Point Way NE

True Value

QFC
 Quality Food Centers

SAFEWAY

general purposes

BURGERMASTER

Seattle Children's

W
 UNIVERSITY of WASHINGTON

Lake Washington

LEASED
BAKERY/CAFE
COMING SOON

11,396 SF
ANCHOR SPACE
AVAILABLE FOR LEASE
(WILL DEMISE)

5440 Sand Point Way NE w Seattle, WA 98015

VILLAGE
PHYSICAL THERAPY

76

University
WINES

Katterman's
SAND POINT PHARMACY

UNCLE
Lee's
高北小馆

Stacy Earlywine
Structural Medicine

Sand Point Way NE

Windermere

SAND
POINT
GRILL

WCCR

West Coast Commercial Realty





5440 Sand Point Way NE, Seattle, WA 98105

Tiffini Connell

tiffini@wccommercialrealty.com
206 854 1925

Riley Gill

rileyg@wccommercialrealty.com
206 799 0199

WCCR | West Coast
Commercial
Realty

DISCLAIMER: The above information has been secured from sources believed to be reliable, however, no representations are made to its accuracy. Prospective tenants or buyers should consult their professional advisors and conduct their own independent investigation. Site plan and configuration are subject to change. Properties are subject to change in price and/or availability without notice. West Coast Commercial Realty, LLC



206 283 5212

wccommercialrealty.com