

FOR LEASE

PIER 54

*8,235 SF Restaurant Space Available
in Seattle's Waterfront District*

1001 ALASKAN WAY, SUITE 109, SEATTLE, WA

PROPERTY HIGHLIGHTS



Premier Location

Located on Seattle's waterfront, adjacent to the newly developed Seattle Waterfront Park and the Washington State Ferry Terminal, Pier 54 presents a prime destination.



Accessibility

Pier 54 is easily accessible by foot, bike, public transport, and by boat, making it convenient for both locals and tourists alike.



Scenic Views

Overlooking Elliott Bay, Pier 54 offers stunning waterfront views, providing an unforgettable ambiance that few locations can match.

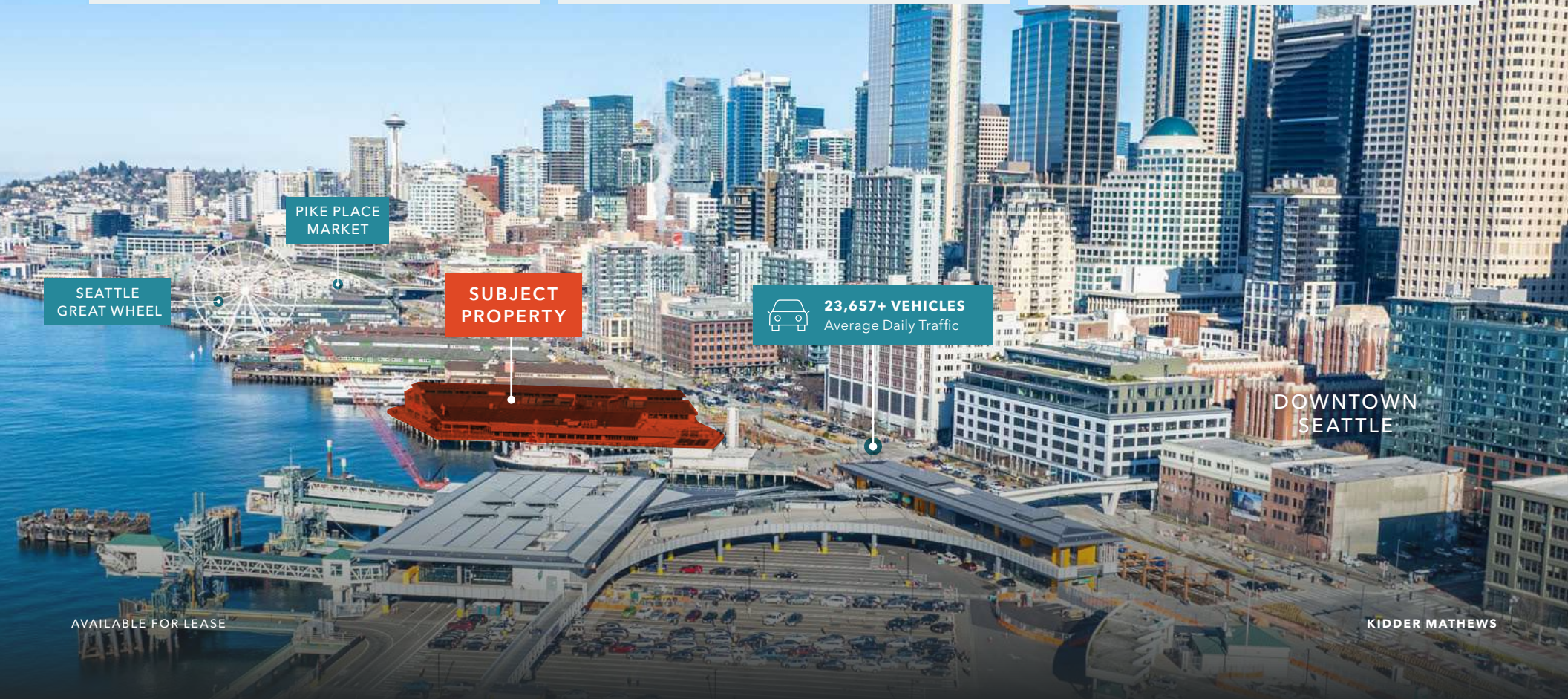

SEATTLE
GREAT WHEEL

PIKE PLACE
MARKET

SUBJECT
PROPERTY



23,657+ VEHICLES
Average Daily Traffic

DOWNTOWN
SEATTLE

PIER 54



AVAILABLE FOR LEASE

KIDDER MATHEWS

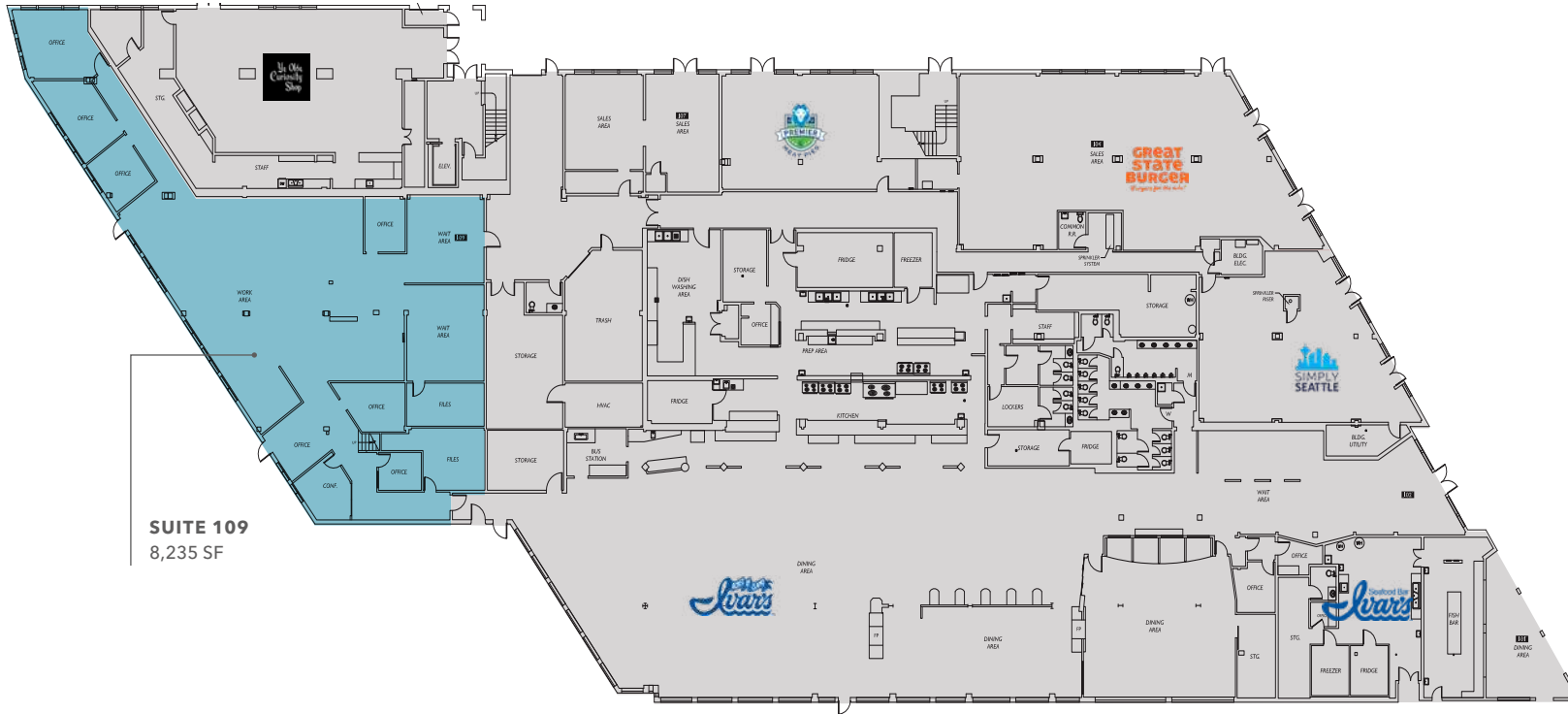

SUITE 109
8,235 SF

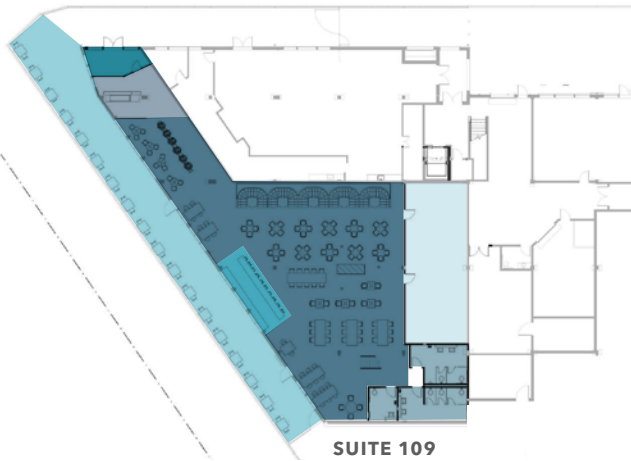

SUITE 109

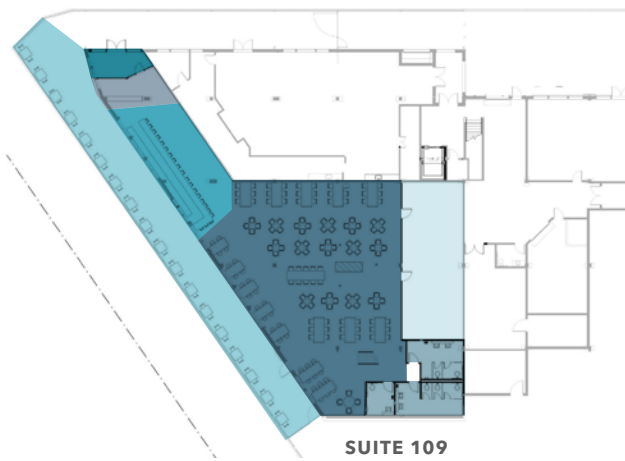

SUITE 109

Legend

- Vestibule
- Lobby
- Bar
- Open Dining
- Kitchen
- Restrooms
- Outdoor



SEATTLE'S NEW WATERFRONT

After six decades of disconnect between the Seattle urban core and its waterfront, a bold vision and partnership is transforming 26 city blocks along Elliott Bay. Waterfront Seattle is a \$1.07 billion project (and just a portion of the \$3.3 billion larger transformation which included the viaduct removal). It represents a partnership between the City of Seattle and its citizens to remedy the disconnect. With over 10,000 community members weighing in on the ambitious project, it is truly a collective effort.

Since completing the demolition of the State Route 99 viaduct, a psychological and physical barrier to the waterfront has been removed and shepherded in a great opportunity for improvements. Upon completion in 2025, Seattle will have a unified downtown district with open spaces, bike and running lanes, an updated ferry terminal, and seismic seawall.

ACCESSIBILITY

Transforming Seattle's waterfront is a welcome boost for accessibility in many ways. Replacing the viaduct with an underground tunnel and an overlook pedestrian bridge integrates districts like Pioneer Square and the iconic Pike's Place Market with the waterfront. In addition, the visionaries have paid special attention to providing state of the art ADA accessibility. Curb ramps, elevators and detectable pavers will provide a safer waterfront. Improved street connections will ease vehicle congestion and, offer more accessibility to ferries, SeaTac airport, and Union Station.

8M

ANNUAL VISITORS

1.07B

REDEVELOPMENT
PROJECT

\$400M

ANNUAL
BUSINESS REVENUE

SEATTLE'S *ROBUST* CRUISE SHIP OPERATIONS

The Port of Seattle said it expects 299 vessel calls and 1.9 million revenue passengers during the 2025 cruise season.

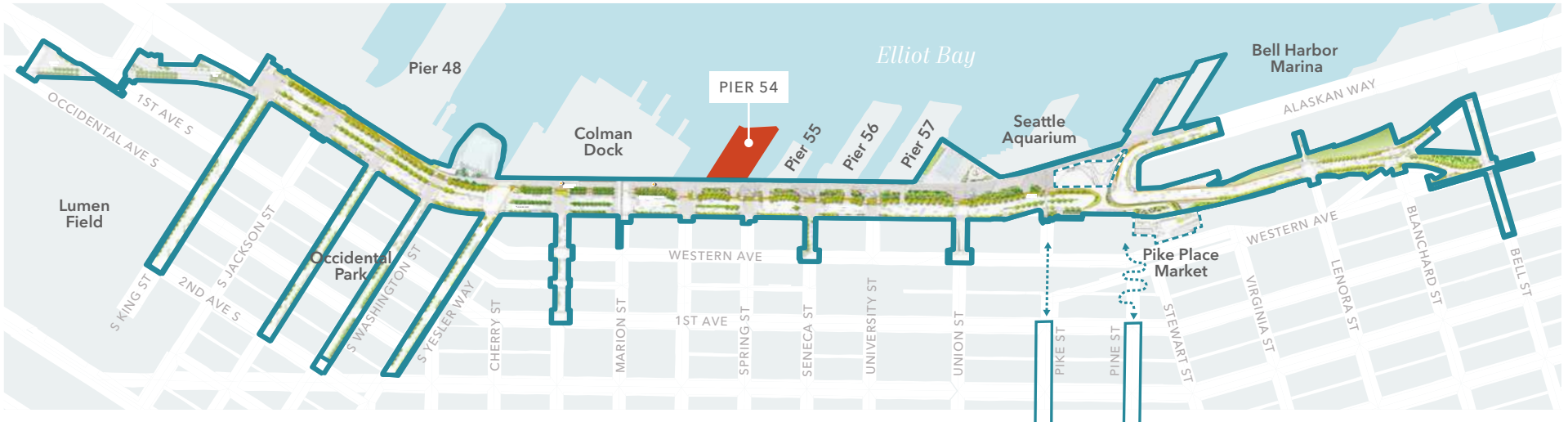

CONNECTED GROWTH

At the core of the waterfront project is the Park Promenade which is a linear park providing a new pedestrian connection meandering from Pier 48 to the Seattle Aquarium, which will enjoy an ambitious makeover in the last phase of the project. The promenade will feature permanent art exhibits while highlighting existing attractions like the Seattle Great Wheel, Miner’s Landing, and rebuilt Pier 62.

The 20 acres of open space will attract cultural events and visitors year-round. Additionally, the unification of the waterfront and downtown district makes cultural destinations like Benaroya Hall, T-Mobile Park, and Lumen Field more accessible. Undoubtedly, the Seattle waterfront will be a civic gem when the project reaches completion in 2025.

Pioneer Square will be connected to the new waterfront via new pedestrian and landscape improvements on four of their main east/west streets.



PIER 54

Exclusively leased by

JASON MILLER

First Vice President

206.296.9649

jason.miller@kidder.com

KELLY GADDIS

Senior Vice President

425.450.1136

kelly.gaddis@kidder.com

MIA PONCE

Senior Associate

425.450.1137

mia.ponce@kidder.com

KIDDER.COM

This information supplied herein is from sources we deem reliable. It is provided without any representation, warranty, or guarantee, expressed or implied as to its accuracy. Prospective Buyer or Tenant should conduct an independent investigation and verification of all matters deemed to be material, including, but not limited to, statements of income and expenses. Consult your attorney, accountant, or other professional advisor. All Kidder Mathews designs are the sole property of Kidder Mathews. Branded materials and layouts are not authorized for use by any other firm or person.

