



FOR SUBLEASE 65,119 SF

919 N Levee Rd
Puyallup, WA

Thad Mallory, SIOR
t 425-362-1410
thad.mallory@nrmk.com

NEWMARK

Property Details

65,119 Total SF (6,772 SF Office - two stories)

Building Shell of 62,040 SF

24' Clear Height

10 Dock High Doors & 2 Grade Level Doors

ESFR Sprinklers

Available October 1, 2025

Master Lease Expires January 31, 2027

Rate: \$0.94 PSF Blended, NNN



**Freestanding
Building**



**Rapid Access to SR 167
and the Port of Tacoma**



FOR SUBLEASE 65,119 SF

919 N Levee Rd
Puyallup, WA

Thad Mallory, SIOR
t 425-362-1410
thad.mallory@nmrk.com

NEWMARK

Floor Plan

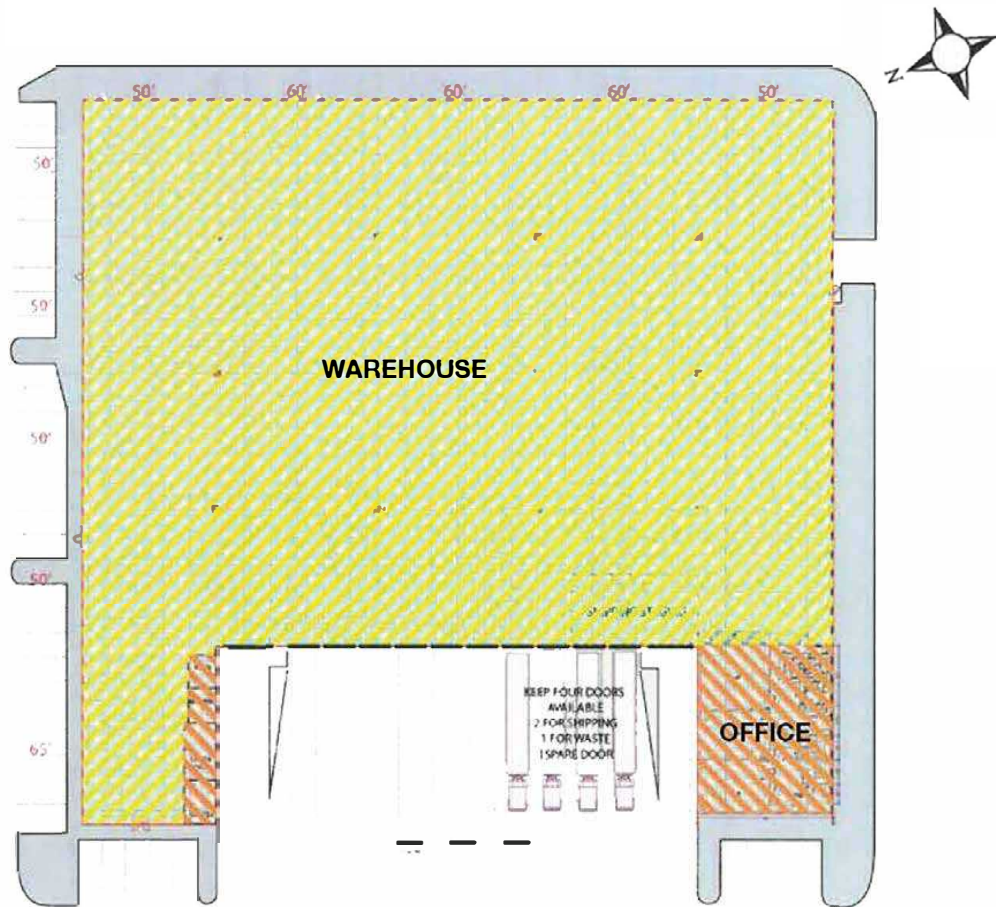



FOR SUBLEASE 65,119 SF

919 N Levee Rd
Puyallup, WA

Thad Mallory, SIOR
t 425-362-1410
thad.mallory@nmrk.com

Aerial Views



NEWMARK

The distributor of this communication is performing acts for which a real estate license is required. The information contained herein has been obtained from sources deemed reliable but has not been verified and no guarantee, warranty or representation, either express or implied, is made with respect to such information. Terms of sale or lease and availability are subject to change or withdrawal without notice.