

1402

PUYALLUP STREET

SUMNER, WA 98039



AVAILABLE FOR LEASE

58,056 SF STANDALONE FACILITY WITH YARD



CBRE

PROPERTY FEATURES



BUILDING SIZE

58,056 SF BUILDING WITH
APPROXIMATELY 8,000 SF
FINISHED TWO-STORY OFFICE



YARD AREA

APPROXIMATELY 2-ACRE
FENCED AND PAVED YARD
SITE COVERAGE: 26%



DOORS

13 DOCK-HIGH DOORS
2 GRADE-LEVEL DOORS



ACCESSABILITY

EASY ACCESS TO HWY 167
VIA 24TH STREET E



PARCEL SIZE

4.59 ACRE PARCEL (200,012 SF)



CLEAR HEIGHT

CLEAR HEIGHT: 24'



PIT LEVELERS

6 PIT LEVELERS WITH
DOCK SEALS



RATES

CALL BROKER FOR
LEASE RATES



SITE PLAN

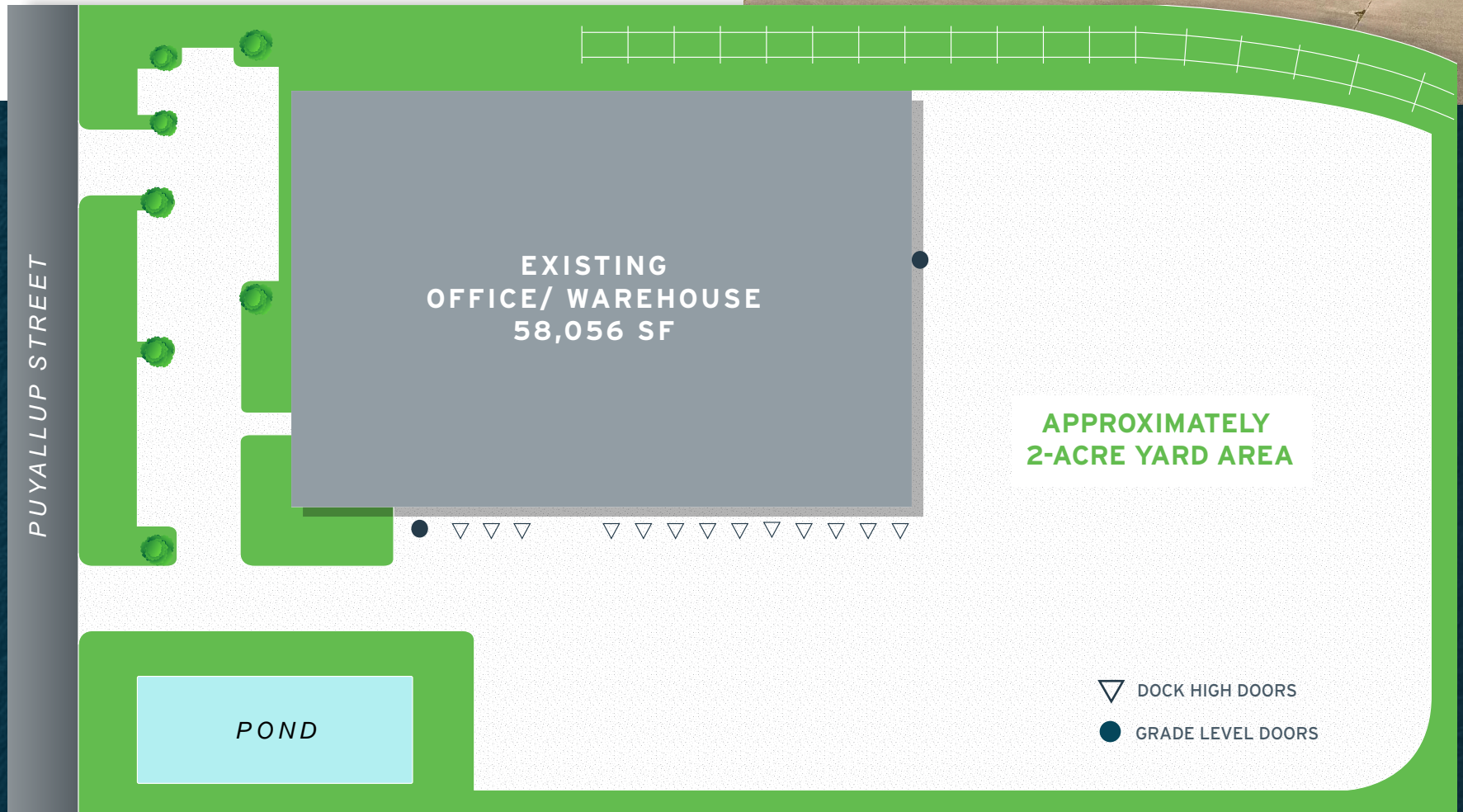

PROPERTY FLOORPLANS

58,056 SF STANDALONE FACILITY WITH YARD

1ST FLOOR

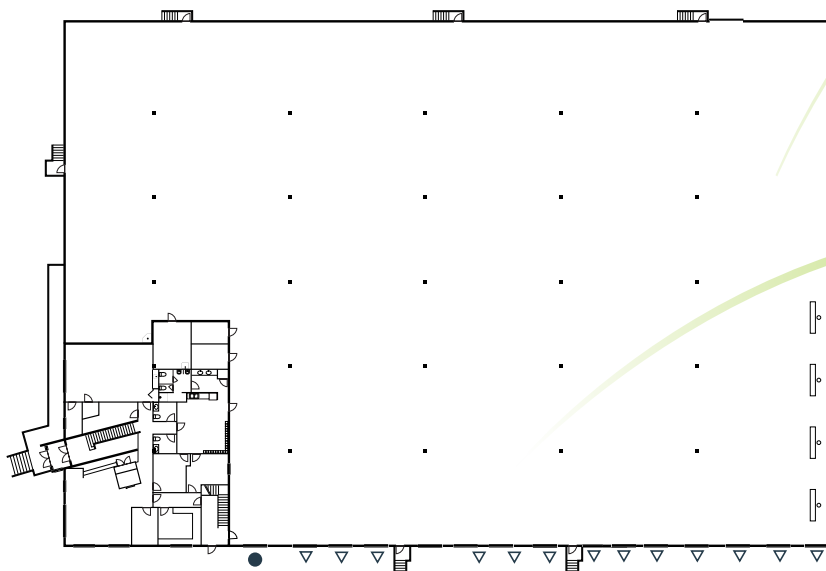

1ST FLOOR
DETAIL



2ND FLOOR DETAIL



- ▽ DOCK HIGH DOORS
- GRADE LEVEL DOORS

LOCATION MAP

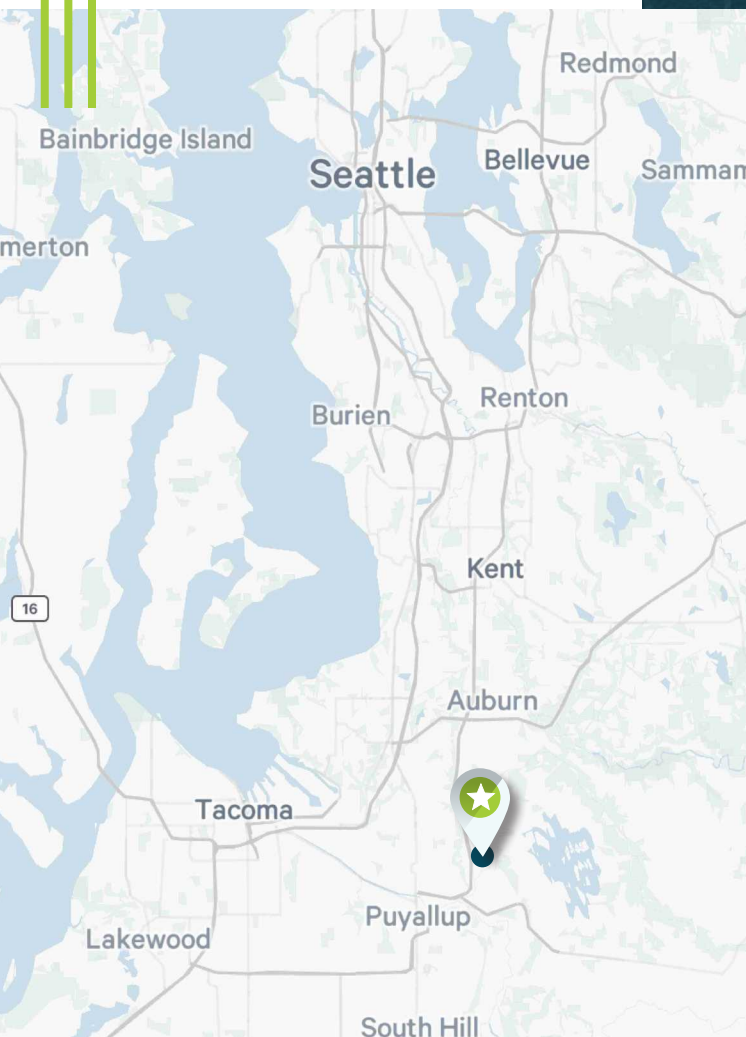

MILES TO/FROM PROPERTY

12 MILES
TO TACOMA

19 MILES
TO SEATAC AIRPORT

20 MILES
TO SOUTHCENTER

35 MILES
TO SEATTLE

30 MILES
TO BELLEVUE

1402

PUYALLUP STREET

SUMNER, WA 98039

BROKER CONTACT:

ANDREW HITCHCOCK

Executive Vice President

+1 206 442 2719

andrew.hitchcock@cbre.com

OWNER CONTACT:

JOHN QUINN

Senior Regional Director

+1 805 906 4091

jquinn@firstindustrial.com



CBRE

© 2025 CBRE, Inc. All rights reserved. This information has been obtained from sources believed reliable but has not been verified for accuracy or completeness. CBRE, Inc. makes no guarantee, representation or warranty and accepts no responsibility or liability as to the accuracy, completeness, or reliability of the information contained herein. You should conduct a careful, independent investigation of the property and verify all information. Any reliance on this information is solely at your own risk. CBRE and the CBRE logo are service marks of CBRE, Inc. All other marks displayed on this document are the property of their respective owners, and the use of such marks does not imply any affiliation with or endorsement of CBRE. Photos herein are the property of their respective owners. Use of these images without the express written consent of the owner is prohibited. MK_APRIL'25