

FOR LEASE

1353 Olney Ave SE,
Port Orchard, WA 98366

CLICK FOR MAP



First Western Properties—Tacoma Inc. | 253.472.0404
6402 Tacoma Mall Blvd, Tacoma, WA 98409 | fwp-inc.com

BI-MART & TRACTOR SUPPLY CO-TENANCY

Tim Weber | Blake Weber | Don Whittles | Ned Whalen



AVAILABLE:

SUITE 131 19,378 SF \$12.00 PSF \$2.08 NNN

SUITE 117 2,800 SF \$18.00 PSF \$3.00 NNN

*FORMER PAYLESS SHOES

- Close proximity to Bremerton Naval Base Bangor & Ferry Terminal
- Just a few miles from Hwy 16 & SR 3
- Pylon signage



Regis - 2023

Population



Average HH Income



Daytime Population

Mile 1

8,144

\$108,827

4,700

Mile 3

51,665

\$106,186

28,247

Mile 5

105,599

\$109,479

60,898

TENANTS

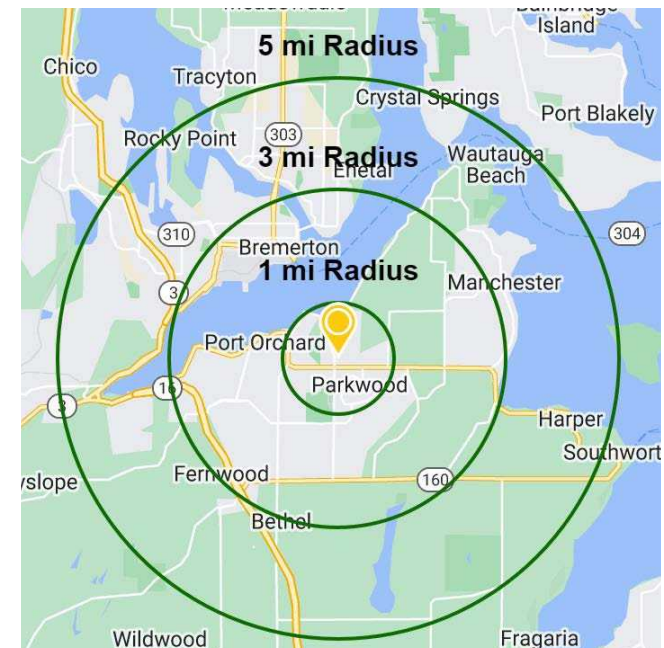

Anchors

Suite #	Tenant	SF
101	Bi-Mart	35,860
131	AVAILABLE	19,378
201	Tractor Supply	42,203

Shops

Suite #	Tenant	SF
101	R & E Kenady Restaurant	5,762
109	Medworx	1,400
111	Cat's Meow	1,346
115	Delapena	2,800
117	AVAILABLE	2,800

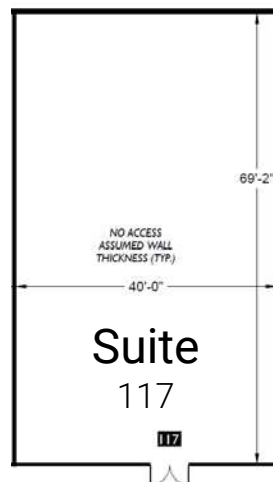



LOCATION DETAILS



5,800 CPD
Olney St SE



18,779 CPD
Mile Hill Dr



Located in the Port
Orchard Retail Core



Located moments from
HWY 16 & SR 3



LOCATION AERIAL



FIRST
WESTERN
PROPERTIES

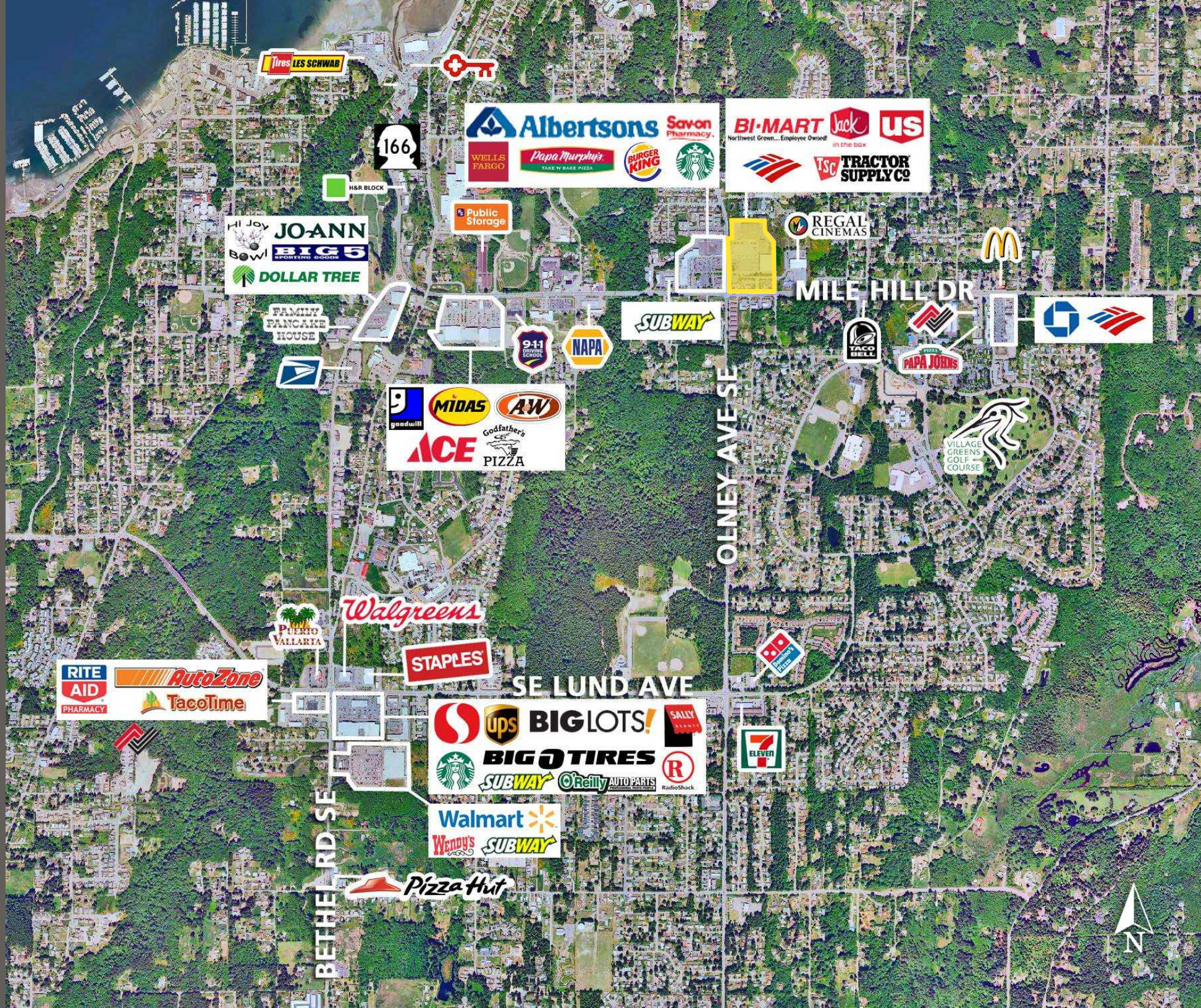

Tires LES SCHWAB



166

Albertsons Savon Pharmacy
WELLS FARGO Papa Murphy's BURGER KING Starbucks

BI-MART Jack in the Box US
Northwest Grow... Employee Owned

JO-ANN
BIG 5 SPORTING GOODS
DOLLAR TREE

Public Storage

REGAL CINEMAS



FAMILY PANCAKE HOUSE



SUBWAY

MILE HILL DR



PAPA JOHN'S



9 goodwill MIDAS ACE Godfather's PIZZA



OLNEY AVE SE

Puerto VALLARTA

Walgreens

STAPLES

RITE AID PHARMACY AutoZone TacoTime

SE LUND AVE

ups BIGLOTS! SALLY BEAUTY
Starbucks BIG TIRES SUBWAY O'Reilly AUTO PARTS RadioShack



BETHEL RD SE

Walmart Wendy's SUBWAY

Pizza hut





PORT ORCHARD, WA is a small but growing community, located on close proximity to major urban and employment centers and enjoys an outstanding natural setting. Residents have a strong community spirit and value the area's important maritime history. These aspects contribute to a high quality of life that influences people's choice to live and work in Port Orchard.

~ Information Provided by City of Port Orchard

TACOMA | KIRKLAND | PORTLAND | SEATTLE

RELATIONSHIP FOCUSED. RESULTS DRIVEN.

TIM WEBER

253.471.5502
tweber@firstwesternproperties.com



BLAKE WEBER

253.274.4926
blake.weber@kidder.com

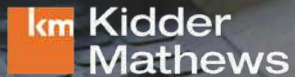

DON WHITTLES

253.274.4928
don.whittles@kidder.com



NED WHALEN

253.274.4927
ned.whalen@kidder.com



© First Western Properties, Inc. DISCLAIMER: The above information has been secured from sources believed to be reliable, however, no representations are made to its accuracy. Prospective tenants or buyers should consult their professional advisors and conduct their own independent investigation. Properties are subject to change in price and/or availability without notice.



First Western Properties—Tacoma Inc. | 253.472.0404
6402 Tacoma Mall Blvd, Tacoma, WA 98409
www.fwp-inc.com

Kidder Mathews-Tacoma | 253.722.1400
1201 Pacific Ave #1400, Tacoma, WA 98402
www.kidder.com

