



5311

INDUSTRIAL WAREHOUSE FOR LEASE

# SALMON BAY CENTER

5311 SHILSHOLE AVE NW | SEATTLE, WA

**NAI** Puget Sound  
Properties

# PROPERTY OVERVIEW SALMON BAY CENTER

5311 SHILSHOLE AVE NW

- Approx. 9,800 - 34,655 SF
- Office will be BTS
- 5 Docks, 2 Grade Level Loading doors
- 20' clear height
- Fully sprinklered
- Free Parking; 1:1,000 SF. Additional parking available.
- Rail served
- Marina access
- Fully fenced site with gates locked after hours and 24/7 onsite security services
- Easily accessible by public transit with stops nearby
- Within short walking distance to Ballard Avenue restaurants
- Call brokers for rates

## JOHN VERNON

PARTNER  
+1 425 586 5638  
jvernon@nai-psp.com

## BOB SWAIN, CCIM

PARTNER  
+1 425 586 5622  
bswain@nai-psp.com

## MATTHEW HOPKINS

ASSOCIATE  
+1 425 586 5635  
mhopkins@nai-psp.com



# SITE OVERVIEW





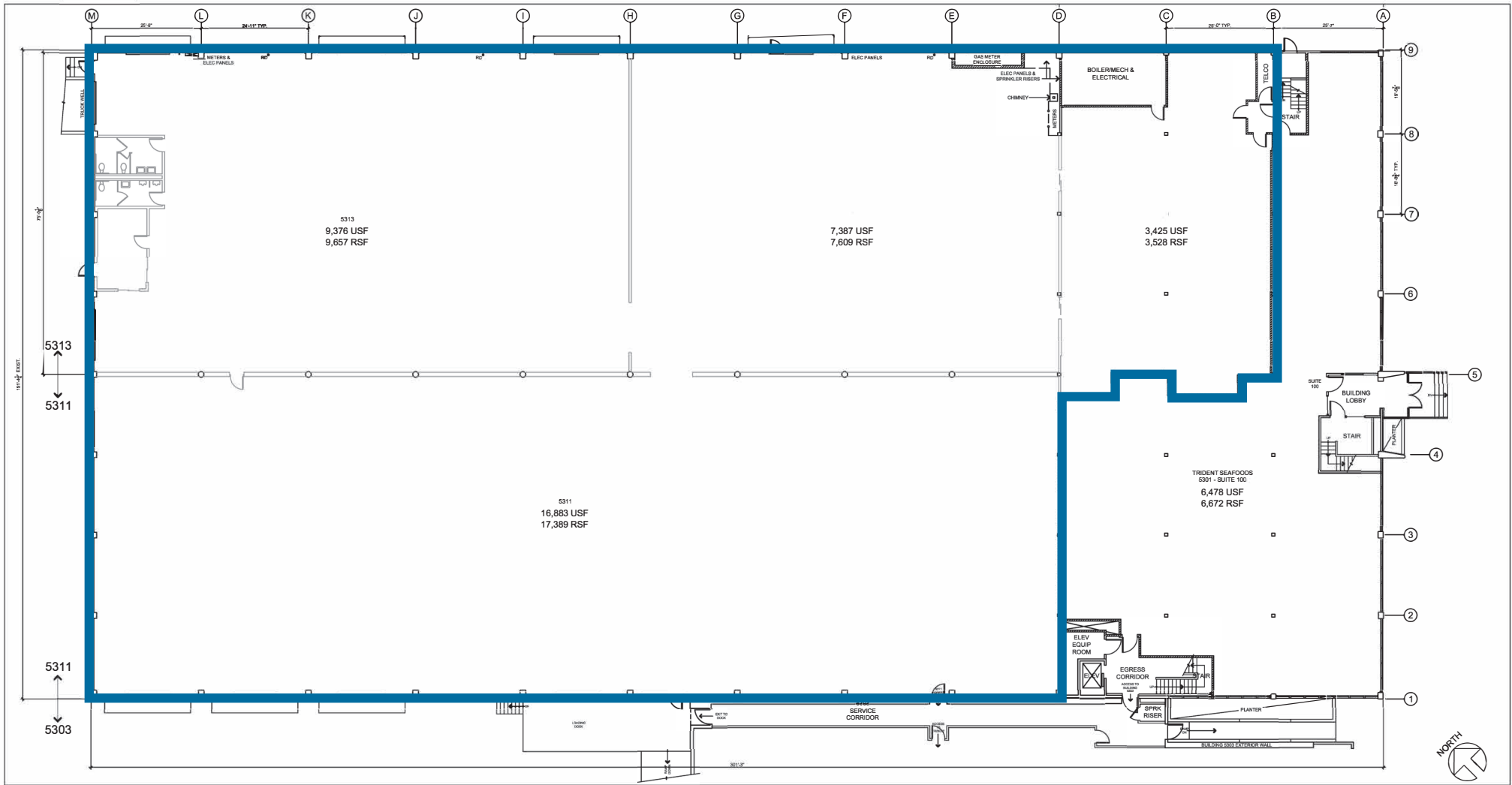

NO SCALE

# 5311

## SALMON BAY CENTER

Floor 1

5301 / 5311 / 5313 Shilshole Ave NW