

7 MAY 96



Common	43
Storage	42
Water	42
sf	42

[KIEMLEHAGOOD

carlg@kiemlehagood.com

PROJECT HIGHLIGHTS

505 W. Kathleen Avenue
Coeur d'Alene, Idaho 83815

COEUR D'ALENE'S NEWEST MIXED-USE DEVELOPMENT

The ±15.89-acre development will offer abundant parking, retail space (including retail pads with drive-thru), and residential units.

Located at the lighted intersection of Kathleen Avenue and Highway 95, this site sees an average daily traffic count of ±49,900 on Highway 95, and ±15,000 on West Kathleen Avenue.

±32,892 SF of Retail Space (1,405-9,773 SF)

Retail pads with drive-thru available

Great access

Residential units

Outdoor seating

Pet friendly



MERCHANT PROXIMITY MAP

505 W. Kathleen Avenue
Coeur d'Alene, Idaho 83815



THE LOCATION

505 W. Kathleen Avenue
Coeur d'Alene, Idaho 83815



SITE PLAN

505 W. Kathleen Avenue
Coeur d'Alene, Idaho 83815

SPACE RANGE
LEASE RATES

| ±1,405 SF up to 9,773 SF
| Contact Listing Broker

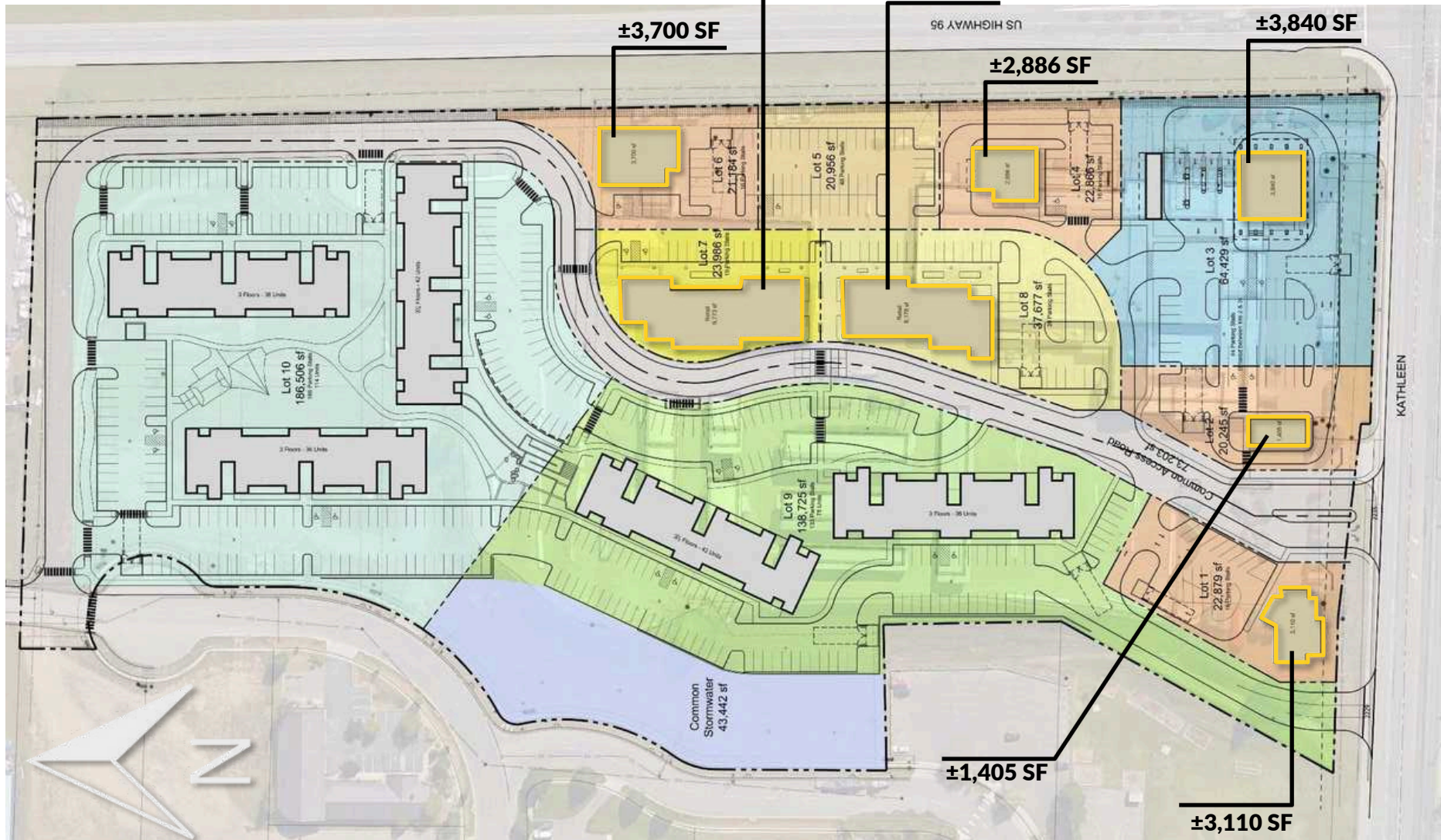

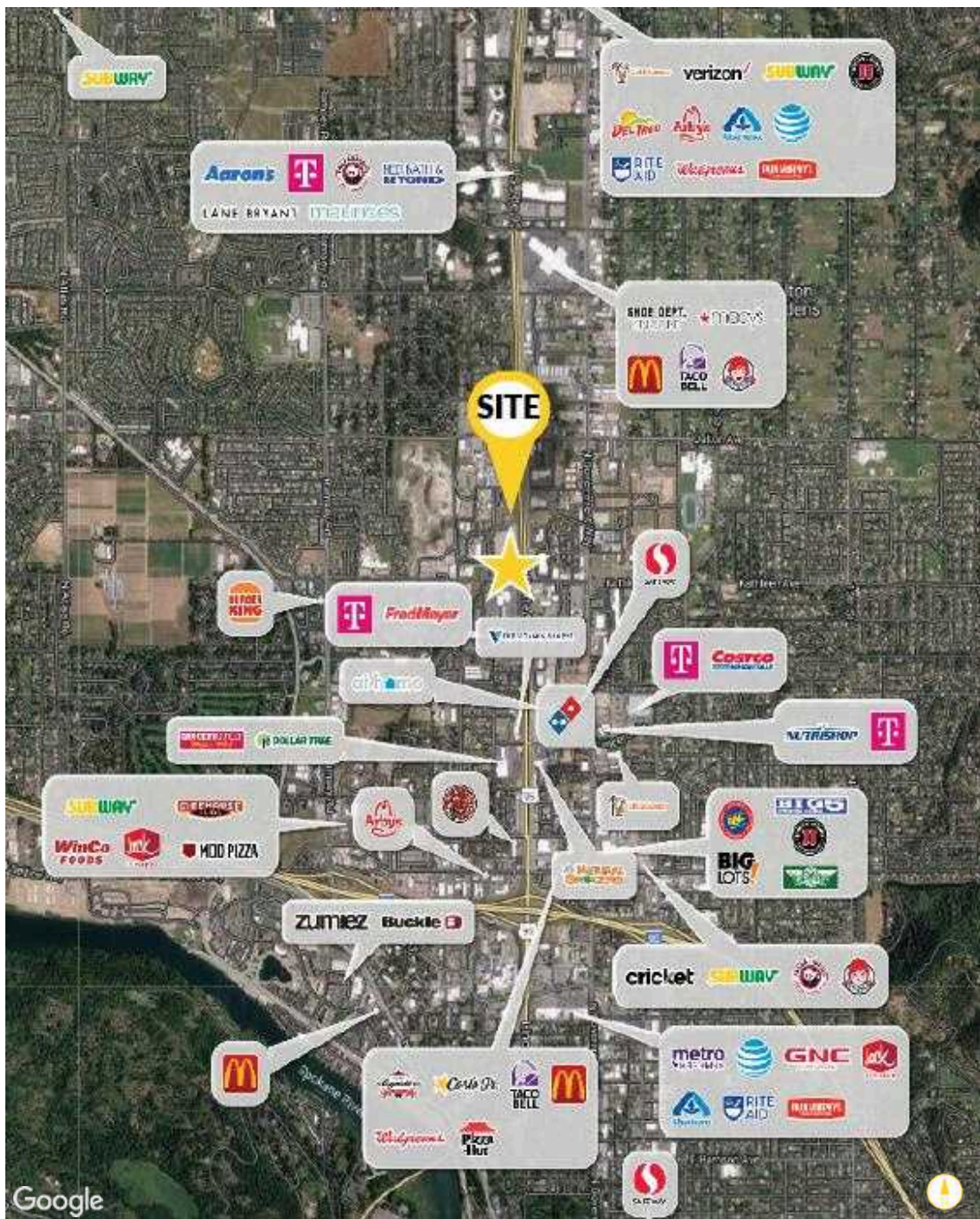

BUILD-TO-SUIT & LANDLEASEOPTIONS

505 W.Kathleen Ave
Coeur d'Alene, ID

CARL GUENZEL, BROKER

509.755.7543

carlg@kiemleahagood.com

**KIEMLE
HAGOOD**

601 WEST MAIN AVENUE, SUITE 400 | SPOKANE, WA 99201

No warranty or representation, expressed or implied, is made by Kiemle Hagood, its agents or its employees as to the accuracy of the information contained herein. All information furnished is from sources deemed reliable and submitted subject to errors, omissions, change of terms and conditions, prior sale, lease or financing, or withdrawal without notice. No one should rely solely on the above information but instead should conduct their own investigation to independently satisfy themselves.

Kiemle Hagood respects the intellectual property of others:

If you believe the copyright in your work has been violated through this Website, please contact our office for notice of claims of copyright infringement. For your complaint to be valid under the Digital Millennium Copyright Act of 1998 (DMCA), you must provide the following information when providing notice of the claimed copyright infringement: Identify the material on the Website that you believe infringes your work, with enough detail so that we may locate it on the Website; provide your address, telephone number and email address; provide a statement that you have a good faith belief that the disputed use is not authorized by the copyright owner, its agent, or the law; provide a statement that the information in the notification is accurate, and under penalty of perjury, that the complaining party is authorized to act on behalf of owner of an exclusive right that is allegedly infringed; provide your physical or electronic signature. Upon receiving your complaint, Kiemle Hagood will, upon review, remove content that you believe infringes your copyright if the complaint is found valid.