

SUBJECT
PROPERTY

5629 208TH ST SW

5629 208TH ST SW, LYNNWOOD, WA

*±3,000 SF Warehouse with
Office Available For Lease
in Lynnwood, WA*

5629 208TH ST SW

SUBJECT
PROPERTY

Property Highlights

ADDRESS	5629 208th St SW Lynnwood, WA 98036
AVAILABLE	±3,000 SF
OFFICE/RESTROOM	±300 SF
LEASE RATE	\$1.40/SF + NNN
BUILDING SIZE	12,000 SF
LOADING	2 grade-level doors
POWER	Heavy power
RESTROOMS	In-suite restroom
LOCATION	Located in the heart of Lynnwood
AVAILABLE	Now

±3,000 SF

AVAILABLE

\$1.40/SF

LEASE RATE + NNN

SITE PLAN

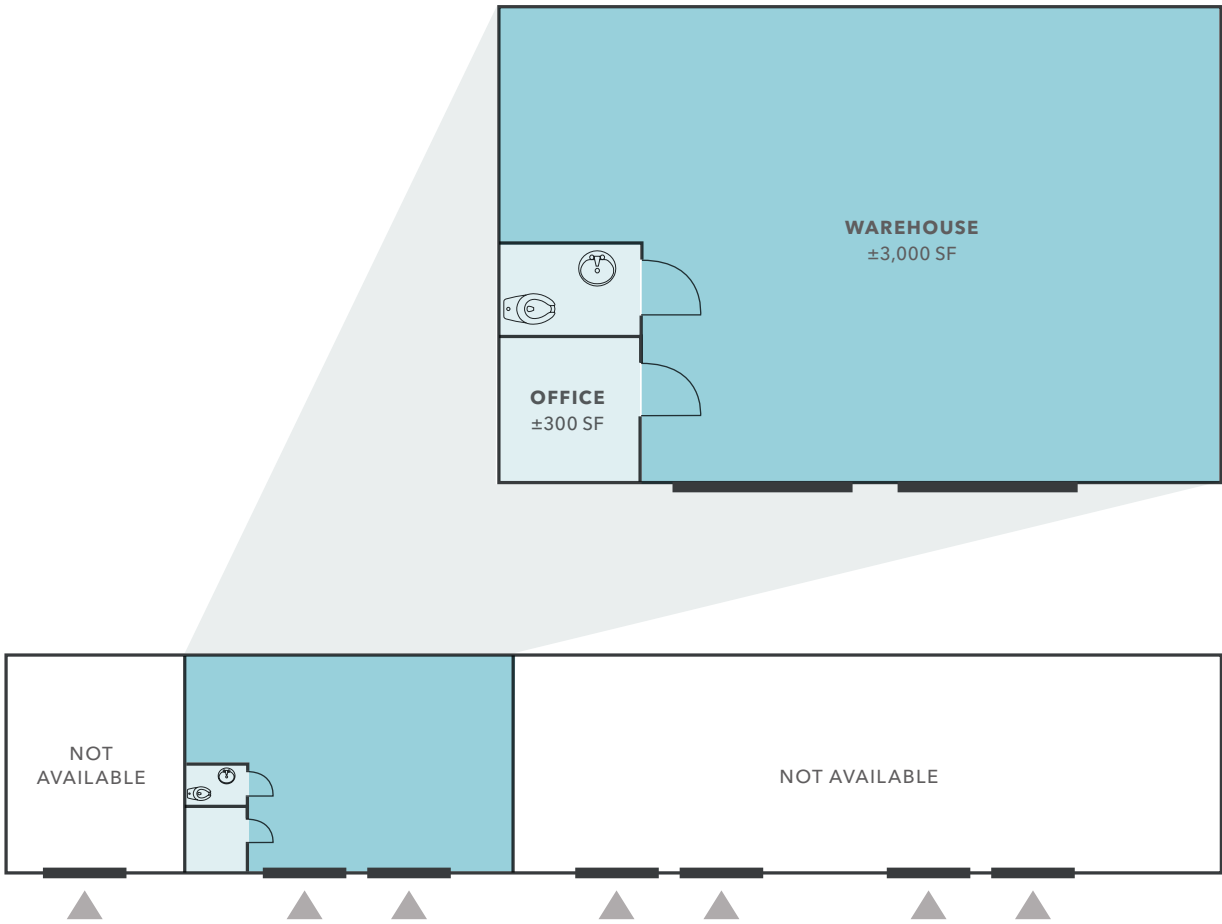

12,000 SF

TOTAL SF

±3,000 SF

AVAILABLE

±300 SF

OFFICE/RESTROOM

NOW

AVAILABLE

▲ Grade level loading



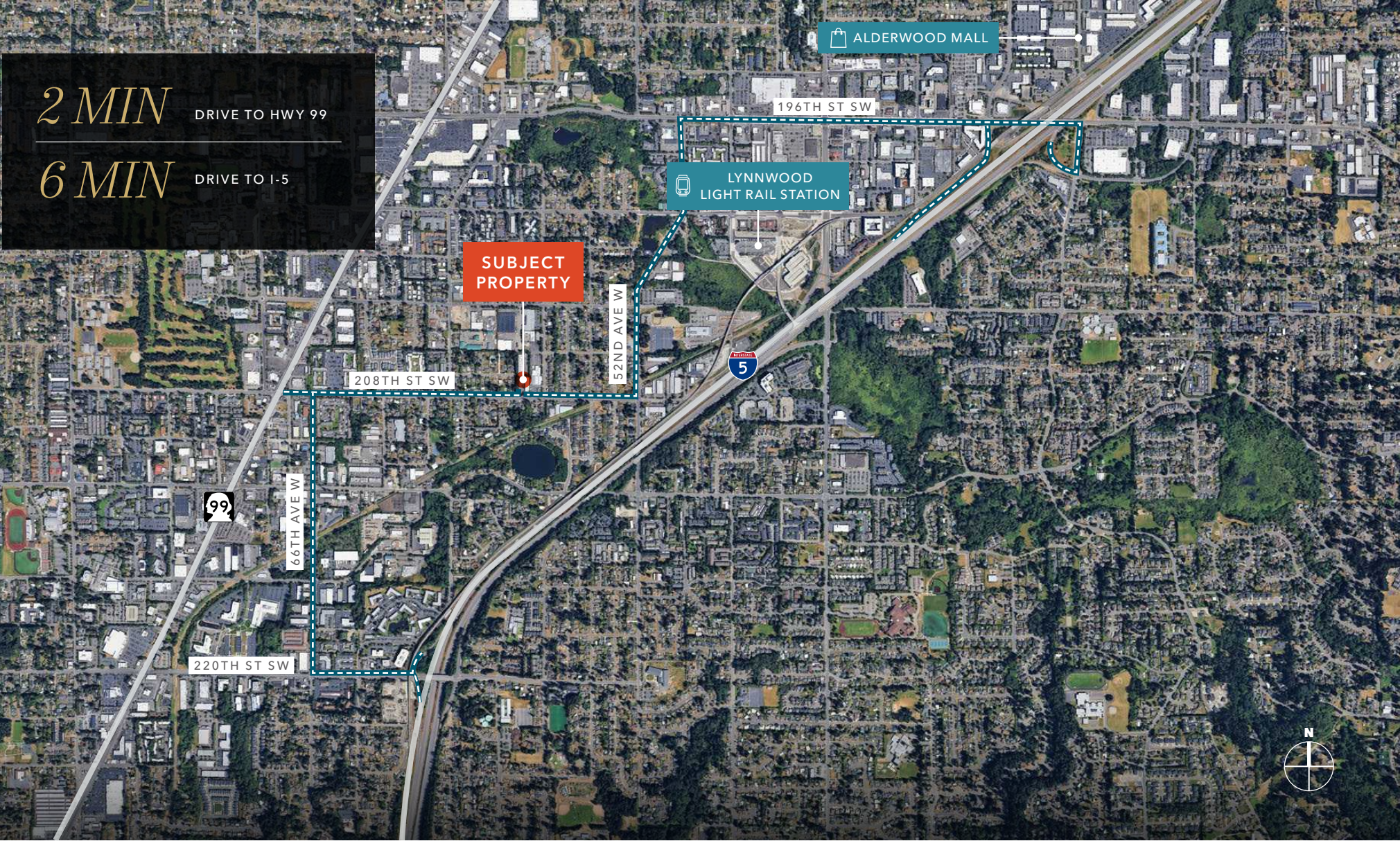





Exclusively listed by

COLTON TEGLOVIC
Vice President
425.281.5261
colton.teglovic@kidder.com

MATTHEW HAGEN, SIO
Executive Vice President
425.283.5782
matt.hagen@kidder.com

KIDDER.COM

This information supplied herein is from sources we deem reliable. It is provided without any representation, warranty, or guarantee, expressed or implied as to its accuracy. Prospective Buyer or Tenant should conduct an independent investigation and verification of all matters deemed to be material, including, but not limited to, statements of income and expenses. Consult your attorney, accountant, or other professional advisor. All Kidder Mathews designs are the sole property of Kidder Mathews. Branded materials and layouts are not authorized for use by any other firm or person.