

Northbrook Place

10215 Lake City Way NE,
Seattle, WA 98125

Position your
business in
the heart of
Lake City's
commercial
arterial.



Northbrook Place delivers high-visibility storefronts and efficient upper-floor suites along one of North Seattle's busiest arterials. Multiple configurations are available to fit your concept and growth plan.

- Suites from approximately ± 450 SF, $\pm 1,500$ SF, up to $\pm 2,400$ SF
- Mix of storefront retail, service commercial, and office layouts
- Prominent building signage along Lake City Way NE (SR-522) with steady, high daily traffic
- On-site parking with easy in/out access

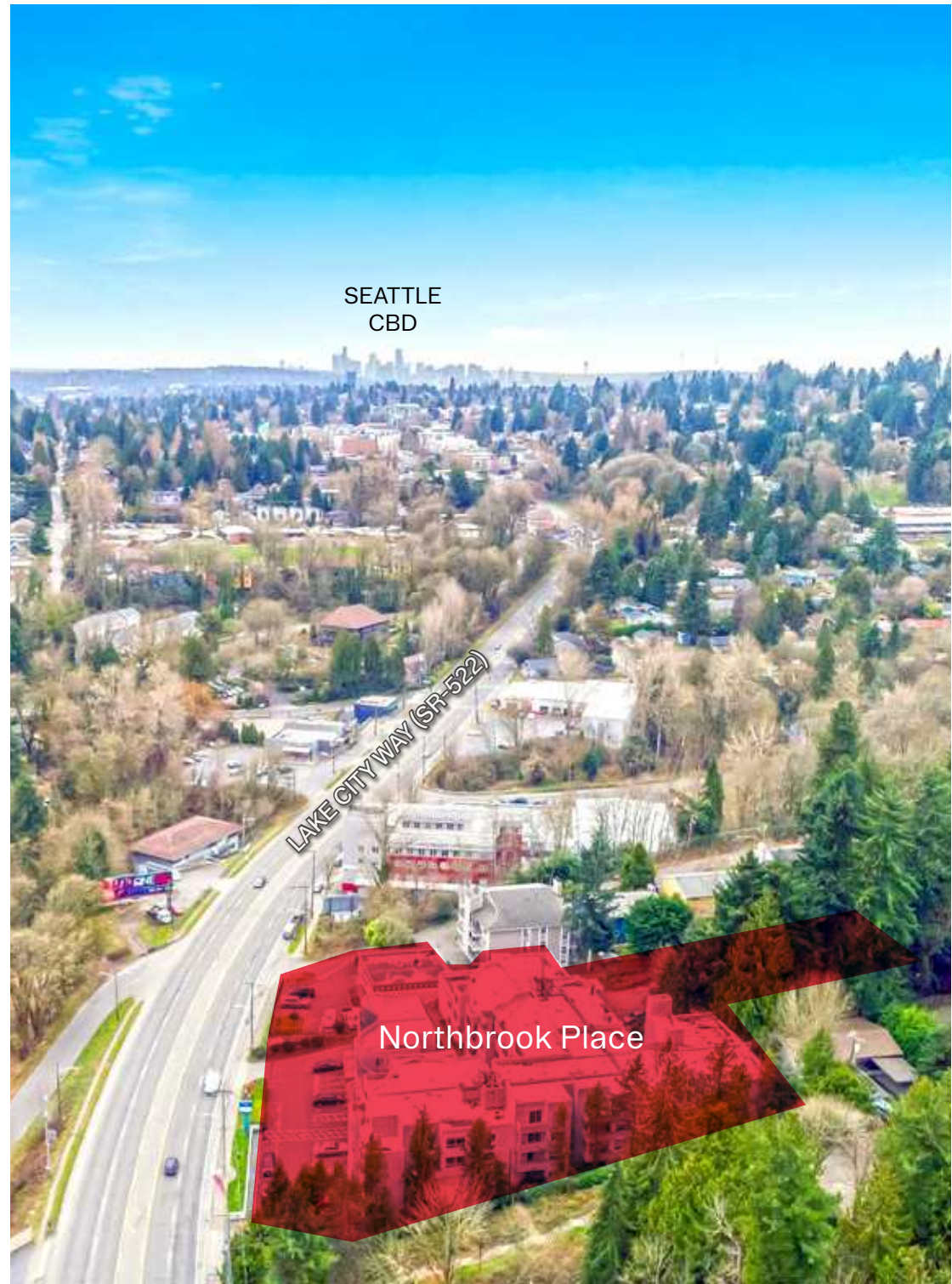

Location Highlights:

Lake City Way NE is SR-522, the direct connection between North Seattle, Lake Forest Park, Kenmore, Bothell, and Woodinville—placing your storefront on a regional commuter and shopping route. This corridor carries tens of thousands of vehicles daily, offering excellent exposure for consumer-facing businesses.

Ideal Uses

- Medical/dental, wellness, beauty, pet services
- Professional services, design/creative studios, tech support
- Tutoring/education, boutique fitness, community services



FLOOR PLAN

FLOOR 1 RETAIL:

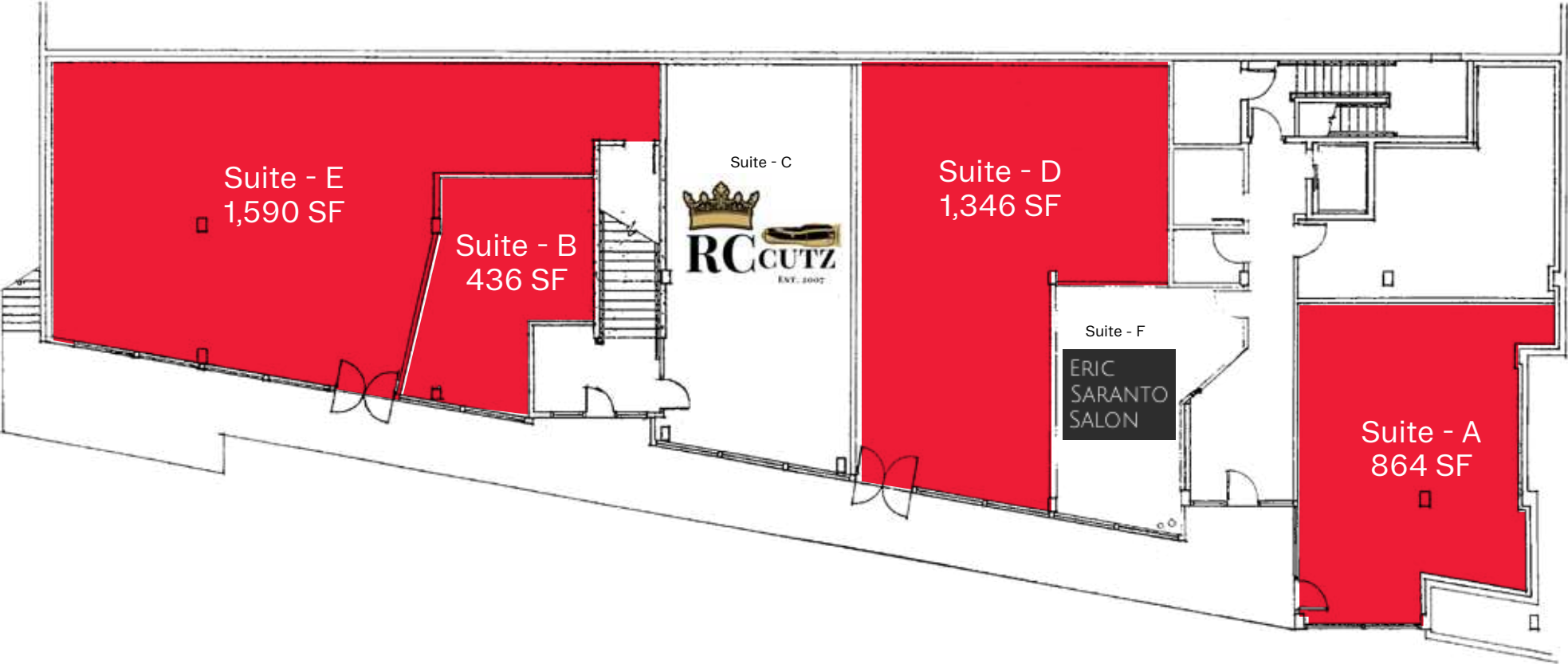

LAKE CITY WAY (SR-522)

FLOOR PLAN

FLOOR 2 RETAIL:

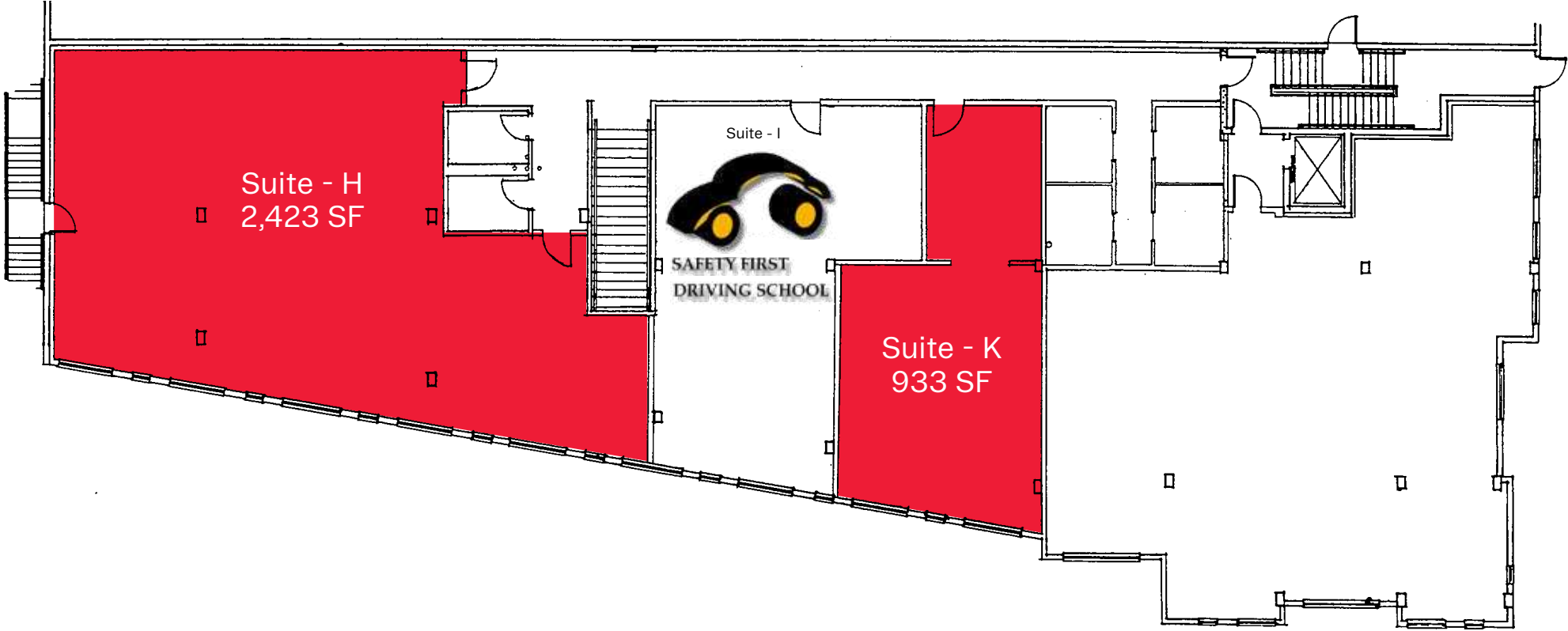

LAKE CITY WAY (SR-522)

Demographics

AVERAGE HOUSEHOLD INCOME

1-Mile: \$149,995

2-Mile: \$139,443

5-Mile: \$147,673

TOTAL POPULATION

1-Mile: 25,343

2-Mile: 94,946

5-Mile: 439,740

TRAFFIC COUNTS

36,412 vehicles per day at

Lake City Way NE and

Fischer PI NE NE

32,775 vehicles per day at

Lake City Way NE and

NE 100th St

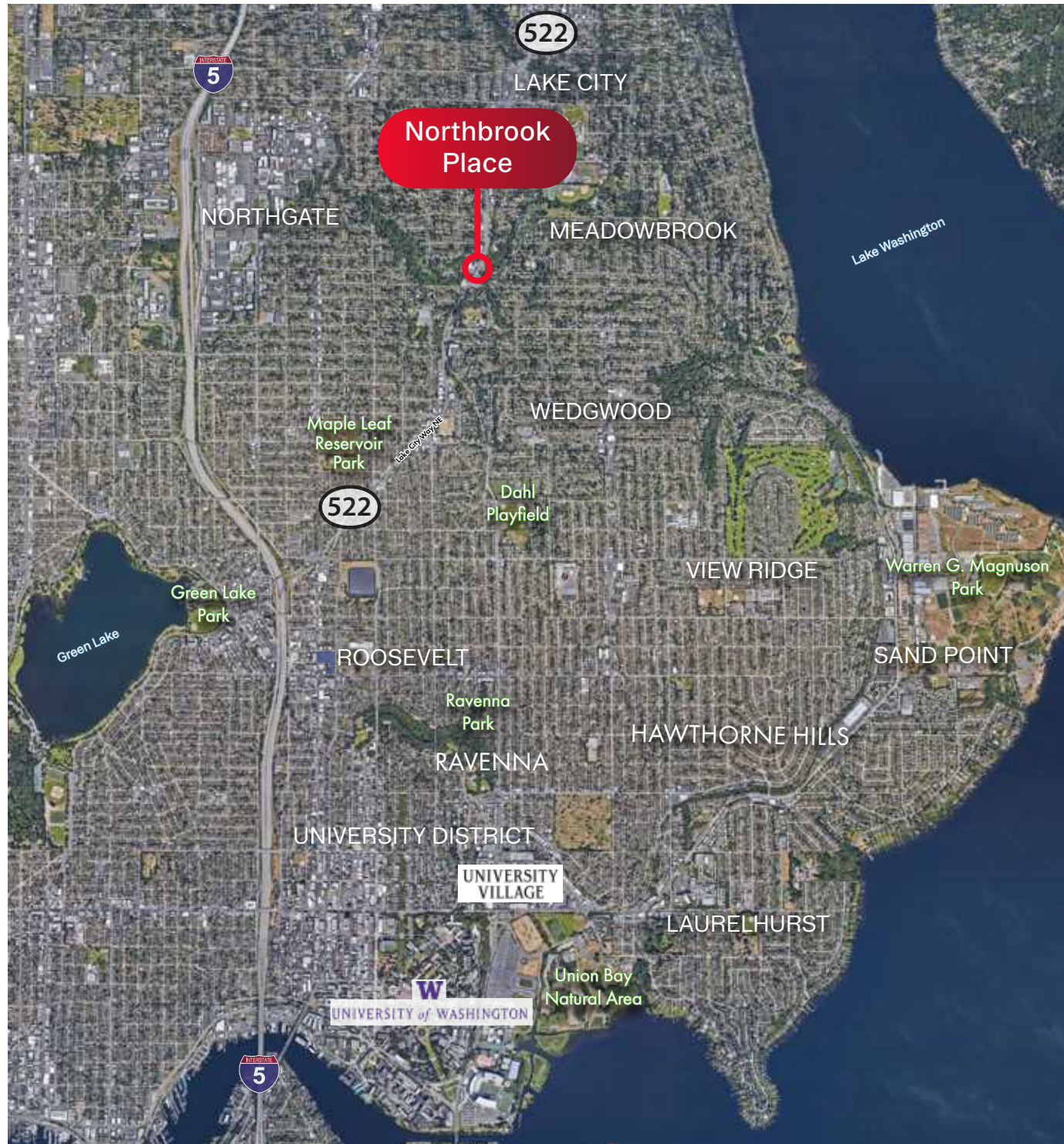



10215 Lake City Way NE, Seattle, WA 98125

Kara Farley

karaf@wccommercialrealty.com
682 351 8844

Blake Taylor

blake@wccommercialrealty.com
206 931 0525

WCCR | West Coast
Commercial
Realty

DISCLAIMER: The above information has been secured from sources believed to be reliable, however, no representations are made to its accuracy. Prospective tenants or buyers should consult their professional advisors and conduct their own independent investigation. Site plan and configuration are subject to change. Properties are subject to change in price and/or availability without notice. West Coast Commercial Realty, LLC



206 283 5212
wccommercialrealty.com