

FOR LEASE

4304 S 131ST PL

TUKWILA, WA

NorMed Building For Lease. Tremendous Access to I-5 and SR 99.

Approximately 7,164 SF rentable area

Approximately 2,091 SF first floor office area

2,141 of "bonus" mezzanine area at no charge

1 grade-level door, plus access to a common dock door

22' clear height

277/480 volt 3-phase power

Available now

\$1.10 shell rate / \$1.20 office add-on, NNN

Best access available for service-related companies

DOUG KLEIN, SIOR
206.248.7348
doug.klein@kidder.com

KIDDER.COM

This information supplied herein is from sources we deem reliable. It is provided without any representation, warranty, or guarantee, expressed or implied as to its accuracy. Prospective Buyer or Tenant should conduct an independent investigation and verification of all matters deemed to be material, including, but not limited to, statements of income and expenses. Consult your attorney, accountant, or other professional advisor.

7,164
SF TOTAL

22'
CLEAR HEIGHT

ONE
GL DOOR

km Kidder Mathews

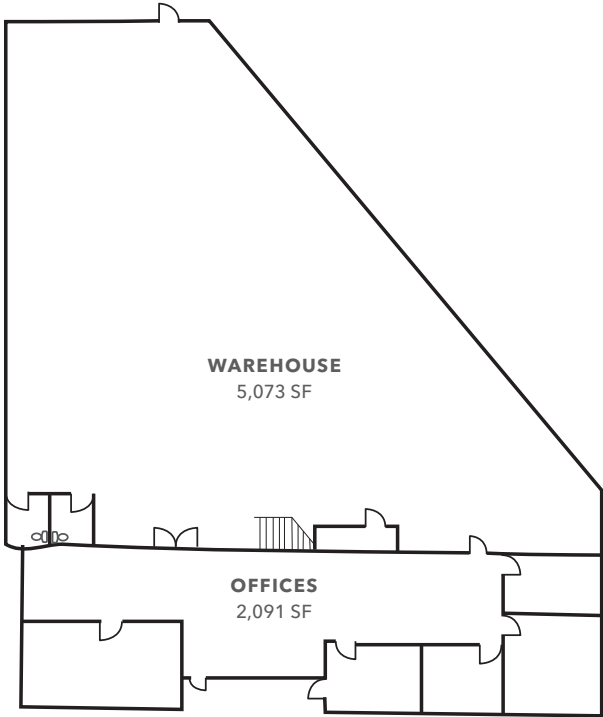

2,091
SF OFFICE

5,073
SF WAREHOUSE

2,141
SF MEZZANINE
"BONUS AREA"

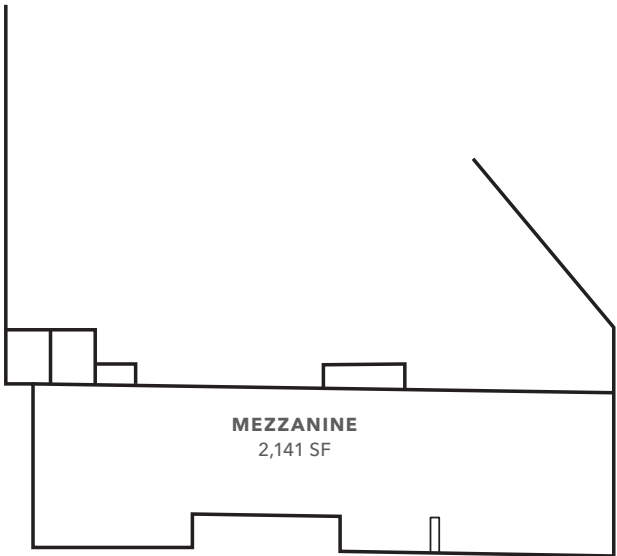

4304 S 131ST PL



KIDDER.COM

This information supplied herein is from sources we deem reliable. It is provided without any representation, warranty, or guarantee, expressed or implied as to its accuracy. Prospective Buyer or Tenant should conduct an independent investigation and verification of all matters deemed to be material, including, but not limited to, statements of income and expenses. Consult your attorney, accountant, or other professional advisor.

km Kidder Mathews