

SEAPORT LOGISTICS CENTER, BUILDING 3

14475 STEWART ROAD – SUMNER, WA 98390





**AN AWARD-WINNING,
CLASS A INDUSTRIAL
PARK** LOCATED IN THE
INDUSTRIAL CENTER
OF SUMNER, WA



501,319 SF TOTAL



37,264 SF OFFICE BUILD-OUT IN 4 LOCATIONS, INCLUDING TRAINING ROOMS, LOCKER-ROOM ETC.



4 GRADE LEVEL
12'X 16' DOORS



40' CLEAR HEIGHT



130' MINIMUM
TRUCK COURT



LED LIGHTING THROUGHOUT,
25 FC IN WAREHOUSE



453 CAR PARKING STALLS



FULLY FENCED, TWO TRUCK ENTRANCES
WITH GUARD SHACKS AND 3 KEY CARD
ACCESS DRIVES FOR CARS



WAREHOUSE FULLY
CLIMATE CONTROLLED



BUILDING DEPTH 640'



86 DOCK DOORS – 33 DOCK DOORS WITH
FULL DOCK PACKAGES (SEALS, LEVELERS
DOCK LOCK AND DOCK LIGHTS)



12,000 AMPS, 277/480 VOLT 3-PHASE POWER



61 TRAILER STALLS –
INCLUDING TANDEM STALLS



9" THICK SLAB ONGRADE



60' SPEED BAY WITH TYPICAL
60' X 56' COLUMN SPACING



OUTDOOR COVERED PATIO AMENITY SPACE



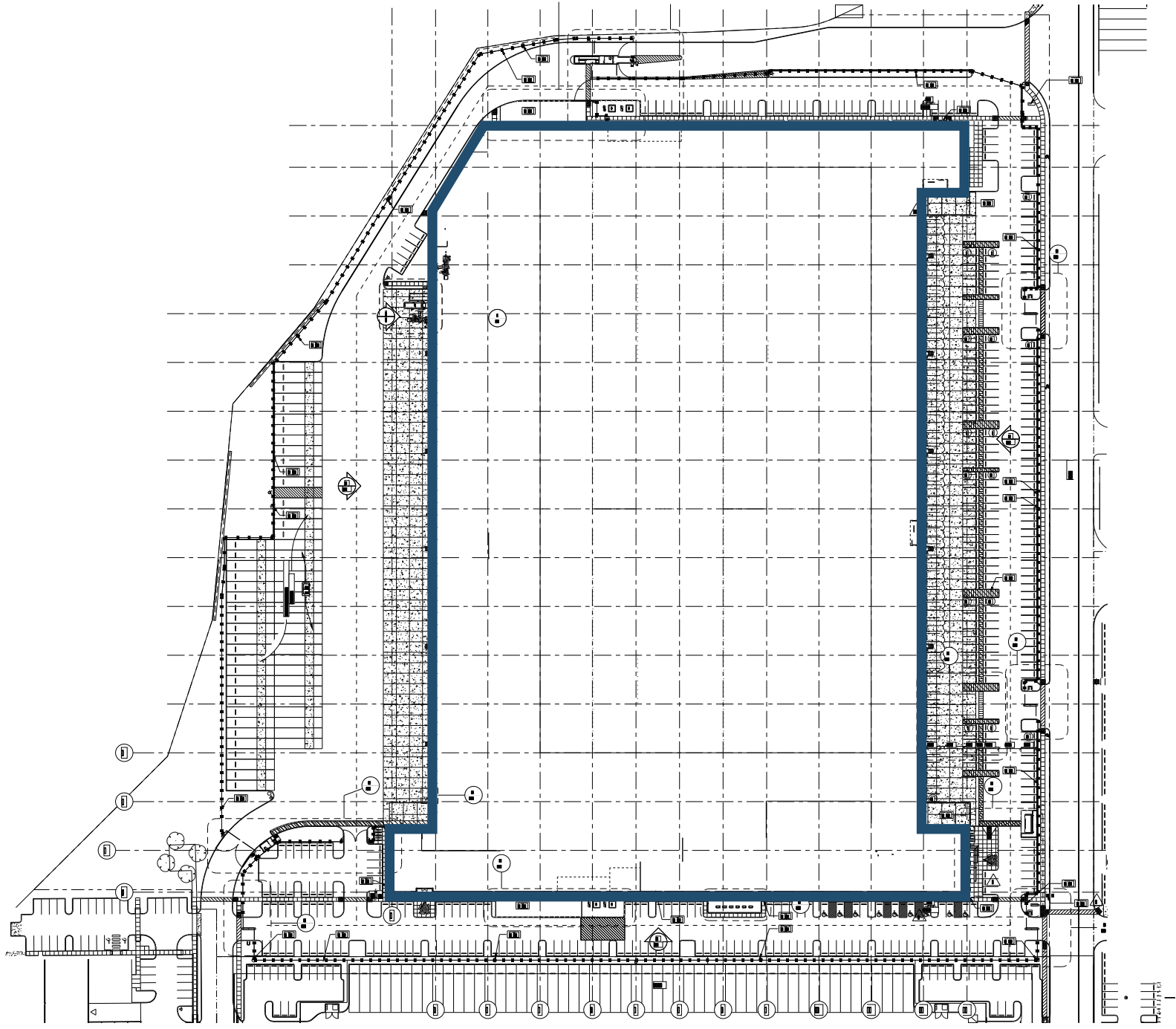

SITE PLAN

FLOOR PLAN

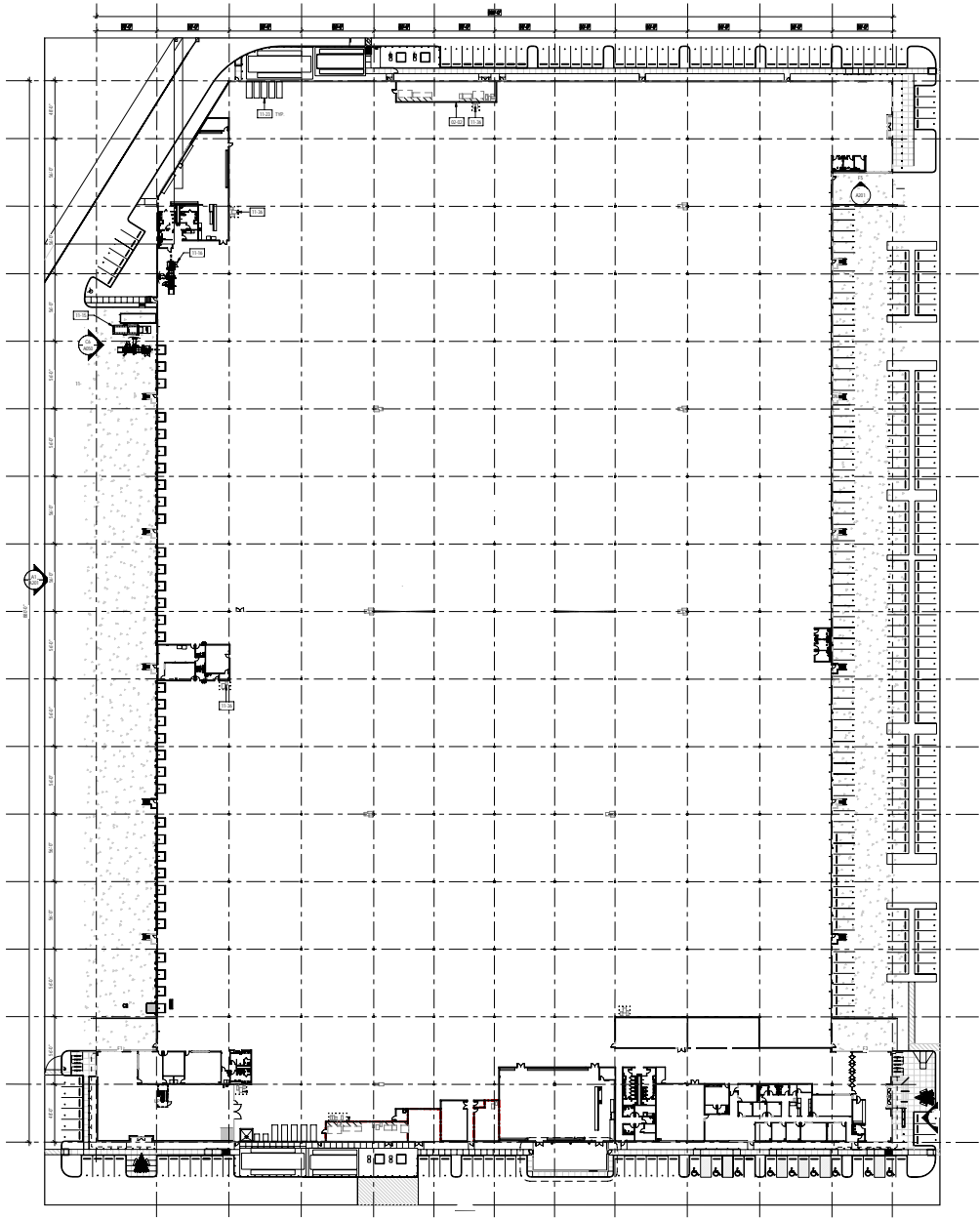



SECURE ACCESS

IDEALLY LOCATED



PORT OF TACOMA
10 MILES



PORT OF SEATTLE
31 MILES



SEATAC AIRPORT
19 MILES



BOEING FIELD
24 MILES





NESPRESSO



fulfillment
by amazon



Expeditors





SCOTT CARTER
scott.carter@jll.com
T +1 425 761 5880

CHRIS SPOFFORD
chris.spofford@jll.com
T +1 425 890 6961

Jones Lang LaSalle Brokerage, Inc.

Although information has been obtained from sources deemed reliable, neither Owner nor JLL makes any guarantees, warranties or representations, express or implied, as to the completeness or accuracy as to the information contained herein. Any projections, opinions, assumptions or estimates used are for example only. There may be differences between projected and actual results, and those differences may be material. The Property may be withdrawn without notice. Neither Owner nor JLL accepts any liability for any loss or damage suffered by any party resulting from reliance on this information. If the recipient of this information has signed a confidentiality agreement regarding this matter, this information is subject to the terms of that agreement. © 2023 Jones Lang LaSalle IP, Inc. All rights reserved.