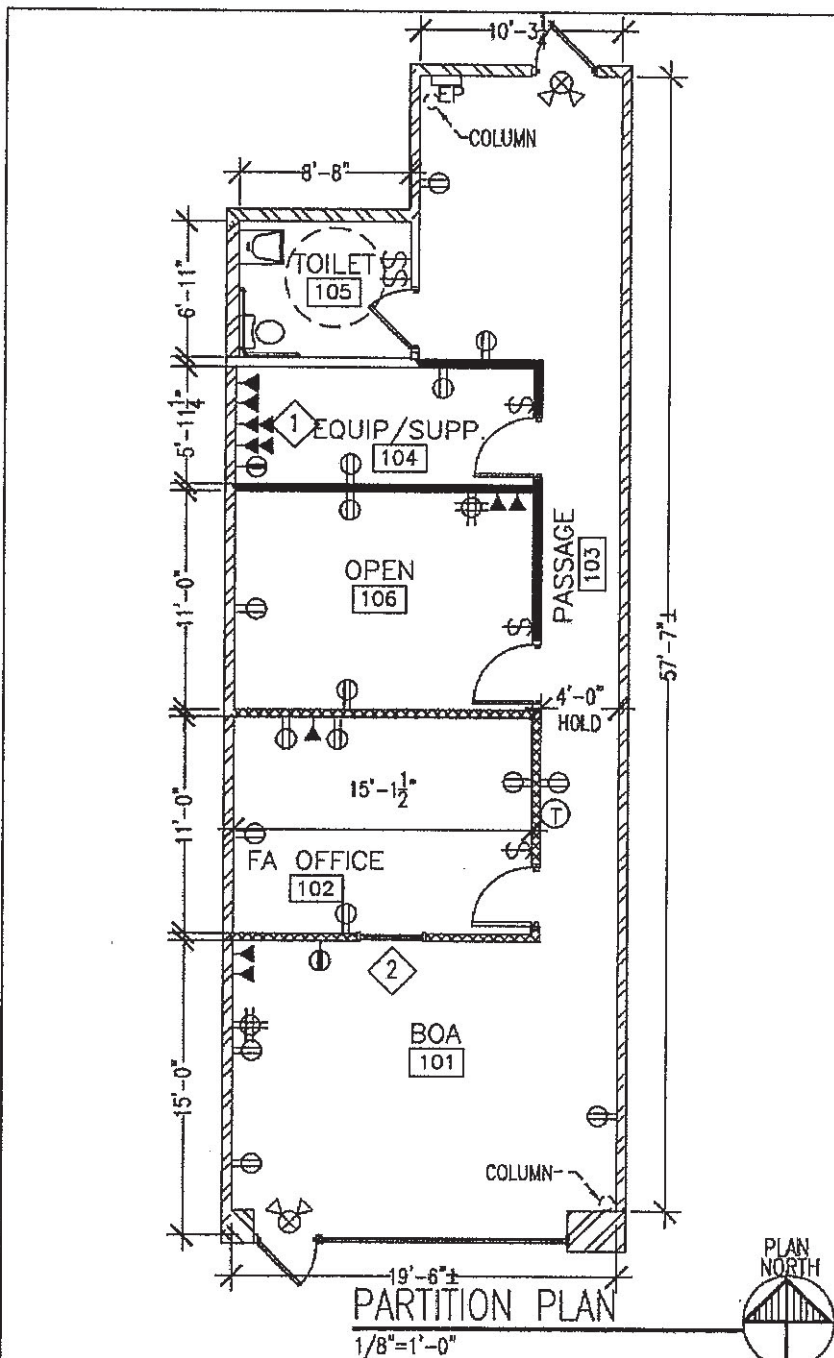

EXHIBIT B-1—Page 2
EDWARD JONES GENERAL NOTES



**** CONTRACTOR MUST HAVE (3) PAGES FOR THIS SET OF DRAWINGS. IF YOU ARE MISSING ANY PAGES, PLEASE CONTACT DESIGNER AT 314-515-3953**

D-Mark extension work per Detail on sheet 1 of 3, to be completed on the first day of construction. Email photo to Leasing Coordinator to confirm work completion.

KEYED NOTES:

- 1 PHONE COMPANY SERVICE TO BE INSTALLED AT BOC LOCATION PER DETAIL ON SHEET 1 OF 3 AND PER SPECIFICATIONS ON 1ST DAY OF CONSTRUCTION. EMAIL PHOTO TO LEASING COORDINATOR TO CONFIRM WORK ASAP.
- 2 FIXED GLASS WINDOW: 30" H X 42"W; WOOD FRAMING AND WOOD BULLNOSE EDGE SILL @ 42" A.F.F.

CONTRACTOR NOTES:

1. LANDLORD TO DELIVER SPACE IN EDWARD JONES TURNKEY CONDITION (SEE EXHIBITS B&C).
2. ALL ITEMS TO BE COMPLETED PER EDWARD JONES SPECIFICATIONS (SEE EXHIBIT B) UNLESS OTHERWISE NOTED.
3. INSTALL (3) CAT6E PHONE LINES IN 3/4" CONDUIT FROM BUILDING SOURCE TO BOC SERVER LOCATION IN EQ/SUPP 104 (SEE DETAIL ON SHEET 1 OF 3).
4. INSTALL NEW 2'x4' ACOUSTICAL CEILING GRID AND TILES @ 9'0" A.F.F. WITH 2'x4' LAY-IN FLUORESCENT LIGHT FIXTURES.
5. RUN SUPPLY AND RETURN DUCT DISTRIBUTION FROM BUILDING HVAC TO SPACE TO ACCOMODATE NEW PARTITIONS.
6. VERIFY LOCATION OF ALL EXISTING DEMISING PARTITIONS AND THAT THEY EXTEND TO THE DECK; EXTEND AS REQUIRED.
7. INSTALL 6 GALLON WATER HEATER ABOVE CEILING AND PROVIDE BRACING AND INSTALL EXHAUST FAN VENTED TO EXTERIOR IN TOILET 105 AS REQUIRED BY LOCAL CODE.
8. INSTALL NEW ADA ACCESSORIES AND HARDWARE IN TOILET 105 AND THROUGHOUT SPACE.
9. INSTALL THERMOSTAT AS INDICATED ON PLAN IN PASSAGE 103.

Edward Jones
BRANCH FACILITIES

BRANCH OFFICE 35667
5714 134th Ave SE
Suite A12
Everett, WA 98208
LEASE SQ. FT. 1116

ISSUES/ REVISIONS		
NO.	DATE	DESCRIPTION
1	2.29.08	add window
2	3.10.08	change city/contact

DRAWN BY: Lauren Correll
314-515-3953
DATE: 2/20/08

EXHIBIT A
SHEET 2 of 3