

OLYMPIC INDUSTRIAL PARK

UNDER NEW OWNERSHIP



RENOVATIONS UNDERWAY

19111 DES MOINES MEMORIAL DR, SUITE F, SEATAC, WA

FOR MORE INFORMATION:

DOUG KLEIN, SIOR
206.248.7348
doug.klein@kidder.com

DANE DAHLIN, SIOR
206.248.6519
dane.dahline@kidder.com

KIDDER MATHEWS
12886 Interurban Ave S
Seattle, WA 98168
www.kidder.com



PROPERTY FEATURES

- 17,507 SF of rentable area
- 1,406 SF of office area
- 16,101 SF of warehouse area
- 8 dock-high doors and 1 ramp
- 21.6' - 23' clear height
- Tremendous access to SeaTac Airport and I-5 via S 188th St
- Call brokers for pricing
- Available now



The information contained herein is believed to be accurate but is not warranted as to its accuracy and may change or be updated without notice. Seller or landlord makes no representation as to the environmental condition of the property and recommends purchaser's or tenant's independent investigation.

OLYMPIC INDUSTRIAL PARK

UNDER NEW OWNERSHIP



FOR MORE INFORMATION

DOUG KLEIN, SIOR
206.248.7348
doug.klein@kidder.com

DANE DAHLIN, SIOR
206.248.6519
dane.dahline@kidder.com

KIDDER MATHEWS
12886 Interurban Ave S
Seattle, WA 98168
www.kidder.com

OLYMPIC INDUSTRIAL PARK
19111 DES MOINES MEMORIAL DR
SUITE F, SEATAC, WA



OLYMPIC INDUSTRIAL PARK

BUILDING FLOOR PLAN

UNDER NEW OWNERSHIP

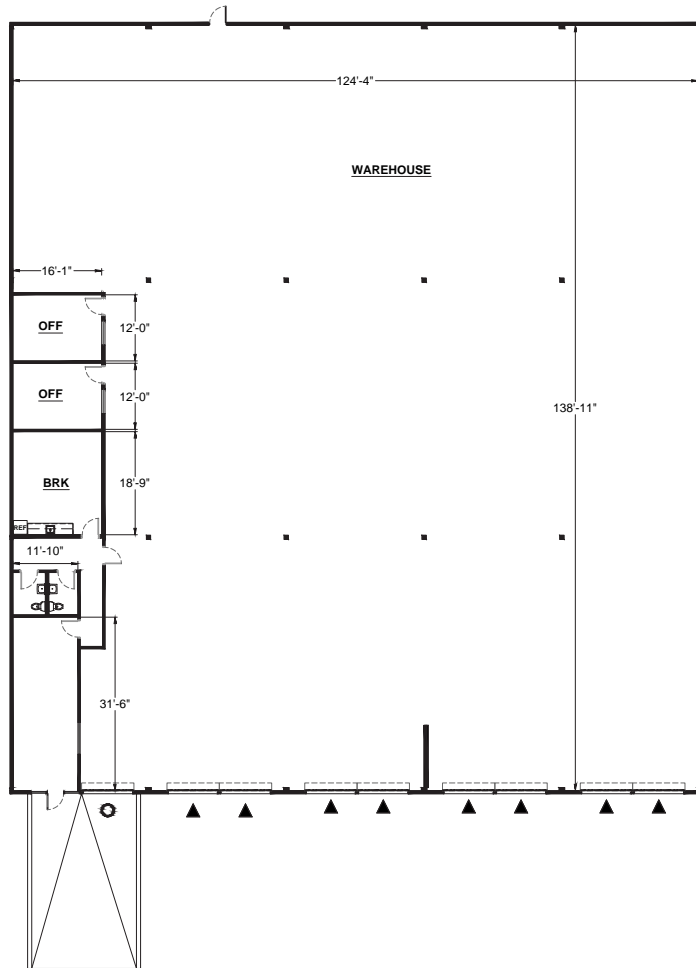

SITE PLAN

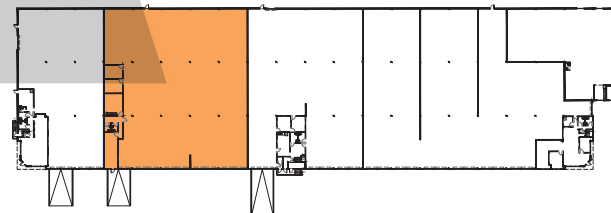

FOR MORE INFORMATION

DOUG KLEIN, SIOR
206.248.7348
doug.klein@kidder.com

DANE DAHLIN, SIOR
206.248.6519
dane.dahline@kidder.com

KIDDER MATHEWS
12886 Interurban Ave S
Seattle, WA 98168
www.kidder.com

OLYMPIC INDUSTRIAL PARK
19111 DES MOINES MEMORIAL DR
SUITE F, SEATAC, WA



AVAILABILITIES

SUITE	TOTAL SF	OFFICE SF	ASKING RATE	AVAILABLE
F	17,507	1,406	Call brokers	Immediately

OLYMPIC INDUSTRIAL PARK

AMENITIES & IMPROVEMENTS

UNDER NEW OWNERSHIP

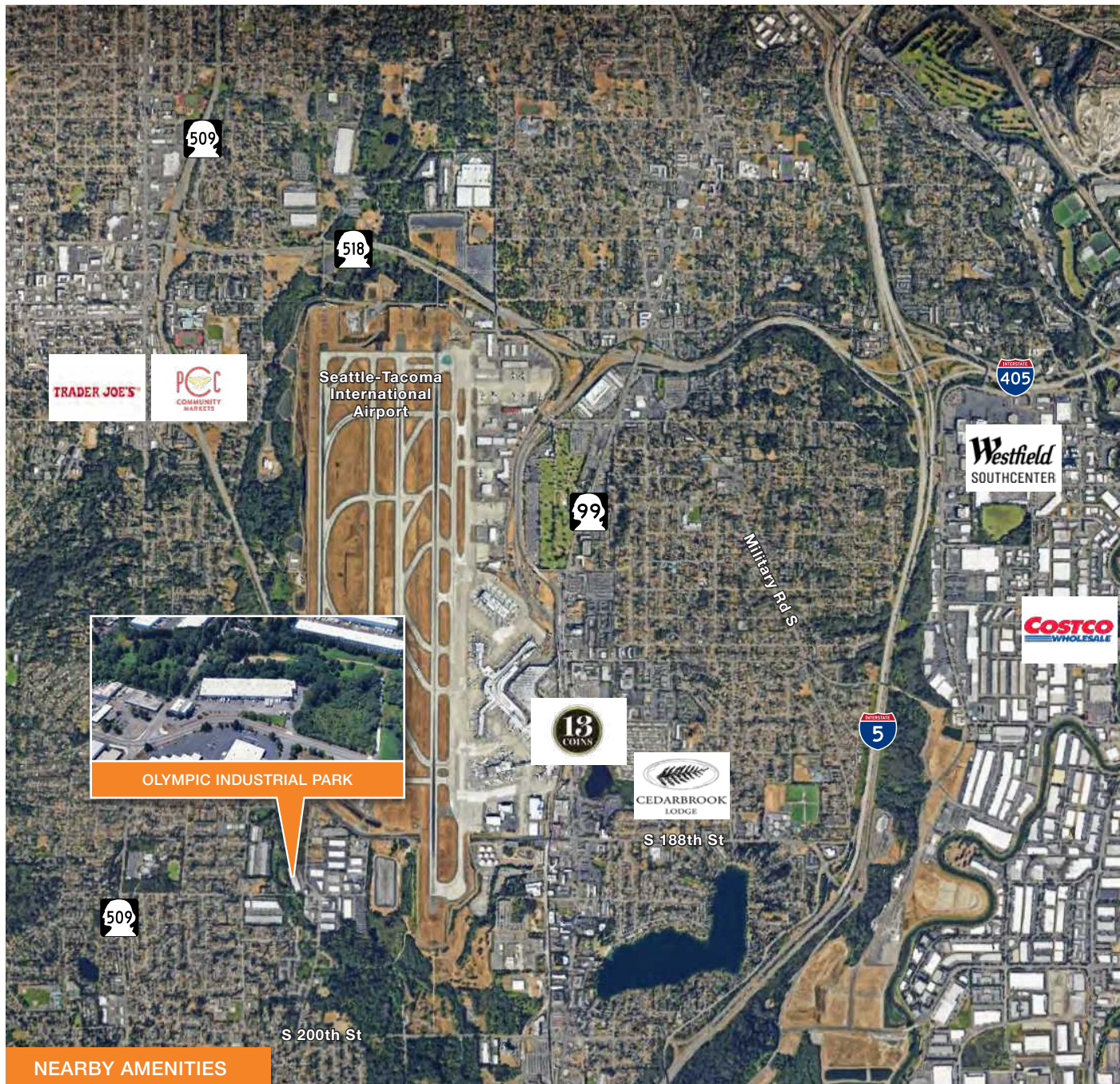

NEARBY AMENITIES

13 Coins
PCC Market
Costco
Trader Joe's
Westfield Southcenter
Cedarbrook Lodge

FOR MORE INFORMATION

DOUG KLEIN, SIOR
206.248.7348
doug.klein@kidder.com

DANE DAHLIN, SIOR
206.248.6519
dane.dahline@kidder.com

KIDDER MATHEWS
12886 Interurban Ave S
Seattle, WA 98168
www.kidder.com

OLYMPIC INDUSTRIAL PARK
19111 DES MOINES MEMORIAL DR
SUITE F, SEATAC, WA



NEARBY AMENITIES