

# BARKLEY

VILLAGE

## Retail Leasing

OVERVIEW



TALBOT  
GROUP



## A Growing Urban Village.

Barkley Village is conveniently located just 15 minutes from every corner of Bellingham.

250

Acre  
Property

193,000

SF Retail with Daily Essentials  
and Regional Anchors

328

Residential Units, Entitled  
for 3,000 Additional Units

235,000

In the MSA with 97,000  
Bellingham Residents

100

Businesses in  
Walking Distance

300,000

SF Class A Office Owned

—  
Additional office onsite: Janicki,  
Bellingham School District,  
medical & financial services









## At the Center of a Dynamic Region.

Bellingham is a top 5 multi-sport destination in the state of Washington and widely known for world class mountain biking, water sports, hiking and skiing.

# +3.42M

Visitors to Whatcom County Annually

90 miles north of Seattle on the I-5 corridor, 50 miles to Vancouver and 50 miles to Mount Baker



### DAILY TRAFFIC COUNTS

I-5 @ Sunset ~ 61,000

Sunset @ Woburn ~ 42,000

Woburn @Barkley ~ 30,000



BARKLEY VILLAGE

# Newmarket Street Retail



# NEWMARKET STREET

44,347 SF OF RETAIL + HAGGEN GROCERY

**BARKLEY**  
VILLAGE

\*  
**HAGGEN  
GROCERY**

**PARKING**

▲ 387 surface parking ▲

▲  
**WOBURN  
STREET**

**2915**

**2925**

**2945**

**2955**

**NEWMARKET**

**EVENT  
PLAZA**

**2930**

OVER  
FLOW

**2940**

**2950**

**PARKING**

117 surface + 34 Newmarket street

**BARKLEY BOULEVARD**

  
*Rail Trail*



## Barkley Village Retail Refined



### First Phase of Renovation Underway

- Updated building façade
- Enhanced patio dining
- Upgraded common areas
- Activated open space and link to regional trail system



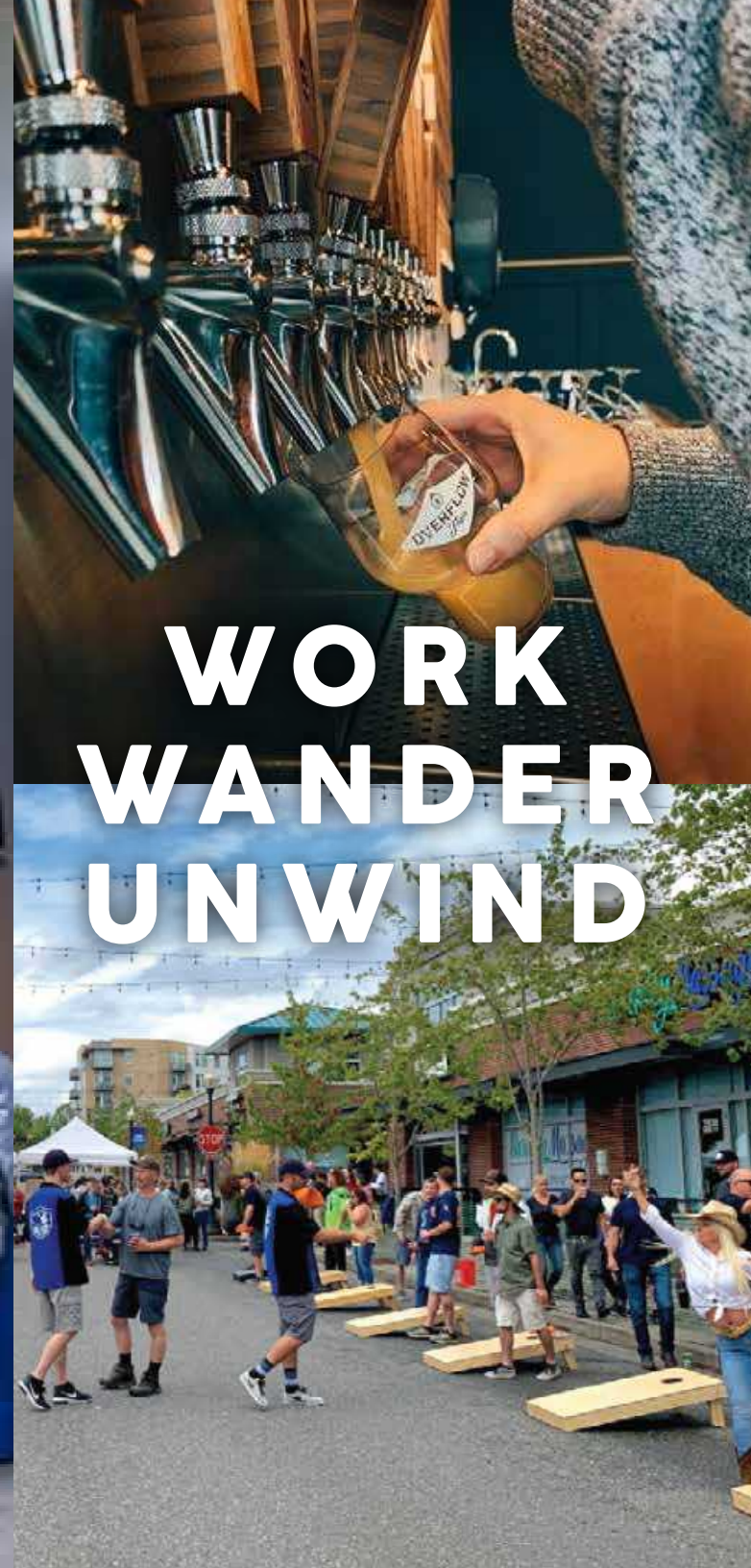

**WORK  
WANDER  
UNWIND**



# 2930 NEWMARKET STREET

## Suite 111

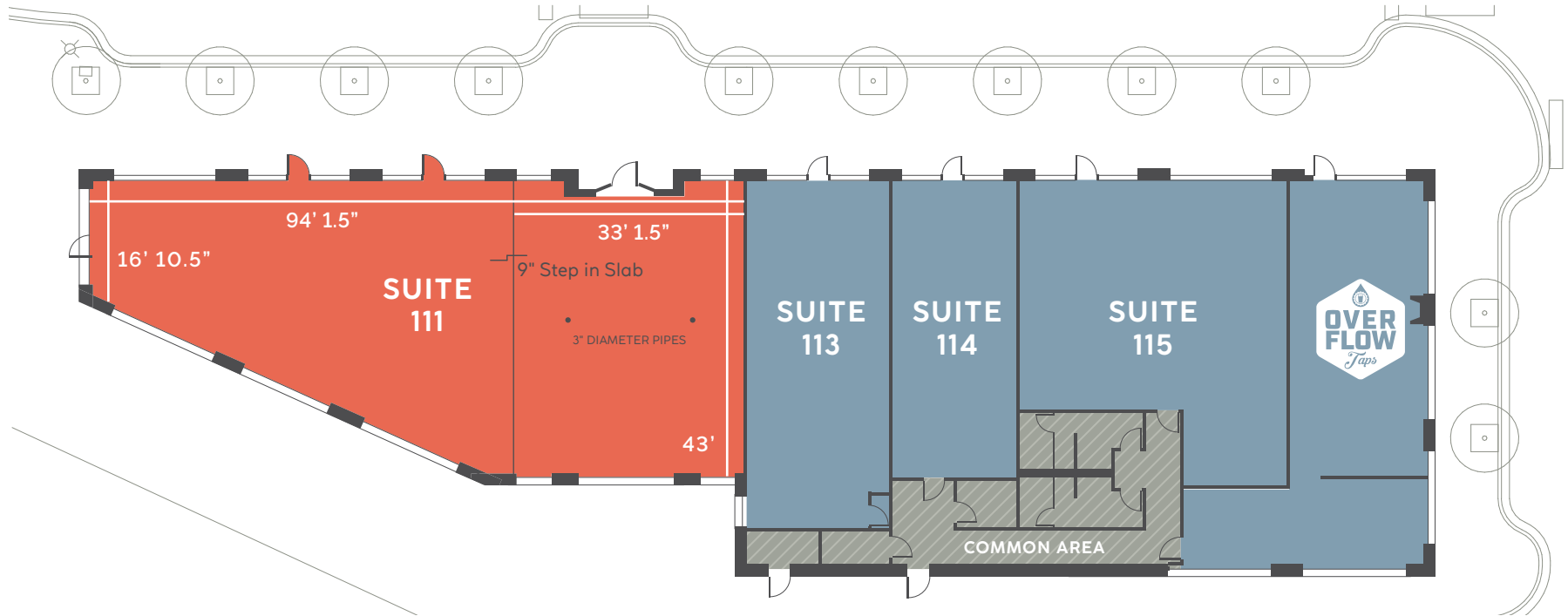

### Location Key

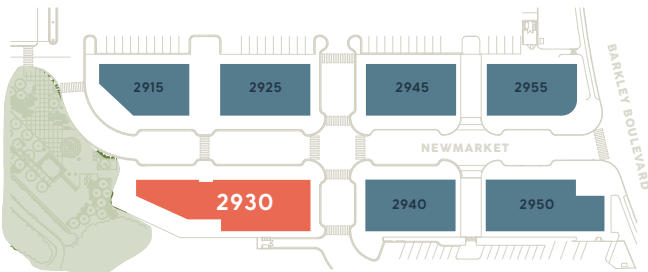

### QUICK OVERVIEW

Restaurant opportunity with  
expansive patio opportunity

Rentable SF: 3,635 SF

2930 Newmarket St  
Suite 111  
Bellingham, WA 98225



# 2930 NEWMARKET STREET

## Suite 113

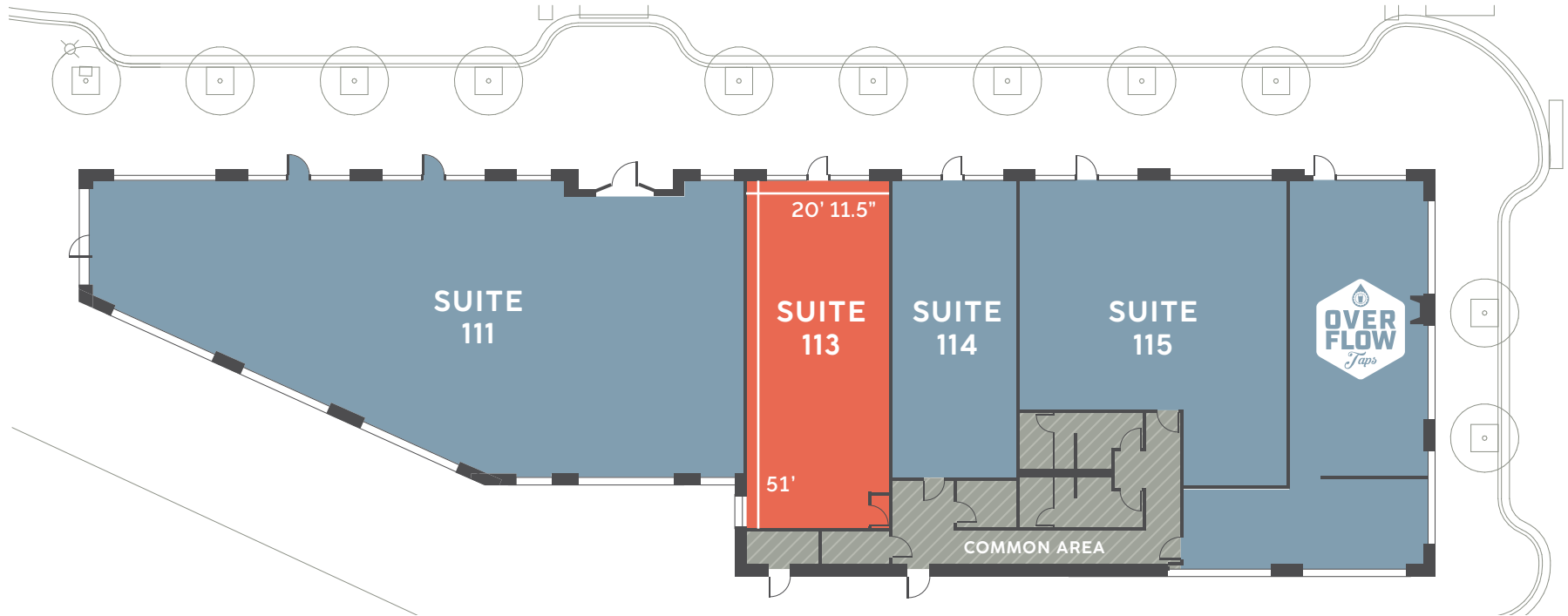

### Location Key

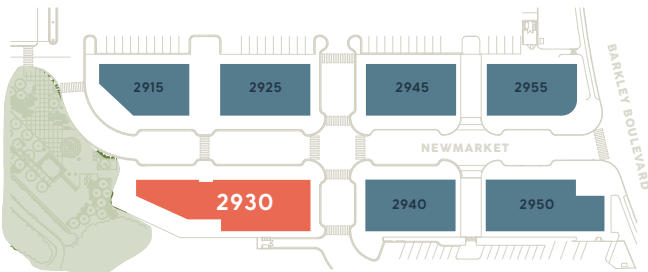

### QUICK OVERVIEW

Restaurant opportunity with  
shared bathroom

Rentable SF: 1,297 SF

2930 Newmarket St  
Suite 113  
Bellingham, WA 98225



# 2930 NEWMARKET STREET

## Suite 114

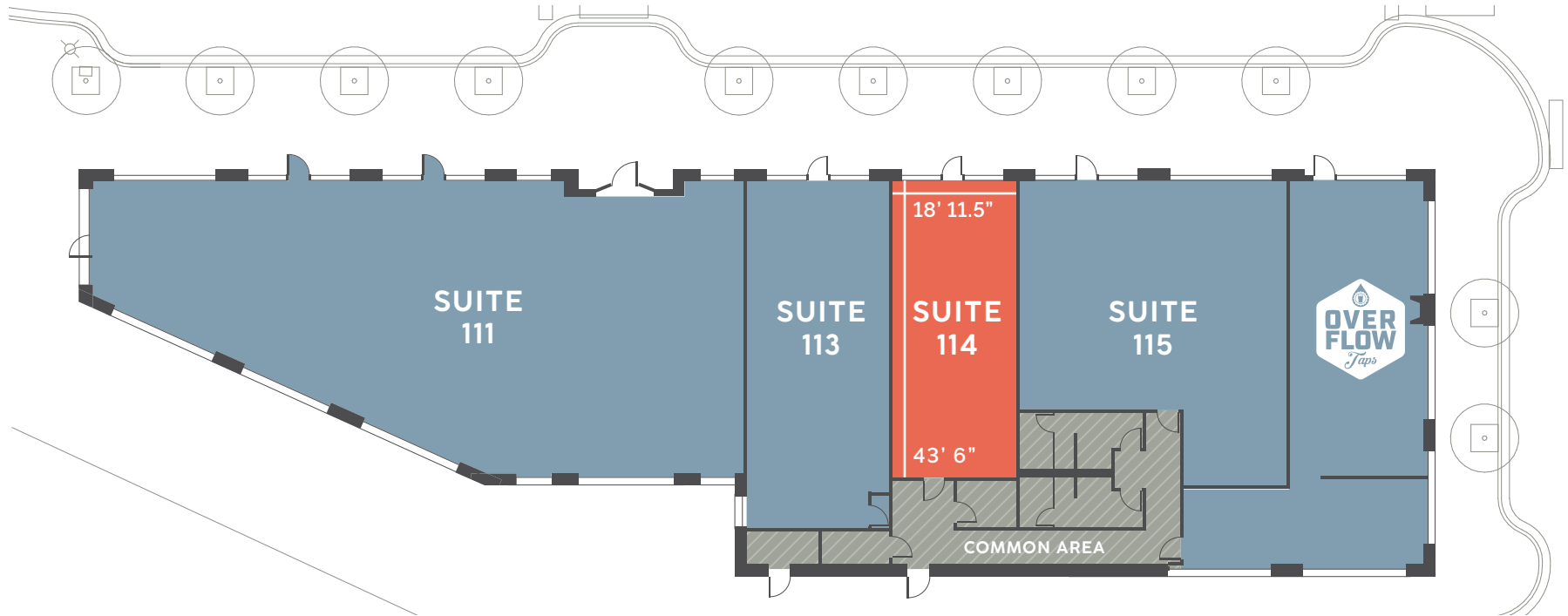

### Location Key

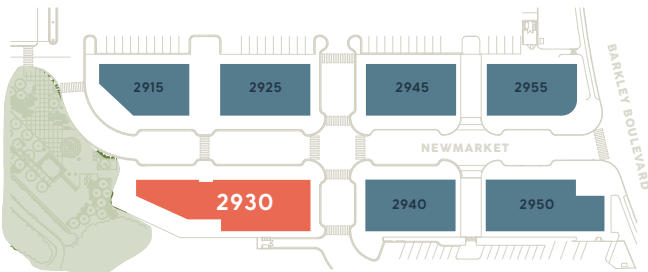

### QUICK OVERVIEW

Retail opportunity with shared bathroom; Delivered in vanilla shell condition

Rentable SF: 1,018 SF

2930 Newmarket St  
Suite 114  
Bellingham, WA 98225



# 2930 NEWMARKET STREET

## Suite 115

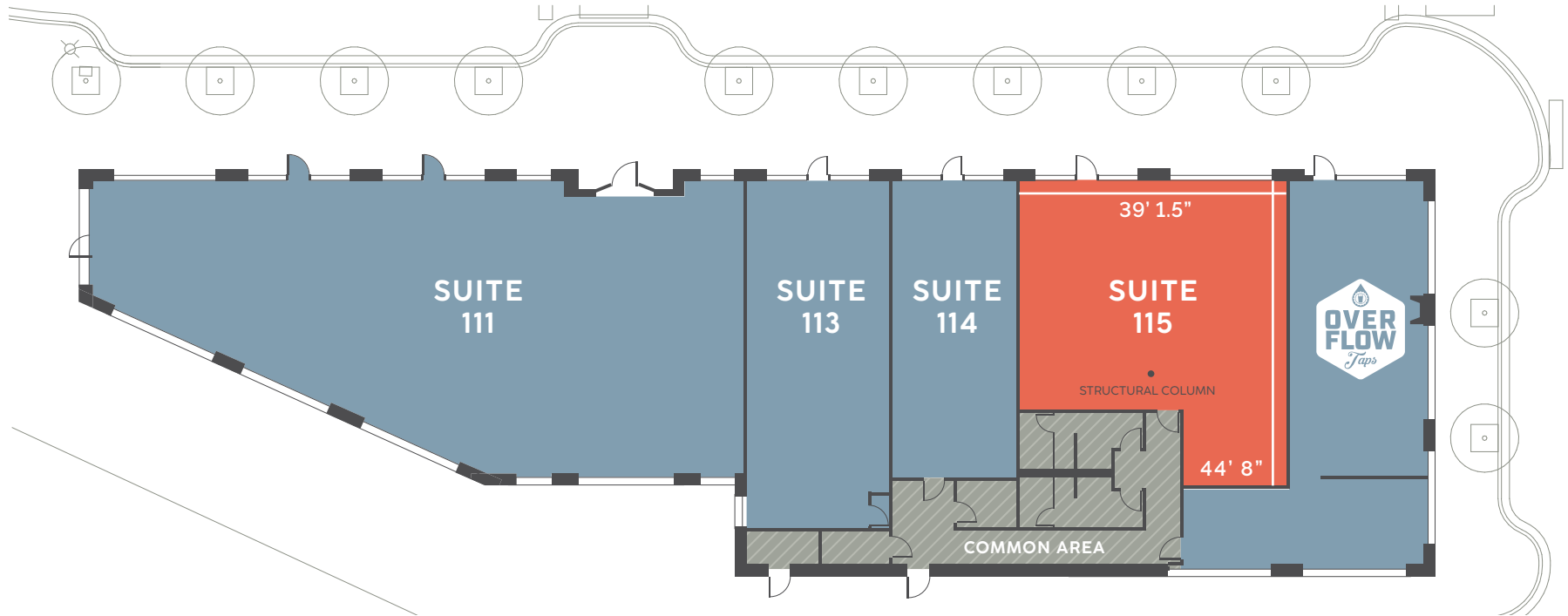

### Location Key

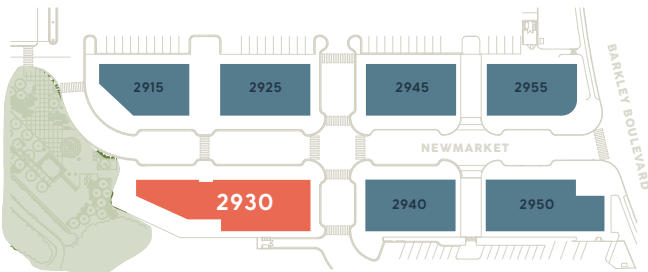

### QUICK OVERVIEW

Retail opportunity with shared bathroom; Delivered in vanilla shell condition and new storefront/entry

Rentable SF: 1,811 SF

2930 Newmarket St  
Suite 115  
Bellingham, WA 98225

# 2955 NEWMARKET STREET

## Suite 107

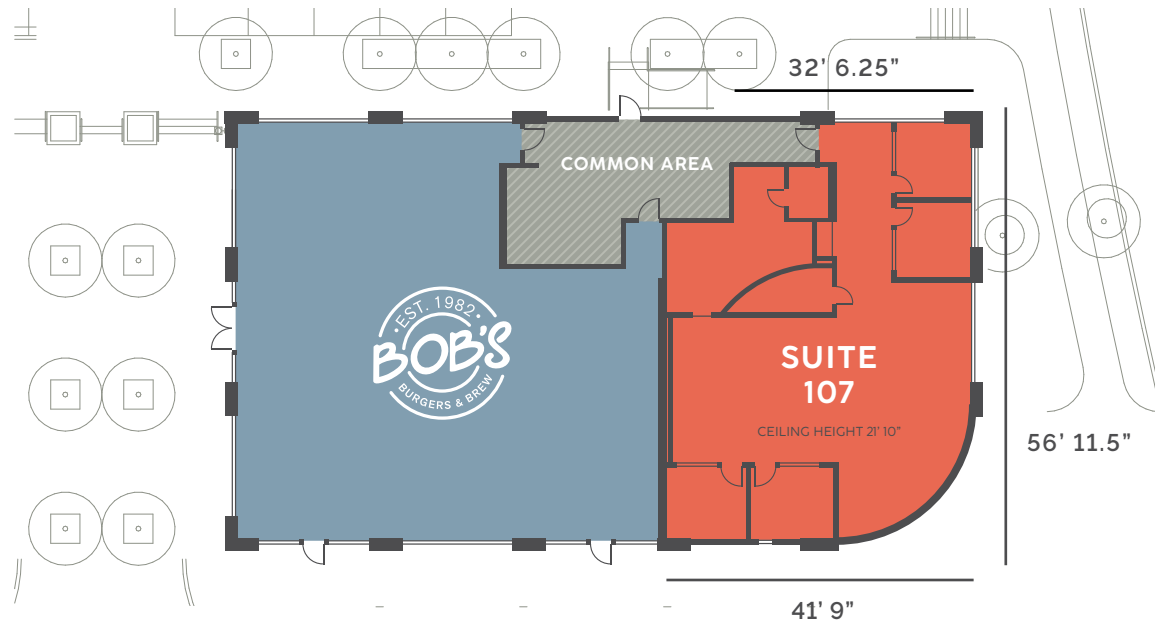

### Location Key

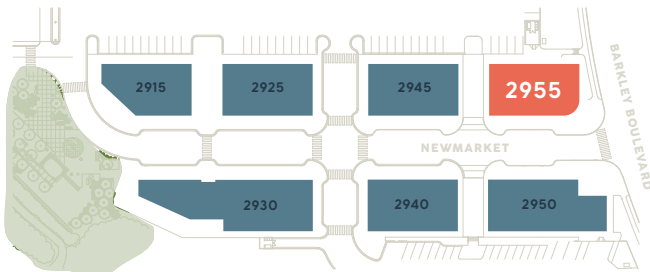

### QUICK OVERVIEW

Retail opportunity; Delivered with existing improvements

Rentable SF: 2,476 SF

2955 Newmarket St  
Suite 107  
Bellingham, WA 98225





**BarkleyVillage.com**

**For More Information**  
**GAGE COMMERCIAL**  
**REAL ESTATE, LLC**

---

**Tracy Carpenter**

Broker/Owner  
360.303.2608  
tracy@gagecre.com

**Greg Martineau, CCIM**

Broker/Owner  
360.820.4645  
greg@gagecre.com



©2025 The Talbot Group. All rights reserved. This information has been obtained from sources believed reliable but has not been verified for accuracy or completeness. You should conduct a careful, independent investigation of the property and verify all information. Any reliance on this information is solely at your own risk. The Talbot Group name and logo are service marks of The Talbot Group. All other marks displayed on this document are the property of their respective owners, and the use of such logos does not imply any affiliation with or endorsement of The Talbot Group. Photos herein are the property of their respective owners. Use of these images without the express written consent of the owner is prohibited.