

# Northwest Corporate Park Building B

6015 6th Avenue S, Seattle, WA 98108



Exclusively marketed by:



**JOHN VERNON**  
+1 425 586 5638  
jvernon@nai-psp.com

**TAMIR OHAYON**  
+1 425 586 5627  
tohayon@nai-psp.com

**BOB SWAIN, CCIM**  
+1 425 586 5622  
bswain@nai-psp.com



# 6015 6th Avenue S

Seattle, WA

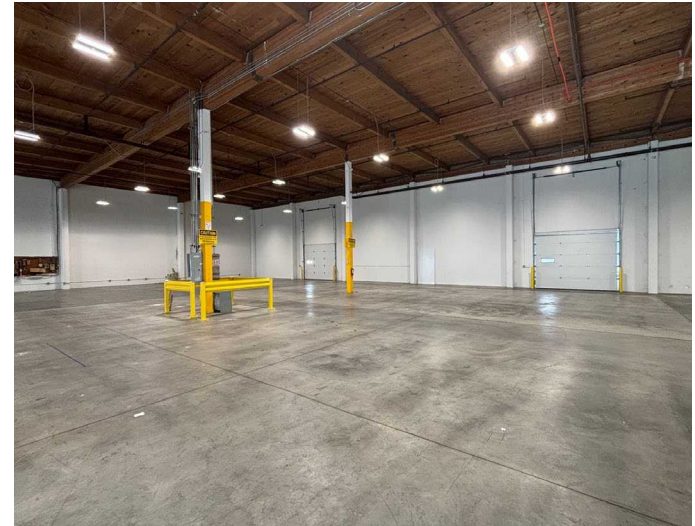

# Northwest Corporate Park, Building B

NAI Puget Sound Properties is pleased to present an opportunity to lease a prime office/warehouse space in Georgetown.

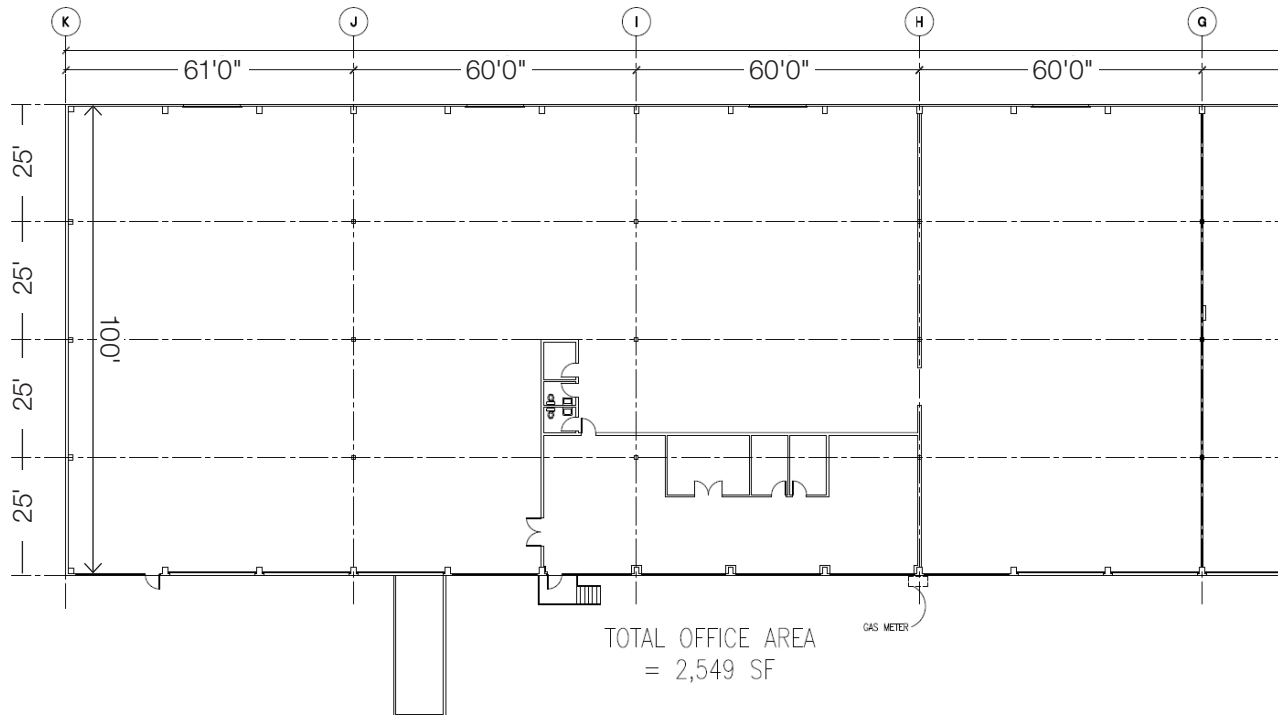

## IG2-85

Zoning

**TOTAL SF** 24,000 SF

**OFFICE SF** 2,549 SF

**DOCK DOORS** 8 DH & 1 ramp

**CLEAR HEIGHT** 22'

**AVAILABLE** March 1, 2026

**LEASE RATE** \$1.35 shell / \$1.50 office  
NNN (2025) \$0.45



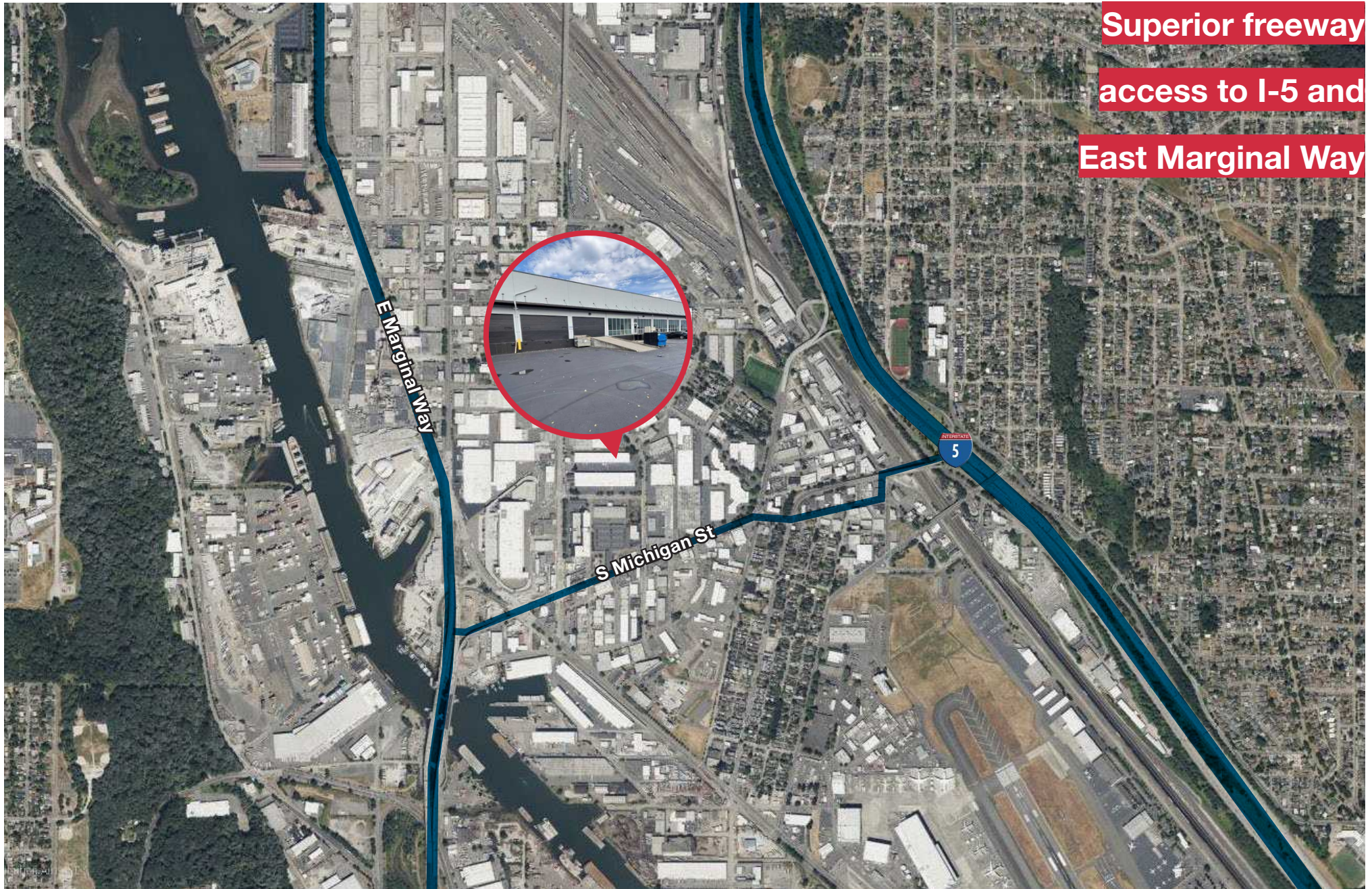



# Georgetown



Located within the industrial market, Georgetown is one of Seattle's oldest neighborhoods. Don't let the label fool you, the neighborhood has a sizable number of office and retail establishments in addition to manufacturing-oriented businesses. Food connoisseurs can enjoy an array of dining options in addition to an assortment of breweries in the area.

Due to its convenient location near the Port of Seattle and the urban core, Georgetown has seen robust growth and leasing activity with low vacancy rates. The area is centrally located with easy access to I-5, Boeing Field, Hwy 99 and minutes from downtown Seattle.





Exclusively marketed by:

**John Vernon**

+1 425 586 5638

[jvernon@nai-psp.com](mailto:jvernon@nai-psp.com)

**Tamir Ohayon**

+1 425 586 5627

[tohayon@nai-psp.com](mailto:tohayon@nai-psp.com)

**Bob Swain, CCIM**

+1 425 586 5622

[bswain@nai-psp.com](mailto:bswain@nai-psp.com)

**NAI** Puget Sound  
Properties