

Logan Building

508 Union Street,
Seattle, WA 98101

**Suite 508:
5,045 RSF
Available**



Key Features:

- Strategically located in Seattle's bustling core, with high foot and vehicular traffic
- Neighboring Tenant: Freya Bakery & Café + Hagen Coffee Roasters
- Surrounded by a strong mix of retail, office, and residential activity
- Near transit hubs, dining, and entertainment destinations
- Street frontage with excellent visibility
- Strong daytime population from nearby offices
- High walkability and downtown synergy



FLOOR PLAN

Suite 508:
5,045 RSF

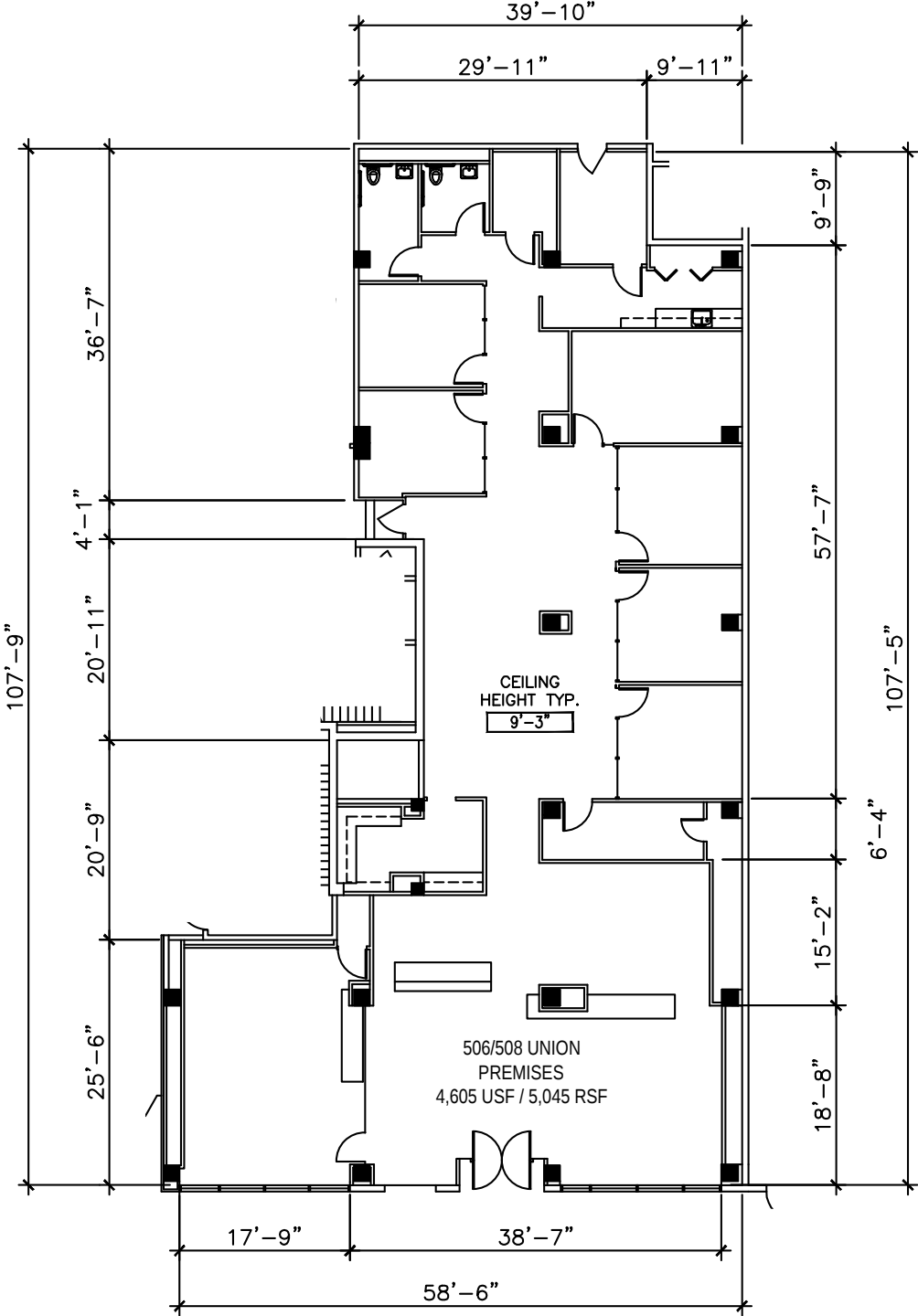

RETAIL

- | | |
|-------------------|---------------------|
| ① Pacific Place | ⑨ UNIQLO |
| ② Nordstrom | ⑩ Anthropologie |
| ③ Westlake Center | ⑪ Urban Outfitters |
| ④ Ben Bridge | ⑫ Pike Place Market |
| ⑤ Rolex | ⑬ Ben Paris |
| ⑥ Sephora | ⑭ TARGET |
| ⑦ Mario's | ⑮ PCC |
| ⑧ KÜHL | ⑯ SUITSUPPLY |

HOTELS

- | | |
|-----------------------|--------------------|
| ① Hyatt Regency | ⑨ Four Seasons |
| ② Hyatt @ Olive8 | ⑩ Fairmont Olympic |
| ③ Westin | ⑪ W Seattle |
| ④ The Paramount Hotel | |
| ⑤ Grand Hyatt | |
| ⑥ Hotel Theodore | |
| ⑦ Sheraton Grand | |
| ⑧ MOTIF | |

RESTAURANTS

- ① Dough Zone
- ② Cortina
- ③ The Fonte Bar
- ④ Fogo de Chão
- ⑤ The Capital Grill
- ⑥ purple
- ⑦ The George
- ⑧ Japonessa
- ⑨ Alder & Ash

ENTERTAINMENT

- ① The 5th Avenue Theatre
- ② Museum of Illusions

SEATTLE CONVENTION CENTER

- ① SUMMIT
- ② ARCH

SEATTLE PUBLIC LIBRARY

- ① Downtown Branch

HEALTH & WELLNESS

- ① Equinox
- ② Washington Athletic Club

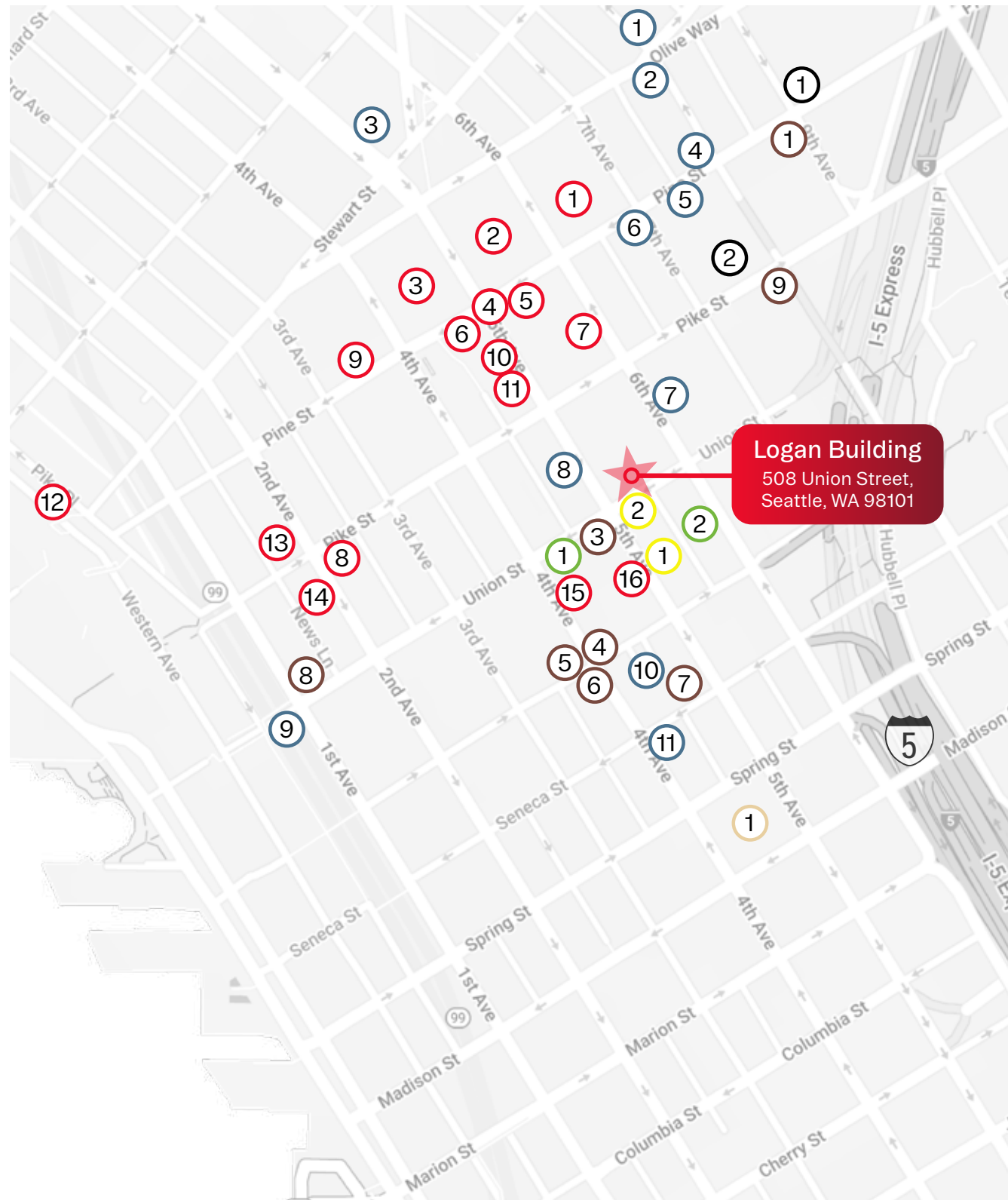

Prime Retail and Service Opportunity.

Demographics



POPULATION

2-Mile: 188,119

5-Mile: 501,301

10-Mile: 1,161,428



HOUSEHOLDS

2-Mile: 111,507

5-Mile: 249,797

10-Mile: 518,267



AVERAGE

HOUSEHOLD INCOME

2-Mile: \$134,913

5-Mile: \$145,159

10-Mile: \$147,754



Logan Building

508 Union Street,
Seattle, WA 98101

Tiffini Connell

tiffini@wccommercialrealty.com
206 854 1925

Avery Connell

avery@wccommercialrealty.com
206 475 9367

Katie Wright

katie@wccommercialrealty.com
206 979 2301

DISCLAIMER: The above information has been secured from sources believed to be reliable, however, no representations are made to its accuracy. Prospective tenants or buyers should consult their professional advisors and conduct their own independent investigation. Site plan and configuration are subject to change. Properties are subject to change in price and/or availability without notice. West Coast Commercial Realty, LLC



WCCR | West Coast
Commercial
Realty

206 283 5212
wccommercialrealty.com

