



# BELLEVUE TECH CENTER

NE 24th St & 156th Ave NE

WHERE WORKPLACE INNOVATION  
MEETS THE GREAT OUTDOORS



[LEASEBELLEVUETECH.COM](http://LEASEBELLEVUETECH.COM)

46.6  
ACRES

9  
BLDGS



PACIFIC OAK  
Keppel Pacific Oak US REIT



Kidder  
Mathews

REINTRODUCING

# THE HUB @BTC

Inspired by the interplay of nature and technology, our full amenity building offers  
**MORE TO EXPLORE, NEXT DOOR.**

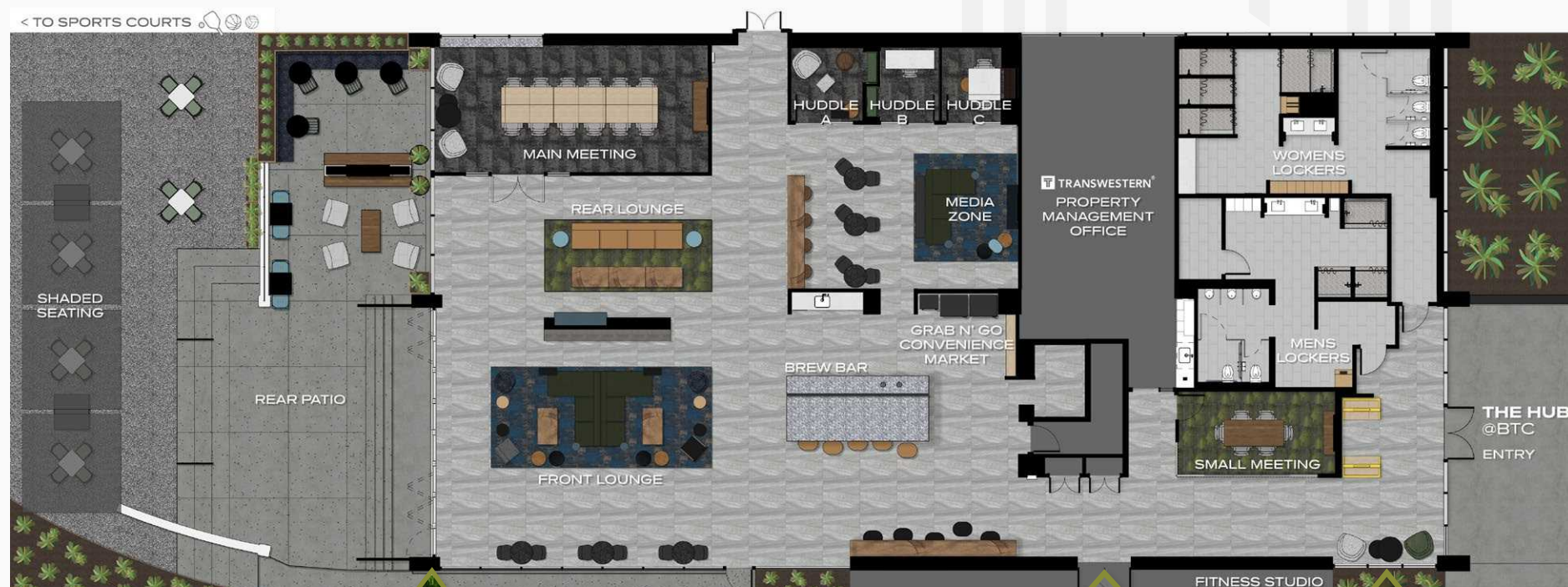

**ALL-SEASONS SPORTS COURTS**  
VOLLEYBALL | PICKLEBALL | BASKETBALL



**20' NANO WALL PROVIDING**  
INDOOR/OUTDOOR CONNECTION



**CARDIO FITNESS STUDIO &**  
RESORT-STYLE LOCKER ROOMS



**OPEN FOR DISCOVERY**  
8A - 5P | MON-FRI

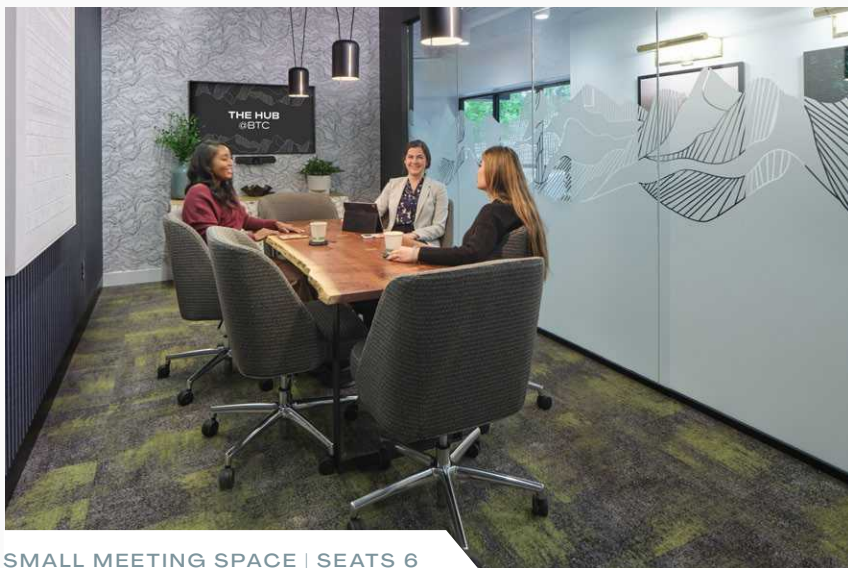

SMALL MEETING SPACE | SEATS 6

THERE'S MORE TO EXPLORE

## 5 PRIVATE MEETING SPACES FOR SOLO AND TEAM USE

THE HUB @BTC

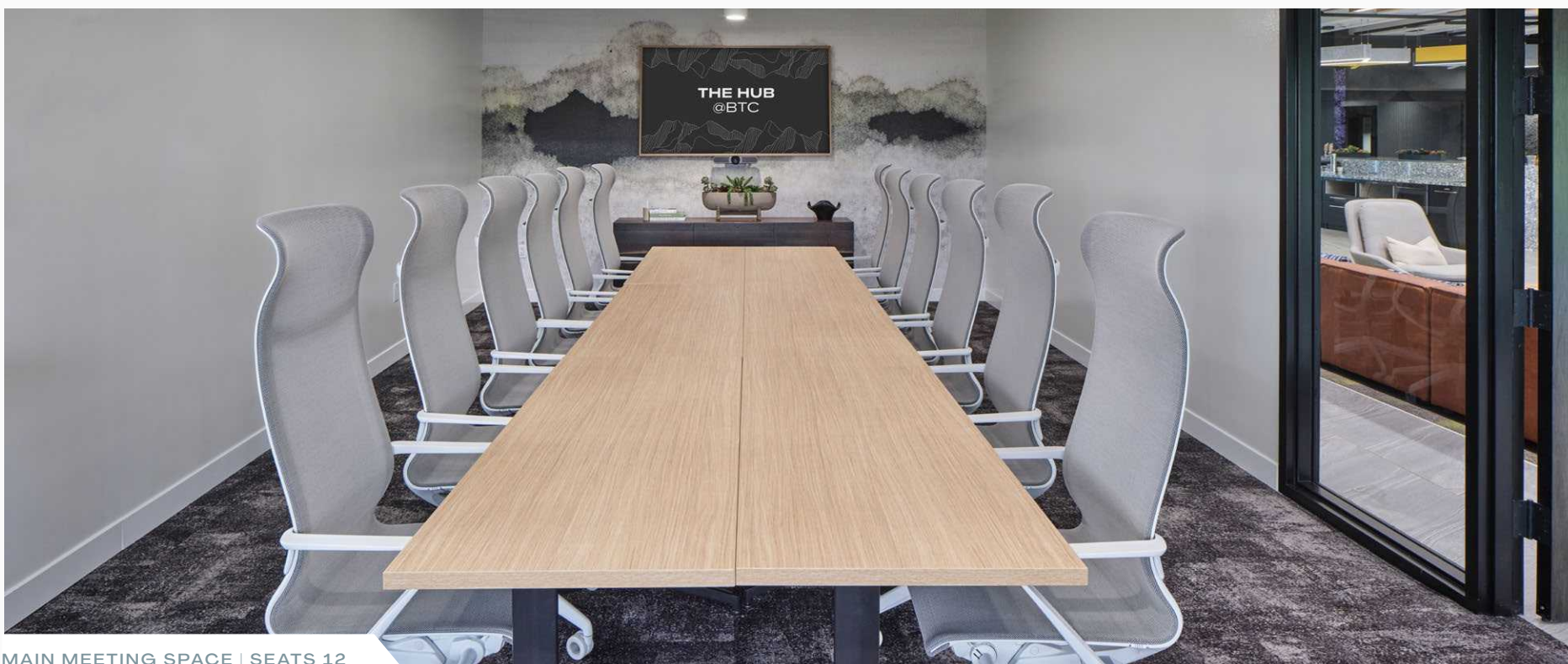

MAIN MEETING SPACE | SEATS 12

THERE'S MORE TO EXPLORE

## 15'L HOST BAR WITH ROTATING COLD BREW AND KOMBUCHA ON TAP

THE HUB @BTC

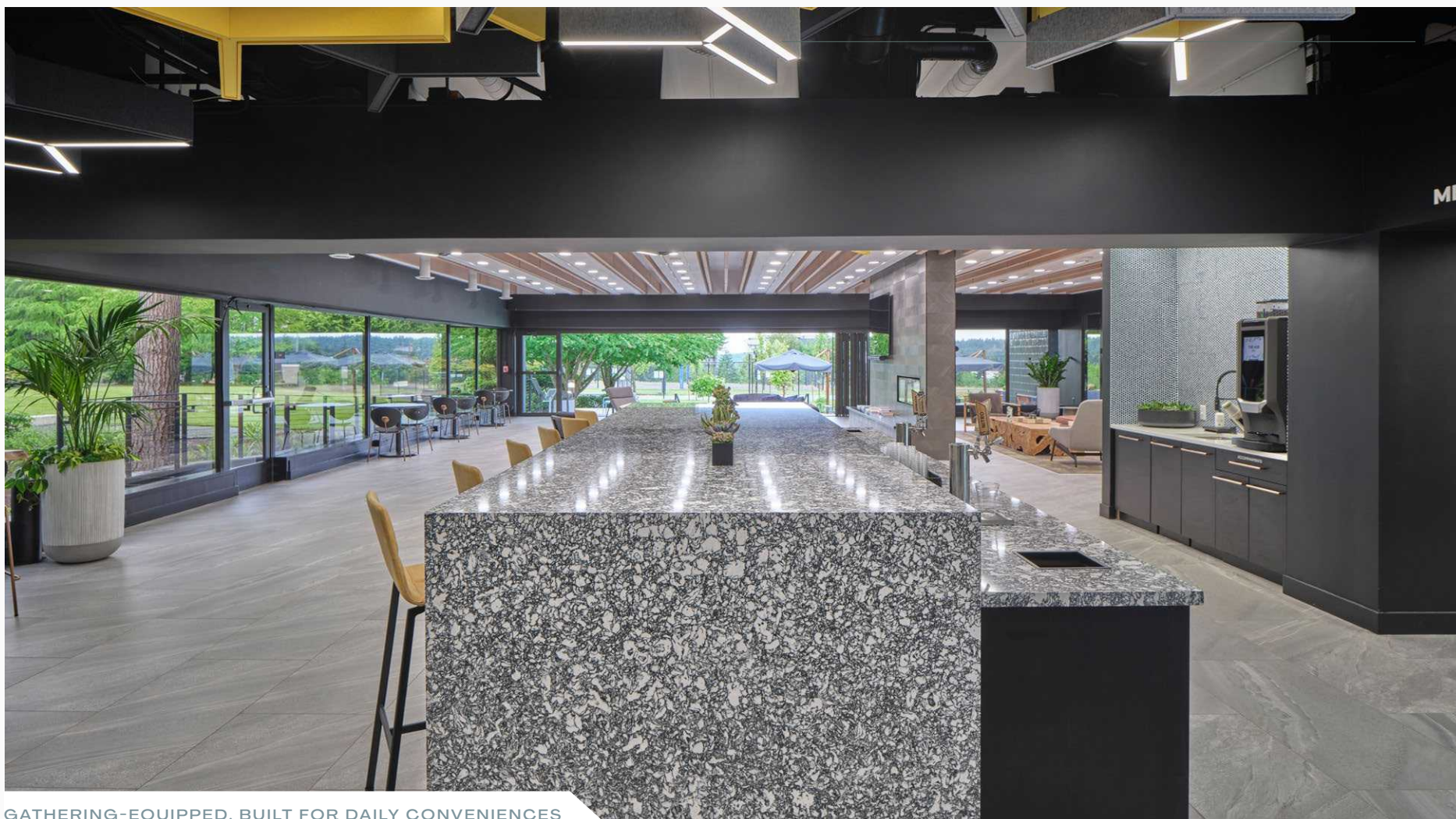

GATHERING-EQUIPPED, BUILT FOR DAILY CONVENIENCES

THERE'S MORE TO EXPLORE

**WELLNESS,  
DONE NATURALLY.**

THE HUB @BTC



GORGEOUS REAR PATIO WITH TWO-SIDED GAS FIREPLACE



FROM PICKLEBALL MATCHES TO PICKUP GAMES

# WHERE FLEXIBILITY TAKES ROOT

## ACTIVE AVAILABILITIES

BUILDING	SUITE(S)	RSF	ADDRESS
2002	100	9,979 RSF	2002 158th Ct NE
2002	200	9,984 RSF	2002 158th Ct NE
2010	300	8,865 RSF	2010 156th Ave NE



For leasing information:

**MARK FLIPPO** | 425.974.4007 | [mark.flippo@jll.com](mailto:mark.flippo@jll.com)

**JASON BLOOM** | 425.450.1102 | [jason.bloom@kidder.com](mailto:jason.bloom@kidder.com)



# FROM HERE TO ANYWHERE

**46.6 ACRE**

MASTERFULLY PLANNED  
TECH CAMPUS

**9**

OFFICE BUILDINGS

**1 MILE**

FROM MICROSOFT  
WORLD HEADQUARTERS

EASY ACCESS TO

**SR-520 & I-405**

**6**

METRO TRANSIT STOPS  
SURROUNDING THE CAMPUS,  
INCLUDING RAPID RIDE

NEARBY BELLEVUE'S  
OVERLAKE NEIGHBORHOOD,  
DOWNTOWN BELLEVUE, &  
REDMOND TOWN CENTER

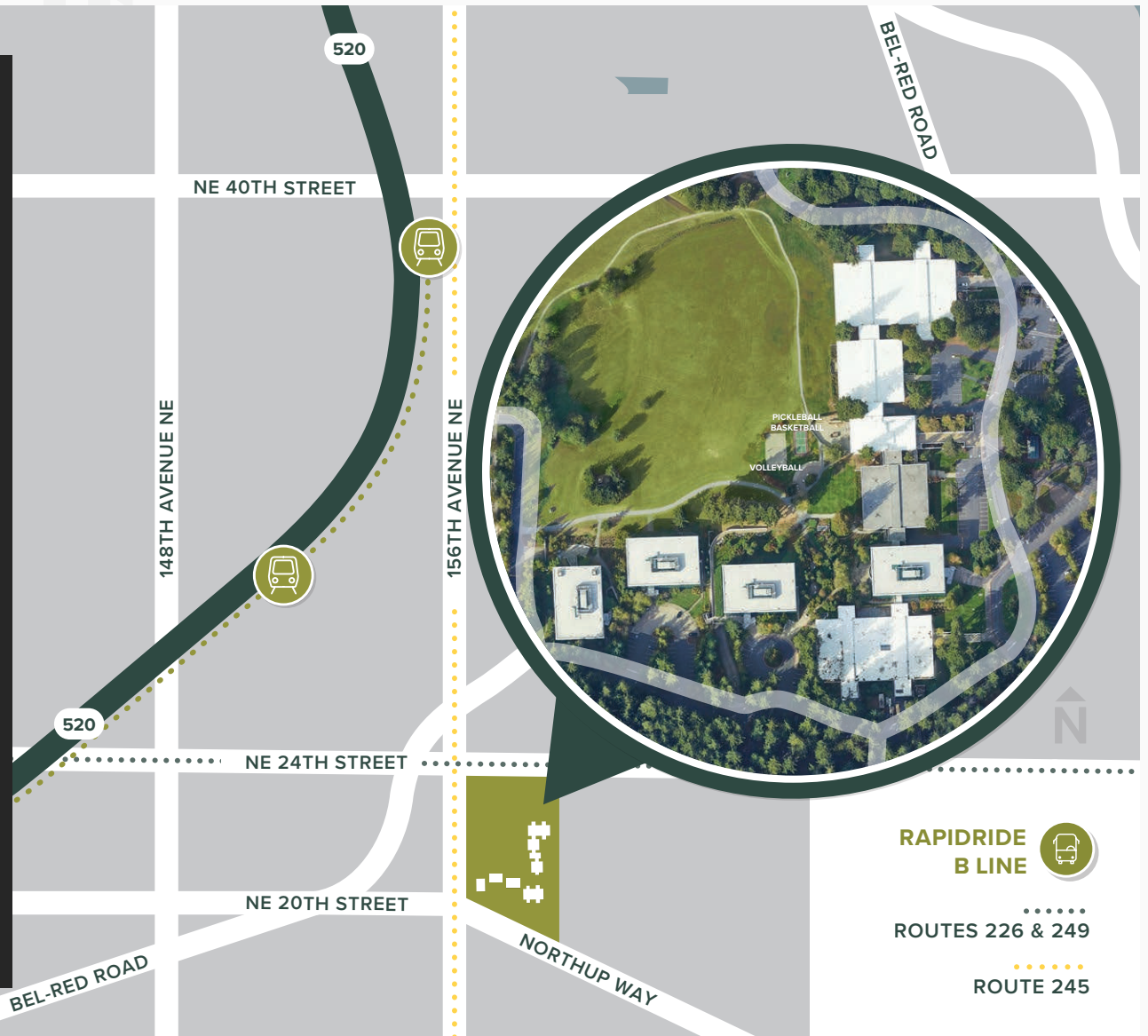

**RAPIDRIDE  
B LINE**



.....  
ROUTES 226 & 249

.....  
ROUTE 245

# EXPLORE NEW SURROUNDINGS

30+  
DINING  
OPTIONS

20+  
BANKS &  
SERVICES

20+  
NEIGHBORING  
RETAILERS



SURROUNDING CONVENIENCES WITHIN 1 MI. OF BTC

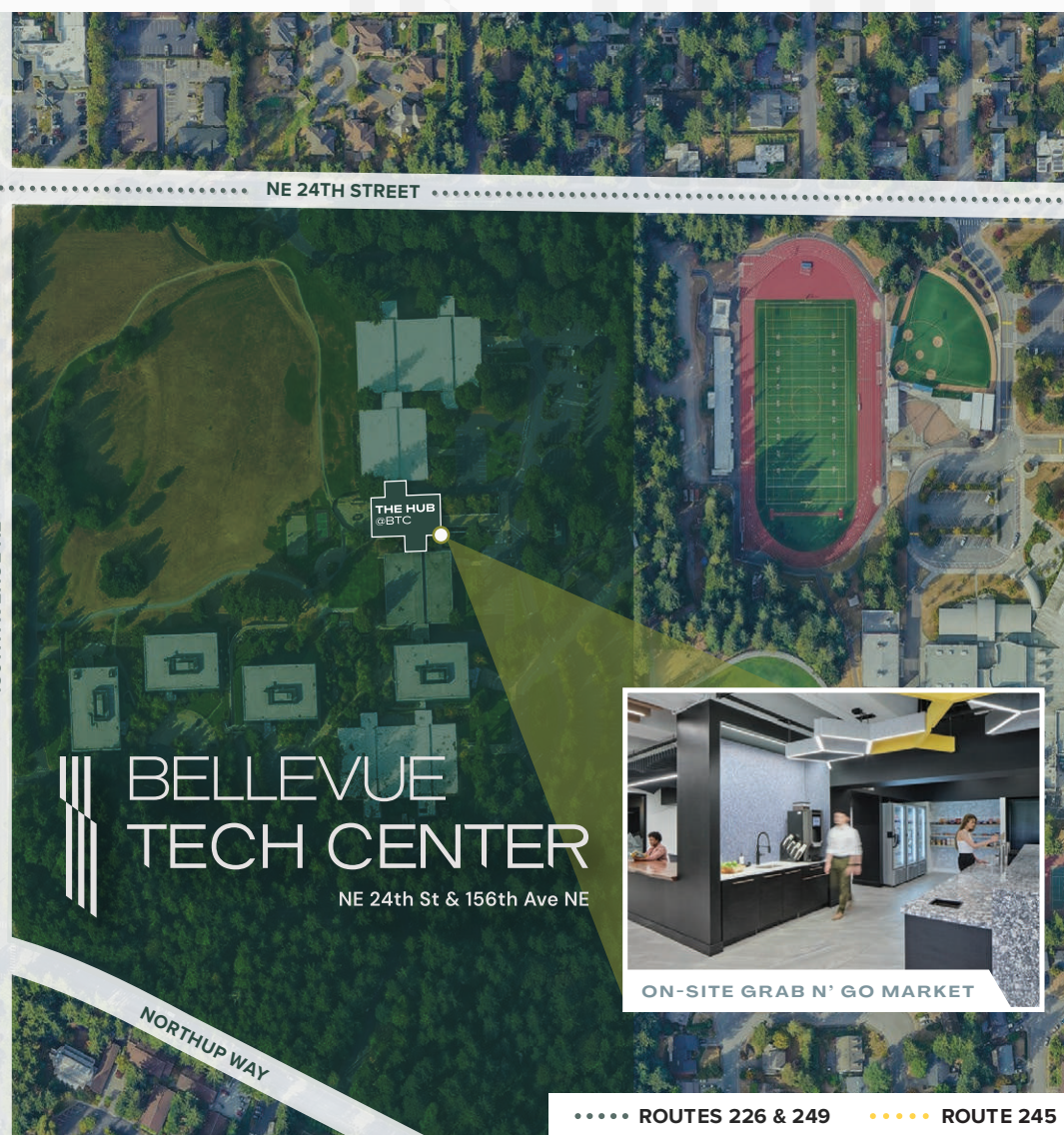



**MARK FLIPPO**

425.974.4007

mark.flippo@jll.com



**Kidder  
Mathews**

**JASON BLOOM**

425.450.1102

Jason.Bloom@kidder.com

Although information has been obtained from sources deemed reliable, neither Owner nor JLL makes any guarantees, warranties or representations, express or implied, as to the completeness or accuracy as to the information contained herein. Any projections, opinions, assumptions or estimates used are for example only. There may be differences between projected and actual results, and those differences may be material. The Property may be withdrawn without notice. Neither Owner nor JLL accepts any liability for any loss or damage suffered by any party resulting from reliance on this information. If the recipient of this information has signed a confidentiality agreement regarding this matter, this information is subject to the terms of that agreement.

© 2024 • Jones Lang LaSalle Brokerage Inc. | Lic #01856260

**LEASEBELLEVUETECH.COM**



**PACIFIC OAK**

**Keppel Pacific Oak US REIT**

