

FOR LEASE

**LOCATION:**

This property is ideally located just east of the NEC of Sprague Avenue and Park Road. Convenient access to I-90 via Sprague and/or Broadway interchanges. Former location of Affordable Brakes and Suspension.

SITE:

A portion of a multi-tenanted complex; a portion of parcel # 45183.9161

ZONING:

City of Spokane Valley RC, Regional Commercial

IMPROVEMENTS:

Footprint Area:	±5,133 SF
Office/Showroom Area:	±1,535 SF
Parts & Shop Area:	±3,598 SF
Heat:	Office/Showroom: Central forced air gas Shop Area: Two (2) gas fired unit heaters
Grade-Level Loading:	One (1) OHD, 10'W x 11'H
Water:	East Sprague Water District #1
Sewer:	Serviced by Spokane County Utilities
Construction Type:	Concrete tilt
Age:	1966
Note:	Lighting upgraded in 2020
Availability:	Immediately

2025 RE TAXES & FIRE INSURANCE:

Estimated at \$326.00/month for fire insurance, RE taxes, and property management. Tenant pays water, sewer, garbage, gas, electric, landscaping, parking lot maintenance & snow removal.

LEASE PRICE:

\$3,000.00/Mo/NNN

Mark Lucas, SIOR | 509.755.7524 or mlucas@kiemlehagood.com

Tracy Lucas | 509.755.7558 or tracyl@kiemlehagood.com

FOR LEASE SHOWROOM OFFICE PARTS SHOP

7505 E. Sprague Ave.
Spokane Valley, WA
99212

**View
Location**



**KIEMLE
HAGOOD**

All information herein is furnished by the owner and believed to be complete and correct. The Agent, however, cannot be responsible for changes, errors, omissions or withdrawals of this offering without notice. The above information is from sources deemed reliable but should be verified by parties that could be adversely affected by any statements or information. This is not an offering of sub-agency, with commission splits to be determined. 06/02/25/tp J:\BROKERS\LUCAS DOCS\FLYERS\Sprague E 7505.PUB



SHOWROOM · OFFICE · PARTS · SHOP | 7505 E. Sprague Ave., Spokane Valley, WA 99212



Mark Lucas, SIOR | 509.755.7524 or mlucas@kiemlehagood.com

Tracy Lucas | 509.755.7558 or tracyl@kiemlehagood.com

Kiemle Hagood respects the intellectual property of others: If you believe the copyright in your work has been violated through this Website, please contact our office for notice of claims of copyright infringement. For your complaint to be valid under the Digital Millennium Copyright Act of 1998 (DMCA), you must provide the following information when providing notice of the claimed copyright infringement: Identify the material on the Website that you believe infringes your work, with enough detail so that we may locate it on the Website; provide your address, telephone number and email address; provide a statement that you have a good faith belief that the disputed use is not authorized by the copyright owner, its agent, or the law; provide a statement that the information in the notification is accurate, and under penalty of perjury, that the complaining party is authorized to act on behalf of owner of an exclusive right that is allegedly infringed; provide your physical or electronic signature. Upon receiving your complaint, Kiemle Hagood will, upon review, remove content that you believe infringes your copyright if the complaint is found valid.

FLOOR PLAN

7505 E. Sprague Avenue, Spokane Valley, WA 99212

THIS DRAWING IS FOR CONVENIENCE ONLY. ALL CRITICAL MEASUREMENTS SHOULD BE VERIFIED BY PURCHASER OR LESSEE. ALL RIGHTS RESERVED. NO PART OF THIS DOCUMENT MAY BE REPRODUCED IN ANY FORM OR BY ANY MEANS WITHOUT WRITTEN PERMISSION FROM MARK & TRACY LUCAS.

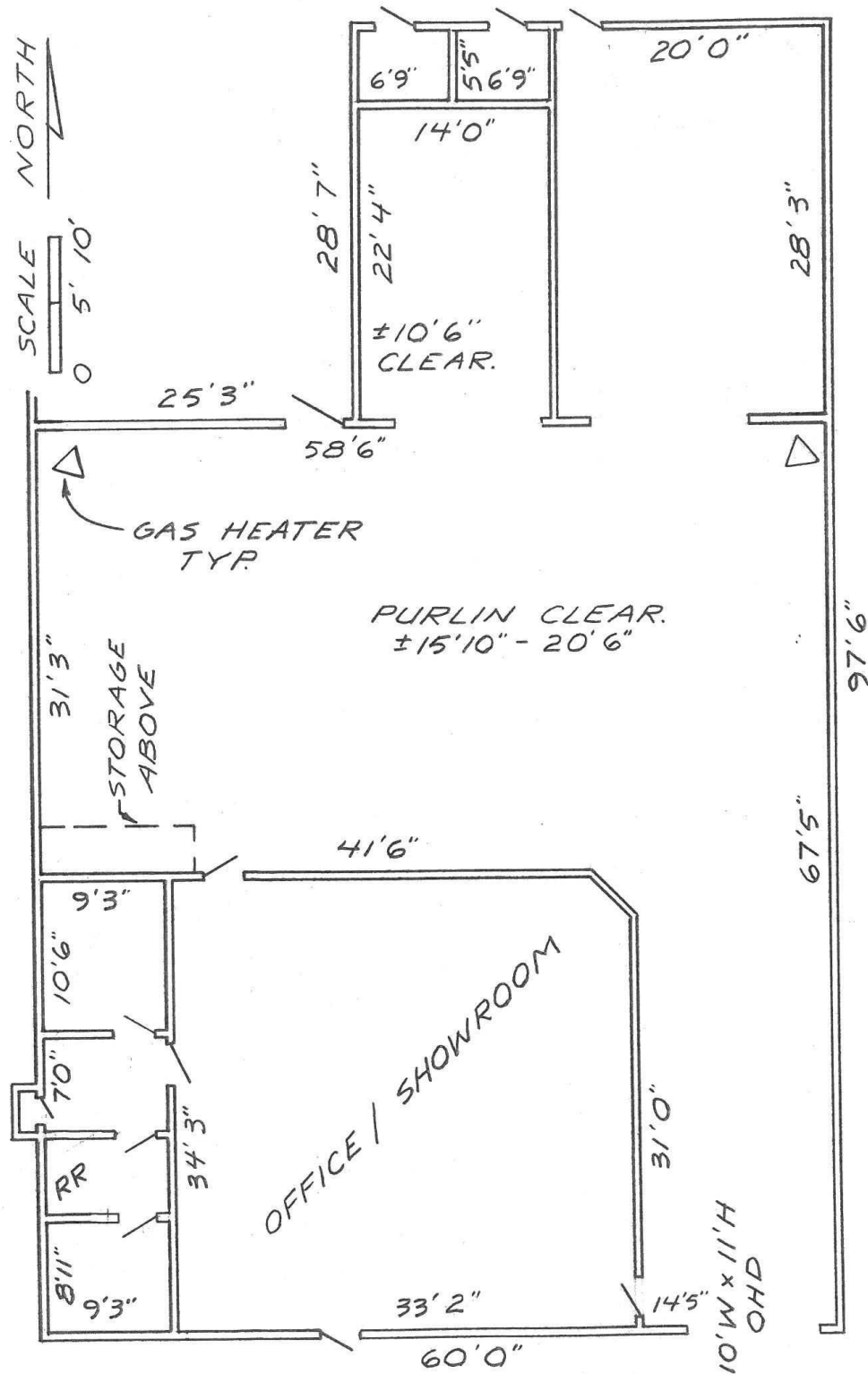

Mark Lucas, SIOR | 509.755.7524 or mlucas@kiemleahagood.com

Tracy Lucas | 509.755.7558 or tracyl@kiemleahagood.com

KIEMLE
HAGOOD

SITE PLAN

7505 E. Sprague Avenue, Spokane Valley, WA 99212



PHOTOS



Mark Lucas, SIOR | 509.755.7524 or mlucas@kiemlehagood.com

Tracy Lucas | 509.755.7558 or tracyl@kiemlehagood.com

KIEMLE
HAGOOD