

AUBURN ITC BLDG A, STE 110



*Industrial Space
For Lease*

35,991
TOTAL SF

4,310
OFFICE SF

CALL
FOR RATES

35,991 SF total (4,310 SF office: 2,537 down / 1,971 up)

Can combine with Suite 120 for 70,011 SF (6,282 SF)

6 dock-high doors / 1 grade-level door

24' clear height

M-1 zoning

Easy access to SR-167 via 277th St or 15th St & access to I-5 via 277th St

Canopies over loading doors

50' concrete aprons

Call agent for rates and availability

CHRIS CORR
206.248.7324
chris.corr@kidder.com

MATT MURRAY, SIOR
206.248.6541
matt.murray@kidder.com

KIDDER.COM

This information supplied herein is from sources we deem reliable. It is provided without any representation, warranty, or guarantee, expressed or implied as to its accuracy. Prospective Buyer or Tenant should conduct an independent investigation and verification of all matters deemed to be material, including, but not limited to, statements of income and expenses. Consult your attorney, accountant, or other professional advisor.

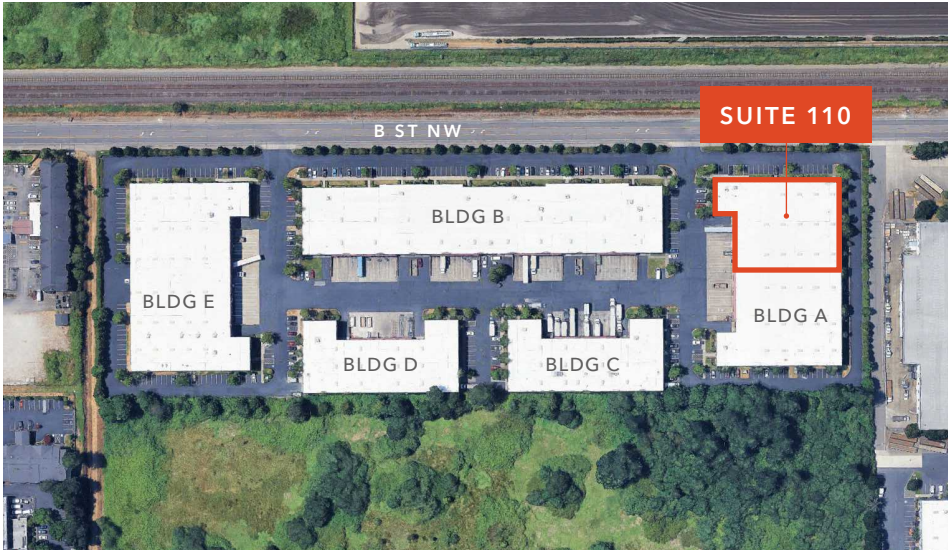

35,991 SF

TOTAL AVAILABLE

4,310 SF

OFFICE

CALL

FOR RATES

SUITE 110 FLOORPLAN

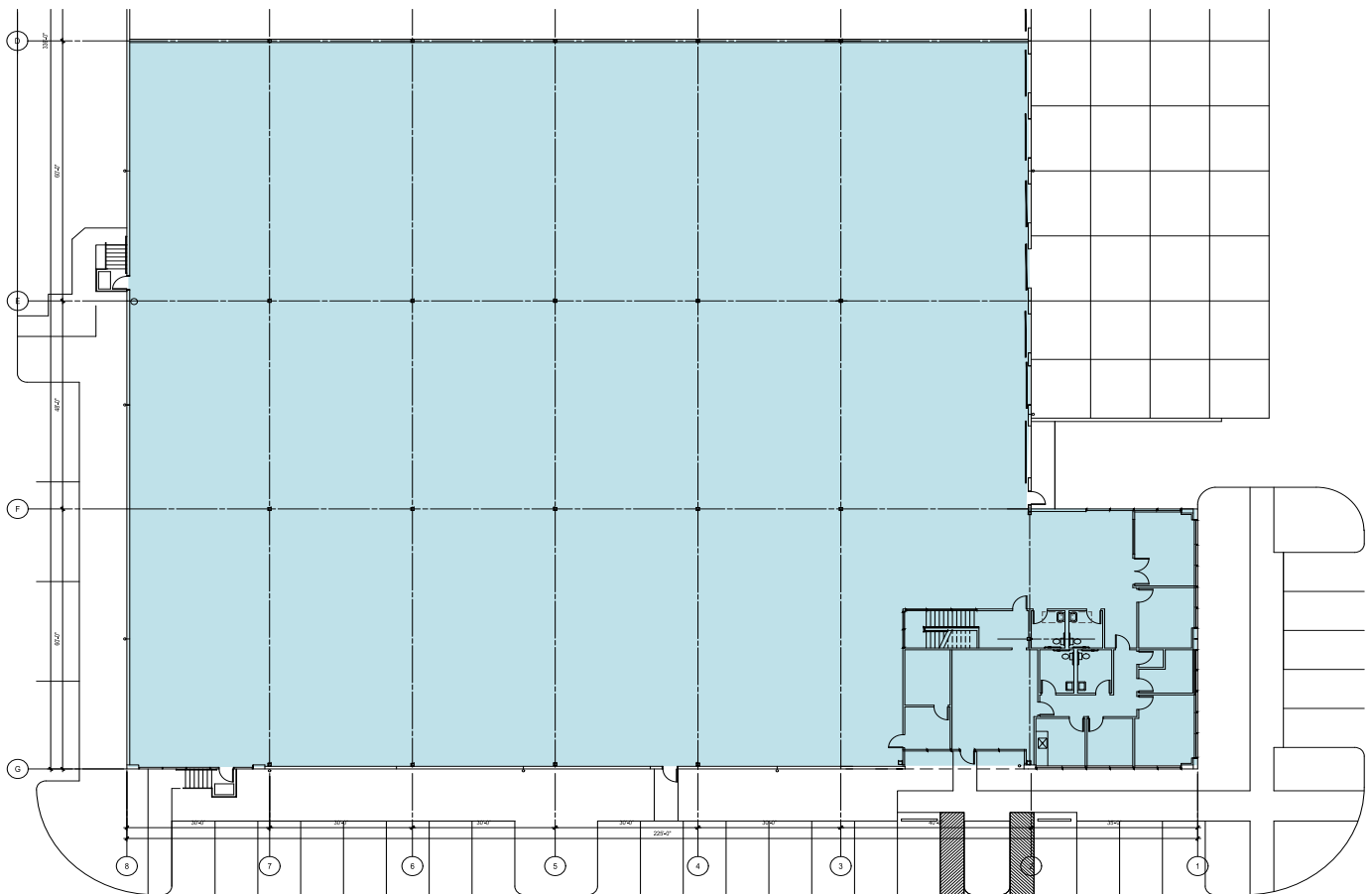

KIDDER.COM

This information supplied herein is from sources we deem reliable. It is provided without any representation, warranty, or guarantee, expressed or implied as to its accuracy. Prospective Buyer or Tenant should conduct an independent investigation and verification of all matters deemed to be material, including, but not limited to, statements of income and expenses. Consult your attorney, accountant, or other professional advisor.

