

Auburn Commerce Center

3416 B Street N.W., Suite A, Auburn, WA



NOW LEASING
**Manufacturing/Distribution/
Storage**
14,246 SF

FEATURES

Bay Size: 14,246 SF (includes mezzanine, one (1) bathroom, no existing office)

Loading Doors: 2 dock high doors (9'x10')
1 grade level door (12'x14')

Height: 24' clear
Concrete tilt-up

Power: 3 phase - 277/480v

Fire Protection: ESFR Sprinklers
High pile

Zoning: Auburn M2

Access: Convenient to SR 167 via
15th Street NW or S. 277th Street

Available: VACANT

Lease Rate: Negotiable

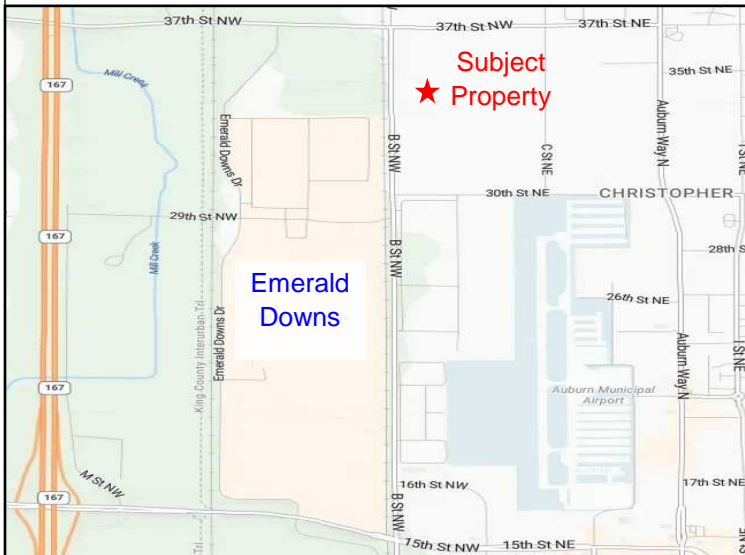

Robert B. Chadek

2050 112th Avenue SE, Suite 230, Bellevue, WA

(425) 453-5354

AUBURN COMMERCE CENTER

'B' STREET N.W.

SITE PLAN

▲ 12' x 14' ON-GRADE ROLL-UP DOOR
 ▲ 9' x 12' DOCK HIGH ROLL-UP DOOR

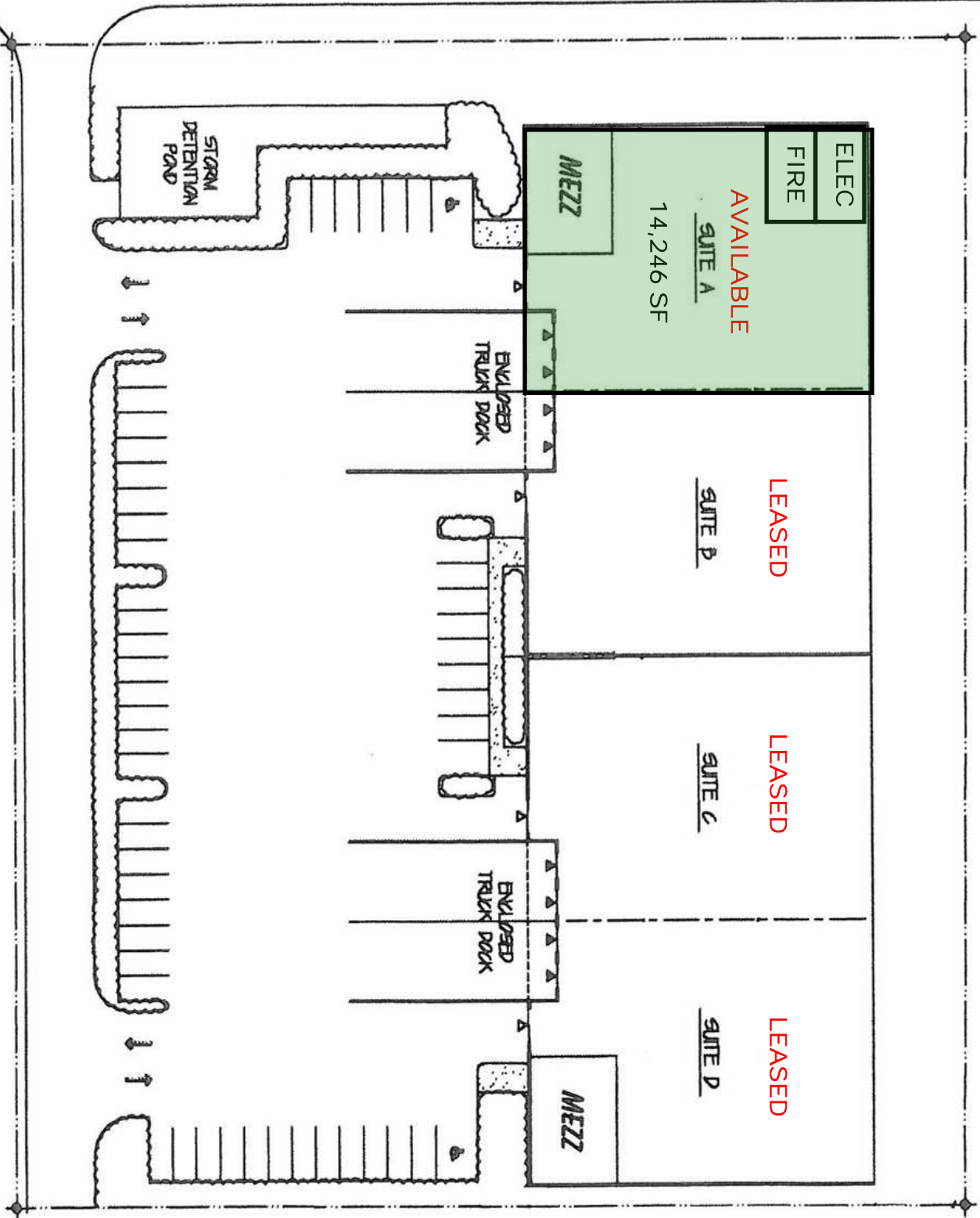

The information contained herein has been obtained from sources believed to be reliable. While we do not doubt its accuracy, we have not verified it and make no guarantee, warranty or representation about it. It is your responsibility to independently confirm its accuracy and completeness. Any projections, opinions or estimates are for example only and do not represent the current or future performance of the property. The value of this transaction to you depends on tax and other factors which should be evaluated by your tax, financial and legal advisors. You and your advisors should conduct a careful, independent investigation of the property to determine the suitability of the property for your needs.

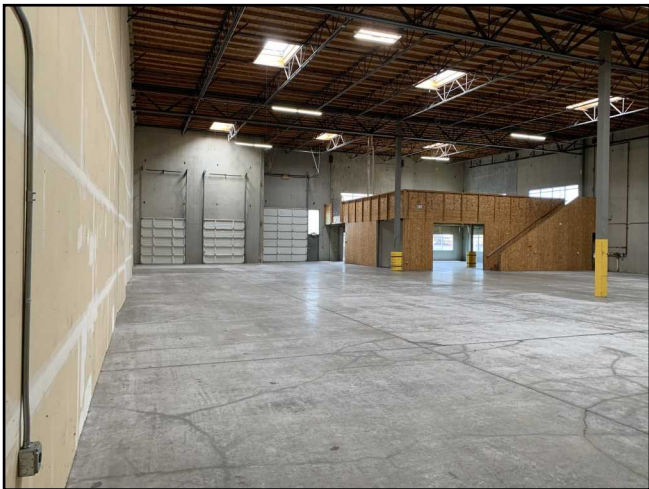

Auburn Commerce Center - Suite A



The information contained herein has been obtained from sources believed to be reliable. While we do not doubt its accuracy, we have not verified it and make no guarantee, warranty or representation about it. It is your responsibility to independently confirm its accuracy and completeness. Any projections, opinions or estimates are for example only and do not represent the current or future performance of the property. The value of this transaction to you depends on tax and other factors which should be evaluated by your tax, financial and legal advisors. You and your advisors should conduct a careful, independent investigation of the property to determine the suitability of the property for your needs.