

FOR LEASE

PLAZA II

12020 MERIDIAN E, PUYALLUP, WA 98373



JEROME O'LEARY
Senior Vice President
T: 253.779.9292
C: 253.732.2600
jerome.oleary@kidder.com

Join Car Toys, Sylvan Learning Center, & others

Prime location

Suite E 2,126 SF

Suite F & G 2,756 SF

Suite H 1,606 SF

Can combine Suites E, F, G & H for 6,488 SF

Excellent South Hill location

42,000+ CPD

Fully signalized access

Quality office build-out

Abundant parking

\$20.00

PSF, PLUS NNN

\$8.00

EST NNN, PSF

KIDDER.COM

This information supplied herein is from sources we deem reliable. It is provided without any representation, warranty, or guarantee, expressed or implied as to its accuracy. Prospective Buyer or Tenant should conduct an independent investigation and verification of all matters deemed to be material, including, but not limited to, statements of income and expenses. Consult your attorney, accountant, or other professional advisor.





KIDDER.COM

This information supplied herein is from sources we deem reliable. It is provided without any representation, warranty, or guarantee, expressed or implied as to its accuracy. Prospective Buyer or Tenant should conduct an independent investigation and verification of all matters deemed to be material, including, but not limited to, statements of income and expenses. Consult your attorney, accountant, or other professional advisor.

SITE PLAN

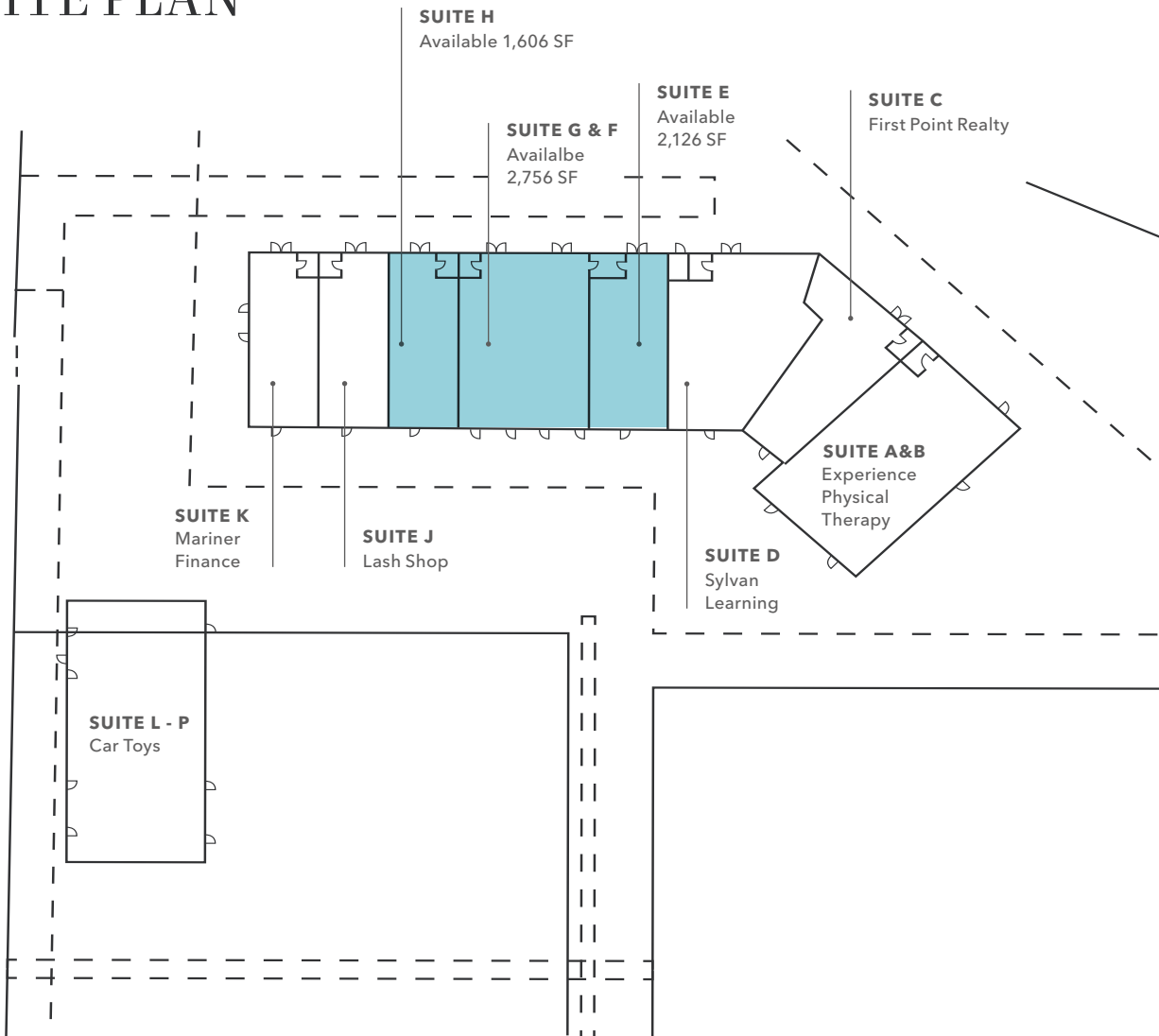

1,606 SF

SUITE H AVAILABLE

2,756 SF

SUITE G & F AVAILABLE

2,126 SF

SUITE E AVAILABLE

6,488 SF

SUITE E, F, G & H AVAILABLE

CONTACT

BROKER FOR MORE INFORMATION

FOR LEASE



KIDDER.COM

This information supplied herein is from sources we deem reliable. It is provided without any representation, warranty, or guarantee, expressed or implied as to its accuracy. Prospective Buyer or Tenant should conduct an independent investigation and verification of all matters deemed to be material, including, but not limited to, statements of income and expenses. Consult your attorney, accountant, or other professional advisor.

