

# TURN-KEY OFFICE IN FIFE

5050 20TH STREET E, FIFE, WA 98424



## AVAILABLE FOR LEASE

### SUITE 101

**3,050 SF**  
(Ability to add the large reception area adjacent to the space for an additional 500 SF)

### LEASE RATE

**\$19.50/SF**  
**Modified Gross**

### COMMENTS

Electricity and other utilities are covered by Landlord, and the interior maintenance and janitorial is covered by Tenant

### OPEN FLOOR PLAN

Suite 101 offers a bright and open floor plan, abundant free parking and is fully furnished. Existing furniture for 24 people.



# TURN-KEY OFFICE IN FIFE

5050 20TH STREET E, FIFE, WA 98424

## FLOOR PLAN | SUITE 101

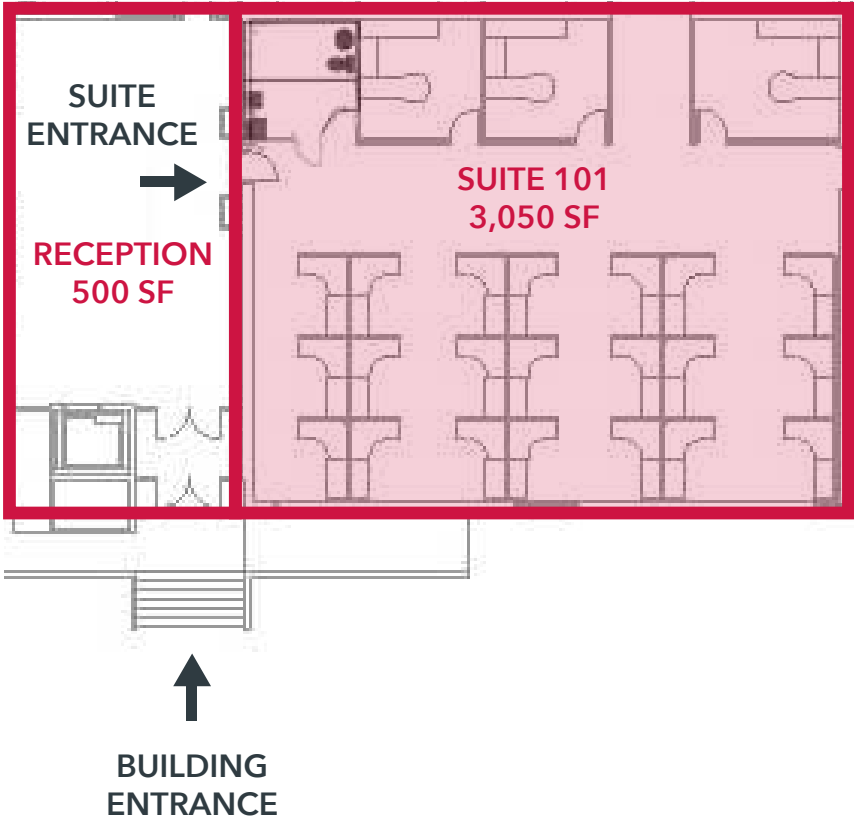

# TURN-KEY OFFICE IN FIFE

5050 20TH STREET E, FIFE, WA 98424

## PHOTOS | SUITE 101



Abundant Natural Light



Kitchenette



Optional Reception Area

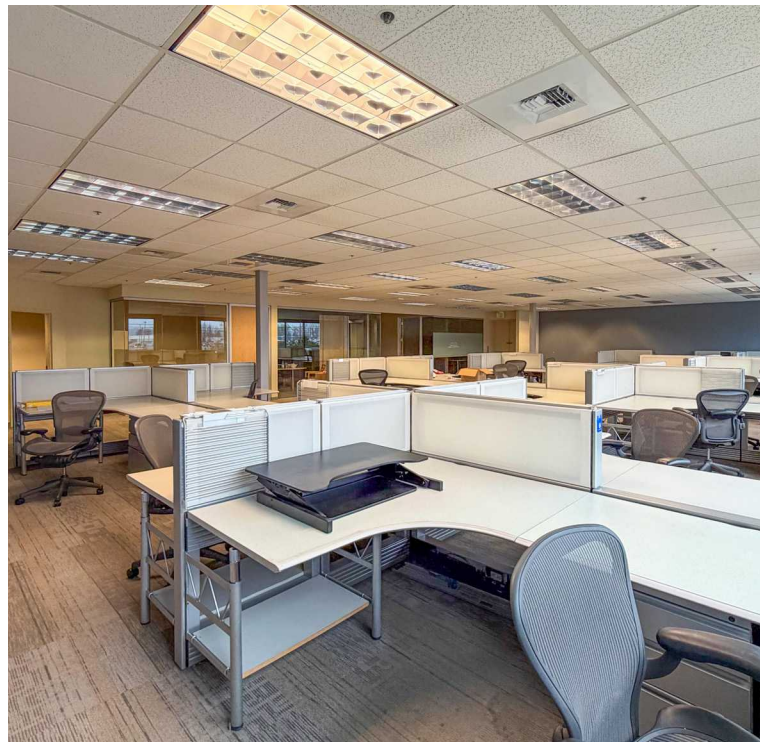

Furniture Included

# TURN-KEY OFFICE IN FIFE

5050 20TH STREET E, FIFE, WA 98424

## LOCAL AMENITIES MAP



## CONTACT

**JOHN BAUDER, ccim**  
jbauder@lee-associates.com  
D 253-238-0043

**HARRISON LAIRD**  
hlaird@lee-associates.com  
D 253-238-0044

All information furnished regarding property for sale, rental or financing is from sources deemed reliable, but no warranty or representation is made to the accuracy thereof and same is submitted to errors, omissions, change of price, rental or other conditions prior to sale, lease or financing or withdrawal without notice. No liability of any kind is to be imposed on the broker herein. 5050 20th Street E, Fife Lease 2024\5050 20th Street E Lease Flyer