



FORMER RITE AID

8500 35th AVE NE
SEATTLE, WA 98115

PACIFIC ASSET ADVISORS, INC.

LISTING DETAILS



RENTABLE SF
26,853 SF
CAN BE DEMISED

**CALL
FOR
RATE**

ADDRESS: 8500 35th Ave NE
Seattle, WA 98115

SQUARE FOOTAGE: 26,853 SF *Can be demised

PARKING: 53 Spaces Available (4 Handicap)

DEMOGRAPHICS:

	1 MILE	3 MILES	5 MILES
POPULATION	23,131	198,210	490,161
HOUSEHOLDS	9,458	85,485	223,377
AVERAGE HH INCOME	\$239,973	\$183,882	\$204,430
MEDIAN HH INCOME	\$183,508	\$135,145	\$146,831
DAYTIME POPULATION	10,139	109,303	301,654
MEDIAN AGE	39.8	34.5	36.6
BUSINESSES	959	9,422	28,522
EMPLOYEES	4,476	54,395	178,135

SPACE PLAN

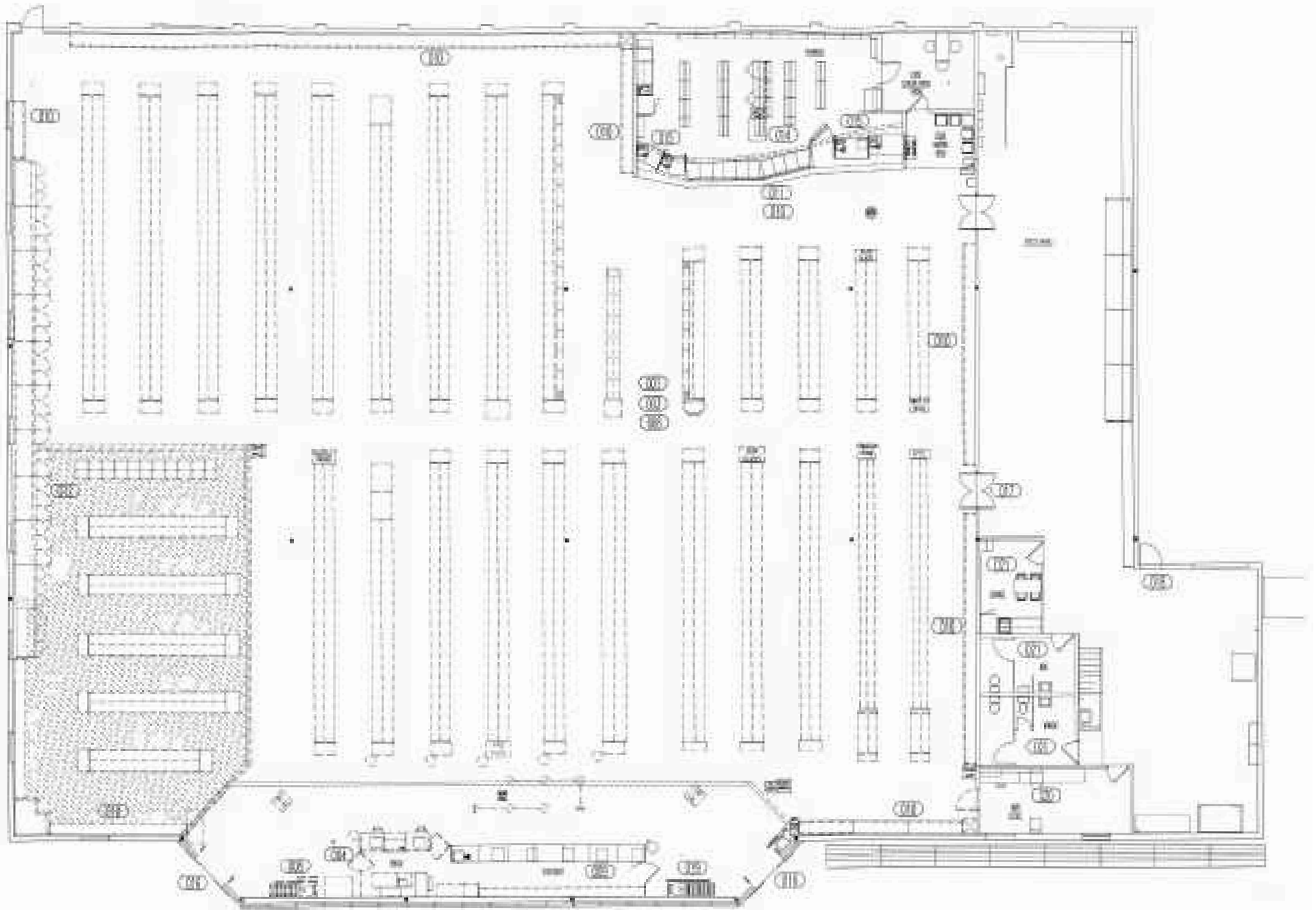

AERIAL

MAPLE LEAF
RESERVOIR PARK

WEDGWOOD
ELEMENTARY SCHOOL

WELLS
FARGO



BANK OF AMERICA

522

THORNTON CREEK
ELEMENTARY SCHOOL



ECKSTEIN
MIDDLE SCHOOL



TOPPOT
DONUTS

INTERSTATE
5



ROOSEVELT
HIGH SCHOOL



PCCT
COMMUNITY
COUNCIL



CONTACT



ADAM GREENBERG
SENIOR VICE PRESIDENT
PARTNER
425.503.1339
ADAM@PAADVISORS.COM

PACIFIC ASSET ADVISORS, INC.

THE PREMIER CHOICE OF THE PACIFIC NORTHWEST

14205 SE 36TH ST, SUITE 215, BELLEVUE, WA 98006