

# Lincoln Loop Logistics

## 2021 Marc Avenue

Tacoma, WA



7.02 Acre Site Plan Outlined in Yellow Available Q4 2026

## 7.02 Acre Site Plan Outlined in Yellow Available Q4 2026



Located in the Heart of the Port of Tacoma Adjacent to the Heavy Haul Corridor of Lincoln Avenue with Access Off Marc Avenue.

### Property Highlights

- + 4.16 Total Acres  
Expansion to 7.02 Total Acres in Q4 2026
- + 3,000 SF Industrial Pole Building
- + 16' clear height
- + Grade level access
- + 1,422 SF (free standing) office
- + Fully paved (concrete) yard surface
- + Fully fenced
- + Active rail spur - Tacoma Rail
- + Port Maritime Industrial

### Zoning (PMI)

- + Zoning allows container stacking
- + Located on the heavy haul corridor
- + Contact brokers for rates



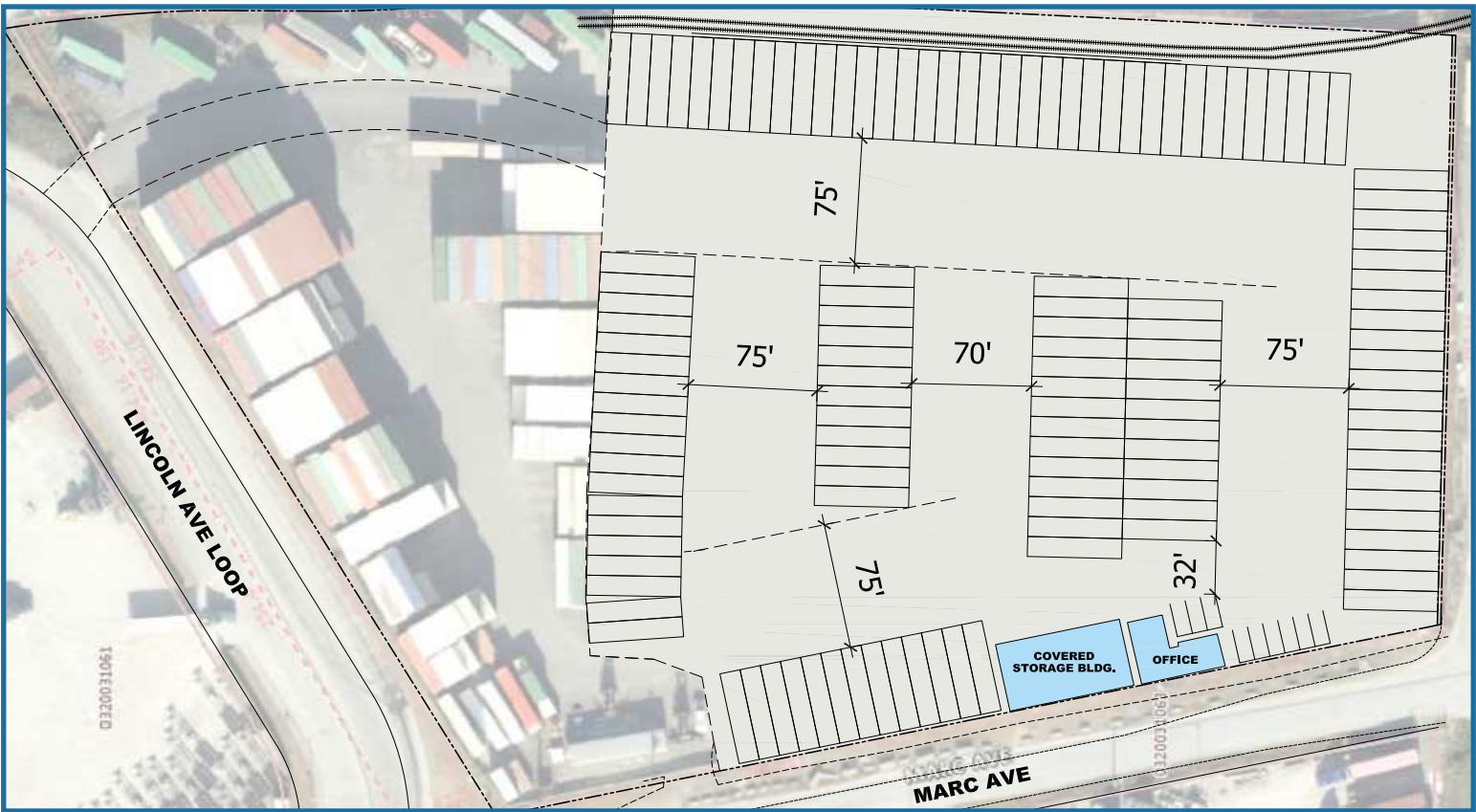

Conceptual ± 4.7 Acre Parking Plan

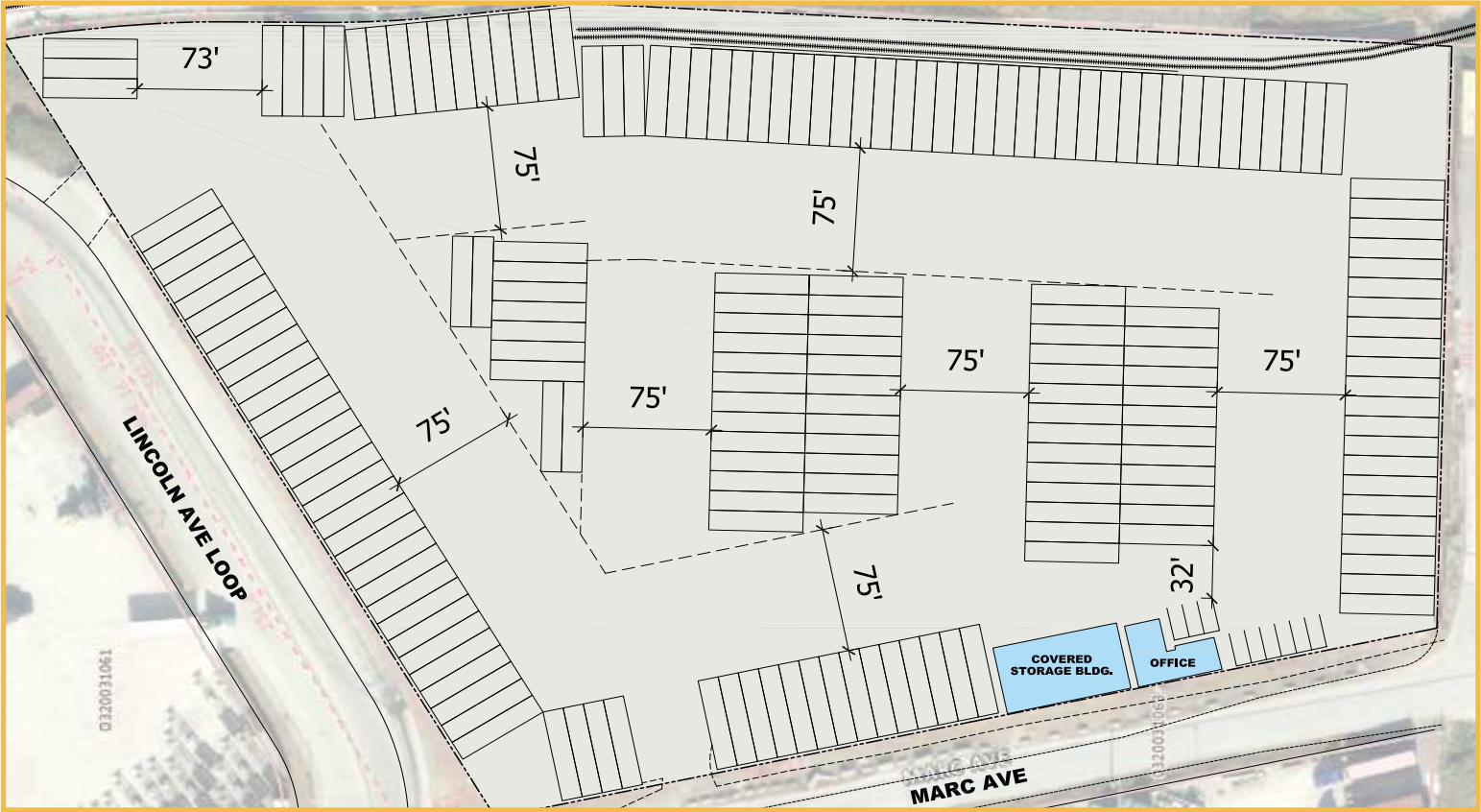

Conceptual 7.02 Acre Parking Plan

4.16 Total Acres with Expansion to 7.02 Total Acres in Q4 2026

# CenterPoint 2021 Marc Ave, Tacoma, WA

## Location Advantages



### Total Size

4.16 Acre site (concrete yard surface)  
Expansion to 7.02 Total Acres in Q4 2026



### Building Size

3,000 SF Industrial Pole Building  
1,422 SF Free Standing Office



### Active Rail Spur

Tacoma Rail Line



### Zoning

Port Maritime Industrial (PMI)

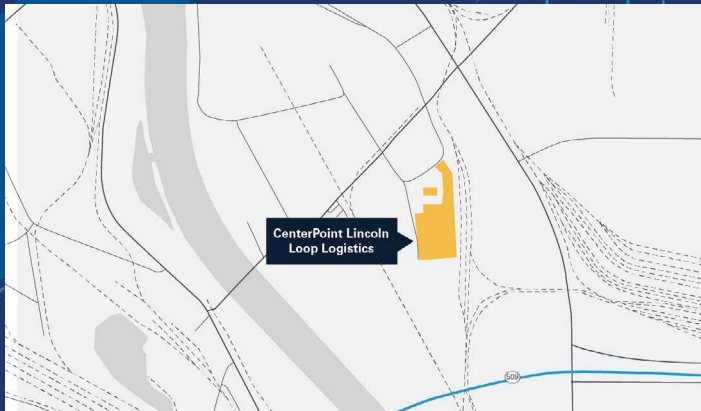
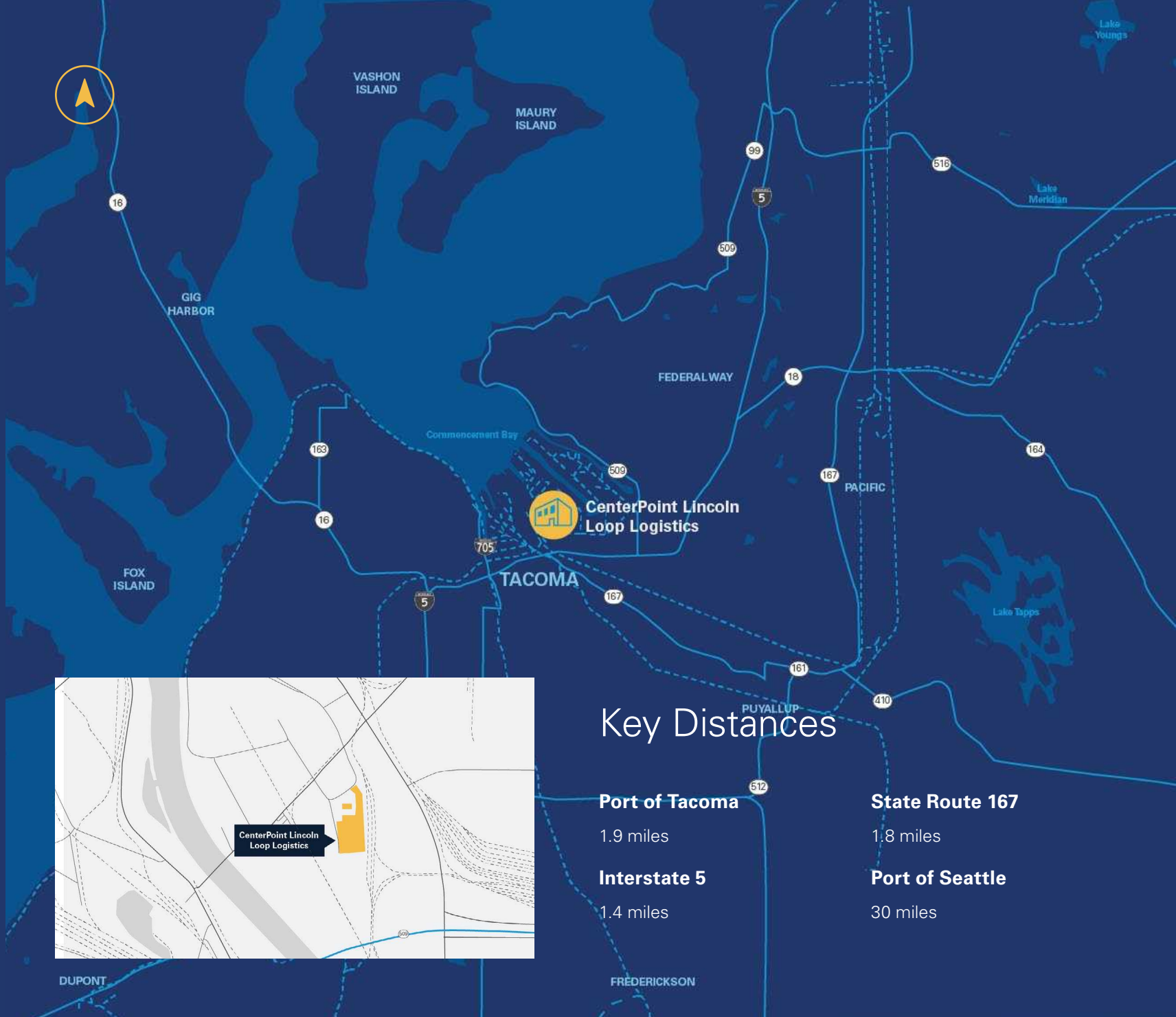

## Key Distances

### Port of Tacoma

1.9 miles

### Interstate 5

1.4 miles

### State Route 167

1.8 miles

### Port of Seattle

30 miles

### About CenterPoint

CenterPoint is an industrial real estate company made up of dedicated thinkers, innovators and leaders with the creativity and know-how to tackle the industry's toughest challenges. And it's those kinds of problems—the delicate, the complex, the seemingly-impossible—that we relish most. Because with an agile team, substantial access to capital and industry-leading expertise, those are exactly the kinds of problems we're built to solve.

[centerpoint.com](http://centerpoint.com)

Owned and Developed By



Greg Stumm  
213.488.8692  
gstumm@centerpoint.com

Wes Payne  
650.888.8600  
wpayne@centerpoint.com

Exclusive Marketing Agent



Billy Moultrie  
253.444.3022  
bmoultrie@lee-associates.com

Christian Mattson, SIOR  
253.444.3021  
cmattson@lee-associates.com