

WAREHOUSE DISTRIBUTION FACILITY

1000-1020 ANDOVER PARK WEST

TUKWILA, WA

54,540 SF

FOR
LEASE



- 54,540 SF TOTAL SQUARE FEET
- 2,910 SF OF OFFICE
- MEZZANINE DECK ABOVE OFFICE AREA
- 7 DOCK HIGH DOORS
- 2 LARGE GRADE LEVEL DOORS
- SECURED YARD AREA
- \$0.70 PSF ON SHELL + NNN
- \$1.00 PSF ON EXISTING OFFICE

GEORGE ROCKWELL, SIOR
(206) 679-7625
grockwell@andoverco.com

 **THE ANDOVER
COMPANY, INC.**
CORFAC INTERNATIONAL

FLOOR PLANS

KEY:

- GRADE LEVEL
- ▲ DOCK HIGH

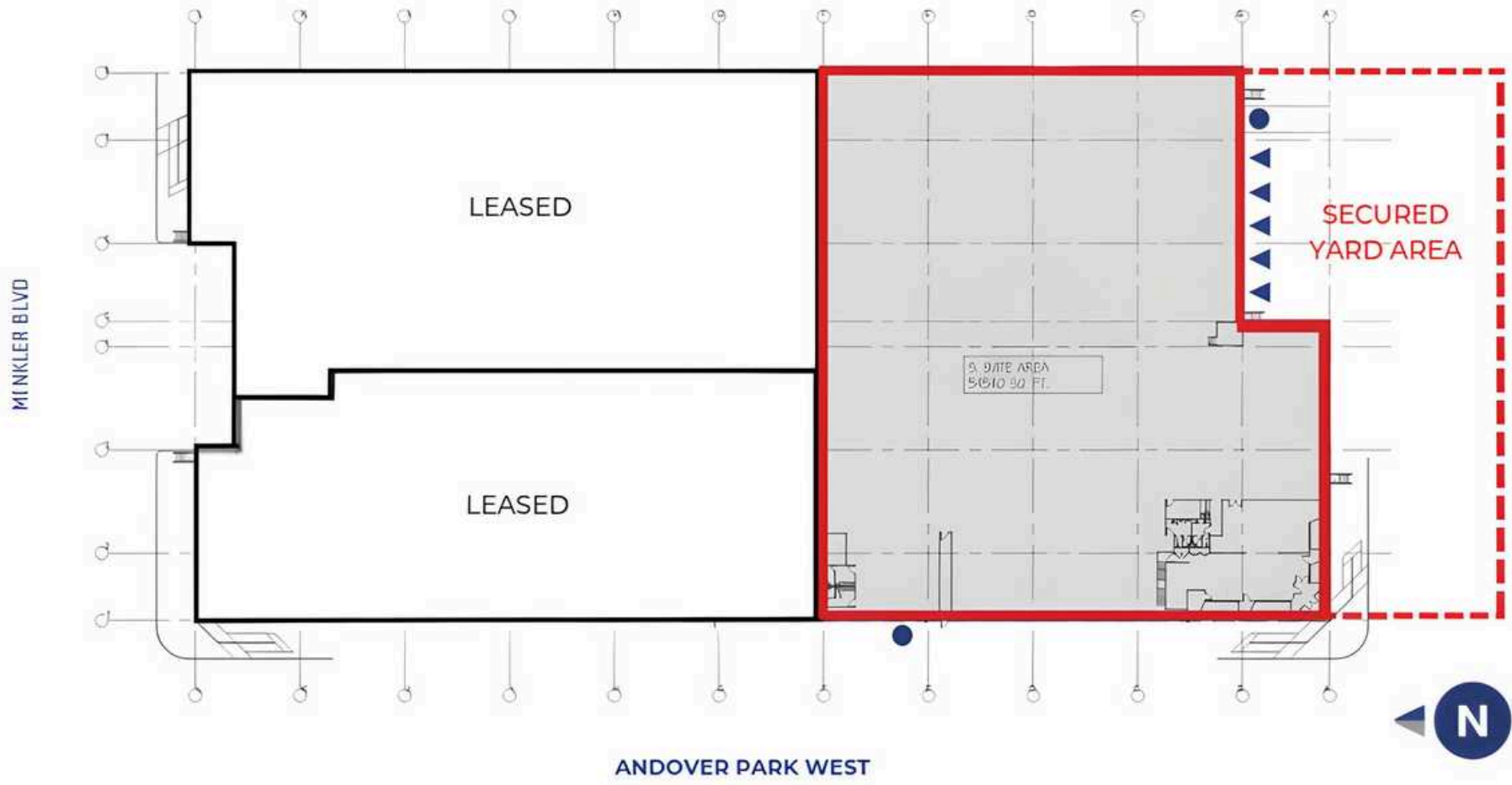

The information contained herein has been obtained from reliable sources, but is not guaranteed. A prospective buyer/tenant should verify each item relating to this property and all information contained herein.

GEORGE ROCKWELL, SIOR
(206) 679-7625
grockwell@andoverco.com

**THE ANDOVER
COMPANY, INC.**
CORFAC INTERNATIONAL