

FOR LEASE

THE RESERVE AT WOODINVILLE

15902 WOODINVILLE REDMOND RD NE, WOODINVILLE, WA

*159,869 SF Building with
59,095 SF Industrial-Office
Space Available in the heart of
the Woodinville wine district*



THERESERVEATWOODINVILLE.COM

km Kidder
Mathews

THE RESERVE AT WOODINVILLE

ADDRESS	15902 Woodinville Redmond Rd NE Woodinville, WA
BUILDING SF	159,869 SF
SUITE C TOTAL SF	59,095 SF
OFFICE	3,082 SF
WAREHOUSE	56,013 SF
POWER	3-phase power, 225 Amps/480V and 225 Amps 120/208V
SPRINKLERS	ESFR sprinkler system
DH LOADING	7 dock-high doors
GL LOADING	1 grade level loading
HEIGHT	30' clear height
FLOORING	R-30 rigid floor insulation 6" reinforced floor slab
AVAILABILITY	Now

56,013 SF

WAREHOUSE

3,082 SF

OFFICE

59,095 SF

SUITE C TOTAL SF

CALL

FOR LEASE RATES



SITE PLAN

SUITE C

59,095 SF

SUITE C TOTAL SF

3,082 SF

OFFICE SF

56,013 SF

WAREHOUSE SF

NOW

AVAILABLE

 TAKE VIRTUAL TOUR

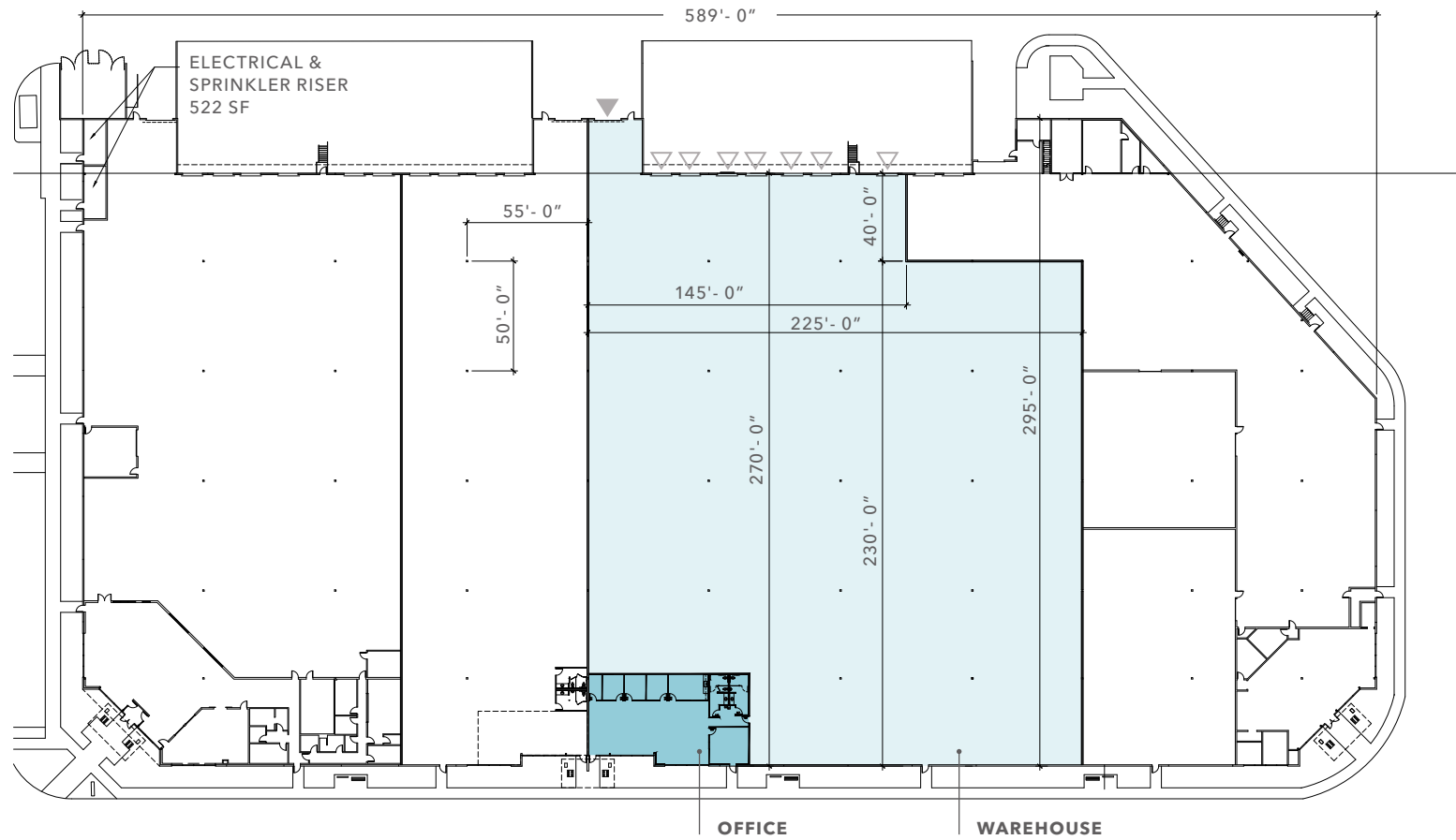

 Dock-high loading  Grade-level loading



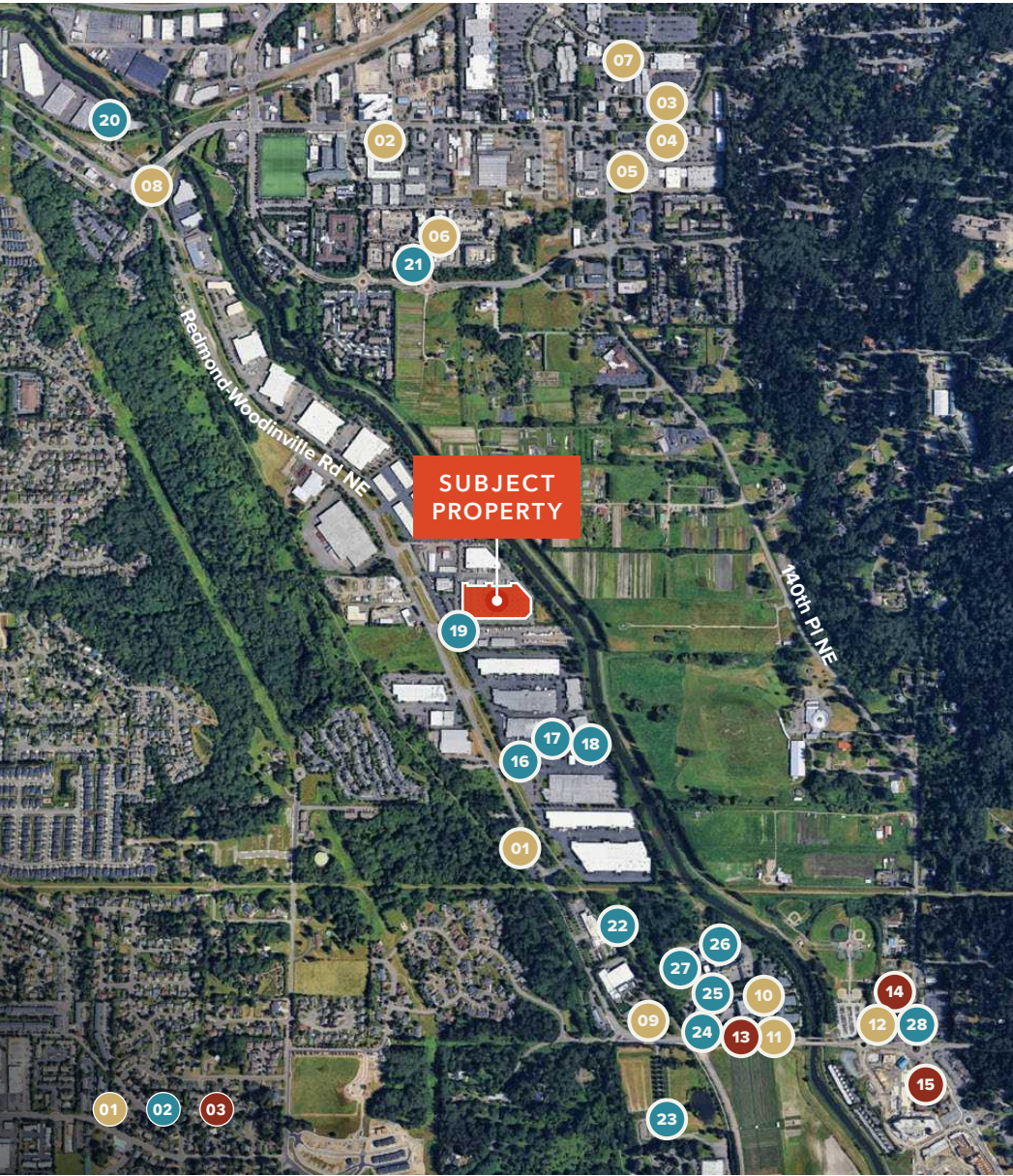

NEARBY AMENITIES

RESTAURANTS & BARS

- 01 Von's 1000Spirits
- 02 The Pizza Coop & Ale House
- 03 Woodinville Café
- 04 Topsy Cow
- 05 Pasta Nova Italiano
- 06 Rusty Pelican Café
- 07 Dough Zone
- 08 Woodinville Cut Shop
- 09 Hollywood Tavern
- 10 Barking Frog
- 11 The Herbfarm
- 12 Vivi Pizzeria

WINERIES & BREWERIES

- 16 Tenor Wines
- 17 Watts Brewing Company
- 18 Black Raven Brewing
- 19 Martedi Winery
- 20 Rocky Pond Estate Winery
- 21 Novelty Hill – Januik Winery
- 22 Chateau Ste. Michelle Winery
- 23 Mark Ryan Winery
- 24 Fidélitas
- 25 DeLille Cellars
- 26 Sparkman Cellars
- 27 Latta Wines
- 28 Patterson Cellars

LODGING

- 13 Willows Lodge
- 14 Hollywood Manor at Tenhulzen Reserve
- 15 The Somm

THE RESERVE AT WOODINVILLE

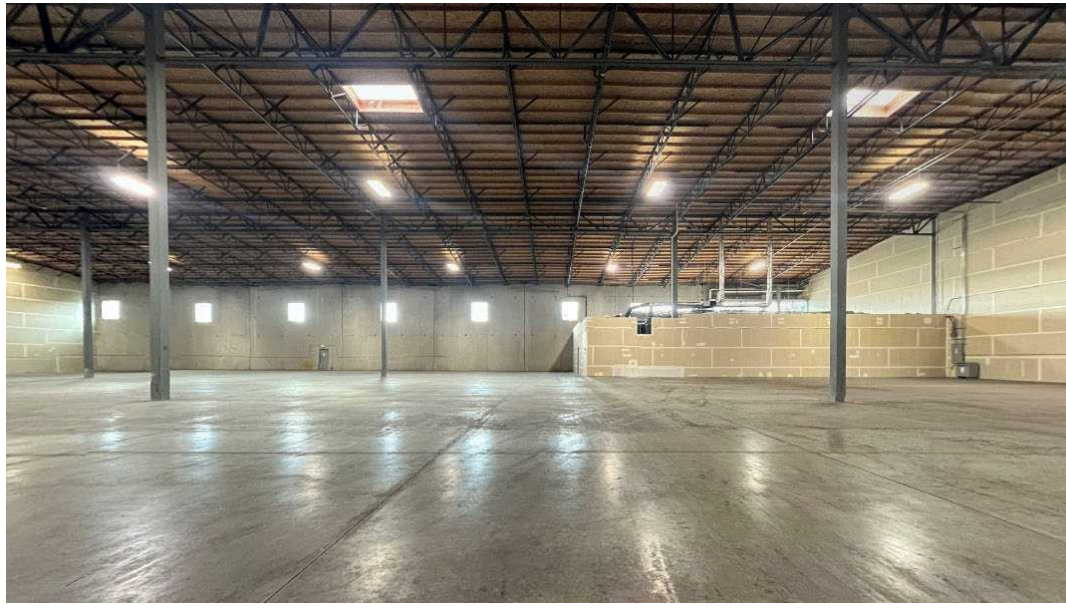
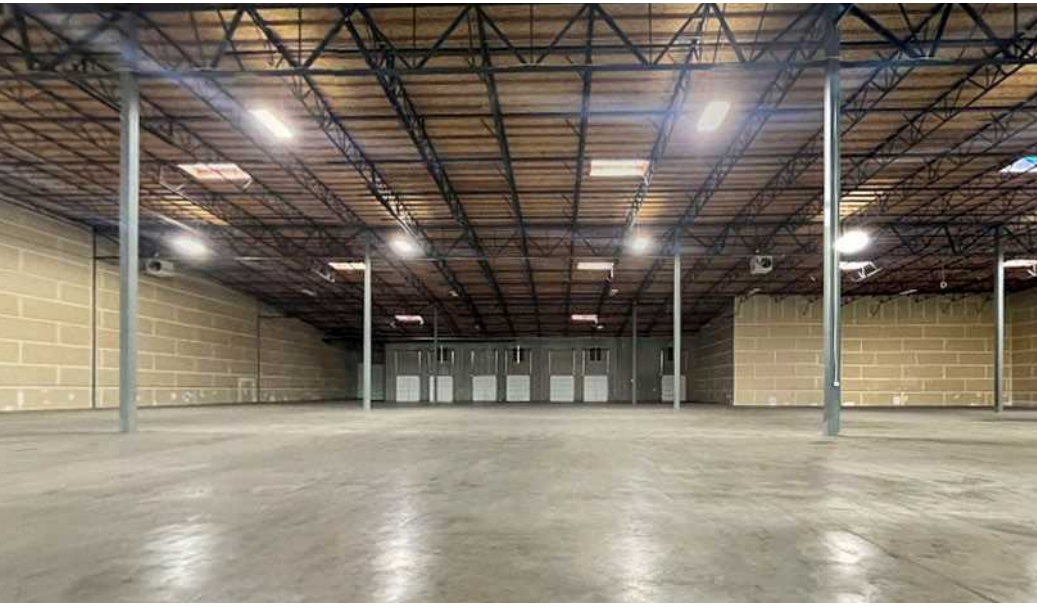

THE RESERVE AT WOODINVILLE





Exclusively listed by

TODD GAUTHIER
Executive Vice President
425.450.1118
todd.gauthier@kidder.com

JASON BLOOM
Executive Vice President
425.450.1102
jason.bloom@kidder.com

GREG FUCHS
Associate
425.450.1161
greg.fuchs@kidder.com

CARTER NICHOLSON
Associate
425.450.1145
carter.nicholson@kidder.com



CAPROCK
PARTNERS