

FOR LEASE

MERIDIAN SQUARE

11904 - 11910 MERIDIAN E
PUYALLUP, WA 98373

*2 retail suites available
1,067 SF endcap space &
1,918 SF*

SUITE A2



MERIDIAN SQUARE



PROPERTY OVERVIEW

Suite A1 1,067 SF, NNN, endcap space

Suite A2 1,918 SF, NNN

\$25 base rent + \$9 NNN

Pylon signage available

Signaled intersection

Located on South Hill Meridian with high traffic volume

Close to South Hill Mall, Walgreens, Starbucks, YMCA and other major retailers!

Contact brokers for pricing

JOIN CURRENT TENANTS

GOODYEAR

KITSAP
CREDIT UNION

peopleready
A TRUEBLUE COMPANY

COMPUTER CITY



MERIDIAN SQUARE

| | | |
|--|--|--|
| | | |
| | | |

| | | |
|--|--|--|
| | | |
| | | |

| | |
|--|--|
| | |
| | |

SOUTH HILL MALL

| | | |
|--|--|--|
| | | |
| | | |
| | | |

39TH AVE SW

WILLOWS SHOPPING CENTER

| | | |
|--|--|--|
| | | |
| | | |

| | |
|--|--|
| | |
|--|--|

94TH AVE E

MERIDIAN AVE

| | | |
|--|--|--|
| | | |
| | | |

SUBJECT PROPERTY

MERIDIAN PLACE

| | | |
|--|--|--|
| | | |
| | | |

AVAILABLE FOR LEASE



KIDDER MATHEWS

SITE PLAN



1,067 SF

SUITE A1

1,918 SF

SUITE A2

11910 MERIDIAN FLOORPLAN - SUITE A2

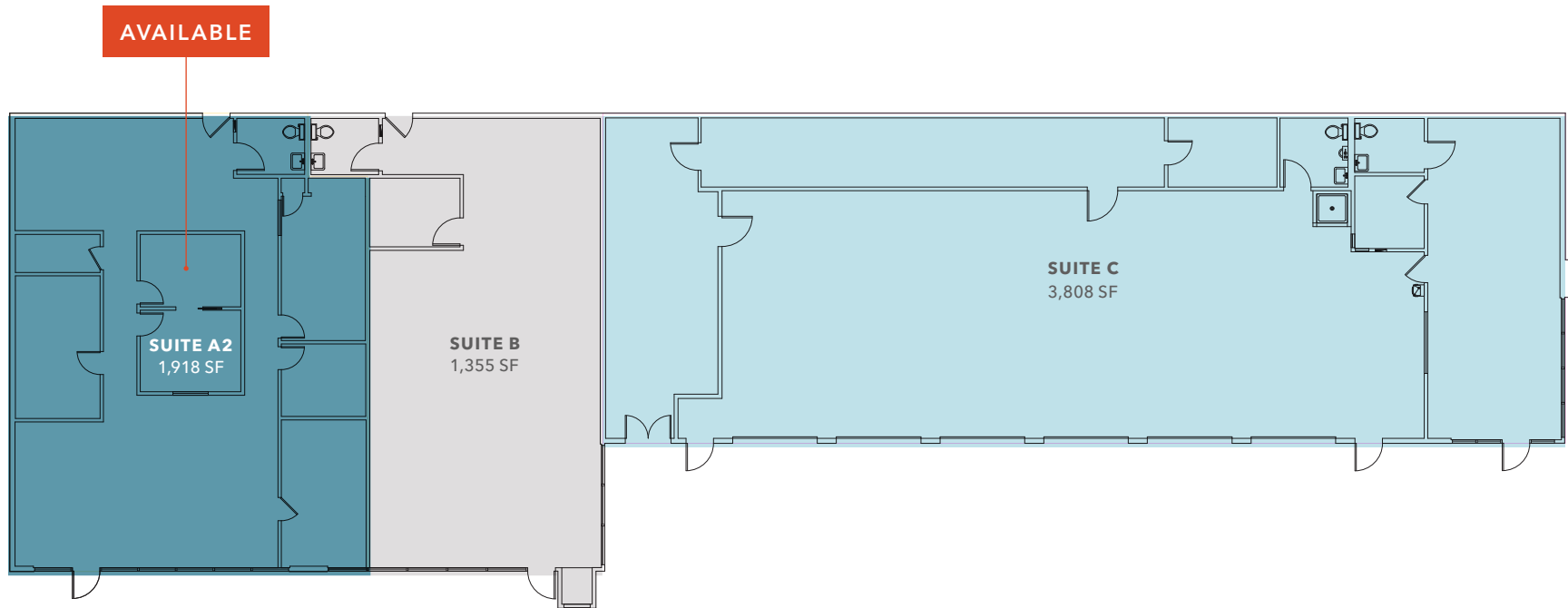

1,918 SF
SUITE A2

NOW
AVAILABLE

11910 MERIDIAN FLOORPLAN - SUITE A1

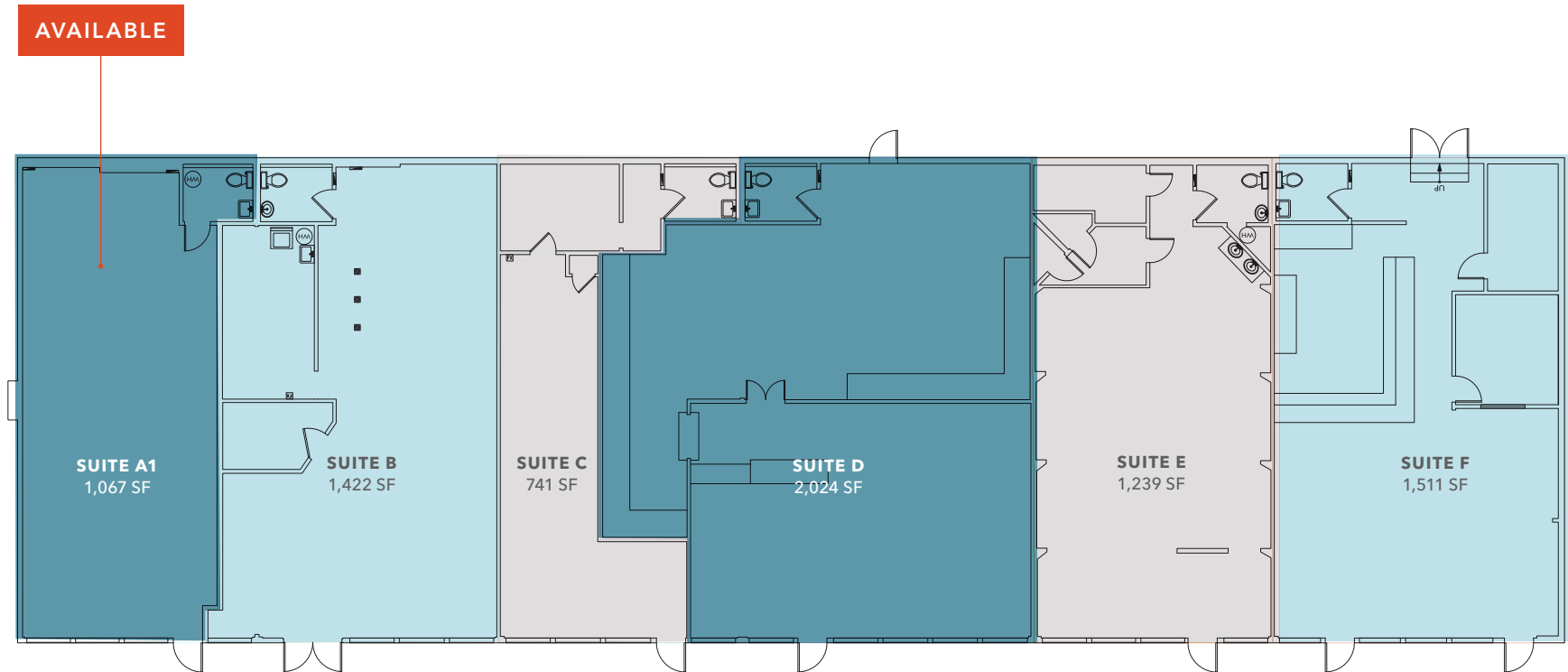

1,067 SF

SUITE A1

NOW

AVAILABLE

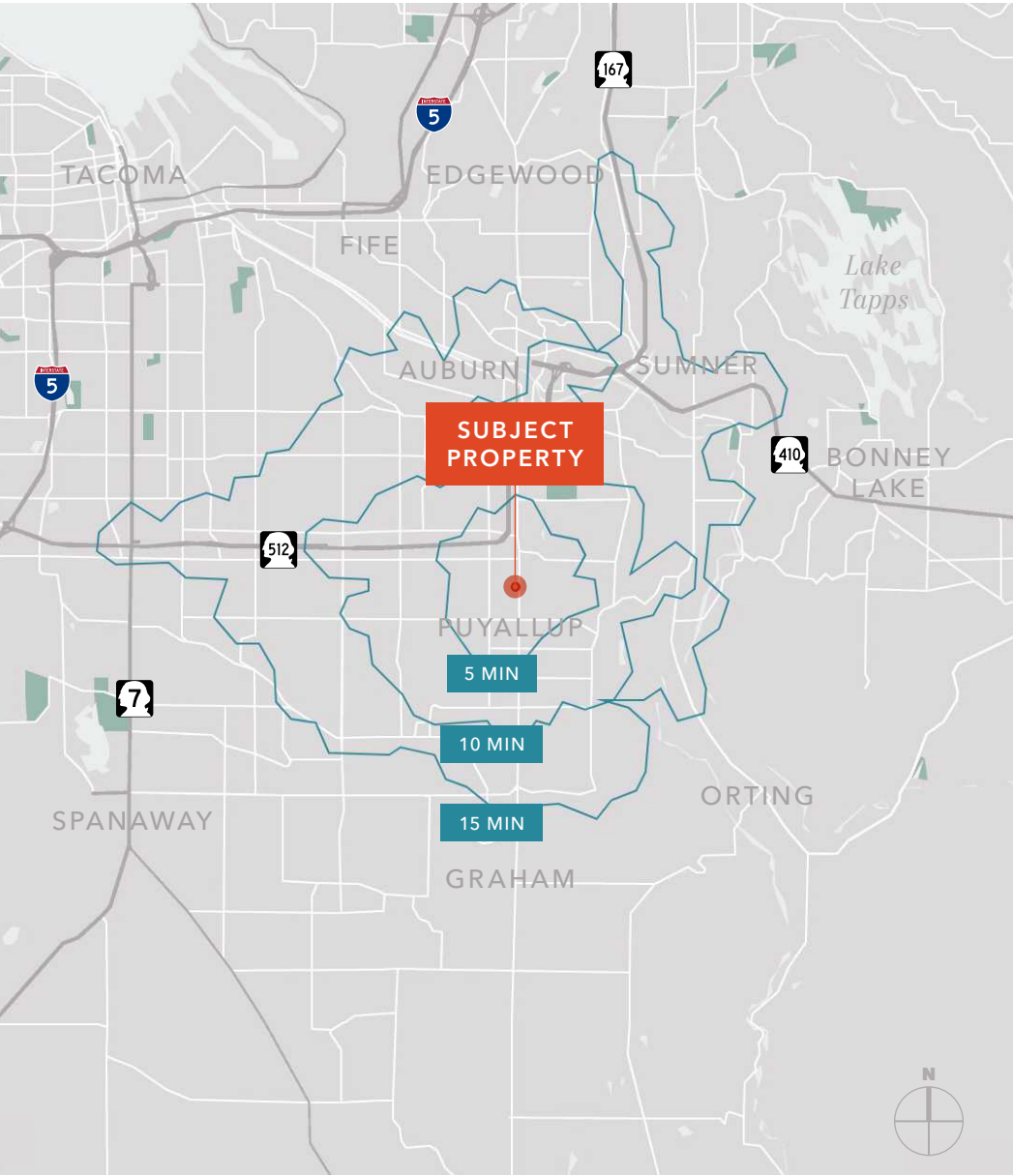

DEMOGRAPHICS

POPULATION

| | 5 Min | 10 Min | 15 Min |
|----------------|--------|--------|---------|
| 2024 ESTIMATED | 19,792 | 77,871 | 153,416 |
| 2029 PROJECTED | 20,089 | 78,641 | 155,656 |
| 2020 CENSUS | 19,110 | 78,087 | 152,794 |
| 2010 CENSUS | 14,862 | 66,891 | 129,489 |

MEDIAN AGE & GENDER

| | 5 Min | 10 Min | 15 Min |
|------------|-------|--------|--------|
| MEDIAN AGE | 35.8 | 37.1 | 37.2 |
| % FEMALE | 52.0% | 50.6% | 50.4% |
| % MALE | 48.0% | 49.4% | 49.6% |

HOUSEHOLDS

| | 5 Min | 10 Min | 15 Min |
|---------------------------|-----------|-----------|-----------|
| 2024 ESTIMATED HOUSEHOLDS | 8,343 | 30,321 | 58,655 |
| 2029 PROJECTED HOUSEHOLDS | 8,523 | 30,770 | 59,684 |
| 2024 AVERAGE INCOME | \$108,408 | \$130,010 | \$133,404 |
| 2029 AVERAGE INCOME PROJ. | \$112,457 | \$135,686 | \$139,931 |

Data Source: ©2025, Sites USA

MERIDIAN SQUARE

Exclusively leased by

BLAKE WEBER
Senior Vice President
206.898.1231
blake.weber@kidder.com

NED WHALEN
Senior Vice President
206.491.5998
ned.whalen@kidder.com

DON WHITTLES
Senior Vice President
253.208.2257
don.whittles@kidder.com

TIM WEBER
Executive Vice President
206.650.0391
tim.weber@kidder.com

KIDDER.COM

This information supplied herein is from sources we deem reliable. It is provided without any representation, warranty, or guarantee, expressed or implied as to its accuracy. Prospective Buyer or Tenant should conduct an independent investigation and verification of all matters deemed to be material, including, but not limited to, statements of income and expenses. Consult your attorney, accountant, or other professional advisor. All Kidder Mathews designs are the sole property of Kidder Mathews. Branded materials and layouts are not authorized for use by any other firm or person.

