

FOR LEASE



PUGET PARK INDUSTRIAL BLDG

19,423 SF warehouse just off of I-5 in south Everett

1104 132ND ST SW | EVERETT, WA 98204

km Kidder
Mathews

PUGET PARK INDUSTRIAL BUILDING



Property Features

- 19,423 SF total available
- 2,180 SF climate-controlled office
- Quality concrete tilt-up construction
- 2 dock-high loading bays
- 2 grade-level loading doors
- 24' clear height; sprinklered
- Natural gas heat in warehouse
- Heavy 277 / 480 volt 3-phase power
- Excellent access to 128th St / I-5 on-ramp

\$1.25/SF

WAREHOUSE

\$2.00/SF

OFFICE

\$0.31/SF

NNN'S

FLOOR PLAN

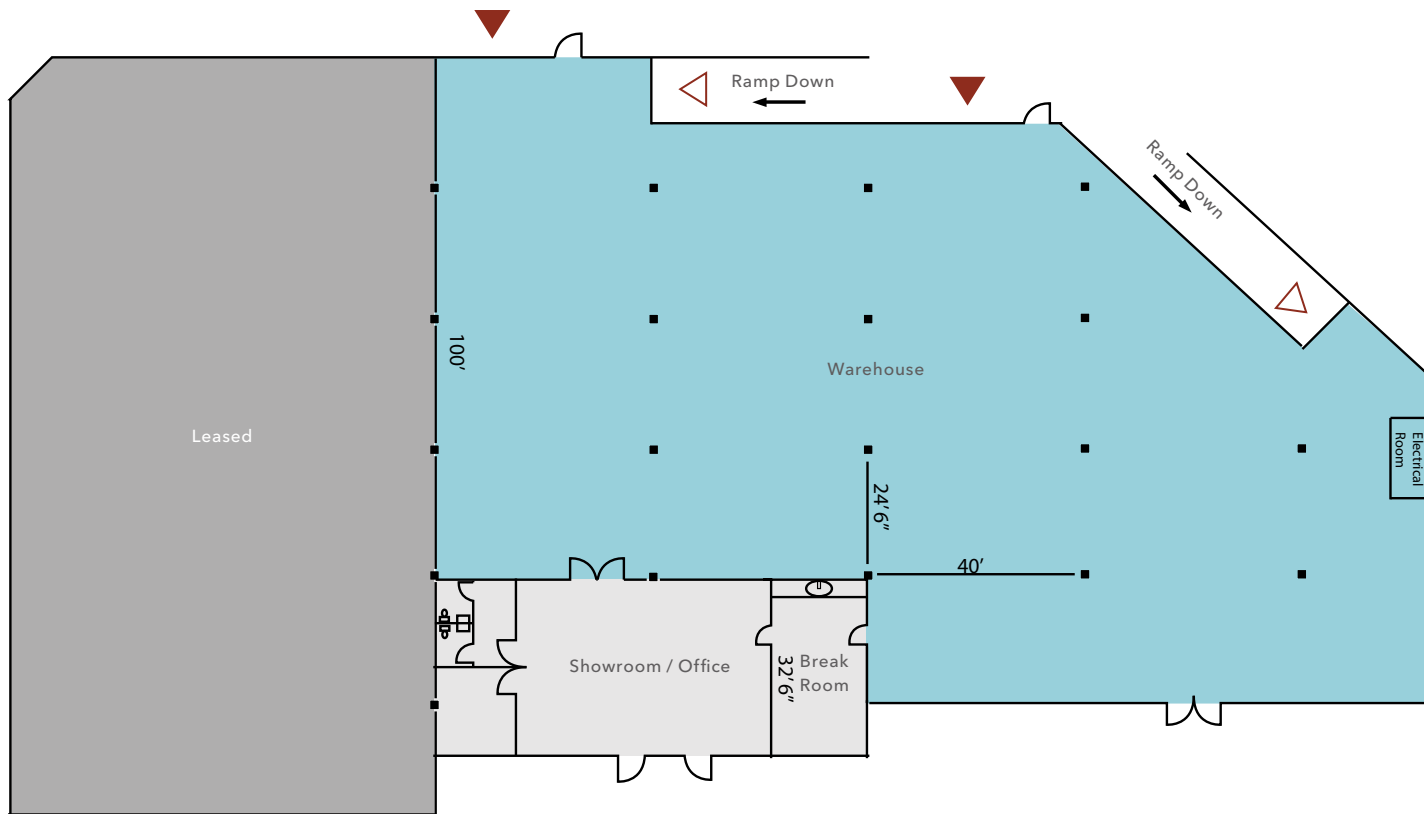

19,423 SF

WAREHOUSE

2,180 SF

OFFICE

NOW

AVAILABLE

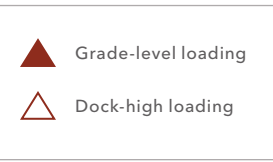

PUGET PARK INDUSTRIAL BUILDING

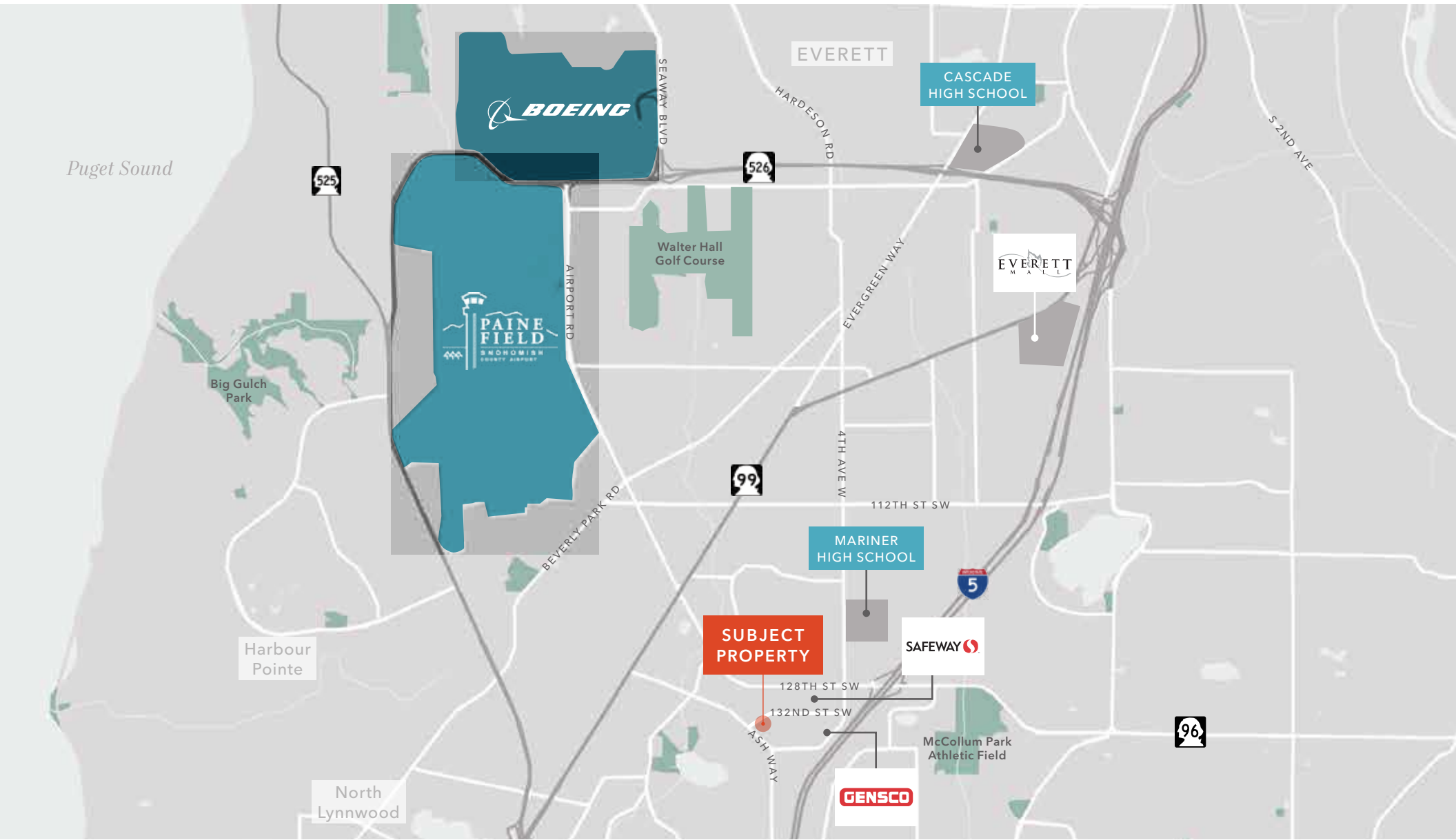



Exclusively listed by

MATTHEW HAGEN, SIOB
Executive Vice President
425.283.5782
matt.hagen@kidder.com

MATTHEW P. HENN
Executive Vice President
206.890.7800
matt.henn@kidder.com

PATRICIA J. LOVEALL, SIOB
Executive Vice President
CBRE
206.292.6139
patricia.loveall@cbre.com

KIDDER.COM

