



OFFICE/FLEX/RETAIL FOR LEASE

THE PARK AT WILLOW RIDGE - BLDG. F

12324 134TH COURT NE, REDMOND, WA 98052



BUILDING F | 12324 134TH CT NE

SUITE 115: 3,024 SF
SUITE 145: 4,569 SF (1,497 WH/3,072 SF OFFICE)

AVAILABLE NOW

AMENITIES

- 2 Grade level loading doors
- 3 parking stalls per 1,000 SF
- Quick access to I-405, Willows Road, the Village at Totem Lake retail, Woodinville wine country with close proximity to Kirkland, Redmond & Bellevue with views of Mt. Rainier and the Cascade Mountains
- Well established hub for technology, aerospace, & innovation and an ideal destination for a variety of tenants

BUILDING F

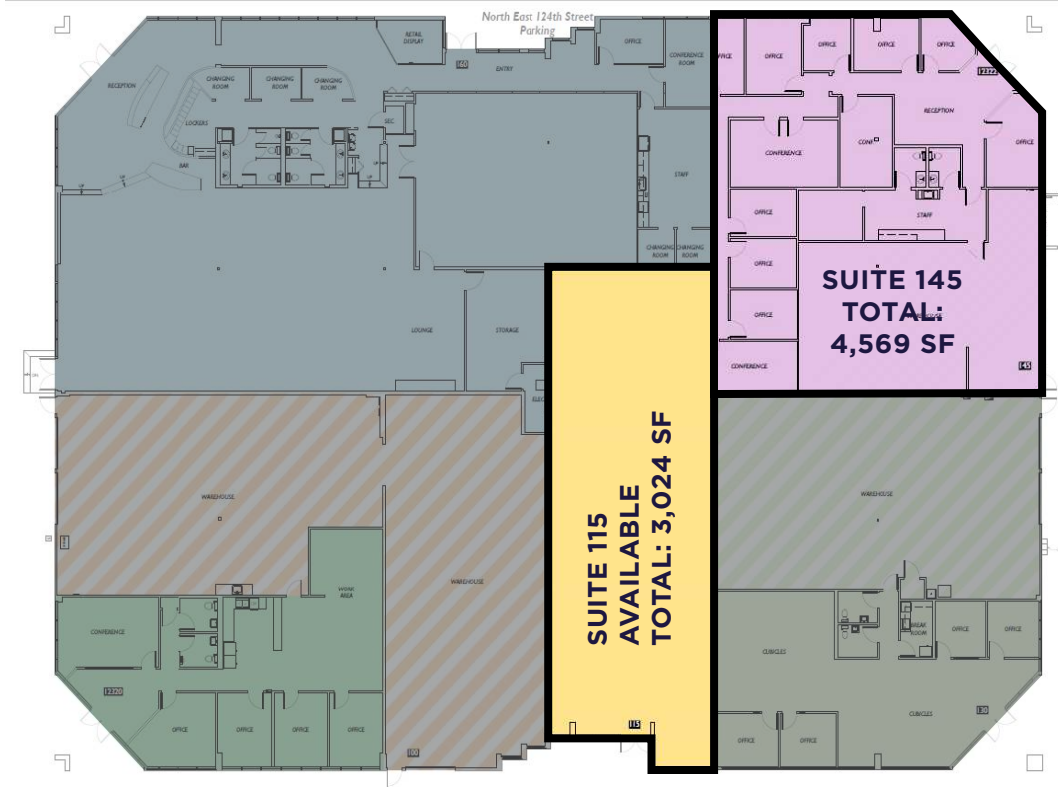

FOR MORE INFORMATION PLEASE CONTACT:

Jim Reed
Executive Managing Director
+1 206 215 9815
jim.reed@cushwake.com

Carson Scott
Senior Associate
+1 206 215 9781
carson.scott@cushwake.com

11235 SE 6th Street Suite 200 | Bellevue, WA 98004 | +1 425 455 4500

