

FOR LEASE

# ALLENMORE TERRACE

3315 S 23RD ST, TACOMA, WA



*Class A Quality in the  
Allenmore Corridor*

Suite 110 | 2,477 RSF (Available 02/01/2026)

\$28.00 PSF per year, NNN

Allenmore Terrace has undergone recent renovations to the interior including common areas and lobby

An unbeatable location that is adjacent to the Allenmore Hospital Campus and allows for quick access to I-5 and HWY 16

MultiCare Allenmore Hospital offers access to hundreds of care providers, the latest diagnostic and treatment technologies plus a 24-hour emergency department

Surface level parking available on-site at 4.6/1,000 SF

**DREW FRAME, SIOR**  
253.948.7032  
drew.frame@kidder.com



# SUITE 110 | 2,447 SF

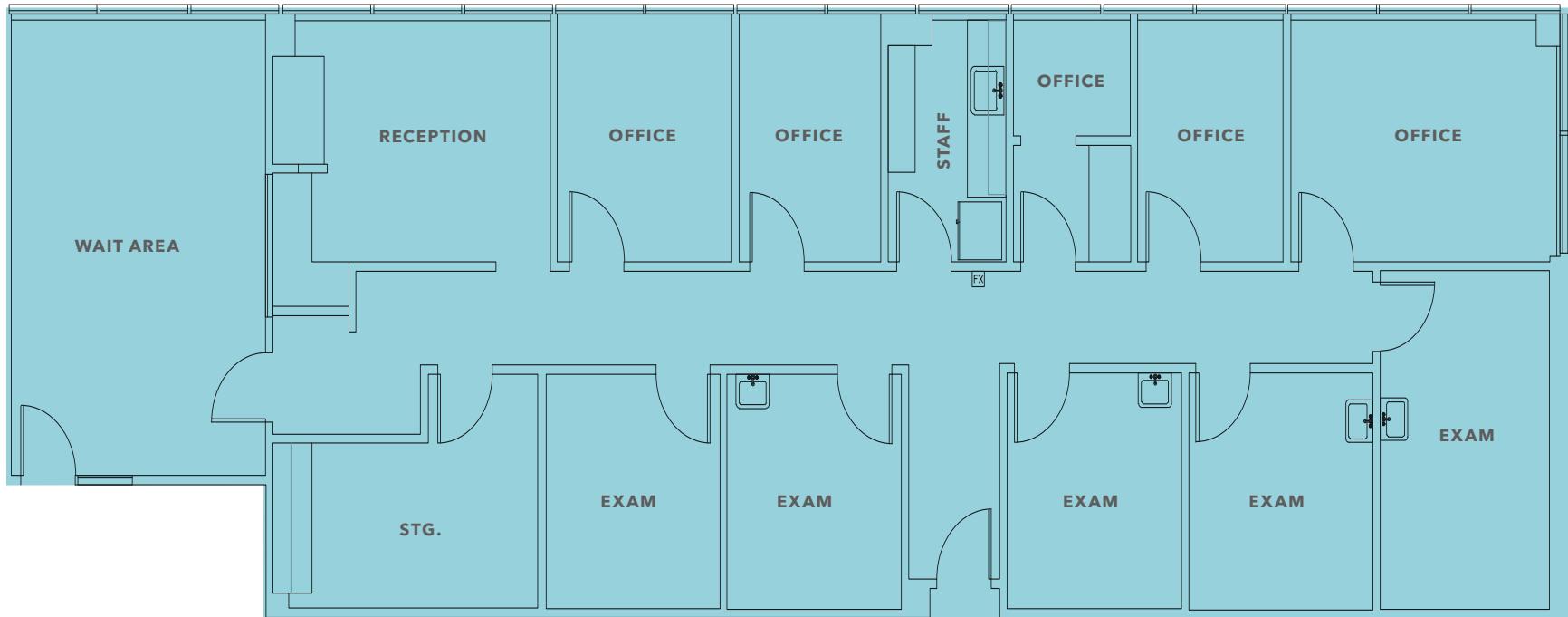

## SPACE PLAN

5 Exam Rooms

5 Private Offices

Storage Room

Staff Room

Reception/Waiting Room

## KIDDER.COM

This information supplied herein is from sources we deem reliable. It is provided without any representation, warranty, or guarantee, expressed or implied as to its accuracy. Prospective Buyer or Tenant should conduct an independent investigation and verification of all matters deemed to be material, including, but not limited to, statements of income and expenses. Consult your attorney, accountant, or other professional advisor. All Kidder Mathews designs are the sole property of Kidder Mathews. Branded materials and layouts are not authorized for use by any other firm or person.



# ALLENMORE TERRACE

*Exclusively leased by*

DREW FRAME, SIOR  
Senior Vice President  
253.948.7032  
drew.frame@kidder.com

[KMTEAMFRAME.COM](http://KMTEAMFRAME.COM)  
[KIDDER.COM](http://KIDDER.COM)

This information supplied herein is from sources we deem reliable. It is provided without any representation, warranty, or guarantee, expressed or implied as to its accuracy. Prospective Buyer or Tenant should conduct an independent investigation and verification of all matters deemed to be material, including, but not limited to, statements of income and expenses. Consult your attorney, accountant, or other professional advisor.

 **Kidder  
Mathews**