

FOR LEASE

14130 Juanita Dr NE
Kirkland, WA 98011



FACADE RENOVATION NOW COMPLETE!



INGLEWOOD VILLAGE

Justin Holmes | Josh Parnell | Lucy Malone

First Western Properties—Tacoma Inc. | 253.472.0404
6402 Tacoma Mall Blvd, Tacoma, WA 98409 | fwp-inc.com

INGLEWOOD VILLAGE benefits from stable demographics and a solid foundation of established anchor tenants. QFC, and Finn Hill Animal Hospital draw steady foot traffic from the surrounding affluent Finn Hill neighborhood, which is home to approximately 52,841 residents*. This consistent customer base contributes to the center's long-term viability and makes it an attractive location for both national and local tenants seeking exposure in a well-trafficked community hub.

*Source: www.kirklandwa.gov

AVAILABLE

- SUITE 103: 1,122 SF (CALL FOR DETAILS)
- SUITE 105: 1,500 SF (CALL FOR DETAILS)
- SUITE 107: 7,778 SF (CALL FOR DETAILS)
- 1,702-12,113 ± SF (CALL FOR DETAILS)

*CAN BE DEMISED

- QFC Anchored Shopping Center located in Kirkland
- New Pylon Signage Available
- New Parking Lot with Ample Parking
- Located on major traffic corridor of Juanita Drive



Population



Average HH Income



Daytime Population

Regis - 2025

	Population	Average HH Income	Daytime Population
Mile 1	9,807	\$233,200	4,383
Mile 3	111,028	\$191,903	56,892
Mile 5	355,470	\$197,585	209,911

NEARBY TENANTS

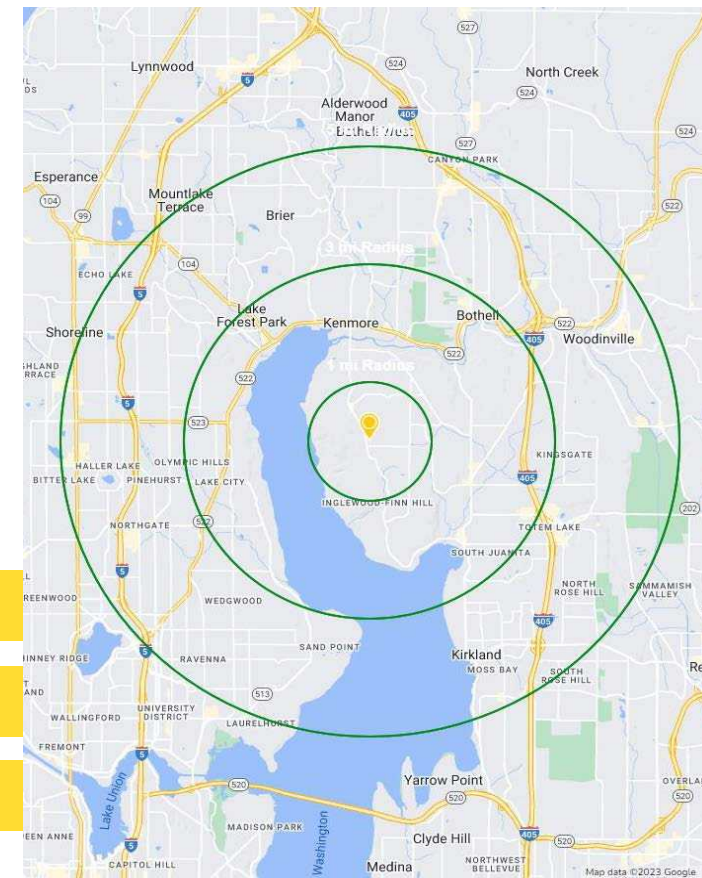

LOCATION AERIAL

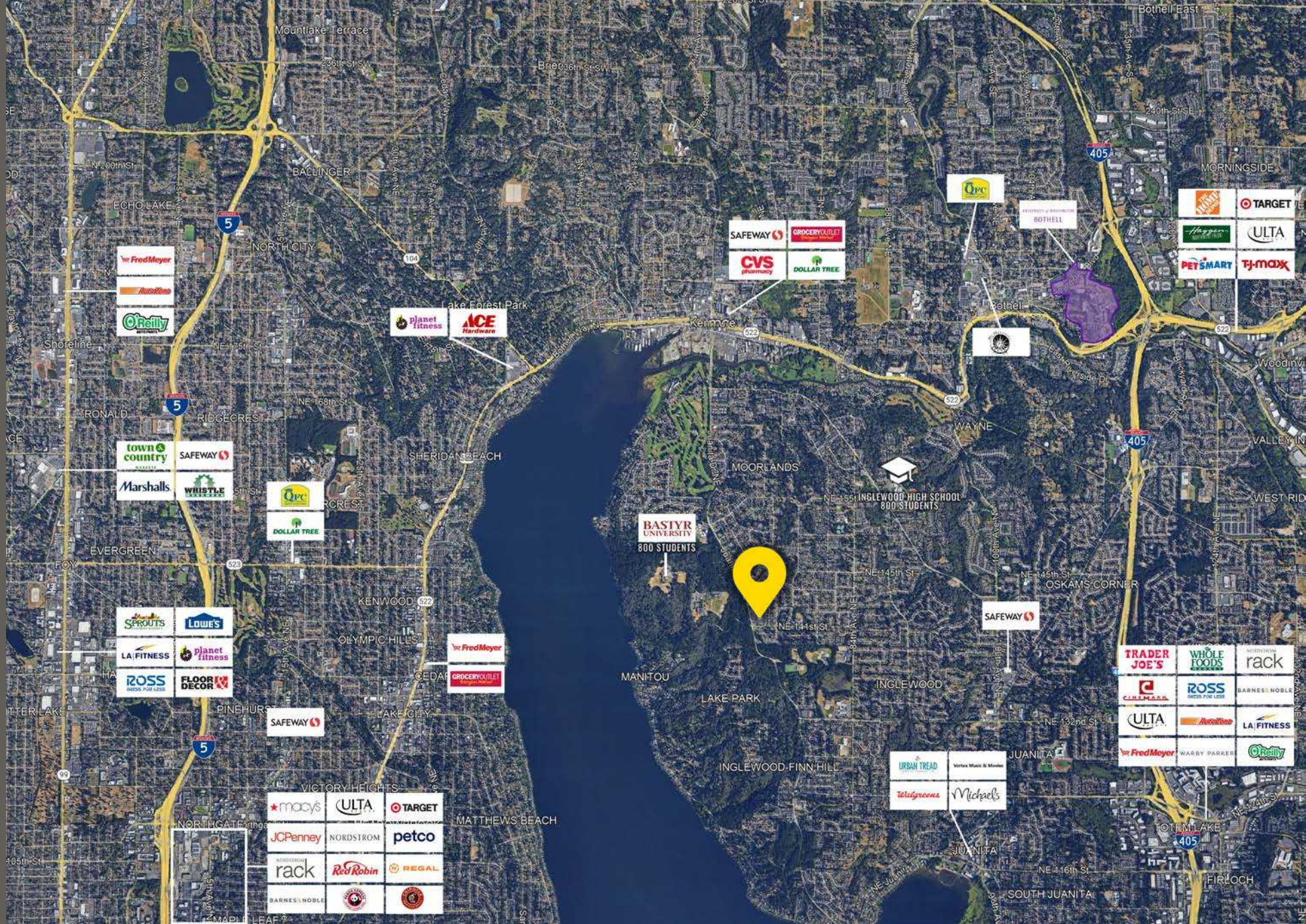

3,665 CPD
NE 144th St



9,433 CPD
Juanita Dr NE



Located in Inglewood neighborhood with strong HH incomes



Just moments from I-405 & HWY 522

SITE PLAN



Renovated Space Available



JUANITA DRIVE NORTHEAST

Suite #	Tenant	SF
111	AVAILABLE	1,702 - 12,113
110	Mod Skin and Body	1,584
109	Thai Golden Bowl	1,540
108	Finn Hill Animal Hospital	3,174
107	AVAILABLE	7,778
106	QFC	27,601

Suite #	Tenant	SF
105	AVAILABLE	1,500
104	Nail Salon	855
103	AVAILABLE	1,122
102	Kami Teriyaki	1,600
101	Tacos El Guero	2,035
200	Over the Brick	1,951



New Pylon Signage

SUITE 103



SUITE 105 - FLOOR PLAN

FRONT

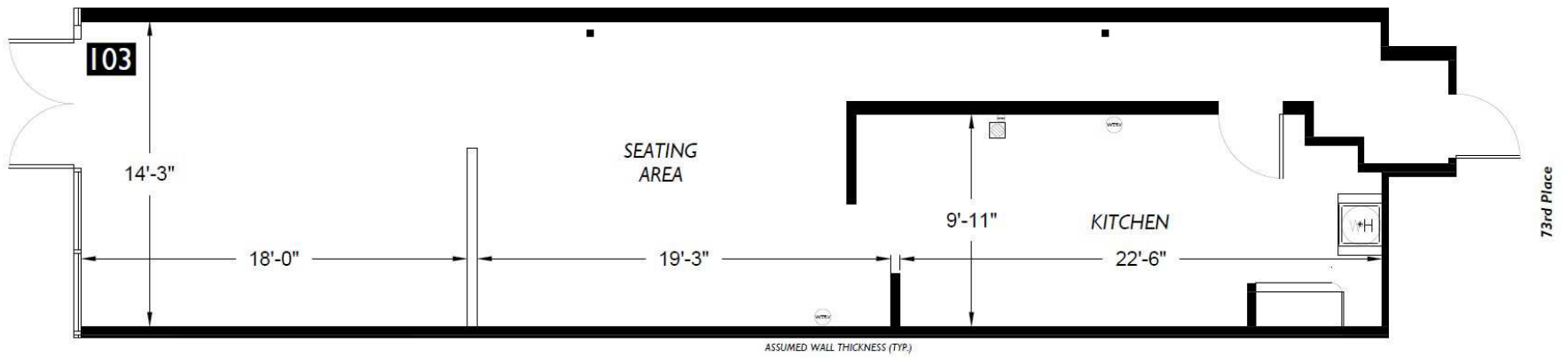

SUITE 105



SUITE 103 - FLOOR PLAN

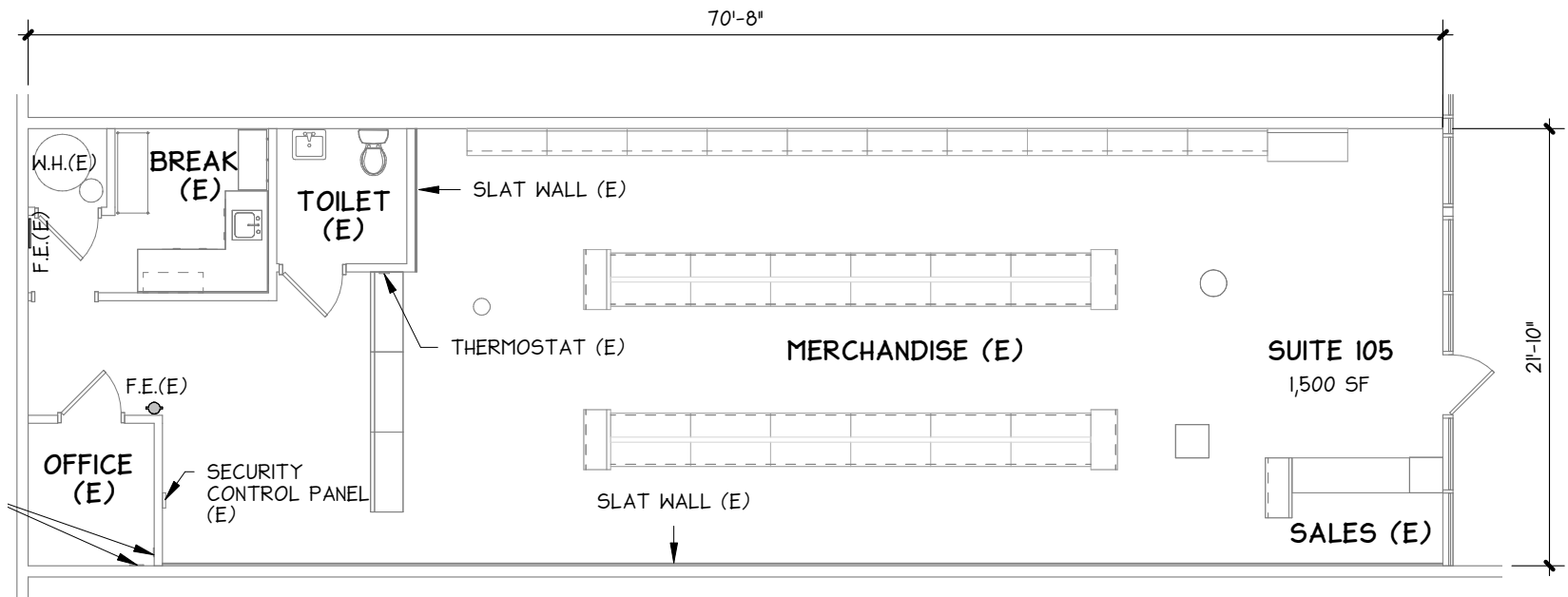

SUITE 107



SUITE 107 - FLOOR PLAN

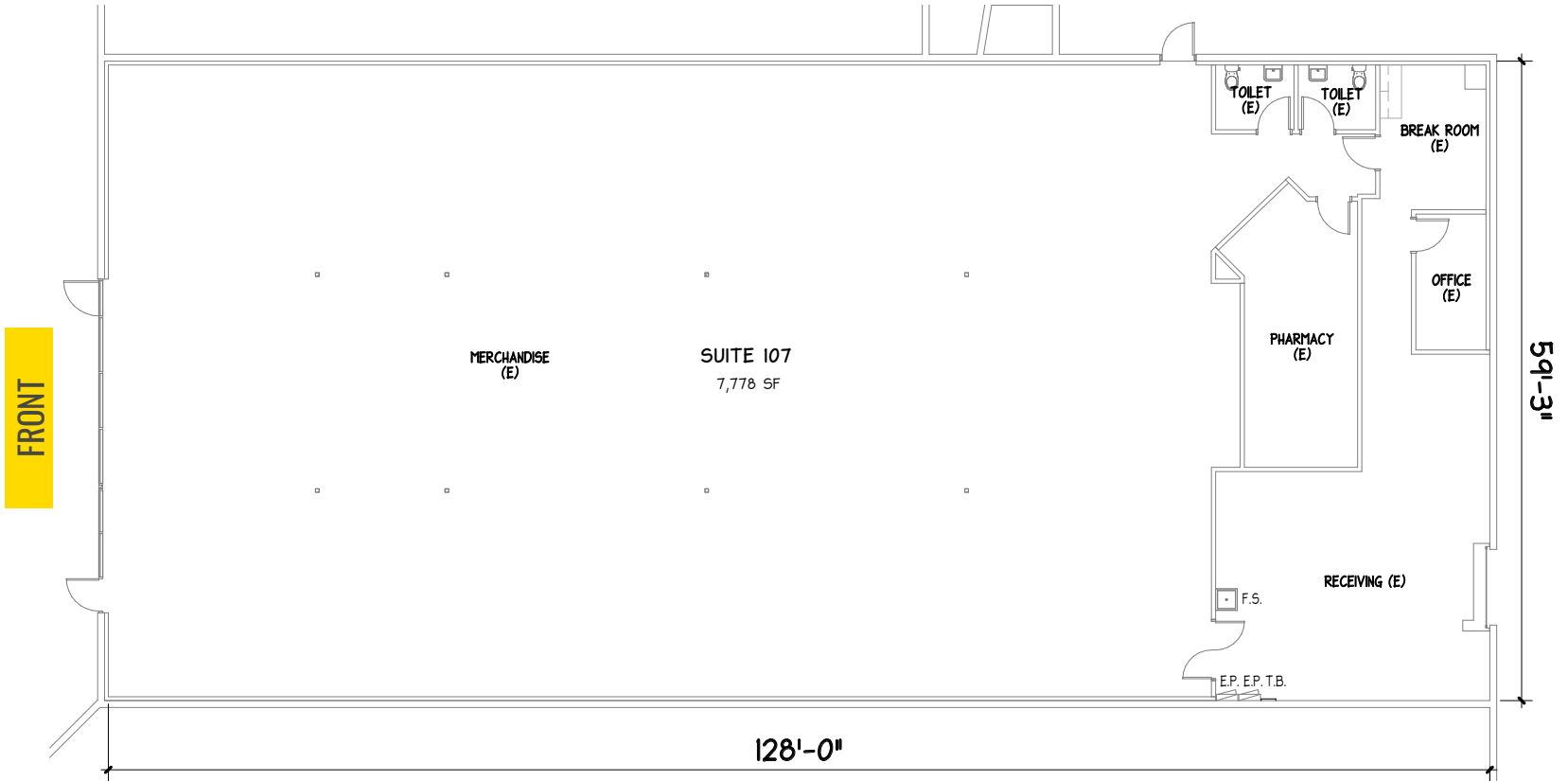

FLOOR PLANS/FACADE RENDERINGS

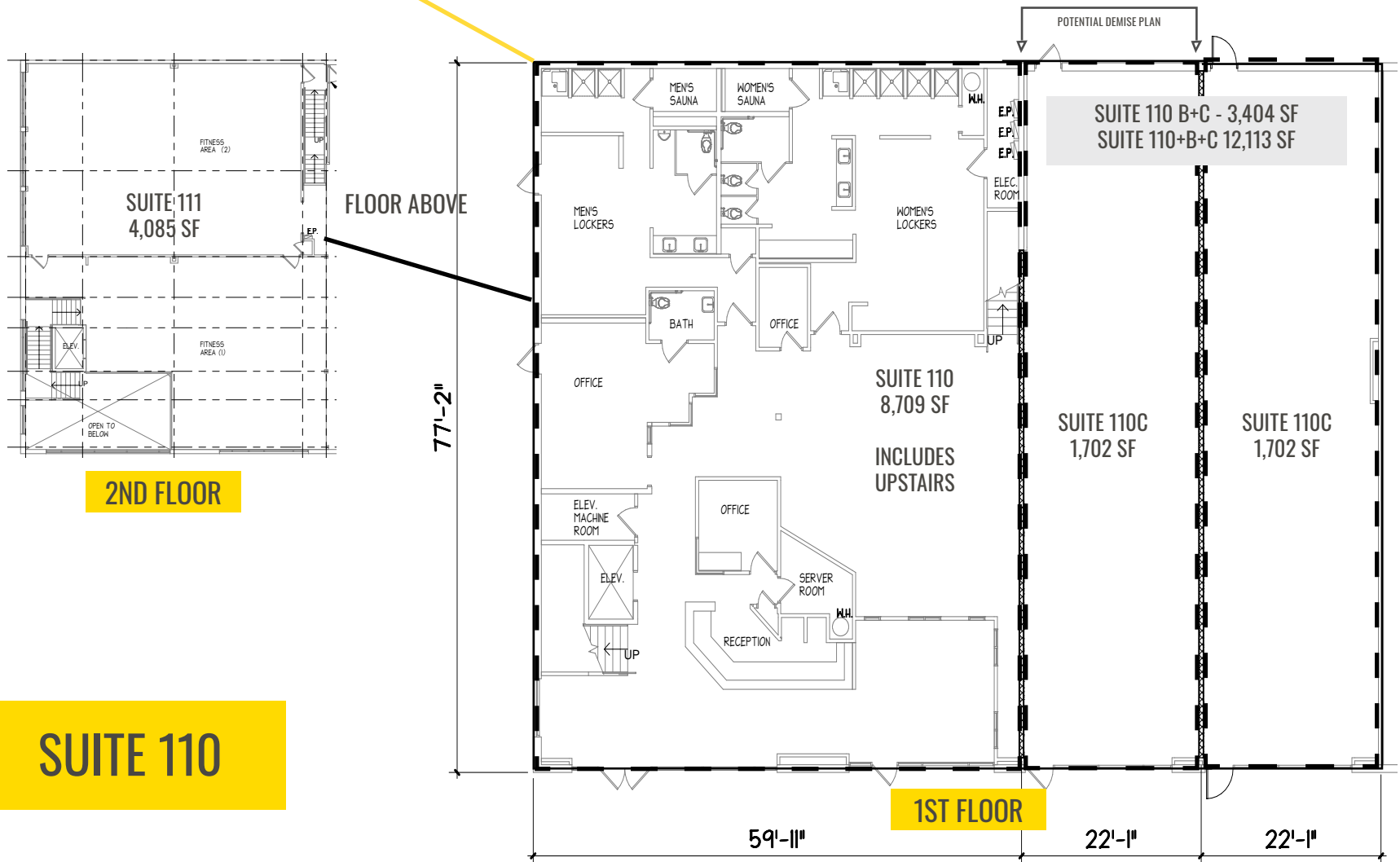

SUITE 110



SUITE 110

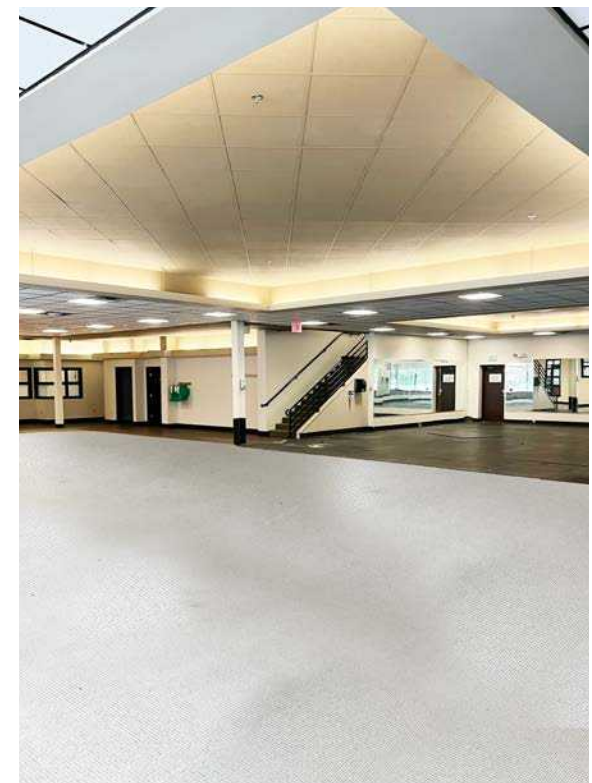

TACOMA | KIRKLAND | PORTLAND | SEATTLE

RELATIONSHIP FOCUSED.
RESULTS DRIVEN.

JUSTIN HOLMES

 253.447.2282

 justin@firstwesternproperties.com

JOSH PARNELL

 253.284.3630

 josh@firstwesternproperties.com

LUCY MALONE

 253.284.3634

 lucy@firstwesternproperties.com

First Western Properties—Tacoma Inc. | 253.472.0404
6402 Tacoma Mall Blvd, Tacoma, WA 98409 | fwp-inc.com

© First Western Properties, Inc. DISCLAIMER: The above information has been secured from sources believed to be reliable, however, no representations are made to its accuracy. Prospective tenants or buyers should consult their professional advisors and conduct their own independent investigation. Properties are subject to change in price and/or availability without notice.

