

**FOR LEASE**

14130 Juanita Dr NE  
Kirkland, WA 98011



**FACADE RENOVATION NOW COMPLETE!**



**INGLEWOOD VILLAGE**

Justin Holmes | Josh Parnell | Lucy Malone

First Western Properties—Tacoma Inc. | 253.472.0404  
6402 Tacoma Mall Blvd, Tacoma, WA 98409 | fwp-inc.com

**INGLEWOOD VILLAGE** benefits from stable demographics and a solid foundation of established anchor tenants. QFC, and Finn Hill Animal Hospital draw steady foot traffic from the surrounding affluent Finn Hill neighborhood, which is home to approximately 52,841 residents\*. This consistent customer base contributes to the center's long-term viability and makes it an attractive location for both national and local tenants seeking exposure in a well-trafficked community hub.

\*Source: www.kirklandwa.gov

**AVAILABLE**

- SUITE 103: 1,122 SF (CALL FOR DETAILS)
- SUITE 105: 1,500 SF (CALL FOR DETAILS)
- SUITE 107: 7,778 SF (CALL FOR DETAILS)
- 1,702-12,113 ± SF (CALL FOR DETAILS)

\*CAN BE DEMISED

- QFC Anchored Shopping Center located in Kirkland
- New Pylon Signage Available
- New Parking Lot with Ample Parking
- Located on major traffic corridor of Juanita Drive



Population



Average HH Income



Daytime Population

Regis - 2025

	Population	Average HH Income	Daytime Population
Mile 1	9,807	\$233,200	4,383
Mile 3	111,028	\$191,903	56,892
Mile 5	355,470	\$197,585	209,911

**NEARBY TENANTS**

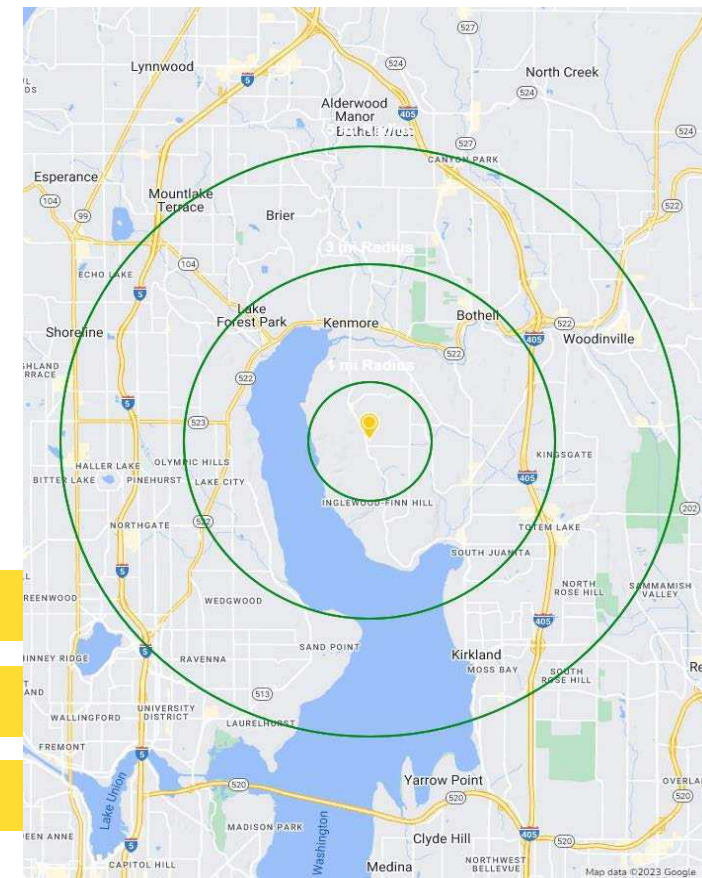

# LOCATION AERIAL

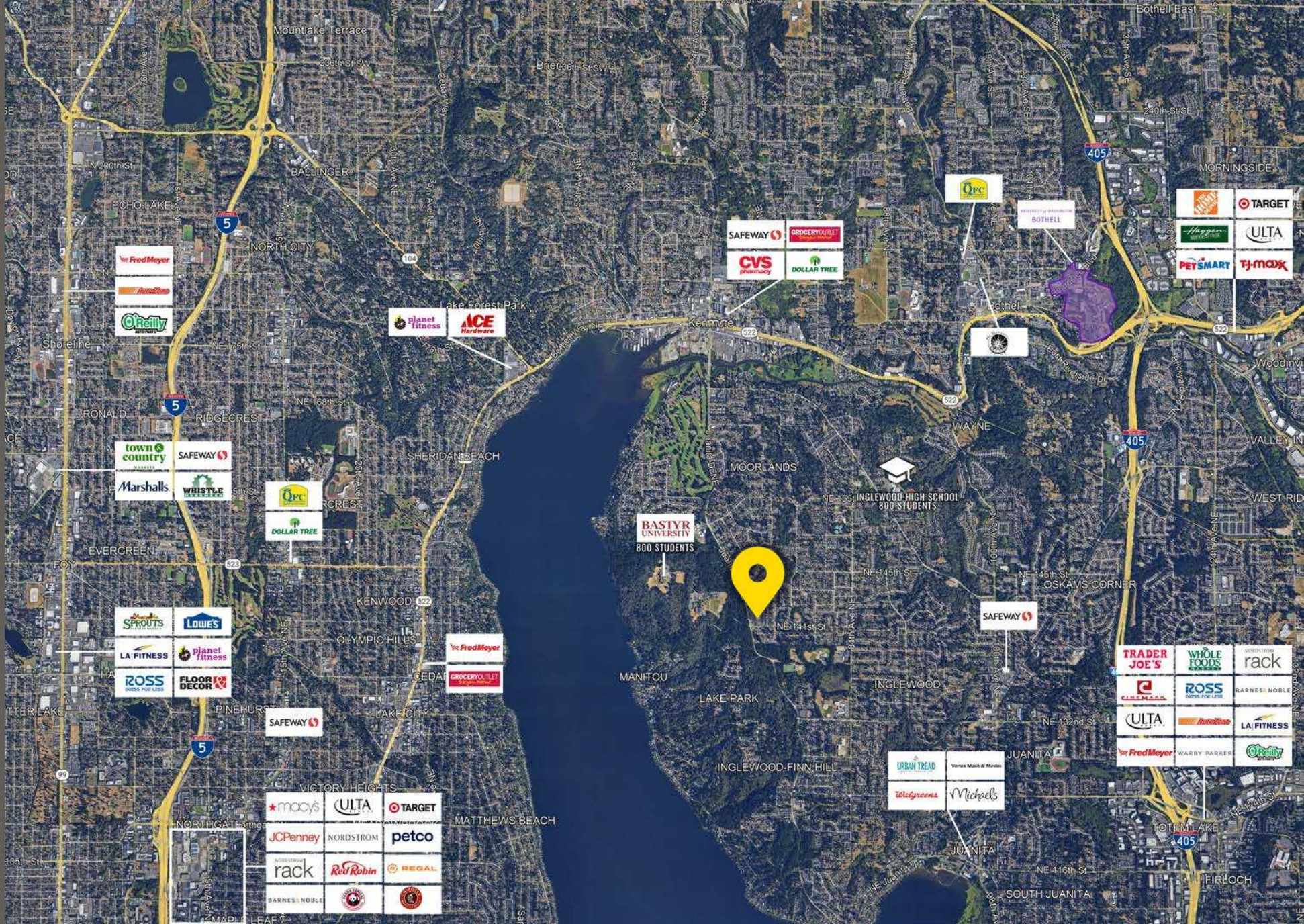

3,665 CPD  
NE 144th St



9,433 CPD  
Juanita Dr NE



Located in Inglewood neighborhood with strong HH incomes



Just moments from I-405 & HWY 522

# SITE PLAN



Renovated Space Available



JUANITA DRIVE NORTHEAST

Suite #	Tenant	SF
<b>111</b>	<b>AVAILABLE</b>	<b>1,702 - 12,113</b>
110	Mod Skin and Body	1,584
109	Thai Golden Bowl	1,540
108	Finn Hill Animal Hospital	3,174
<b>107</b>	<b>AVAILABLE</b>	<b>7,778</b>
106	QFC	27,601

Suite #	Tenant	SF
<b>105</b>	<b>AVAILABLE</b>	<b>1,500</b>
104	Nail Salon	855
<b>103</b>	<b>AVAILABLE</b>	<b>1,122</b>
102	Kami Teriyaki	1,600
101	Tacos El Guero	2,035
200	Over the Brick	1,951

# SUITE 103



## SUITE 103 - FLOOR PLAN

FRONT

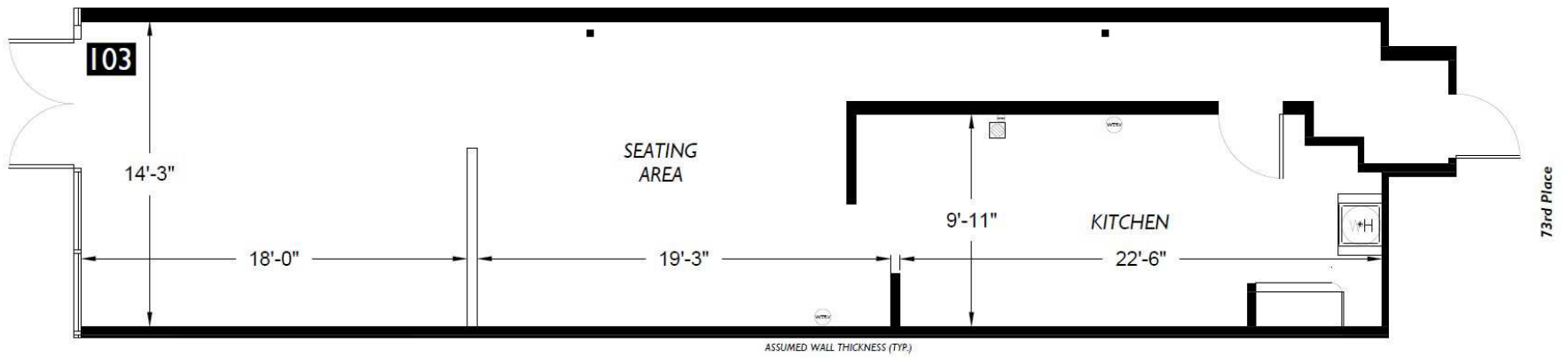

# SUITE 105



## SUITE 105 - FLOOR PLAN

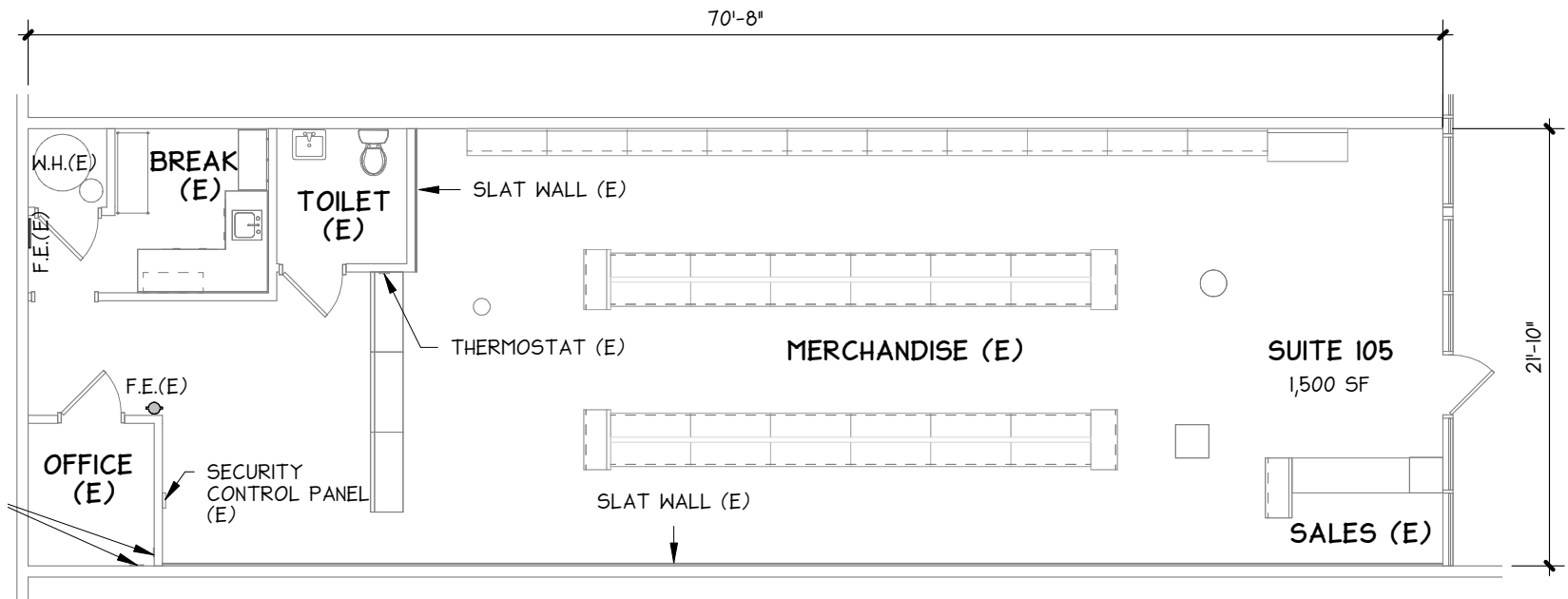

# SUITE 107



## SUITE 107 - FLOOR PLAN

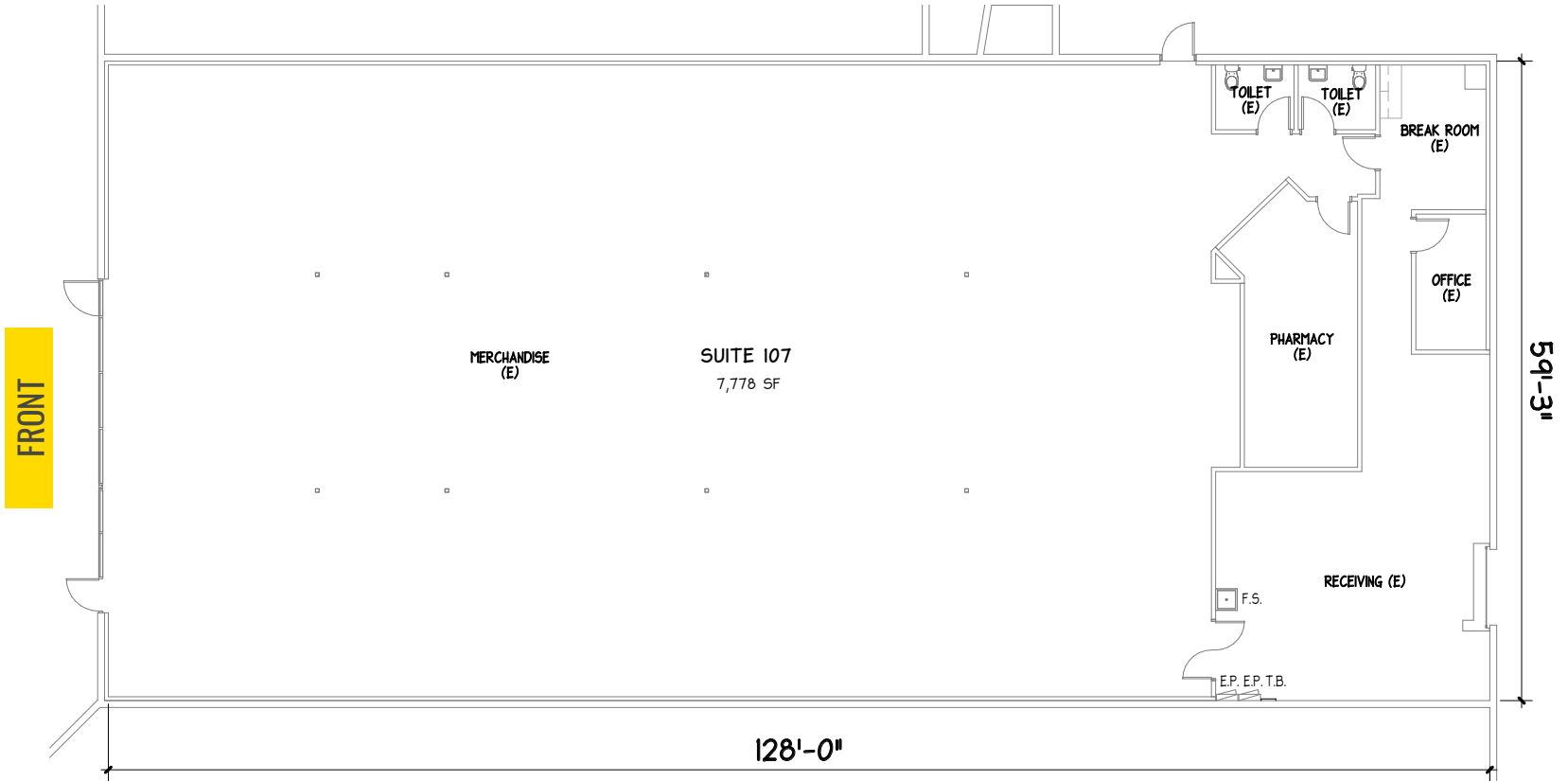

# FLOOR PLANS/FACADE RENDERINGS

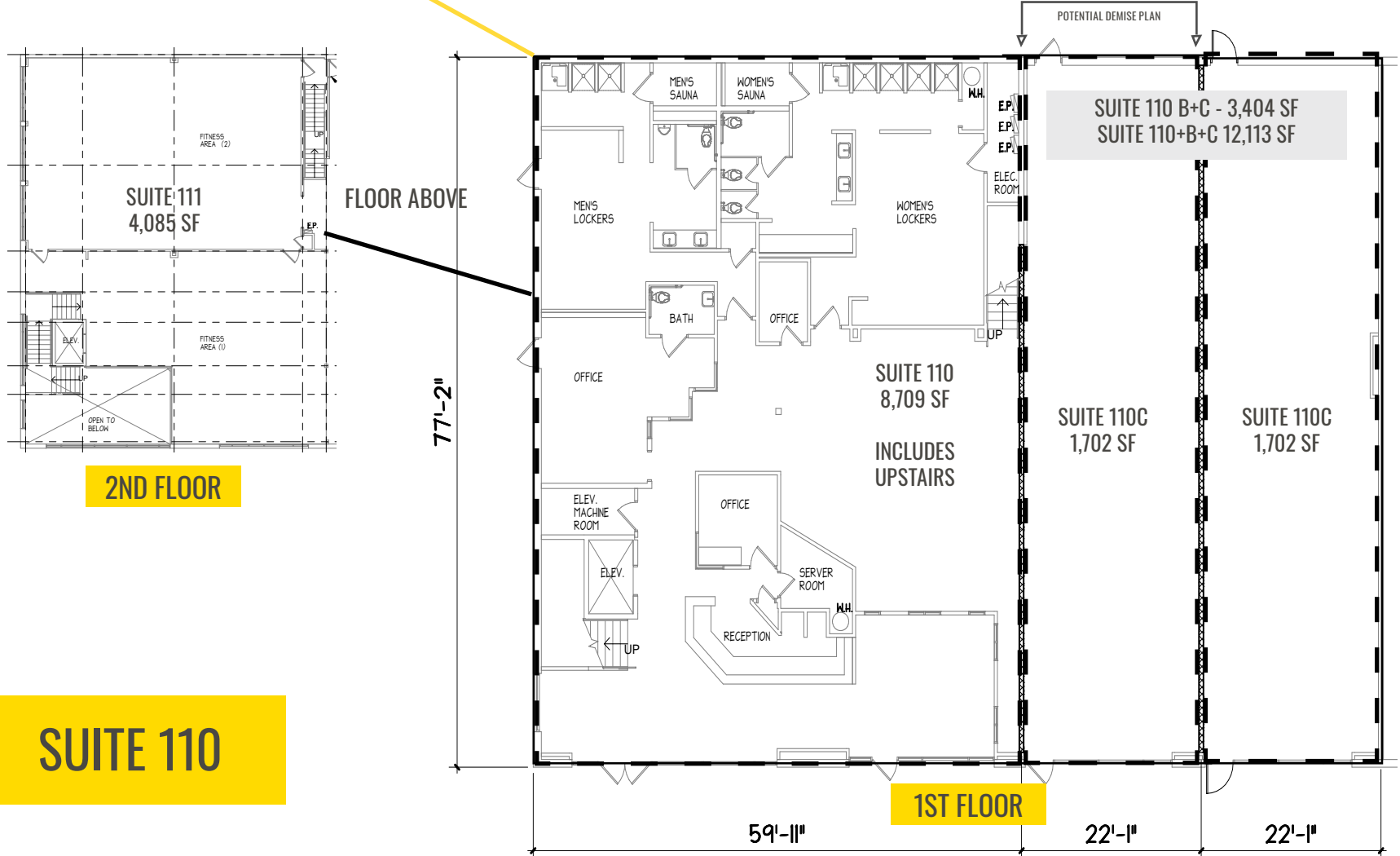

**SUITE 110**



**SUITE 110**

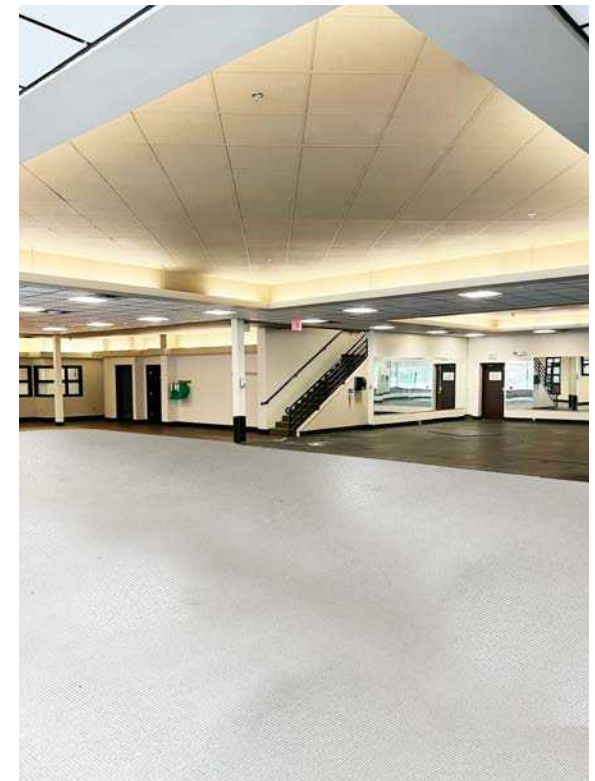

TACOMA | KIRKLAND | PORTLAND | SEATTLE

RELATIONSHIP FOCUSED.  
RESULTS DRIVEN.

JUSTIN HOLMES

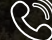
 253.447.2282

 [justin@firstwesternproperties.com](mailto:justin@firstwesternproperties.com)

JOSH PARNELL

 253.284.3630

 [josh@firstwesternproperties.com](mailto:josh@firstwesternproperties.com)

LUCY MALONE

 253.284.3634

 [lucy@firstwesternproperties.com](mailto:lucy@firstwesternproperties.com)

First Western Properties—Tacoma Inc. | 253.472.0404  
6402 Tacoma Mall Blvd, Tacoma, WA 98409 | fwp-inc.com

© First Western Properties, Inc. DISCLAIMER: The above information has been secured from sources believed to be reliable, however, no representations are made to its accuracy. Prospective tenants or buyers should consult their professional advisors and conduct their own independent investigation. Properties are subject to change in price and/or availability without notice.

