

RETAIL FOR LEASE

# COPAL

*Prime Retail Available in the Spring District,  
Adjacent to BelRed Light Rail Station*

13101-13191 NE SPRING BLVD | BELLEVUE, WA



KIDDER.COM

**km** Kidder  
Mathews

*Multiple opportunities at the newly constructed Copal building. Easy access from downtown Bellevue, Redmond, and freeways.*

Available Now.  
Contact brokers for rates.

951 - 4,087 SF (some suites can be combined)

RETAIL A	1,325 RSF
RETAIL B	951 RSF
RETAIL C	2,273 RSF
RETAIL D	1,814 RSF
RETAIL E	Half Moon



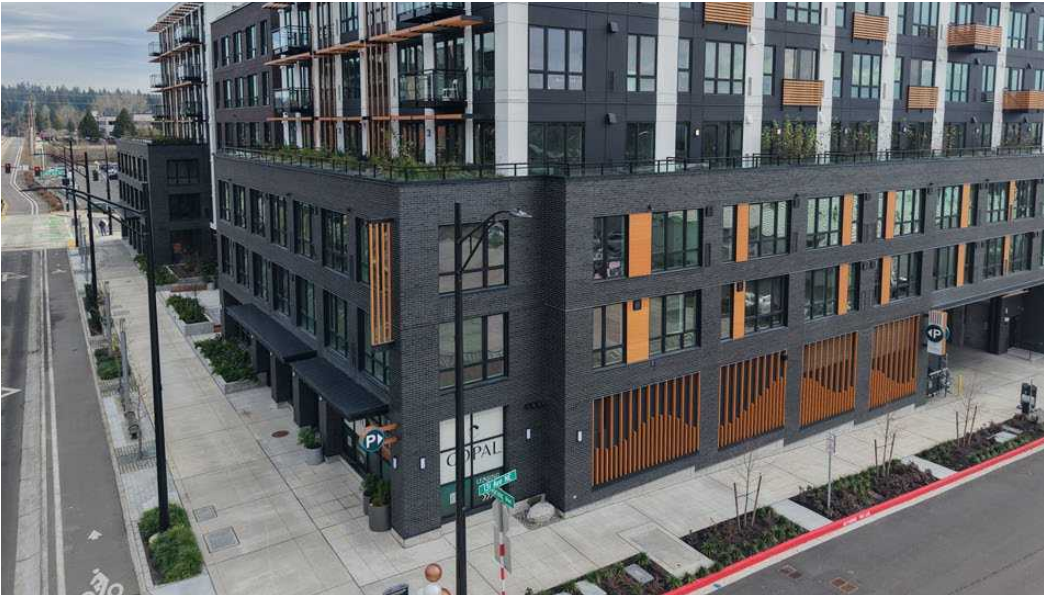

# RETAIL SITE PLAN

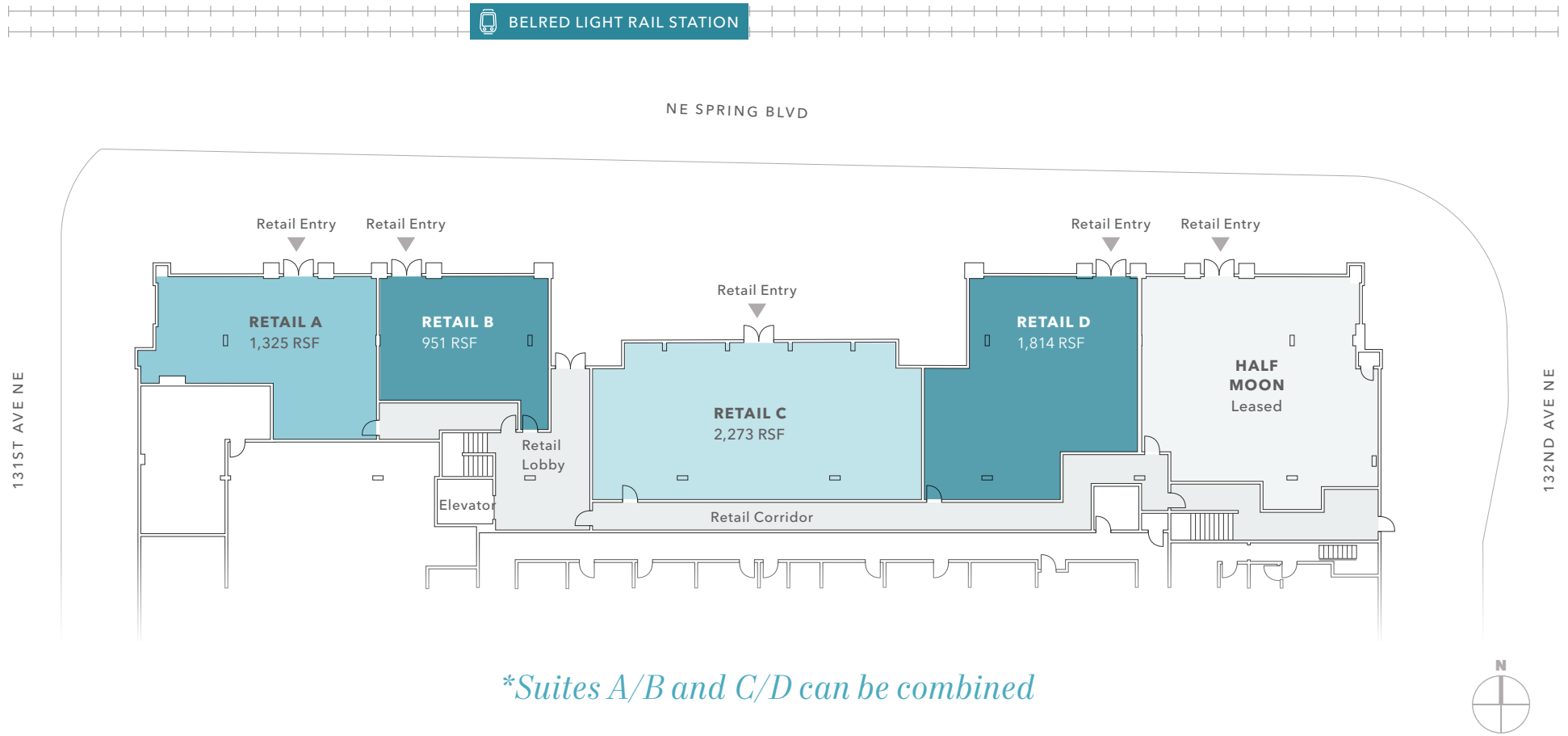

*\*Suites A/B and C/D can be combined*

*Virtual Tours Available*

 TOUR RETAIL A

 TOUR RETAIL B

 TOUR RETAIL C

 TOUR RETAIL D

# RETAIL PARKING

NE SPRING BLVD

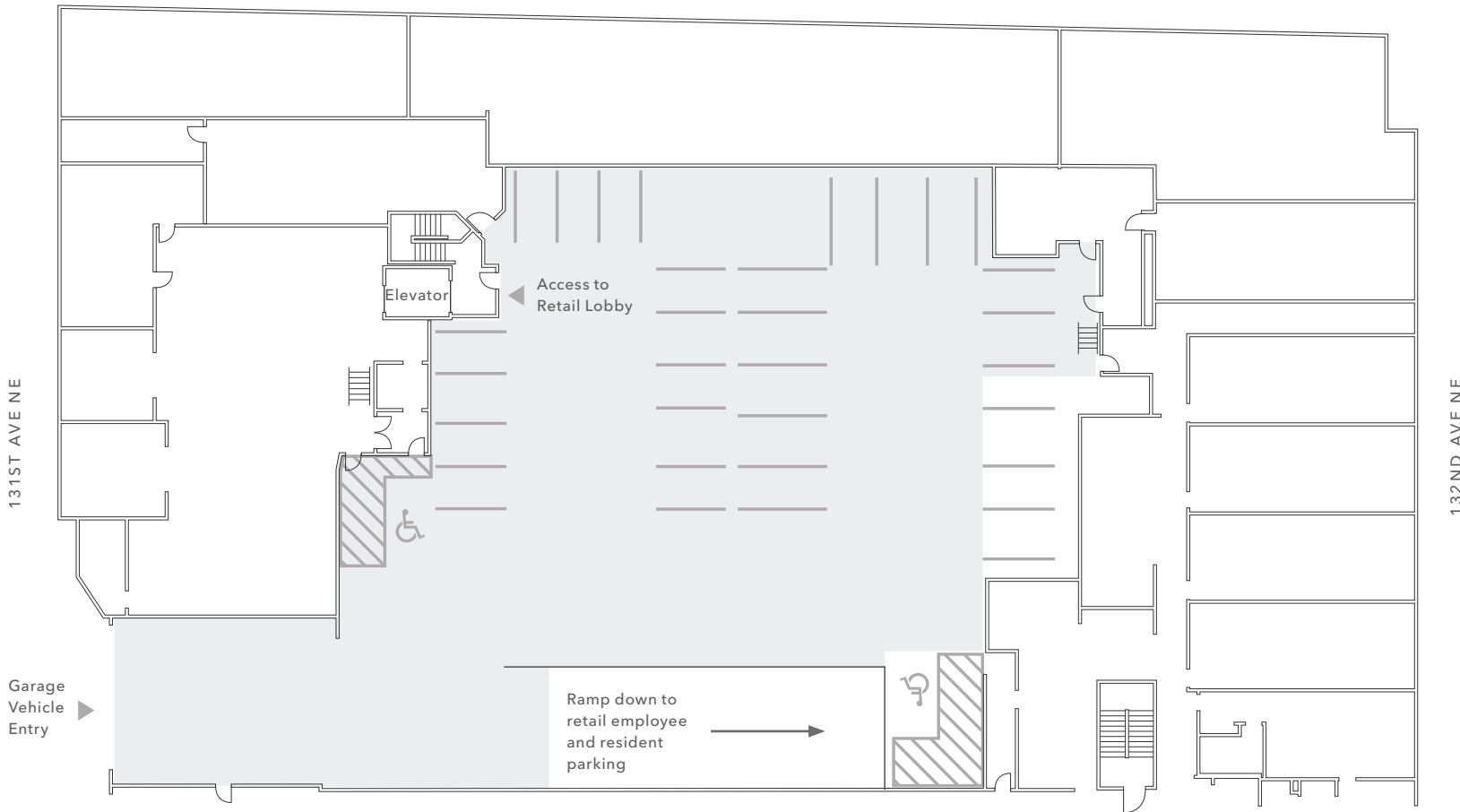

23

RETAIL STALLS

9

RETAIL EMPLOYEE STALLS



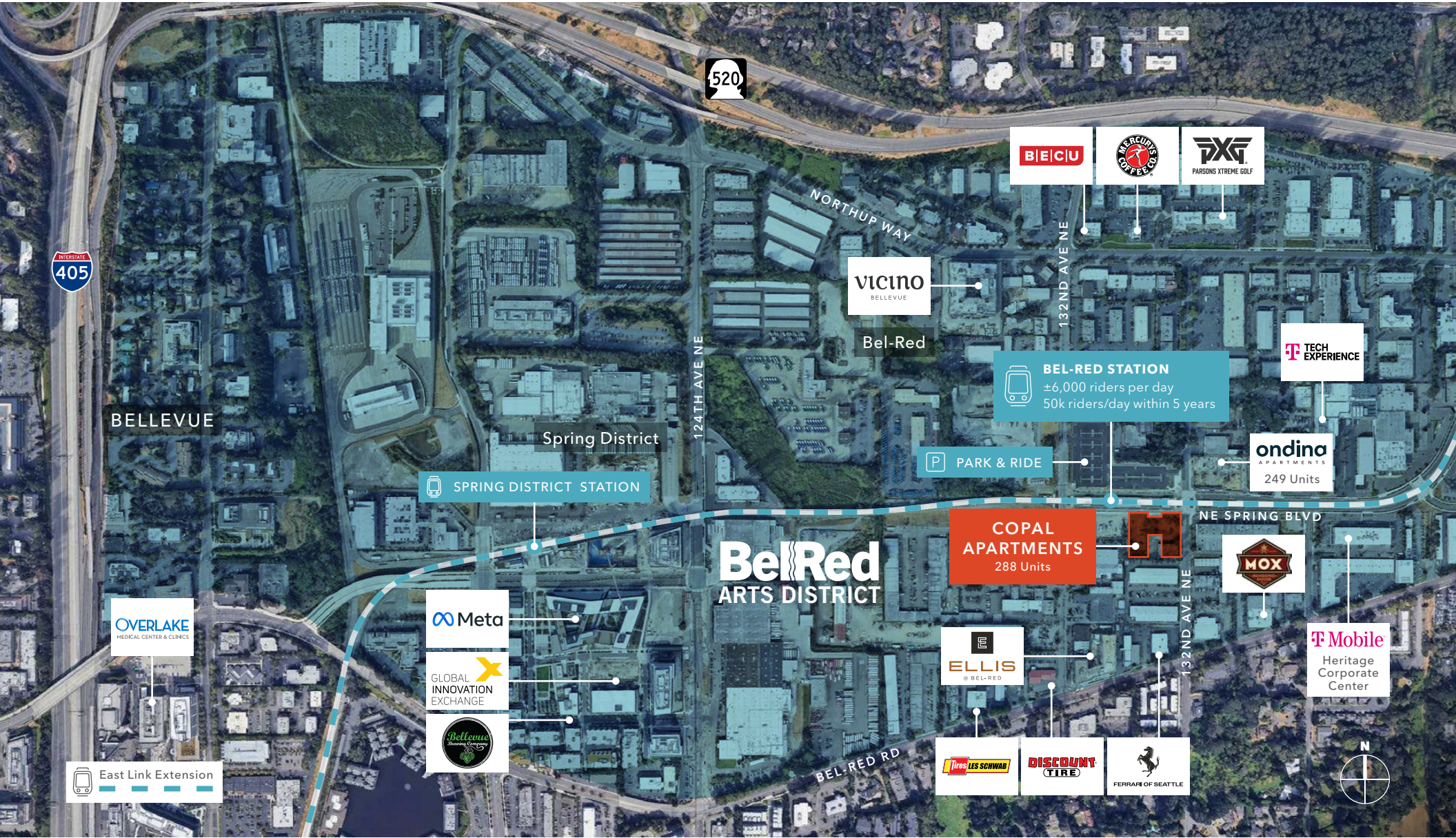

# DEMOGRAPHICS

## POPULATION

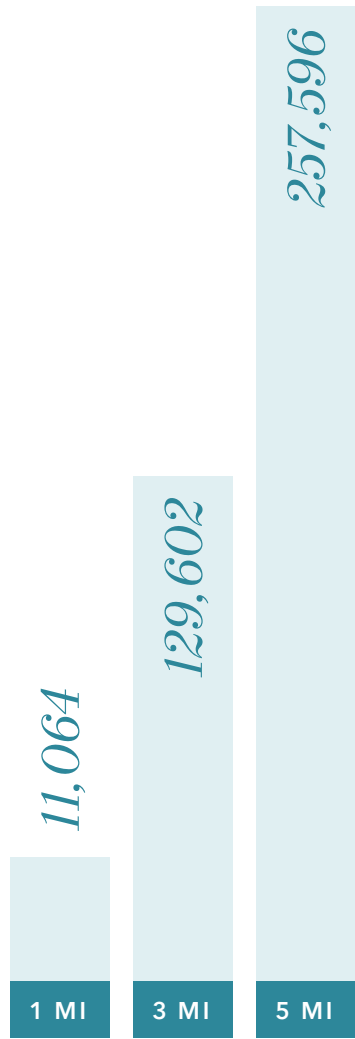

## AVERAGE HOUSEHOLD INCOME

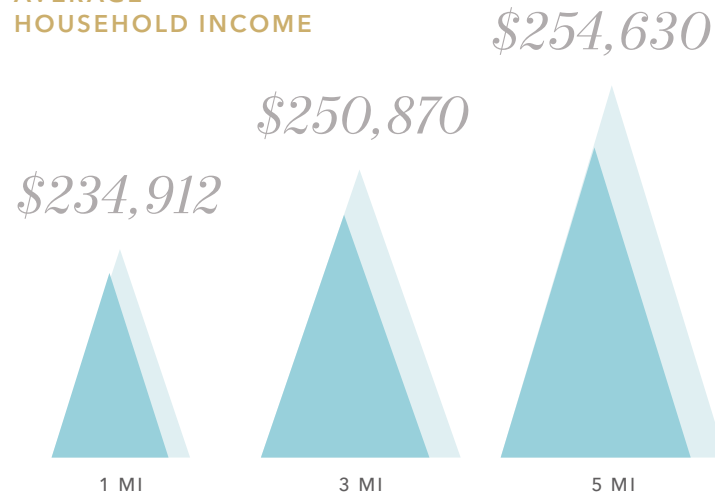

## MEDIAN AGE

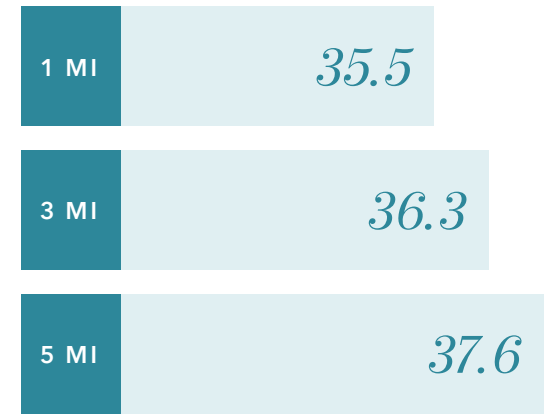

## ESTIMATED HOUSEHOLDS

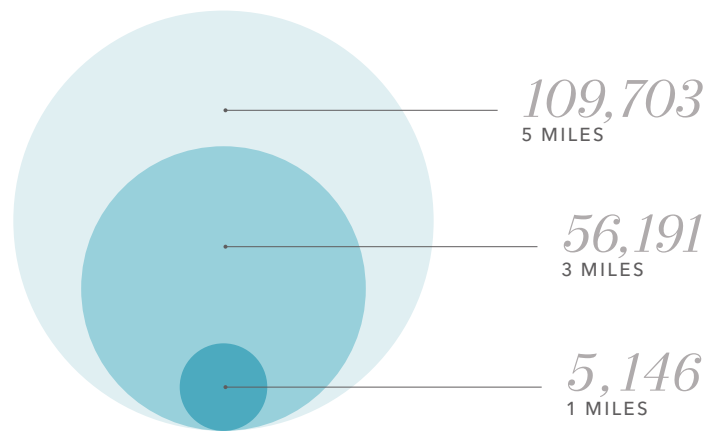

## ESTIMATED EMPLOYEES

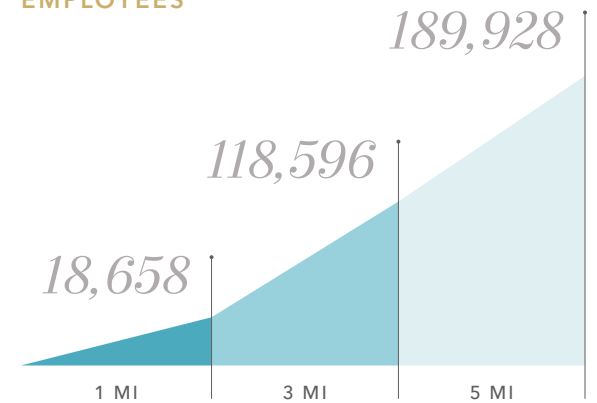

Data Source: ©2024, Sites USA



## COPAL RETAIL

*Exclusively  
leased by*

**MONICA WALLACE**  
Executive Vice President  
425.450.1104  
monica.wallace@kidder.com

**KELLY GADDIS**  
Senior Vice President  
425.450.1136  
kelly.gaddis@kidder.com

**MIA PONCE**  
Senior Associate  
425.450.1137  
mia.ponce@kidder.com

**KIDDER.COM**

This information supplied herein is from sources we deem reliable. It is provided without any representation, warranty, or guarantee, expressed or implied as to its accuracy. Prospective Buyer or Tenant should conduct an independent investigation and verification of all matters deemed to be material, including, but not limited to, statements of income and expenses. Consult your attorney, accountant, or other professional advisor. All Kidder Mathews designs are the sole property of Kidder Mathews. Branded materials and layouts are not authorized for use by any other firm or person.

