

PARK 277

4401 D Street Northwest, Auburn, WA 98001

54,804 SF | FOR LEASE



Matt Wood, SIOR
206-595-6814
matt.wood@kbcadvisors.com

KBC Advisors | Seattle 5628 Airport Way South, Suite 238, Seattle, WA 98108



FLOOR PLAN



SPACE INFORMATION

Available now

54,804 SF total

1,776 SF office

12 dock-high doors

1 grade-level door

30' clear height

Rail potential

Unparalleled access to SR-167 & I-5

Equidistant to Port of Seattle & Port of Tacoma

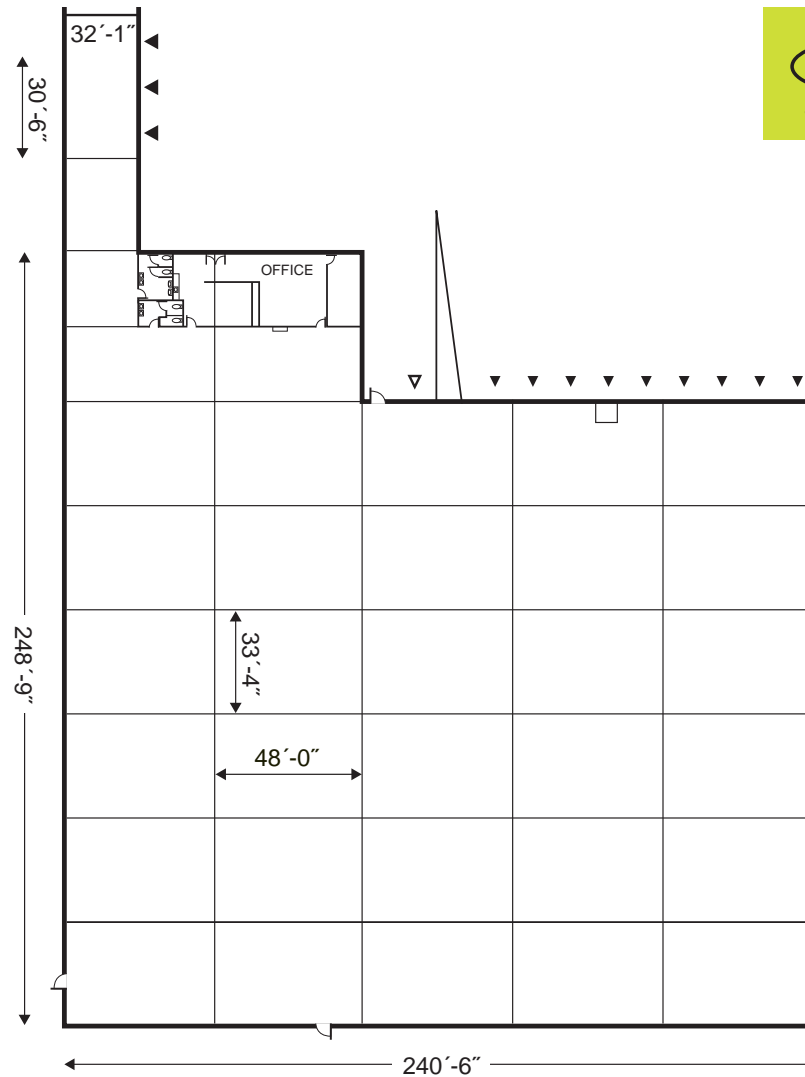

Matt Wood, SIOR
206-595-6814
matt.wood@kbcadvisors.com

KBC Advisors | Seattle 5628 Airport Way South, Suite 238, Seattle, WA 98108



Ownership Advisor:





LOCATION

State Route 167	1 minute
Interstate 5	5 minutes
Port of Tacoma	25 minutes
Port of Seattle	25 minutes

Matt Wood, SIOR
 206-595-6814
 matt.wood@kbcadvisors.com

