

# AUBURN ITC BLDG B, STE 150



SUITE 150

*Industrial Space  
For Lease*

*14,850*  
TOTAL SF

*950*  
OFFICE SF

*CALL*  
FOR RATES

14,850 SF total / 950 SF office

6 dock-high doors

1 oversized grade-level door (12' x 16')

24' clear height

Easy access to SR-167 via 277th St or 15th St & access to I-5 via 277th St

M-1 zoning

Canopies over loading doors

50' concrete aprons

Available now

Call agent for rates

**CHRIS CORR**  
206.248.7324  
chris.corr@kidder.com

**MATT MURRAY, SIOR**  
206.248.6541  
matt.murray@kidder.com

**KIDDER.COM**

This information supplied herein is from sources we deem reliable. It is provided without any representation, warranty, or guarantee, expressed or implied as to its accuracy. Prospective Buyer or Tenant should conduct an independent investigation and verification of all matters deemed to be material, including, but not limited to, statements of income and expenses. Consult your attorney, accountant, or other professional advisor.



*14,850 SF*

TOTAL AVAILABLE

*950 SF*

OFFICE

*CALL*

FOR RATES

**SUITE 150 FLOOR PLAN**

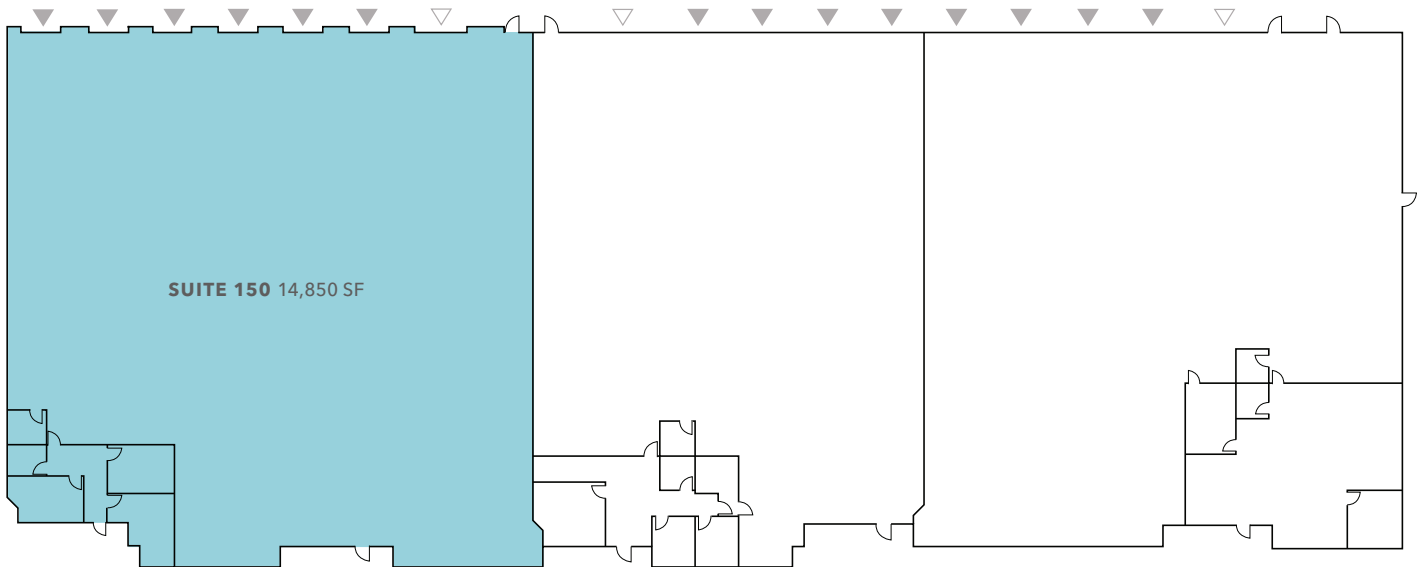

▲ Drive-In Loading

△ Dock-High Loading

**KIDDER.COM**

This information supplied herein is from sources we deem reliable. It is provided without any representation, warranty, or guarantee, expressed or implied as to its accuracy. Prospective Buyer or Tenant should conduct an independent investigation and verification of all matters deemed to be material, including, but not limited to, statements of income and expenses. Consult your attorney, accountant, or other professional advisor.

