

Commercial Space for Lease | The Trailhead

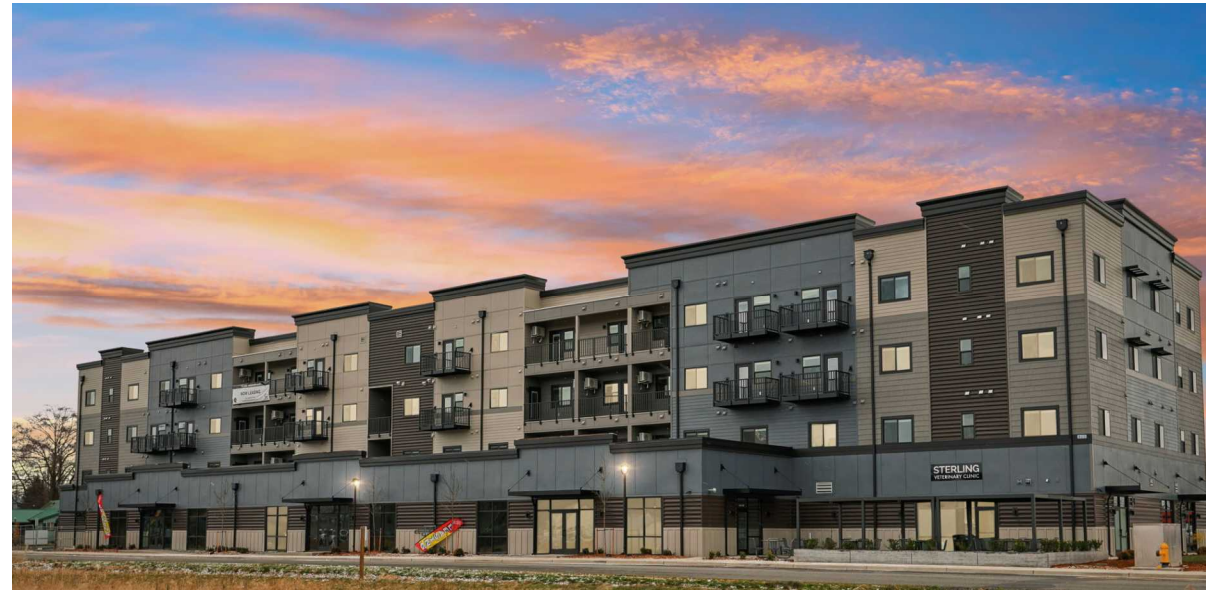

- One Space available for around 3,700 sf built to suit! The space can be cut up into 1,500 sf increments. The building will have 67 luxury apartments for rent with tons of parking. The building is fully leased, and there are two commercial spaces leased, Bee Fit Gym, and Sterling Vet Clinic are already operating onsite.
- Make this your next office space, retail space, service space, restaurant or tap room!
- Great location in Sedro-Woolley in the Urban Village Mixed use zone on Trail road adjacent to Hwy 20 and Cook road.
- Building Owner is willing to work together on the Tenant Improvement costs as well as get them constructed during the construction process.
- Starting Rent at \$20 per sf, NNN estimated to be \$4-5 per sf, 5 year lease minimum.

820 Trail Road Sedro-Woolley WA 98284

SITE MAP

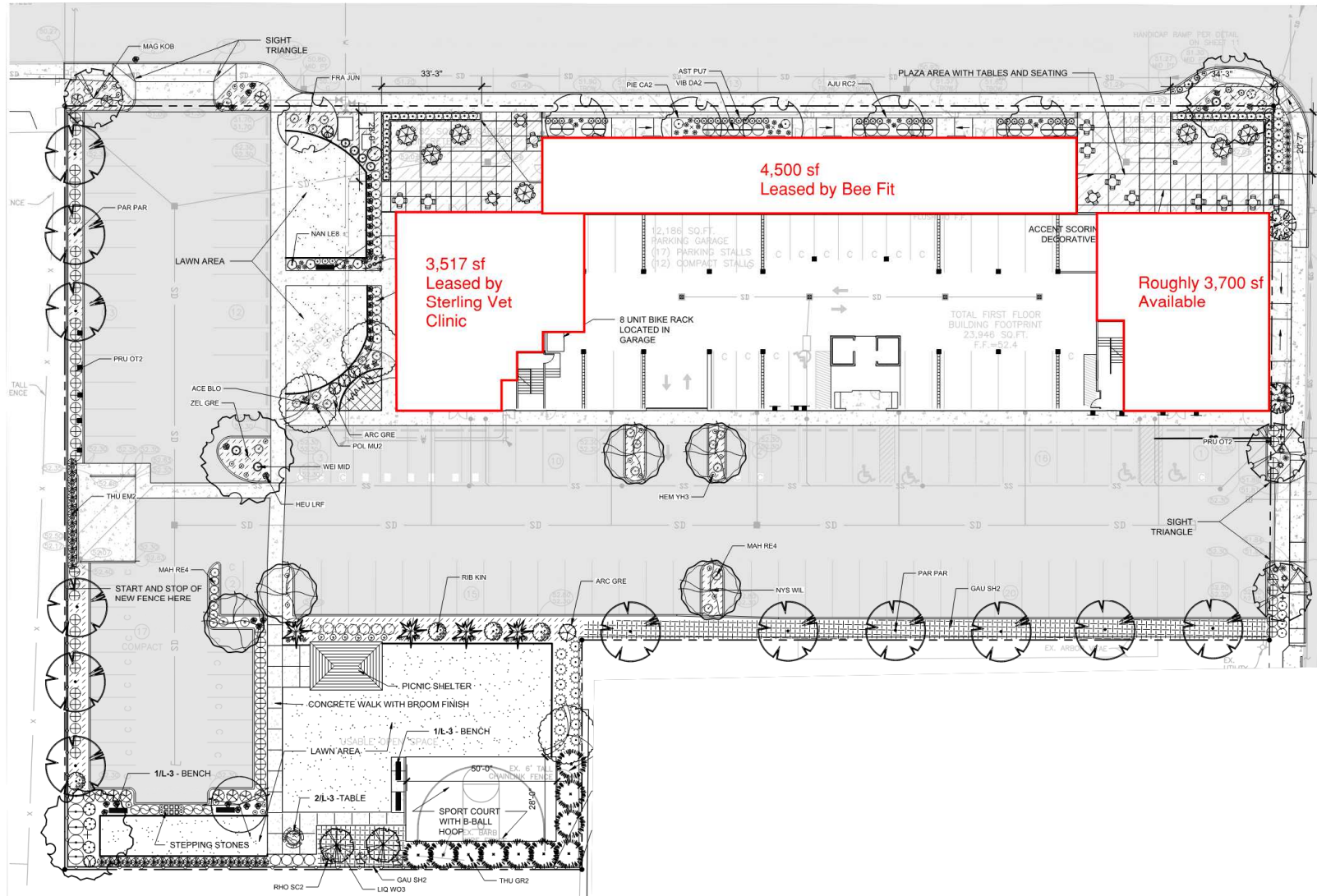

AERIAL MAP

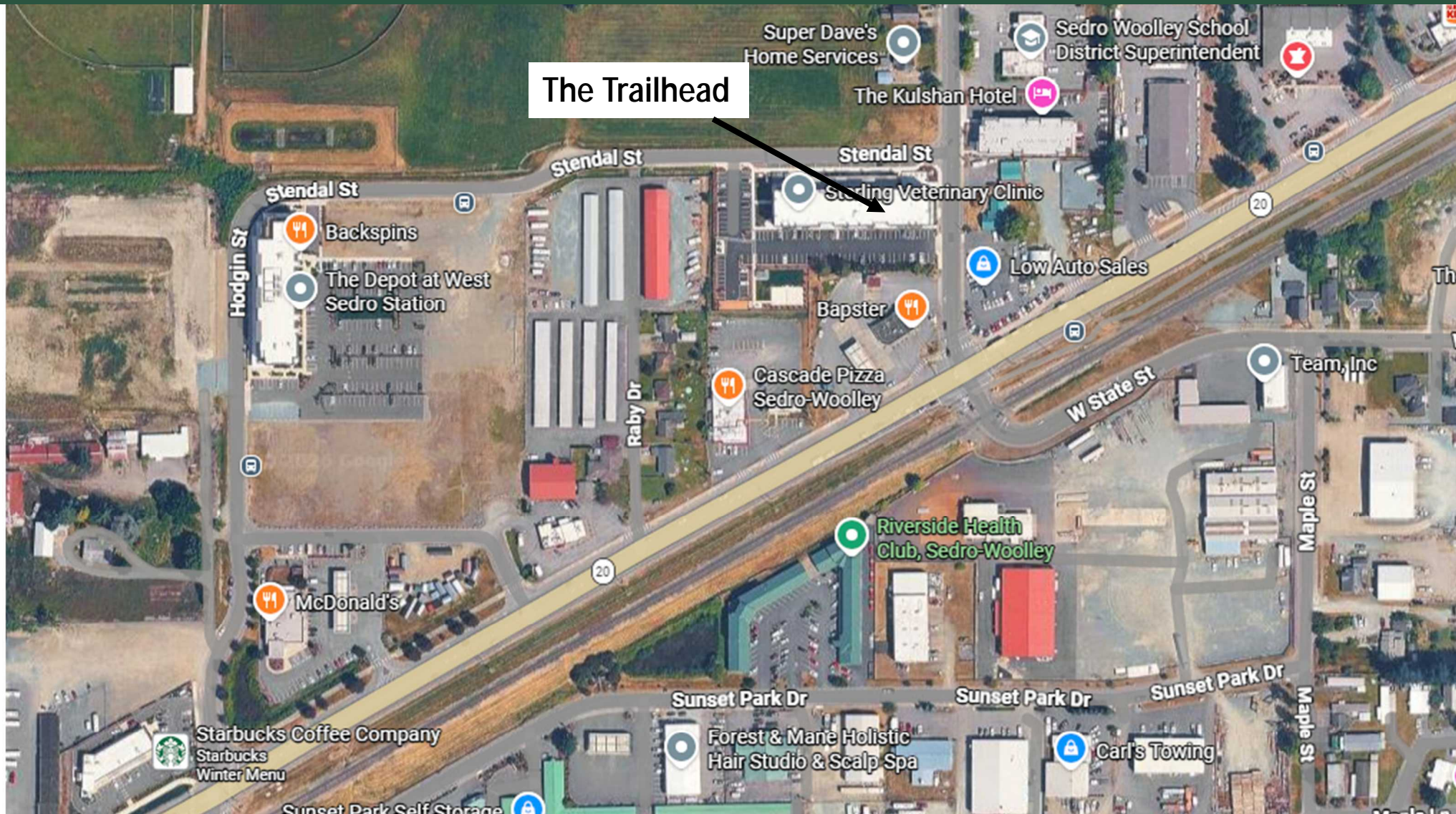

This property is Co-listed by-



Paul Woodmansee
Key Northwest
Real Estate Broker & Owner

Email:
paul@keynorthwestwa.com
360.661.5325



Jason Boggs BROKER
(360) 770-2099

