



MALTBY COMMERCE CENTER *BUILDING A*

*18,852 SF (Divisible)
Retail/Flex/Industrial
Space Available for Lease*

21301 87TH AVE SE, BLDG A
WOODINVILLE, WA

ROGER THORN
First Vice President
425.450.1120
roger.thorn@kidder.com

RYAN JONES
Senior Vice President
425.450.1117
ryan.jones@kidder.com

KIDDER.COM



FLEX SPACES FOR LEASE— *UP TO ±18,852 SF*

Maltby Commerce center is a two-building warehouse and retail/flex development delivering Q1 2026.



MALTBY COMMERCE CENTER

PROPERTY HIGHLIGHTS

18,852 SF (divisible) of retail/flex space available

Corner site near future interchange intersection of 87th Ave SE & Maltby Road (SR 524)

Excellent parking

Easy access to Hwy 522 and only six miles to I-405

Zoned Light Industrial Snohomish County, which also allows retail uses

24' clear height

8 grade-level doors

Delivering Q1 2026

ROGER THORN

First Vice President
425.450.1120
roger.thorn@kidder.com

RYAN JONES

Senior Vice President
425.450.1117
ryan.jones@kidder.com



BUILDING A

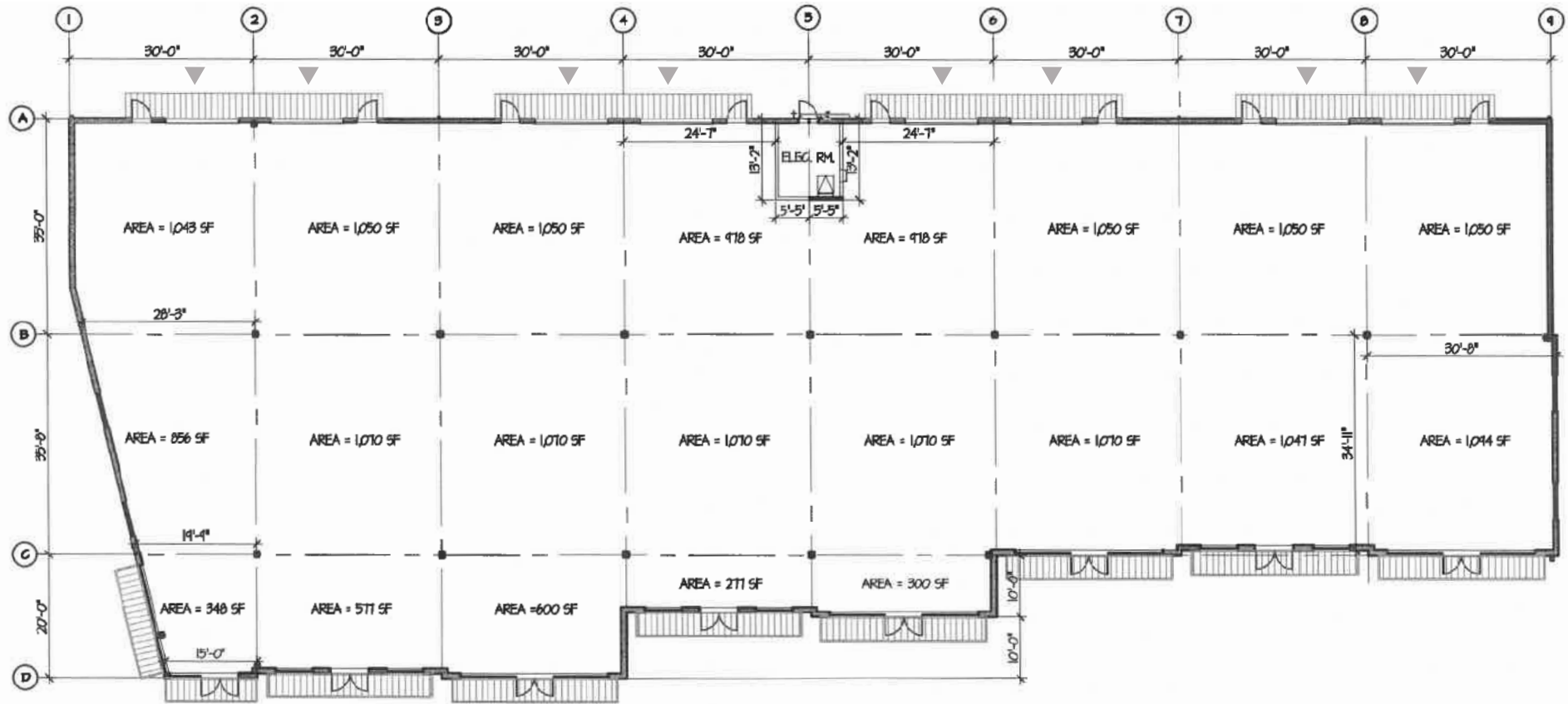

▲ Grade-level loading

Up to 400 AMP of 480V,
3-phase power

MALTBY COMMERCE CENTER



WSDOT CONSTRUCTION & PLANNING

SR 522 INTERCHANGE & WIDENING

Future Improvements Planned from Paradise Lake Road to Snohomish River Bridge

State Road 522 in Snohomish County is an increasingly important east-west route connecting communities between Woodinville and Monroe. One section between Paradise Lake Road in Maltby and the Snohomish River remains one-lane in each direction. WSDOT plans to widen the highway to two lanes in each direction, build a new eastbound bridge at Fales Road/Echo Lake Road, replace the SR 522 intersection at Paradise Lake Road with an interchange and remove fish barriers.

| | |
|----------------|------------------|
| TIMELINE | TBD |
| PROJECT STATUS | Pre-construction |
| FUNDING | \$33.5 Million |

Source: Washington State Department of Transportation



MALTBY COMMERCE CENTER

5.3 MILES

TO WOODINVILLE

11.9 MILES

TO REDMOND

20 MILES

TO BELLEVUE

27 MILES

TO SEATTLE



WINERIES & TASTING ROOMS

| | | |
|--------------|---------------|------------|
| J.P. TRODDEN | GORMAN WINERY | GUARDIAN |
| LATERUS | TWO VINTNERS | JM CELLARS |

| | | |
|----------------------|-----------------|----------------------|
| SNOQUALMIE ICE CREAM | The Maltby Cafe | MALTBY PIZZA & PASTA |
|----------------------|-----------------|----------------------|

Flower World

CRISPY KRUNCHY CHICKEN

MALTBY COMMERCE CENTER

IN DEVELOPMENT
Snohomish Garden Townhomes - 196 units

WINERIES & TASTING ROOMS

| | | |
|-----------------|-------------------|-----------------------|
| SMASNE CELLARS | PATTERSON CELLARS | BOSK |
| BARRAGE Cellars | LONGCELLARS | TRIPLEHORN BREWING CO |

COSTCO WHOLESALE

Haggen NORTHWEST FRESH

Target

WORLD MARKET

ROSS DRESS FOR LESS

PET SMART

BARNES & NOBLE

MOD

AMC THEATRES

Rusty Pelican CAFE

Ezell's Famous Chicken

Jamba

Panera BREAD

DEMOGRAPHICS

POPULATION

| | 1 Mile | 3 Miles | 5 Miles |
|-----------------|--------|---------|---------|
| 2025 TOTAL | 1,617 | 21,732 | 125,621 |
| 2030 PROJECTION | 1,583 | 21,447 | 124,679 |
| 2020 CENSUS | 1,619 | 21,832 | 124,072 |

MEDIAN AGE & GENDER

| | 1 Mile | 3 Miles | 5 Miles |
|------------|--------|---------|---------|
| MEDIAN AGE | 44.7 | 41.3 | 38.2 |
| FEMALE | 48.5% | 49.1% | 49.9% |
| MALE | 51.5% | 50.9% | 50.1% |

HOUSEHOLDS

| | 1 Mile | 3 Miles | 5 Miles |
|-----------------|--------|---------|---------|
| 2025 TOTAL | 572 | 7,493 | 45,563 |
| 2030 PROJECTED | 567 | 7,464 | 45,621 |
| 2020 CENSUS | 566 | 7,416 | 44,201 |
| OWNER-OCCUPIED | 90.1% | 89.0% | 73.9% |
| RENTER-OCCUPIED | 9.9% | 11.0% | 26.1% |

INCOME

| | 1 Mile | 3 Miles | 5 Miles |
|-----------------------------|-----------|-----------|-----------|
| 2025 MEDIAN HH INCOME | \$178,529 | \$188,089 | \$171,924 |
| 2030 PROJ. MEDIAN HH INCOME | \$178,983 | \$189,607 | \$172,383 |
| ANNUAL CHANGE 2025 - 2030 | - | 0.2% | - |

EMPLOYMENT

| | 1 Mile | 3 Miles | 5 Miles |
|----------------------|--------|---------|---------|
| TOTAL BUSINESSES | 241 | 1,443 | 5,708 |
| TOTAL EMPLOYEES | 2,878 | 13,377 | 48,852 |
| WHITE COLLAR WORKERS | 69.6% | 76.7% | 77.1% |
| BLUE COLLAR WORKERS | 30.4% | 23.3% | 22.9% |

EDUCATION

| | 1 Mile | 3 Miles | 5 Miles |
|---------------------|--------|---------|---------|
| SOME HIGH SCHOOL | 2.5% | 1.8% | 1.9% |
| HIGH SCHOOL DIPLOMA | 18.4% | 16.3% | 13.2% |
| SOME COLLEGE | 17.8% | 16.0% | 14.8% |
| ASSOCIATE | 9.4% | 9.2% | 8.4% |
| BACHELOR'S | 33.4% | 33.6% | 34.7% |
| GRADUATE | 18.1% | 22.1% | 25.2% |

Data Source: ©2025, Sites USA



MALTBY COMMERCE CENTER | BUILDING A

*For more information about
this property, please contact*

ROGER THORN
First Vice President
425.450.1120
roger.thorn@kidder.com

RYAN JONES
Senior Vice President
425.450.1117
ryan.jones@kidder.com

KIDDER.COM

This information supplied herein is from sources we deem reliable. It is provided without any representation, warranty, or guarantee, expressed or implied as to its accuracy. Prospective Buyer or Tenant should conduct an independent investigation and verification of all matters deemed to be material, including, but not limited to, statements of income and expenses. Consult your attorney, accountant, or other professional advisor. All Kidder Mathews designs are the sole property of Kidder Mathews. Branded materials and layouts are not authorized for use by any other firm or person.

