

FOR LEASE

MERIDIAN SQUARE

11904 - 11910 MERIDIAN E
PUYALLUP, WA 98373

*2 retail suites available
1,067 SF endcap space &
1,918 SF*

SUITE A2



MERIDIAN SQUARE



PROPERTY OVERVIEW

Suite A1 1,067 SF, NNN, endcap space

Suite A2 1,918 SF, NNN

\$25 base rent + \$9 NNN

Pylon signage available

Signaled intersection

Located on South Hill Meridian with high traffic volume

Close to South Hill Mall, Walgreens, Starbucks, YMCA and other major retailers!

Contact brokers for pricing



JOIN CURRENT TENANTS

GOODYEAR

KITSAP
CREDIT UNION

peopleready
A TRUEBLUE COMPANY

COMPUTER CITY



MERIDIAN SQUARE

SOUTH HILL MALL

39TH AVE SW

MERIDIAN AVE

WILLOWS SHOPPING CENTER

--	--

SUBJECT PROPERTY

MERIDIAN PLACE

AVAILABLE FOR LEASE



KIDDER MATHEWS

SITE PLAN



1,067 SF

SUITE A1

1,918 SF

SUITE A2

11910 MERIDIAN FLOORPLAN - SUITE A2

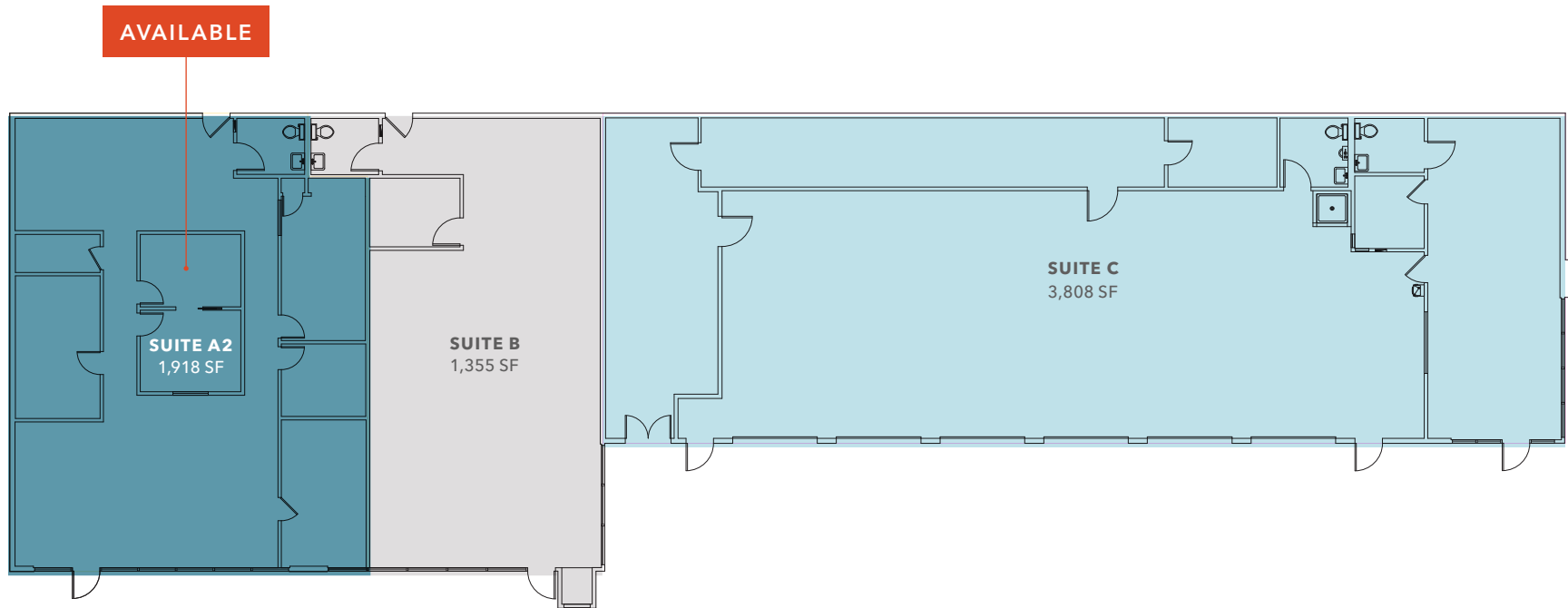

1,918 SF

SUITE A2

NOW

AVAILABLE

11910 MERIDIAN FLOORPLAN - SUITE A1

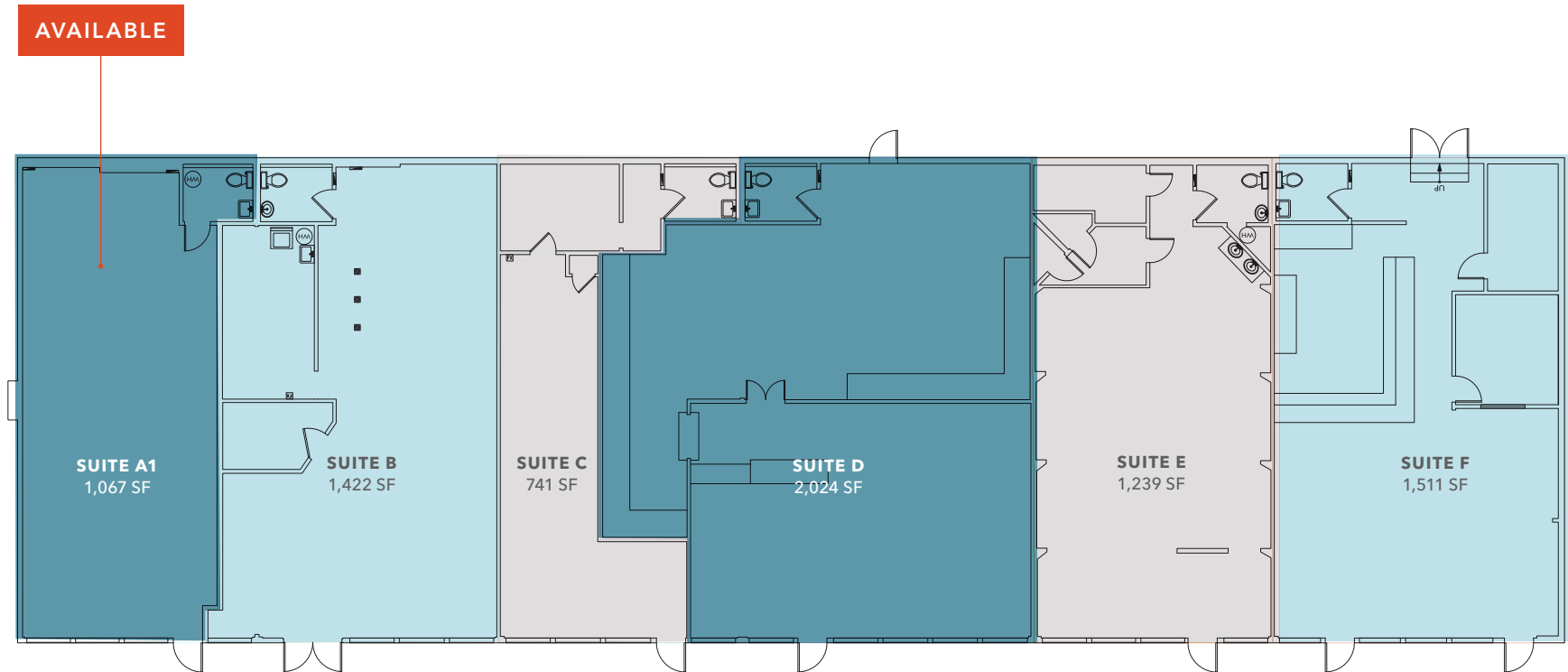

1,067 SF

SUITE A1

NOW

AVAILABLE

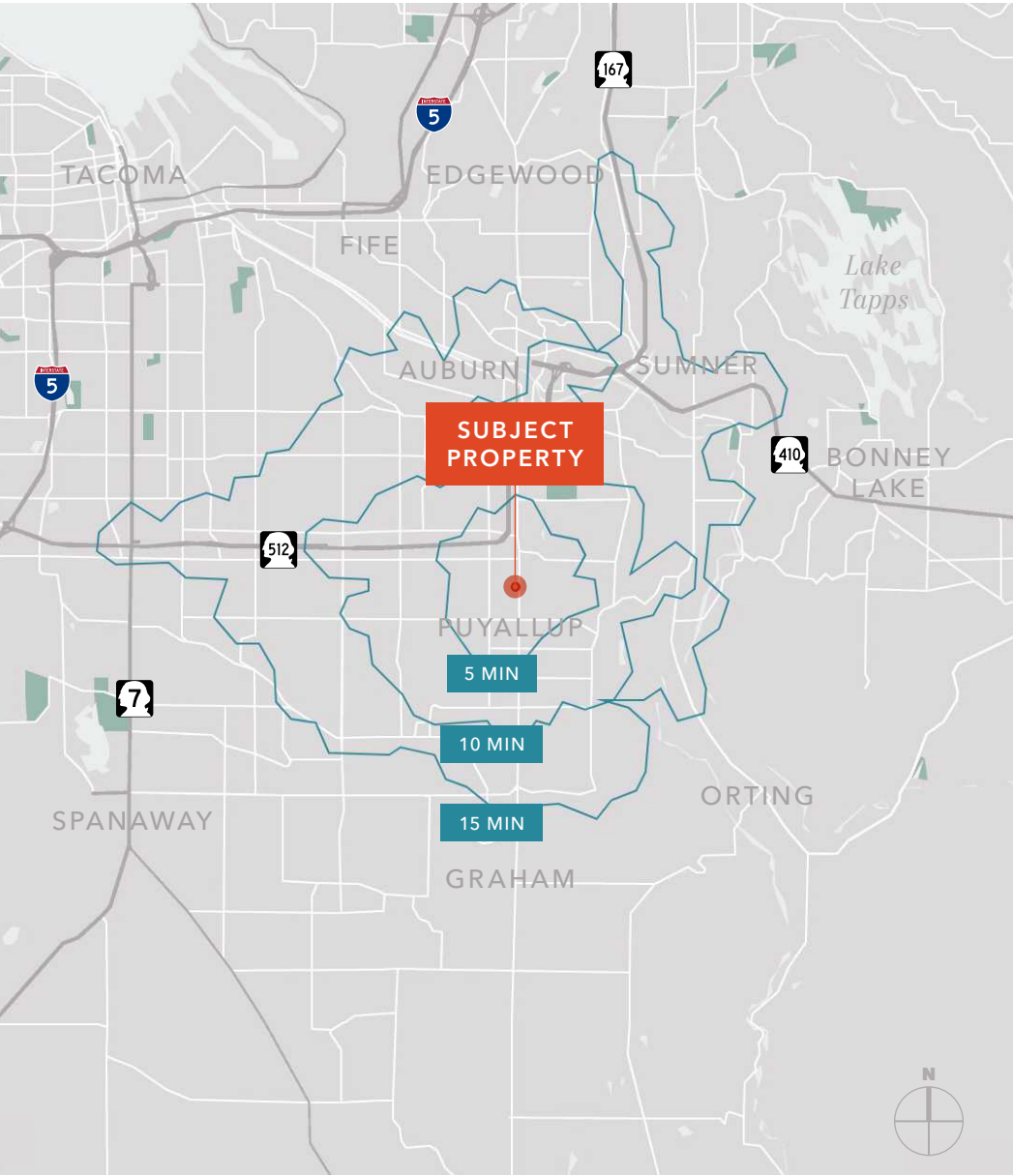

DEMOGRAPHICS

POPULATION

	5 Min	10 Min	15 Min
2024 ESTIMATED	19,792	77,871	153,416
2029 PROJECTED	20,089	78,641	155,656
2020 CENSUS	19,110	78,087	152,794
2010 CENSUS	14,862	66,891	129,489

MEDIAN AGE & GENDER

	5 Min	10 Min	15 Min
MEDIAN AGE	35.8	37.1	37.2
% FEMALE	52.0%	50.6%	50.4%
% MALE	48.0%	49.4%	49.6%

HOUSEHOLDS

	5 Min	10 Min	15 Min
2024 ESTIMATED HOUSEHOLDS	8,343	30,321	58,655
2029 PROJECTED HOUSEHOLDS	8,523	30,770	59,684
2024 AVERAGE INCOME	\$108,408	\$130,010	\$133,404
2029 AVERAGE INCOME PROJ.	\$112,457	\$135,686	\$139,931

Data Source: ©2025, Sites USA

MERIDIAN SQUARE

Exclusively leased by

BLAKE WEBER
Senior Vice President
206.898.1231
blake.weber@kidder.com

NED WHALEN
Senior Vice President
206.491.5998
ned.whalen@kidder.com

DON WHITTLES
Senior Vice President
253.208.2257
don.whittles@kidder.com

TIM WEBER
Executive Vice President
206.650.0391
tim.weber@kidder.com

KIDDER.COM

This information supplied herein is from sources we deem reliable. It is provided without any representation, warranty, or guarantee, expressed or implied as to its accuracy. Prospective Buyer or Tenant should conduct an independent investigation and verification of all matters deemed to be material, including, but not limited to, statements of income and expenses. Consult your attorney, accountant, or other professional advisor. All Kidder Mathews designs are the sole property of Kidder Mathews. Branded materials and layouts are not authorized for use by any other firm or person.

