

FOR LEASE

BRAND NEW DEVELOPMENT



2920 Harrison Ave

Centralia, WA 98531

PROPERTY HIGHLIGHTS

- + Permit approved 12,000 SF building
- + 5 - 14'x14' Grade Level Doors
- + M-1; Light Industrial Zoning
- + Ideal for equipment sales or repair shop
- + Fast growing and thriving Lewis County Submarket
- + 24' Clear Height
- + **\$11,500/month, NNN**
- + Option to add additional 1.24 Acres of yard

BUILDING SIZE

12,000 SF

LOT SIZE

61,841 SF



KYLE SCHIPPER, SIOR

Partner
+1 253 203 1320
kschipper@nai-psp.com

DAVE DOUGLAS, SIOR, CCIM

Partner
+1 253 203 1325
ddouglas@nai-psp.com



THE INFORMATION CONTAINED HEREIN HAS BEEN GIVEN TO US BY THE OWNER OF THE PROPERTY OR OTHER SOURCES WE DEEM RELIABLE, WE HAVE NO REASON TO DOUBT ITS ACCURACY, BUT WE DO NOT GUARANTEE IT. ALL INFORMATION SHOULD BE VERIFIED PRIOR TO PURCHASE OR LEASE.

nai-psp.com

Area Overview



KYLE SCHIPPER, SIOR
Partner
+1 253 203 1320
kschipper@nai-psp.com

DAVE DOUGLAS, SIOR, CCIM
Partner
+1 253 203 1325
ddouglas@nai-psp.com



Site Plan

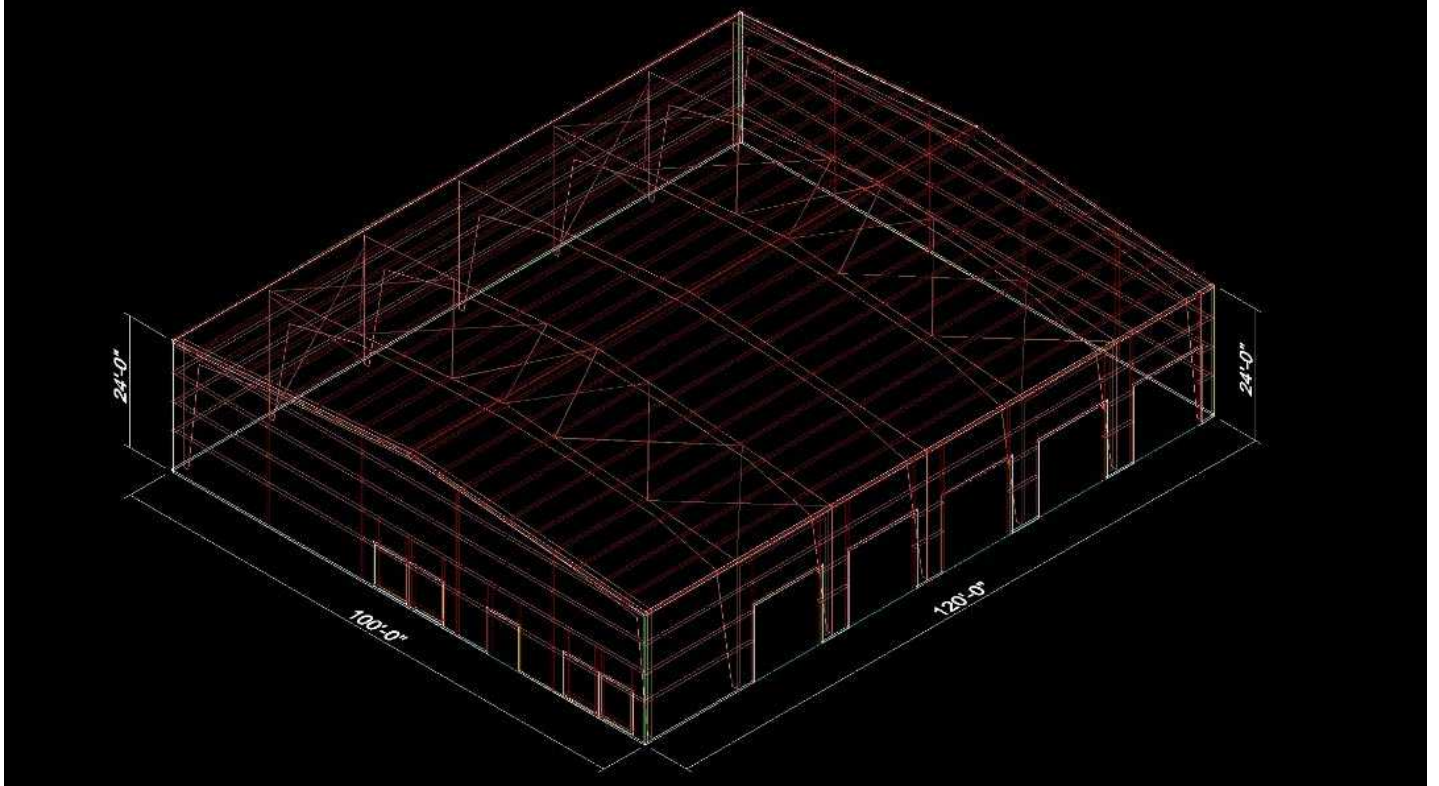
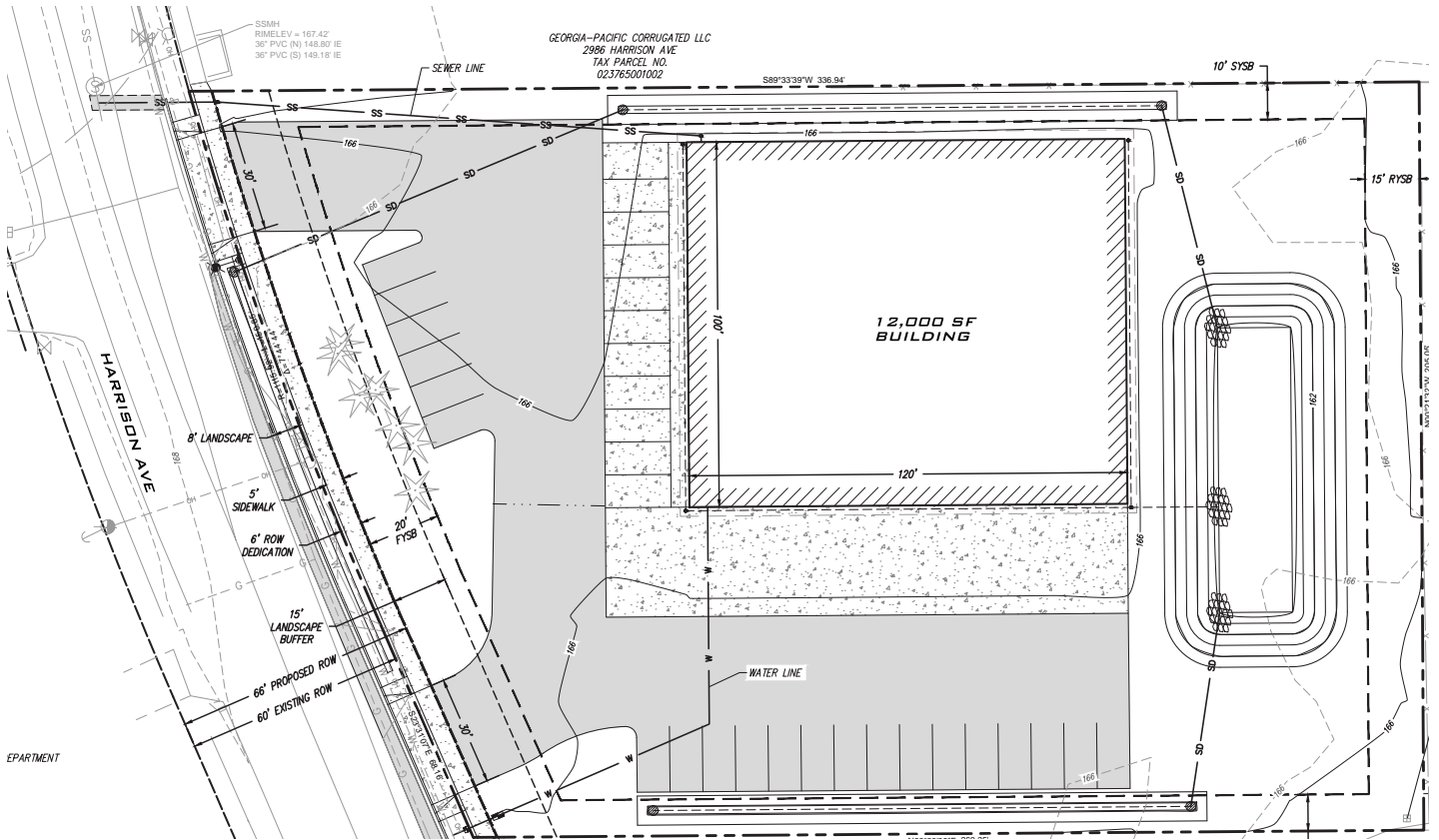

KYLE SCHIPPER, SIOR
 Partner
 +1 253 203 1320
 kschipper@nai-psp.com

DAVE DOUGLAS, SIOR, CCIM
 Partner
 +1 253 203 1325
 ddouglas@nai-psp.com

