

**FOR
LEASE**

510-555

ANDOVER PARK WEST

TUKWILA, WA



GEORGE ROCKWELL, SIOR | PRINCIPAL

C: 206.679.7625

E: grockwell@andoverco.com

BEN HEMPHILL | BROKER

C: 425.941.1320

E: bhemphill@andoverco.com

The information contained herein was obtained from sources believed reliable; however, The Andover Company, Inc. makes no guarantees, warranties or representations as to the completeness or accuracy thereof. The presentation of this property is submitted subject to errors, omissions, change of price or conditions, prior to sale or lease, or withdrawal without notice.



510-555

ANDOVER PARK WEST

PROPERTY HIGHLIGHTS

- +/- 121,206 SF Standalone Building, Fully Revamped Warehouse Space
- Up to 11,700 of Fully Refreshed Office Spaces
- Large, Fenced, Secured Area
- 19 Dock Height Doors
- 5 Grade-Level Doors
- 24' Clear Height
- Fully Sprinklered
- Abundant Parking
- Seismic and Capital Improvements



510-555 ANDOVER PARK WEST | TUKWILA, WA

SITE PLAN

510-555

ANDOVER PARK WEST

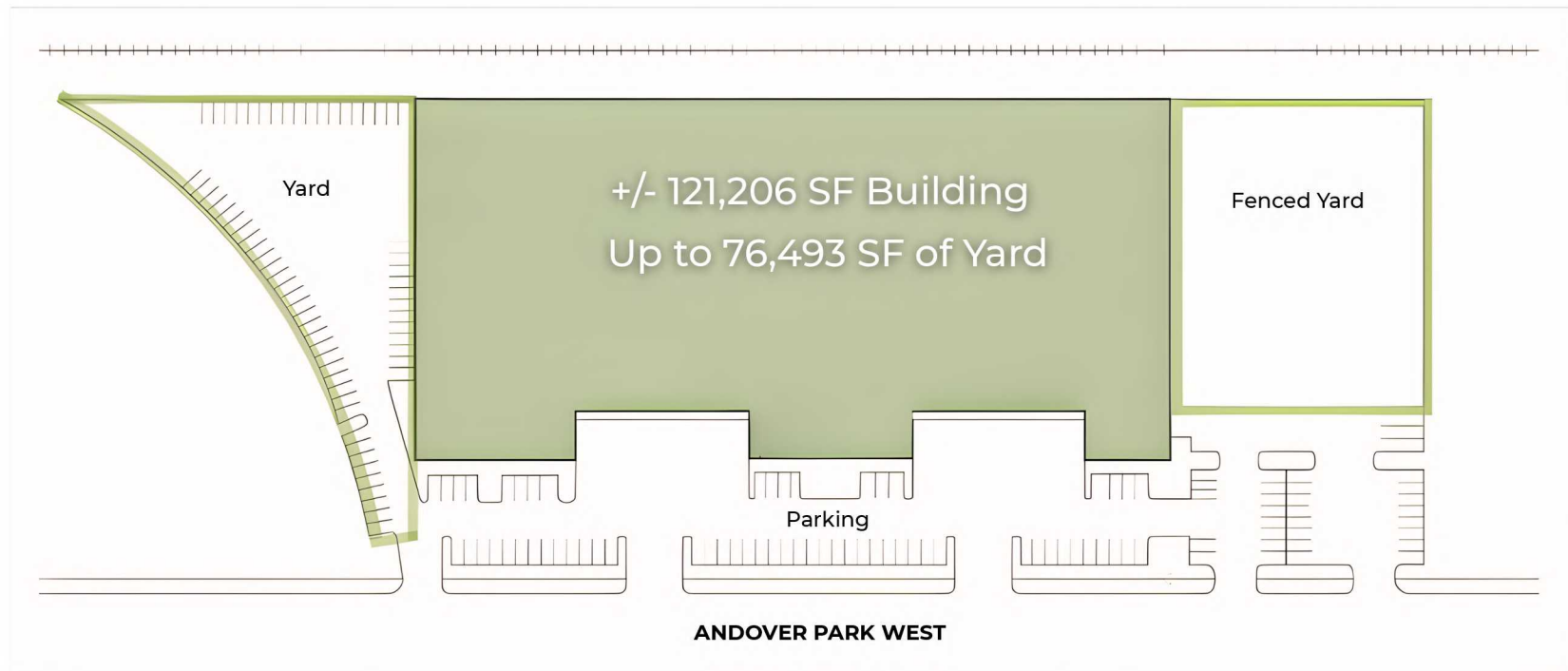

PROSPECTIVE FLOOR PLAN

(FLEXIBLE DEMISING PLAN)

510-555

ANDOVER PARK WEST

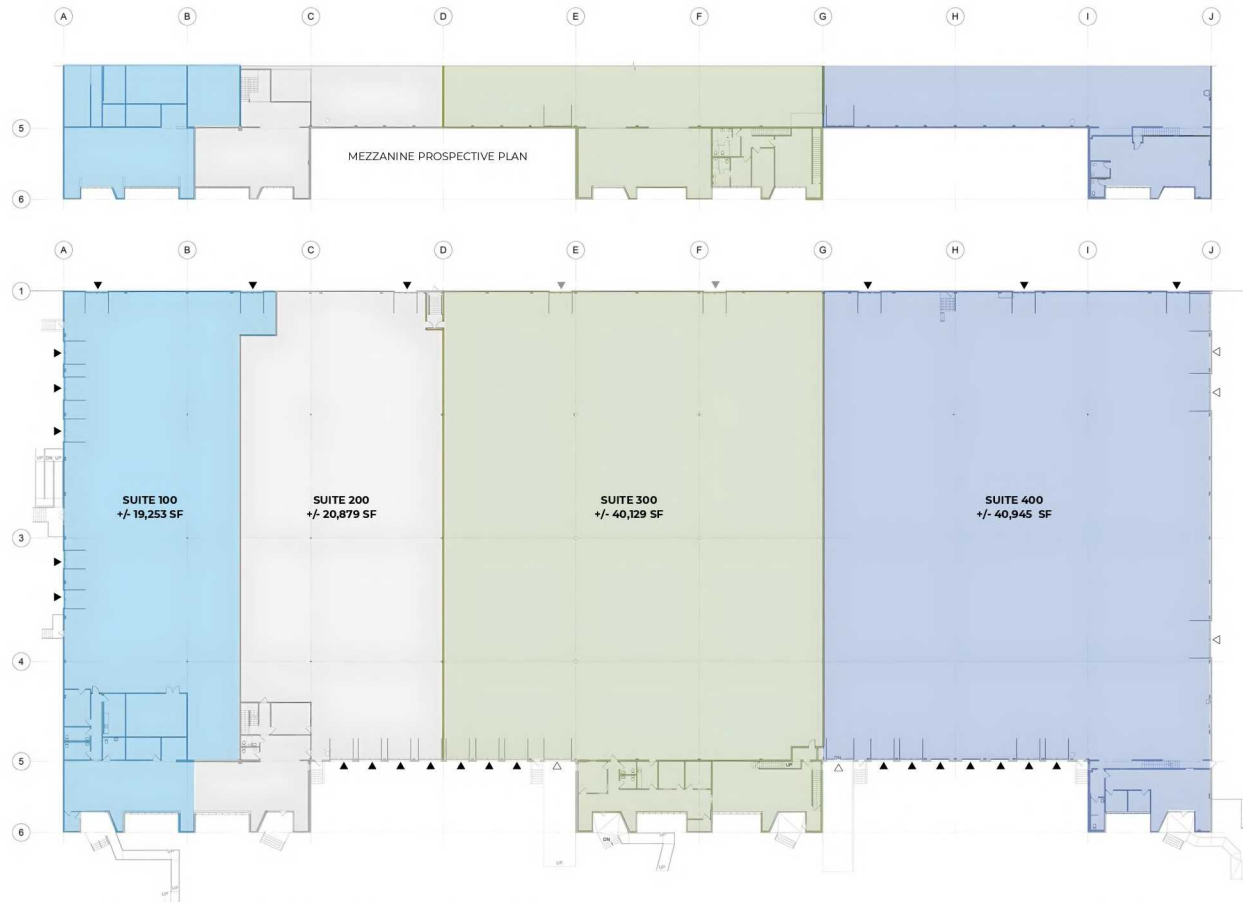

LEGEND

- ▲ OVERHEAD DOOR
- ▲ OVERHEAD DOOR BLOCKED
- △ DRIVE-IN DOOR

ANDOVER PARK W - TENANT IMPROVEMENT | TERRENO REALTY CORP

TENANT PLAN

510 ANDOVER PARK W, TUKWILA, WA | 25-228

NEARBY AMENITIES

510-555

ANDOVER PARK WEST



DRIVE TIMES

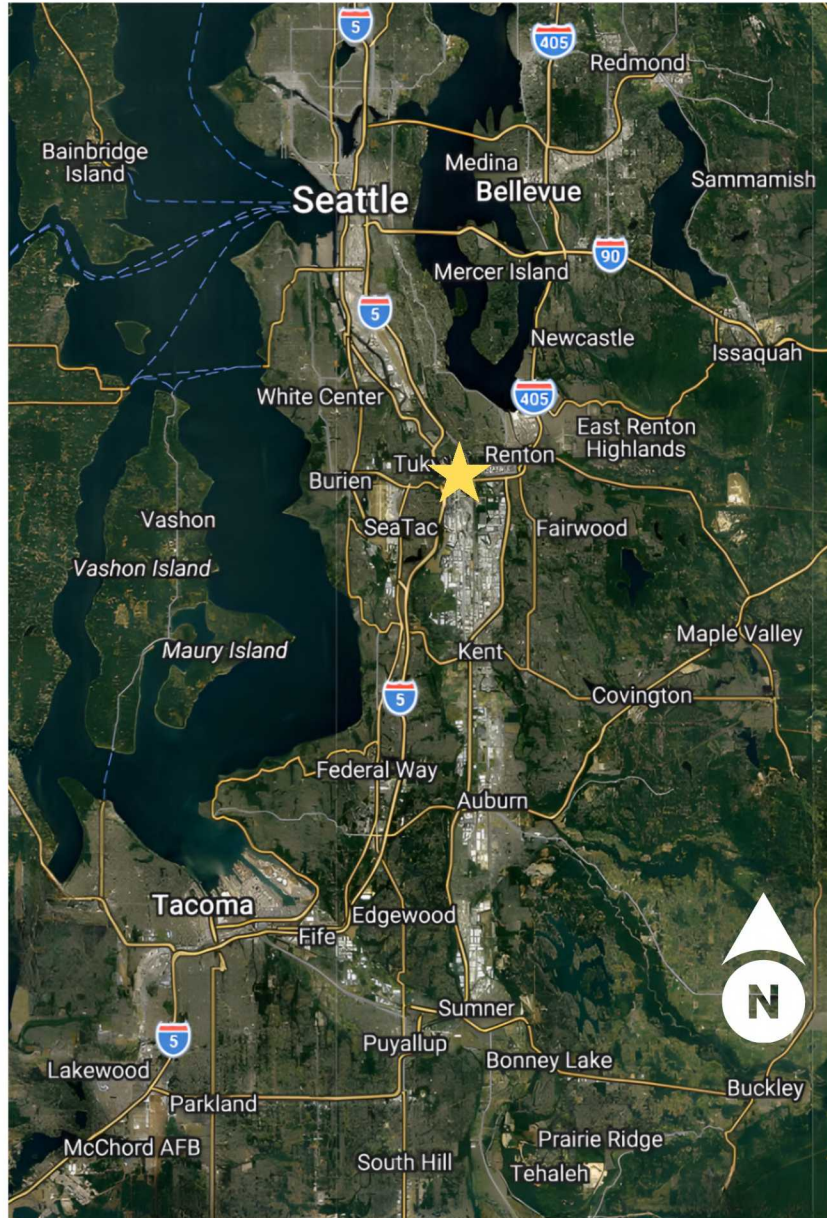

510-555

ANDOVER PARK WEST

- HWY 18- 4 MIN
- I-5- 4 MIN
- I-405- 4 MIN
- HWY 167- 6 MIN
- SEATAC AIRPORT- 10 MIN
- PORT OF SEATTLE- 20 MIN
- PORT OF TACOMA- 30 MIN

GEORGE ROCKWELL, SIOR | PRINCIPAL

C: 206.679.7625

E: grockwell@andoverco.com

BEN HEMPHILL | BROKER

C: 425.941.1320

E: bhemphill@andoverco.com

510-555

ANDOVER PARK WEST

TUKWILA, WA

